

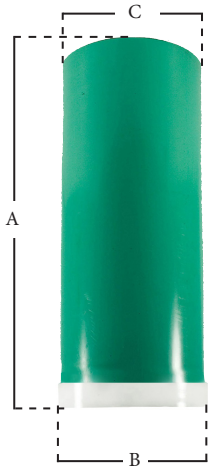

EXTENSION KIT FOR BACKWATER VALVES

- Kit includes lid, 16" sleeve, and adapter
- Thick walled for longevity



Part No.	Description	Valve Size	A	B	C
B04303	Extension Kit with Cast Iron Lid, Adapter & 16" Sleeve	3.00"	16.30"	7.00"	6.30"
B04403	Extension Kit with Cast Iron Lid, Adapter & 16" Sleeve	4.00"	16.30"	9.00"	8.40"
B04304	Extension Kit with Plastic Lid, Adapter & 16" Sleeve	3.00"	16.30"	7.00"	6.30"
B04404	Extension Kit with Plastic Lid, Adapter & 16" Sleeve	4.00"	16.30"	9.00"	8.40"

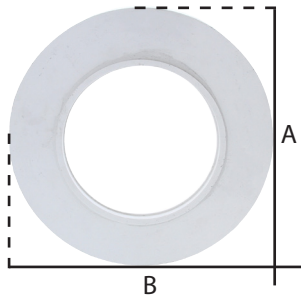

Part No.	Description	Valve Size	A	B
BWV200	Ring Adapter	1.50"-2.00"	7.00"	7.00"
BWV300	Ring Adapter	3.00"	7.00"	7.00"
BWV400	Ring Adapter	4.00"	9.00"	9.00"



Part No.	Description	Valve Size	A	B
B04006	Lid Marked Sewer	1.50" - 3.00"	6.30"	6.30"
B04007	Lid Marked Water	1.50" - 3.00"	6.30"	6.30"
B04008	Lid Marked Sewer	4.00"	8.40"	8.40"