

Rev. 9-15 Shaded area indicates changes



H-10094N

Straight coupling

Swivel nut with female increasing I.P. thread (this thread is one size larger than the nominal size of the fitting) x M.I.P. thread.

3/4"

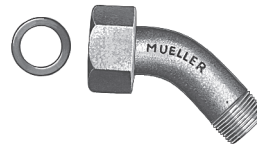

H-10022N

Eighth bend coupling

Swivel nut with female Mueller® Coupling thread x M.I.P. thread

5/8"	3/4"	1"
------	------	----

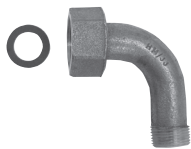

H-10096N

Quarter bend coupling

Swivel nut with female increasing I.P. thread (this thread is one size larger than the nominal size of the fitting) x M.I.P. thread.

3/4"	1"	1-1/4" ‡	1-1/2"	2"
------	----	----------	--------	----

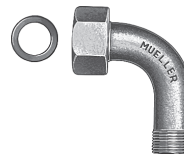

H-10023N

Quarter bend coupling

Swivel nut with female Mueller Coupling thread x M.I.P. thread

5/8"	3/4"	1"
------	------	----

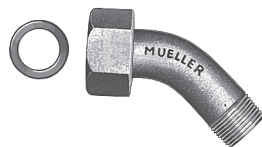

H-10095N

Eighth bend coupling

Swivel nut with female Mueller® Coupling I/S I.P. thread x M.I.P. outlet

1-1/2"	2"
--------	----

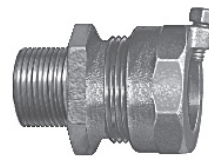

H-15423-10N

Straight coupling

Compression connection with set screw for use on steel pipe x M.I.P. thread

3/4"	1" ‡
------	------

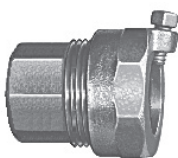

H-14233-10N

Straight coupling

Compression connection with set screw (drilled for wire seal) for use on steel pipe x F.I.P. thread

3/4"	1" ‡
------	------

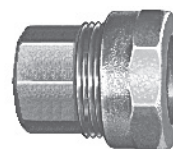

H-14232N

Straight coupling

Compression connection for use on steel pipe x F.I.P. thread

3/4" ‡ *

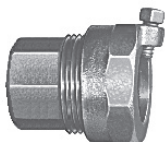

H-14233N

Straight coupling

Compression connection with set screw for use on steel pipe x F.I.P. thread

3/4"	1" ‡
------	------



H-15538N

Quarter bend coupling

Mueller Coupling thread M.I.P. thread - **both ends**

3/4"	1"	1-1/2"	2"
------	----	--------	----

* Both ends of coupling are 3/4" size.

‡ Requires minimum ordering quantity. Contact MUELLER Customer Service Center for minimum order requirements and availability.

NOTE: Sizes shown above represent nominal size of fitting.