

Installation Instructions

Towel Bar / Post Tissue Holder

Model No. 30-02, 30-03, 30-28

NEWPORT BRASS®

Flawless Beauty. From Faucet to Finish.™

Recommended Installation by a Professional Contractor

1. Using the table below, measure the appropriate distance between post centers. See Figure 1.

Note: Hole locations should be level.

- 24" Single Towel Bar - 24 5/16"
- 30" Single Towel Bar - 30 5/16"
- Tissue Holder - 6 1/4"

2. Drill hole(s) in wall at points marked using the appropriate drill size:

- Wood Screw (#6 x 2") - use: 3/32" Drill
- Toggle Screw (6-32 x 3") - use: 3/8" Drill

3. Fasten FLANGE (1) to finished wall using either WOOD/TOGGLE SCREWS (2). Place ADAPTER POST (3) into FLANGE (1) at specified height of 2-5/16". Secure ADAPTER POST (3) in place with SETSCREW (4). See Figure 2.

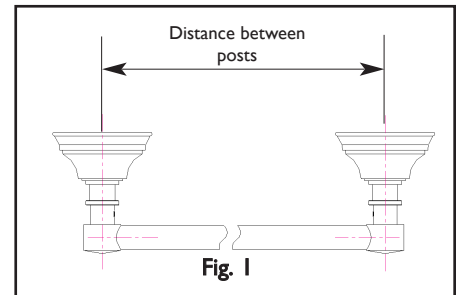

5. Place ESCUTCHEON (5), BONNET (6) and NUT (7) over POST (3). See Figure 3.

6a. **TOWEL BAR:** Assemble TOWEL BAR (9) between END POST (6). Place END POST (6) onto POST (3). Secure in place with SETSCREW (4). See Figure 4.

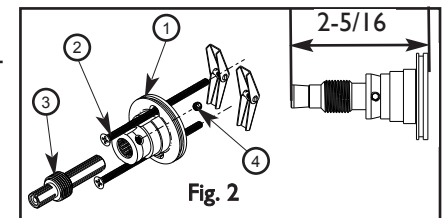

6b. **TISSUE HOLDER:** Place END POST (6) onto POST (3). Secure in place with SETSCREWS (4). Place HOLDERS (8) between END POSTS (6). See Figure 5.

