



VALVE SHOWN WITH TORQ-ABLE CARTRIDGES THAT ARE SUPPLIED WITH TRIM KIT. THESE CARTRIDGES MUST BE USED TO REPLACE CARTRIDGES THAT ARE SUPPLIED WITH THE VALVE. TORQUE TO 14-16 FT-LBS.



RECOMMENDED VALVE(S), SHOWN WITH TRIM KIT, SOLD SEPERATELY.

### BILL OF MATERIAL (CURRENT LEVEL)

ITEM	PT/ASSY	DESCRIPTION	TYPE	QTY.
1	1-532C	WALL LAVATORY KIT 1/2" NPT	ASSEMBLY	1
2	3-2031	TRIM KIT - 3-2031	ASSEMBLY	1

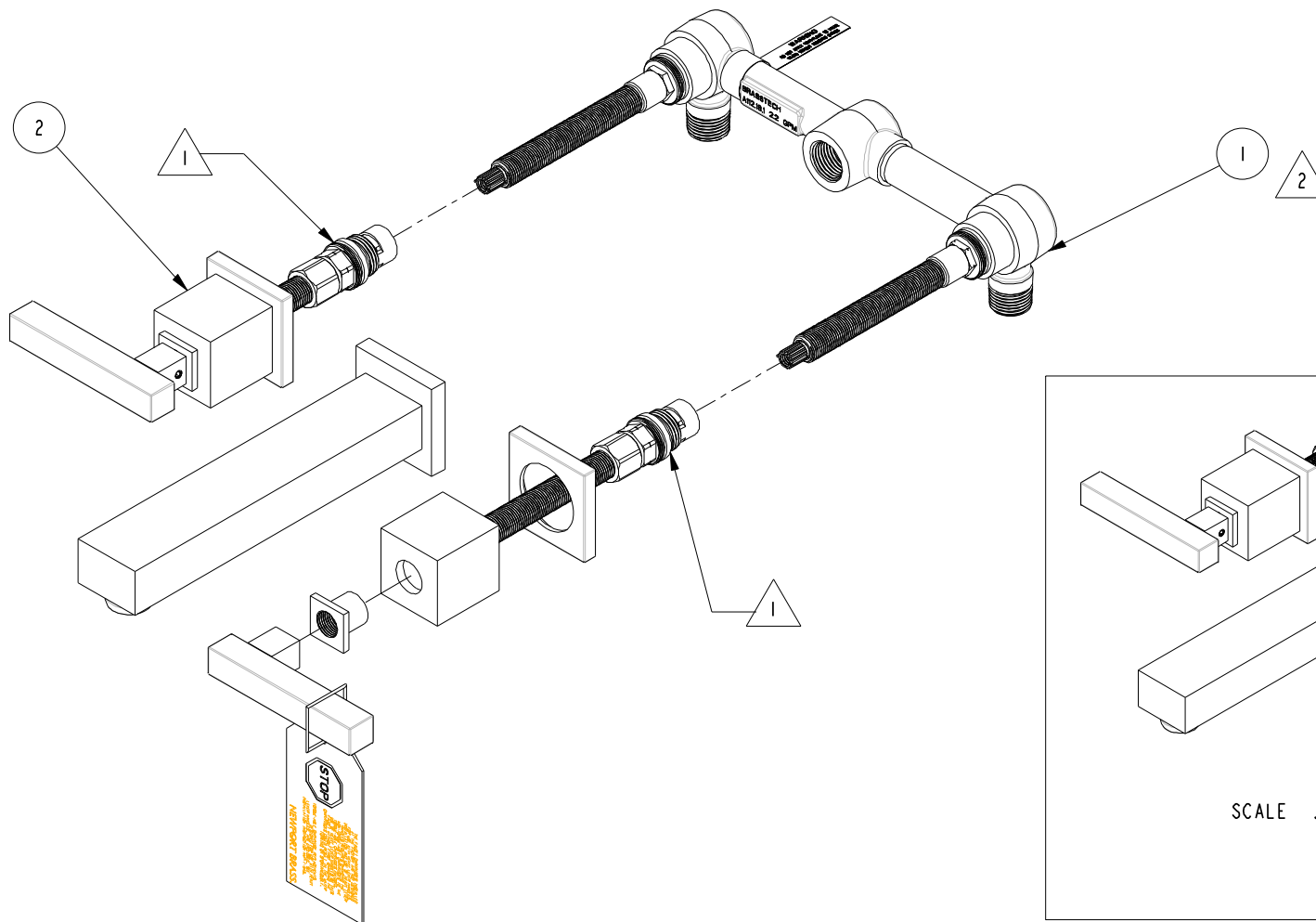

COPYRIGHT 2005 BRASSTECH, INC. THESE DRAWINGS AND THE DESIGNS DEPICTED HEREIN ARE THE PROPRIETARY PROPERTY OF BRASSTECH. ANY USE OR REPRODUCTION IS SUBJECT TO THE EXPRESS APPROVAL OF BRASSTECH. UNAUTHORIZED USE IS STRICTLY PROHIBITED. ALL RIGHTS RESERVED.

**BRASSTECH**  
INCORPORATED  
2001 E. CARNEGIE AVE.  
SANTA ANA, CA 92705  
(949) 417-5207

WALL LAV ASM

ASSY. NO. 2031

SCALE .300

REF. -

SHEET 1 OF 3

C	EN-1176	10/23/09
B	EN-1167	12/19/08
A	EO-0482	03/07/05
-	EO-0259	03/22/04
REV	REV DESC	DATE



VALVE SHOWN WITH TORQ-ABLE CARTRIDGES THAT ARE SUPPLIED WITH TRIM KIT. THESE CARTRIDGES MUST BE USED TO REPLACE CARTRIDGES THAT ARE SUPPLIED WITH THE VALVE. TORQUE TO 14-16 FT-LBS.

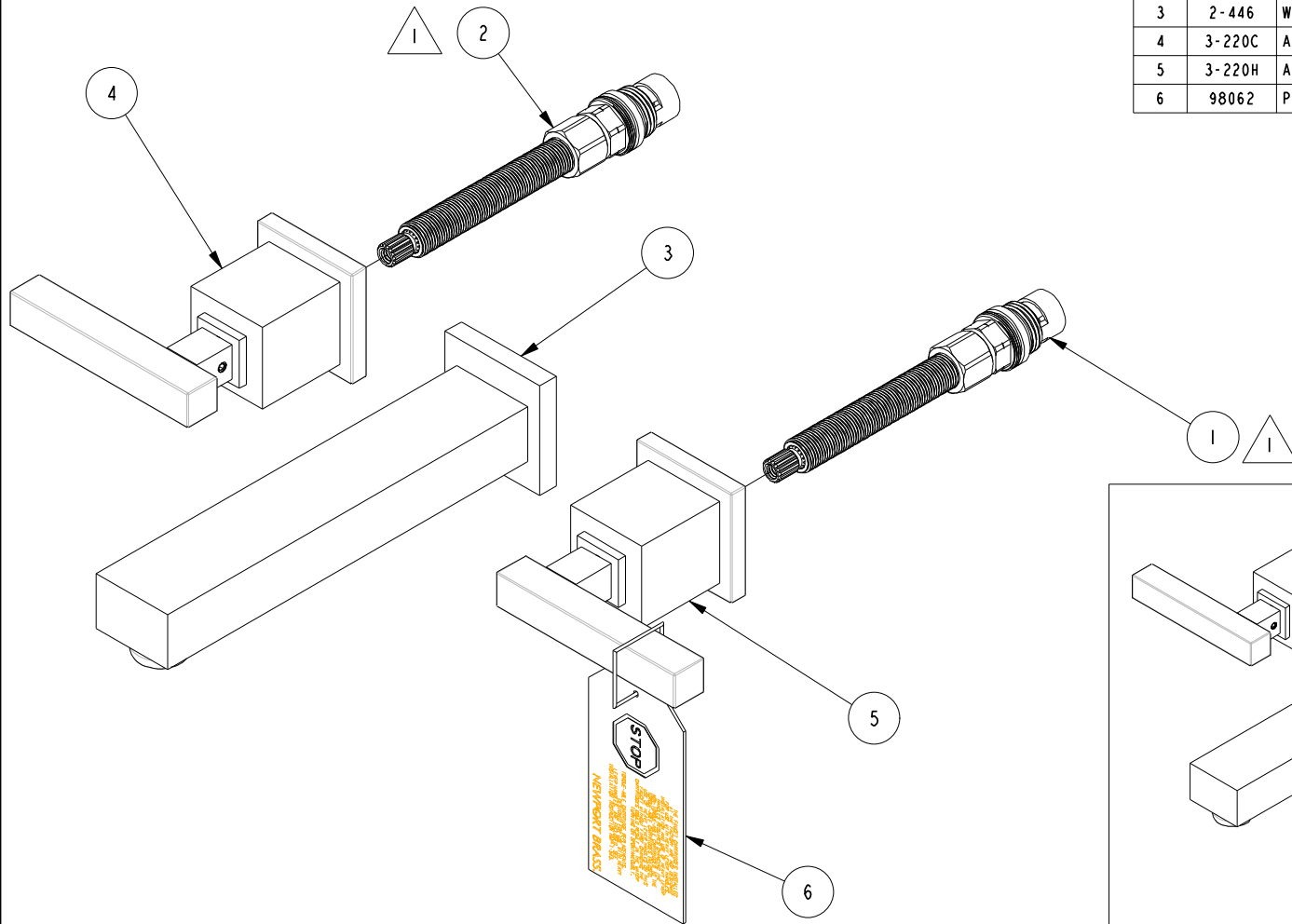

### BILL OF MATERIAL (CURRENT LEVEL)

ITEM	PT/ASSY	DESCRIPTION	TYPE	QTY.
1	1-543	T/S TORQ. CARTRIDGE COLD	ASSEMBLY	1
2	1-544	T/S TORQ. CARTRIDGE HOT	ASSEMBLY	1
3	2-446	WALL LAV SPOUT ASM	ASSEMBLY	1
4	3-220C	ASSY, HANDLE TRIM, COLD	ASSEMBLY	1
5	3-220H	ASSY, HANDLE TRIM, HOT	ASSEMBLY	1
6	98062	PRODUCT WARNING LABEL	PART	1

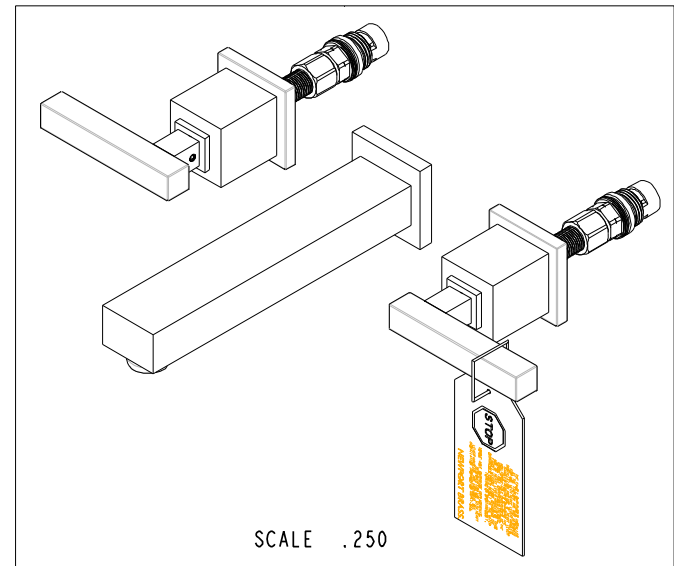

COPYRIGHT 2005 BRASSTECH, INC. THESE DRAWINGS AND THE DESIGNS DEPICTED HEREIN ARE THE PROPRIETARY PROPERTY OF BRASSTECH. ANY USE OR REPRODUCTION IS SUBJECT TO THE EXPRESS APPROVAL OF BRASSTECH. UNAUTHORIZED USE IS STRICTLY PROHIBITED. ALL RIGHTS RESERVED.

**BRASSTECH**  
INCORPORATED  
2001 E. CARNEGIE AVE.  
SANTA ANA, CA 92705  
(949) 417-5207

TRIM KIT - 3-2031

ASSY. NO. 2031

SCALE .375

REF. -

SHEET 2 OF 3

C	EN-1176	10/23/09
B	EN-1167	12/19/08
A	EO-0482	03/07/05
-	EO-0259	03/22/04
REV	REV DESC	DATE

1. CUT ALL-THREAD 1/2"  
SHORTER THAN STEM

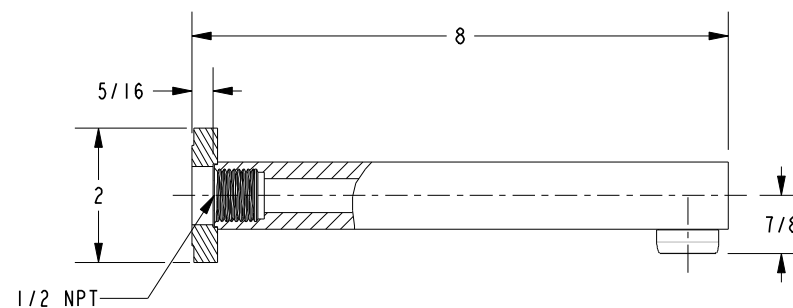
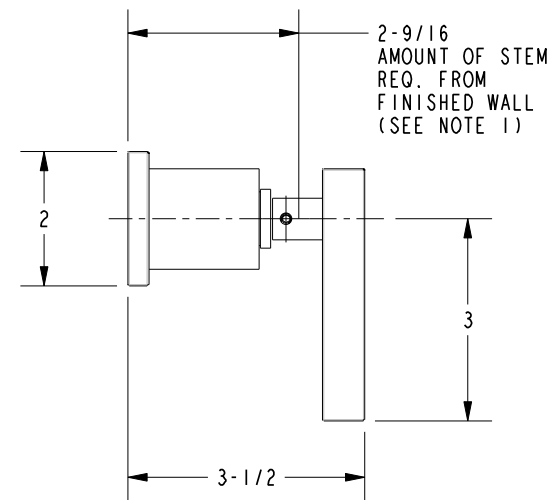

COPYRIGHT 2005 BRASSTECH, INC. THESE DRAWINGS AND THE DESIGNS DEPICTED HEREIN ARE THE PROPRIETARY PROPERTY OF BRASSTECH. ANY USE OR REPRODUCTION IS SUBJECT TO THE EXPRESS APPROVAL OF BRASSTECH. UNAUTHORIZED USE IS STRICTLY PROHIBITED. ALL RIGHTS RESERVED.

**BRASSTECH**  
INCORPORATED

2001 E. CARNEGIE AVE.  
SANTA ANA, CA 92705  
(949) 417-5207

DWG NO.		2031		REV	
				C	
SCALE .125		REF. -		SHEET 3 OF 3	