



SYMMONS® Temptrol®

Shower & Tub-Shower Mixing Valve

Model 4000-X-BODY

Specification Submittal

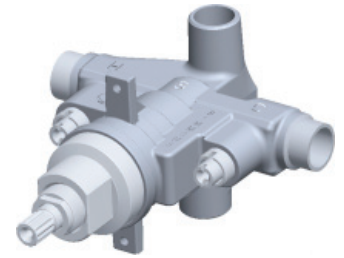

Model Numbers

- ❑ 4000-X-BODY..... Shower & Tub-Shower Valve
Symmons Temptrol Tub-Shower, mixing valve with
integral service stops. Includes plug to install in tub
outlet port when used in shower only installations.

Options / Modifications

Append appropriate -suffix to model number.

- ☐ -CHKS Integral check stops for use in installations where a positive shut-off device is used downstream of mixing valve.
- ☐ -IPS 1/2 inch female IPS connections
- ☐ -REV Reverse coring, hot on right, cold on left for back to back installations

Feature Highlights

- Symmons Temptrol 4-port pressure balancing mixing valve with adjustable stop screw to limit handle turn
- Integral service stops to allow water shut-off for servicing valve
- Supply inlet ports 1/2 inch sweat
- Outlet ports 1/2 inch sweat

Standards / Certifications

ASME A112.18.1/CSA B125.1

Warranty

- **Limited Lifetime** - to the original end purchaser in residential/consumer installations.
- **5 years** - for commercial installations

Dimensions

