

No.	DESCRIPTION	MATERIAL DESCRIPTION
1	BRANCH CONN	CAST LOW LEAD BRASS ALLOY
2	GASKET	ASTM D2000 (SBR)&410 STAINLESS STL
3	CONN NUT	CAST BRASS ASTM B62 ALLOY C83600

VALVE SIZE	A	B
3/4"x1"	1.91	1.03
1"x1-1/2"	2.38	1.40
1"x2"	2.38	1.59

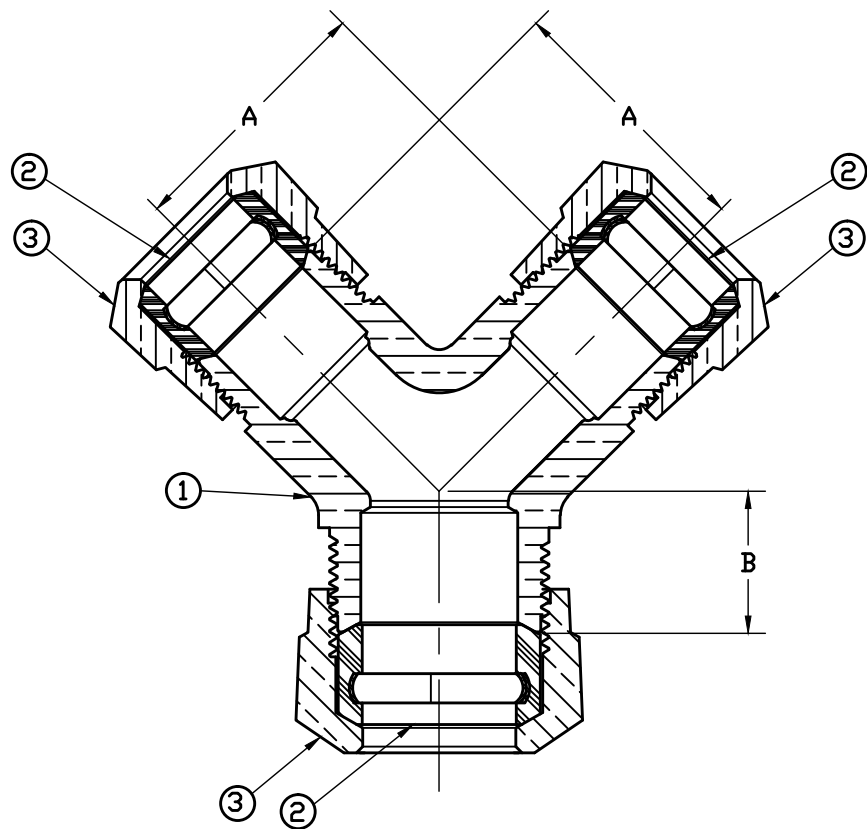

NOTE: ALL WETTED PARTS ARE LOW LEAD BRASS ALLOY

FILEPATH: PROD-ENG\MUELLER\ASYSUBMITTALS\H15343N

						DRFTRJGarvin	12/21/09			THIRD ANGLE PROJECTION REF. No. SCALE			
						CHKR							
						ENGR							
						MGR							
						BY	DATE	UNLESS OTHERWISE NOTED SURFACE PREPARATION: BREAK CORNER(S) ---- .000 SURFACE FINISH -- XX RMS TOLERANCE(S): LINEAR ----- ± .000 ANGULAR ----- ± 0°00'					
						STK No:							
						MAT'L:							
REV	ECR	DESCRIPTION	DATE	BY	CHKR	DESCR.							
PER EST NO: DXXXX						EST FIN WT = 0.0000 lbs							
						Y-BRANCH CONNECTION LOW LEAD BRASS (110CTS ENDS)						PART NUMBER H15343N	

PART NUMBER
H15343N
442-MRKTG

April 28, 2017

Subject: Mueller Co. Service Brass

To Whom It May Concern:

This will certify that Mueller Co. service brass, which includes corporation stops, curb stops, service fittings, meter valves, copper meter yokes and end connections, are manufactured and tested in accordance with the latest revision of AWWA C800 standard and are certified to NSF 61.

Components that come in contact with potable water comply with the latest requirements of the U.S. Federal Safe Drinking Water Act that was enacted on January 4, 2014.

Sincerely,



Larry Aulich
Senior Product Manager
Mueller Company