

Ratings (ASTM A105)

800 p.s.i. @ 850°F
1975 p.s.i. @ 100°F

Test pressure (ASTM A105)

Hydrostatic: (minimum)
Body - 3000 p.s.i.
Seat - 2175 p.s.i.
Pneumatic:
Seat - 85 p.s.i.

Standards

Construction API 602, BS 5352
Socket weld ASME B16.11
Threaded ASME B1.20.1
Test API 598-BS 6755 (Pt.1)

Connections

S Socket weld
T Threaded NPT
X Sw/NPT

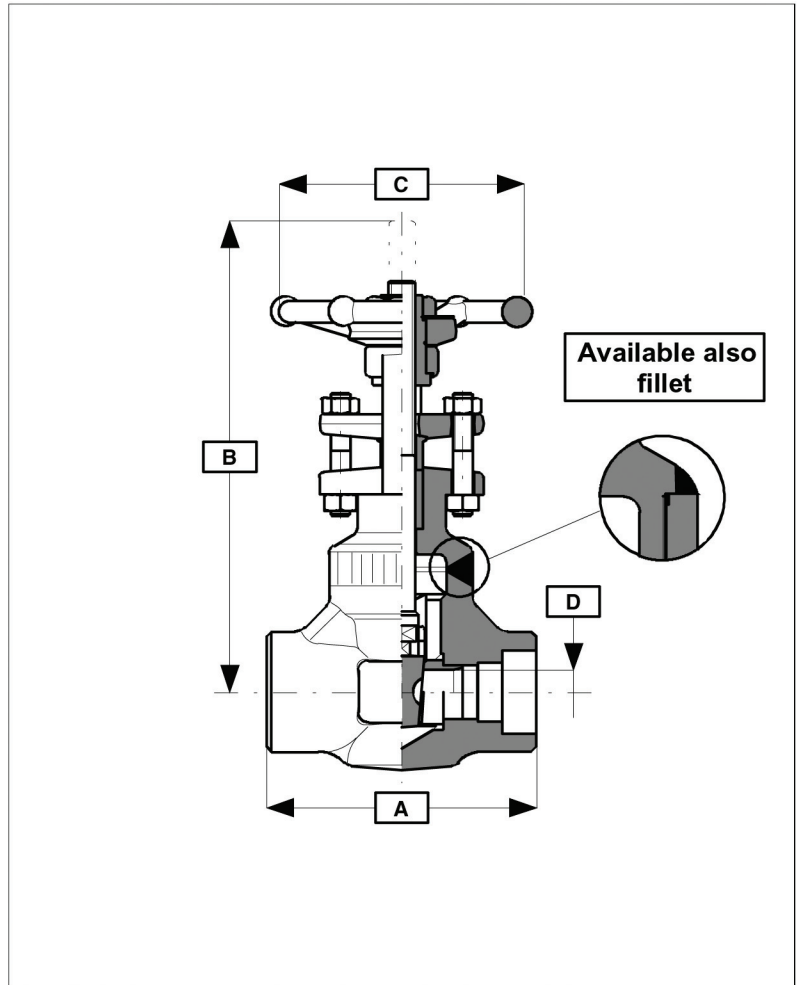

Typical Figure Number: GA08SA58GW - A105, Socket Weld, Trim 8

		CONVENTIONAL PORT											
		1/2"		3/4"		1"		1-1/4"		1-1/2"		2"	
A	(mm/in)	80	3.15	90	3.54	110	4.33	127	5.00	127	5.00	130	5.12
B	(mm/in)	150	5.91	157	6.18	188	7.40	220	8.66	248	9.76	274	10.79
C	(mm/in)	90	3.54	90	3.54	100	3.94	120	4.72	140	5.51	140	5.51
D	(mm/in)	10	0.39	14	0.55	18	0.71	24	0.94	31	1.22	36.5	1.44
Wt.	(kg/lb)	1.4	3.1	1.7	3.7	2.8	6.2	4.4	9.7	5.6	12.3	7.6	16.7

		SPECIAL PORT															
		1/4"		3/8"		1/2"		3/4"		1"		1-1/4"		1-1/2"		2"	
A	(mm/in)	80	3.15	80	3.15	90	3.54	110	4.33	127	5.00	127	5.00	130	5.12	150	5.91
B	(mm/in)	150	5.91	150	5.91	157	6.18	188	7.40	220	8.66	248	9.76	274	10.79	334	13.15
C	(mm/in)	90	3.54	90	3.54	90	3.54	100	3.94	120	4.72	140	5.51	140	5.51	200	7.87
D	(mm/in)	8.5	0.33	10	0.39	14	0.55	18	0.71	24	0.94	31	1.22	36.5	1.44	48	1.9
Wt.	(kg/lb)	1.5	3.3	1.5	3.3	1.8	4.0	2.9	6.4	4.5	9.9	5.7	12.5	7.7	16.9	12.2	26.8

Figure Number Definitions - See page 4