

# PRODUCT SPECIFICATION DRAWING HOLDRITE® #424, #425 & #426 Inserts

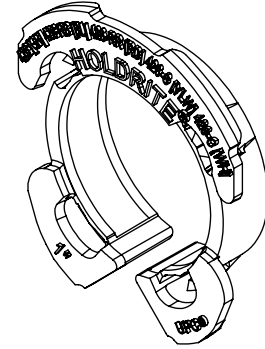

ALL DIMENSIONS IN INCHES

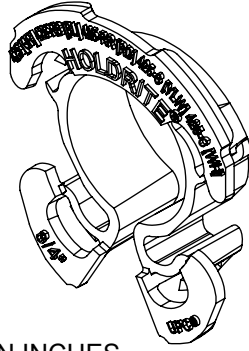
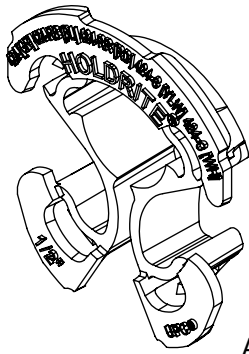
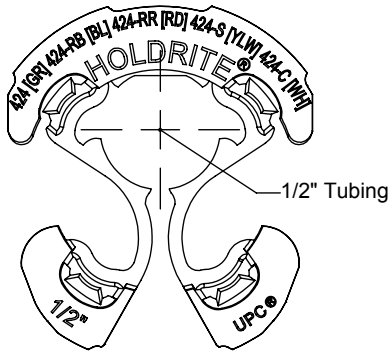
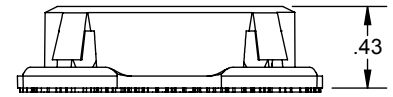
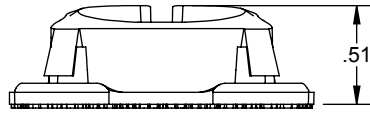
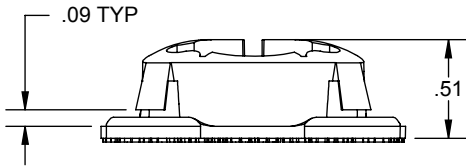

**#424**

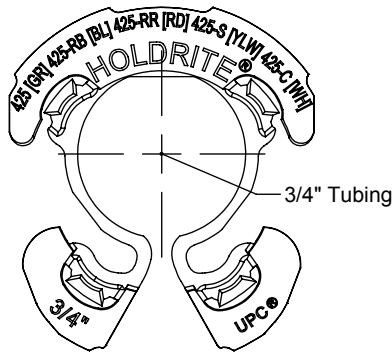

**#425**

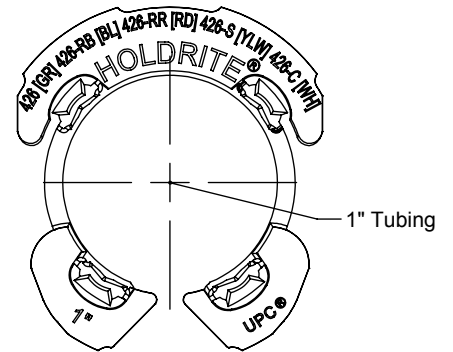

**#426**

For used with 1-11/32" or 1-3/8" round cut-outs in 14 to 25 gage sheet metal.  
Ideal for isolation of Copper, PEX or CPVC tubing.

## Product Information:

- Material: Polypropylene, Light Gray, UL94HB
- Temperature range: -10°F to 180°F
- UPC / IPC / IAPMO listed



THIS INFORMATION IS PROPRIETARY TO HOLDRITE AND IS SUBJECT TO CHANGE WITHOUT NOTICE. IT MAY NOT BE REPRODUCED IN PART OR WHOLE WITHOUT WRITTEN AUTHORIZATION.

# HOLDRITE®

CONVERTING MAKESHIFT METHODS INTO ENGINEERED SOLUTIONS<sup>SM</sup>  
800-321-0316 OR 760-744-6944 / FAX: 760-744-0507 / WWW.HOLDRITE.COM  
spec\_424\_425\_426\_RevD

| Product Submittal  |      |
|--------------------|------|
| Job Name:          |      |
| Date:              |      |
| Part Number:       | Qty: |
|                    |      |
| Architect / Owner: |      |
|                    |      |
| Contractor:        |      |
|                    |      |
| Notes:             |      |
|                    |      |
|                    |      |