

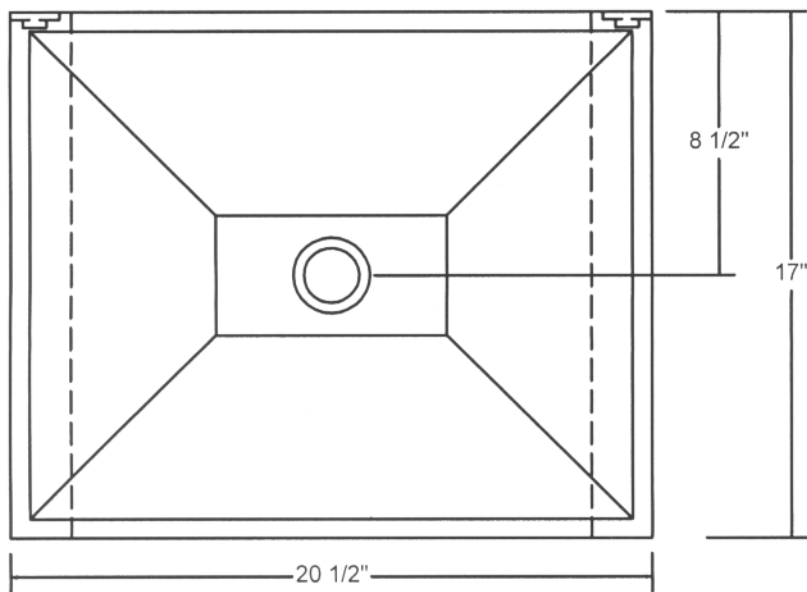

SYNC-SK-A SYNC SYSTEM RECTANGULAR SINK

© 2008 STONE FOREST, INC.
PATENT PENDING



TOP VIEW

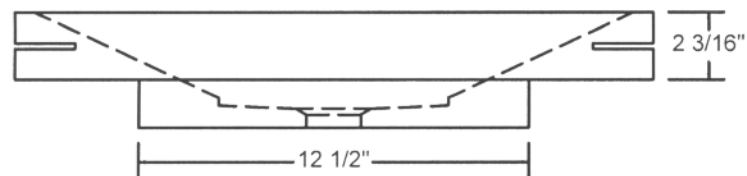

FRONT VIEW

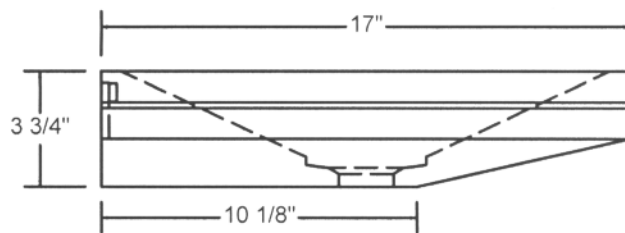

SIDE VIEW

Available in:

Honed black granite (HONE BL)
Carrara marble (CA)

Must be used with SYNC system brackets,
#SYNC-BR-17

1 bracket will be required for each open
side of your layout along with 1 bracket
between any and all adjoining sink(s) and
countertop(s).

Includes stainless steel grid cover (sink can
be custom made without the stainless
grid for commercial use)

Approx thickness at drain is .75"
Required drain use 9054D Grid drain.
Drains are 1.25" NPT. This can
be supplied by Stone Forest at your
request in select finishes.

Do not use pop up drain

Approx 75lbs

STONE
FOREST