

DIMENSIONAL SPECIFICATIONS

LEAD-FREE IMPORT BRASS FITTINGS* 125 LB.

CROSS

Part #	Size (IN.)	Approx. Net WT. (LB.)	A	B	C
XNL110-04	1/4	0.20	0.72	0.34	0.81
XNL110-08	1/2	0.44	1.03	0.45	1.17
XNL110-12	3/4	0.68	1.19	0.52	1.42
XNL110-16	1	1.08	1.43	0.60	1.72
XNL110-24	1-1/2	1.97	1.87	0.70	2.38
XNL110-32	2	2.52	2.14	0.76	2.92

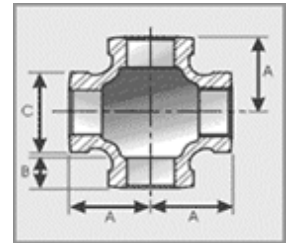

CAP

Part #	Size (IN.)	Approx. Net WT. (LB.)	G1	G2	A
XNL116-02	1/8	0.08	0.08	0.09	0.25
XNL116-04	1/4	0.07	0.08	0.10	0.32
XNL116-06	3/8	0.09	0.09	0.11	0.36
XNL116-08	1/2	0.13	0.09	0.12	0.45
XNL116-12	3/4	0.22	0.10	0.13	0.50
XNL116-16	1	0.40	0.11	0.15	0.58
XNL116-20	1-1/4	0.48	0.12	0.17	0.67
XNL116-24	1-1/2	0.72	0.13	0.19	0.70
XNL116-32	2	1.11	0.15	0.22	0.75
XNL116-40	2-1/2	1.75	0.17	0.25	0.92
XNL116-48	3	2.71	0.19	0.29	0.98
XNL116-64	4	4.64	0.22	0.36	1.08

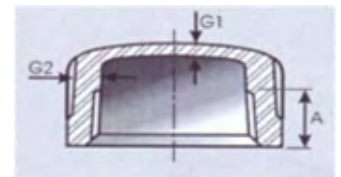

*Conforms with lead content requirements for lead-free plumbing as defined by the U.S. Safe Drinking Water Act. Certified <0.25 weighted average % lead.



MERIT BRASS

DIRECTING THE FLOW OF *Quality*