

TECHNICAL SPECIFICATIONS

SP-3248

MODEL NUMBER 141070

DIMENSIONS: 48" x 32" x 6" Gelcoat



STANDARD FEATURES

- Rectangular shower base
- Integrated tiling flange
- Textured floor
- Center drain

UNIQUE FEATURES

- Tiling Flange

OPTIONS

- None

SYSTEMS

- None

DOOR SELECTION

Combine with AKER's complete shower door offering visit www.akerbymax.com

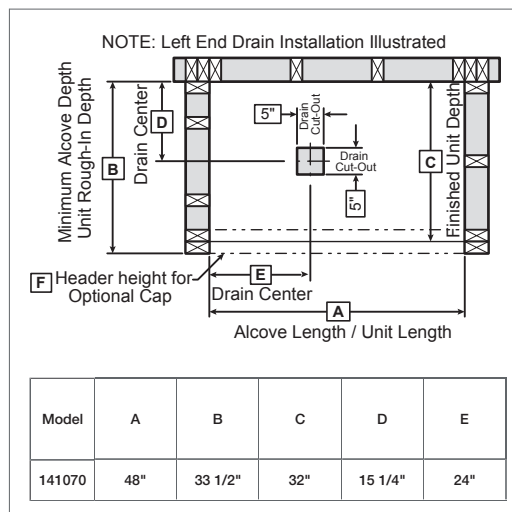

Project : _____

Contractor : _____

AKER Representative : _____ Tel : _____

Date : _____

CERTIFICATIONS

AKER products adhere to one or more of the following certifications:



TECHNICAL SPECIFICATIONS

SP-3248

MODEL NUMBER 141070

TECHNICAL DRAWINGS

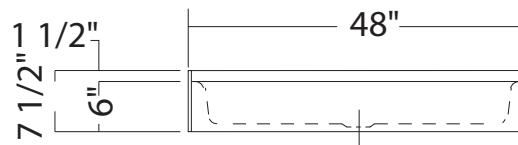
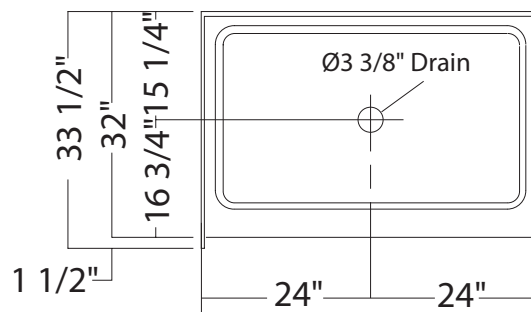

All dimensions are approximate. Structure measurements must be verified against the unit to ensure proper fit.