

*For Residential and Commercial Applications*

Job Name		Engineer / Architect	
Job Location		Wholesaler	
Submittal Date		Contractor	

## BRPX1B/ BRPX09/ BRPX19 Multi-Turn Angle Stop – Barbed PEX x Compression

**Use:** For use in potable water distribution systems. Not intended for recirculating systems that produce continuous use temperatures above 115° F. For those applications, use BrassCraft’s KT series ball stop.

**Design Features:**

- **Machined one-piece brass body** provides strength, durability and long-lasting performance
- **Knurled oval handle** provides a secure grip and smooth on/off operation
- **Easy-to-remove handle** with screw attachment protects accidental stop operation during rough-ins
- **Compliant Multi-Turn Stops** available for California and Vermont “low-lead” requirements

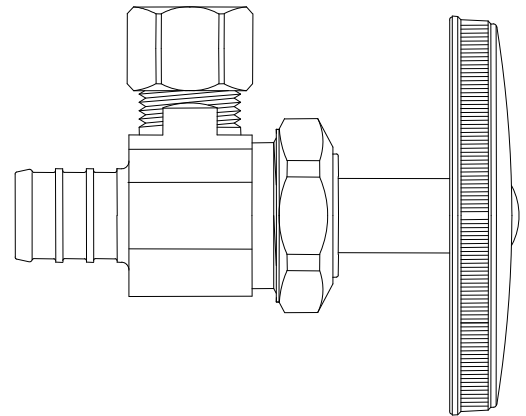

**Operating Specifications:**

**Temperature:** 40°- 140° F  
**Pressure:** 125 psi maximum

**Standard**

MATERIAL SPECIFICATIONS	
<b>Valve Body</b>	C36000 brass
<b>Stem</b>	POM
<b>Bib &amp; Packing Washers</b>	Nitrile or EPDM rubber
<b>Packing Nut</b>	EPDM
<b>Handle</b>	Lexan
<b>Handle Screw</b>	Zinc-plated steel
<b>Plastic Sleeve</b>	Delrin
<b>Compression Sleeve</b>	C36000 brass
<b>Compression Nut</b>	C36000 brass

**Compliant**

MATERIAL SPECIFICATIONS	
<b>Valve Body</b>	Compliant brass
<b>Stem</b>	POM
<b>Bib &amp; Packing Washers</b>	Nitrile or EPDM rubber
<b>Packing Nut</b>	EPDM
<b>Handle</b>	Lexan
<b>Handle Screw</b>	Zinc-plated steel
<b>Plastic Sleeve</b>	Delrin
<b>Compression Sleeve</b>	C36000 brass
<b>Compression Nut</b>	C36000 brass

**Standard Part Listing:**

- BRPX1B C      3/8” Nom. Crimp Barb (for PEX) x 3/8” OD Compression, chrome plated
- BRPX09 C      1/2” Nom. Crimp Barb (for PEX) x 1/4” OD Compression, chrome plated
- BRPX09 CBT    1/2” Nom. Crimp Barb (for PEX) x 1/4” OD Compression, chrome plated, plain tray, bulk
- BRPX09 R      1/2” Nom. Crimp Barb (for PEX) x 1/4” OD Compression, rough brass
- BRPX19 C      1/2” Nom. Crimp Barb (for PEX) x 3/8” OD Compression, chrome plated
- BRPX19 C1     1/2” Nom. Crimp Barb (for PEX) x 3/8” OD Compression, chrome plated, window tray

*This specification and all information contained herein is the confidential and exclusive property of BrassCraft Manufacturing, and shall not be disclosed to others without the written consent of BrassCraft. This specification must be returned to BrassCraft if requested.*



# BRPX1B/ BRPX09/ BRPX19 Multi-Turn Angle Stop – Barbed PEX x Compression

**Standard Part Listing (con't):**

- BRPX19 R            1/2" Nom. Crimp Barb (for PEX) x 3/8" OD Compression, rough brass

**Compliant Part Listing:**

- BRPX19X C            1/2" Nom. Crimp Barb (for PEX) x 3/8" OD Compression, chrome plated
- BRPX19X R            1/2" Nom. Crimp Barb (for PEX) x 3/8" OD Compression, rough brass

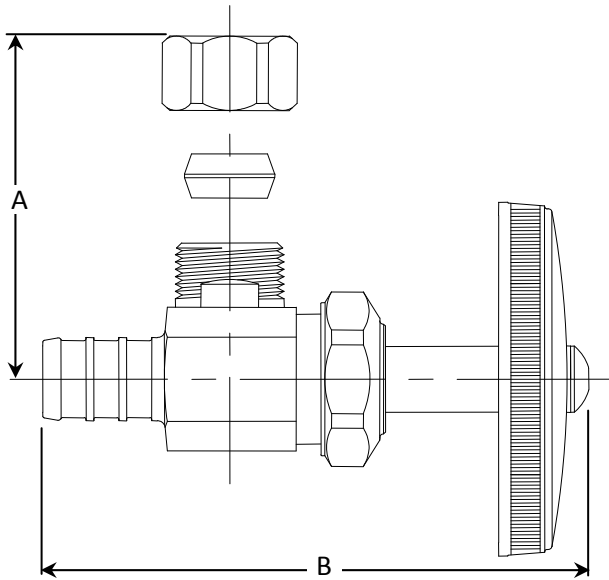

<b>PART DIMENSIONS (Inches)</b>		
<b>Model</b>	<b>DIM. A</b>	<b>DIM. B</b>
BRPX1B	1.06	2.72
BRPX09	1.06	2.79
BRPX19	1.06	2.79

**Listings & Certifications:**

- IAPMO listed to ASME A112.18.1-05 / CSA B125.1-05 (File # 0645)
- CSA listed to ASME A112.18.1-05 / CSA B125.1-05 (File # 204593)
- Compliant product CSA approved to California Health & Safety Code 116875 and Vermont Bill S.152 (Project # 2174785)



*This specification and all information contained herein is the confidential and exclusive property of BrassCraft Manufacturing, and shall not be disclosed to others without the written consent of BrassCraft. This specification must be returned to BrassCraft if requested.*

