

## Forged Gate Valves

- Round Bolted Bonnet
- Spiral Wound Gasket
- Outside Screw & Yoke
- Bolted Gland
- Solid Wedge
- Hard Faced Seats
- API 602
- ASME B16.34

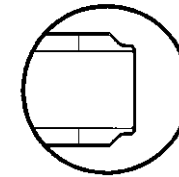
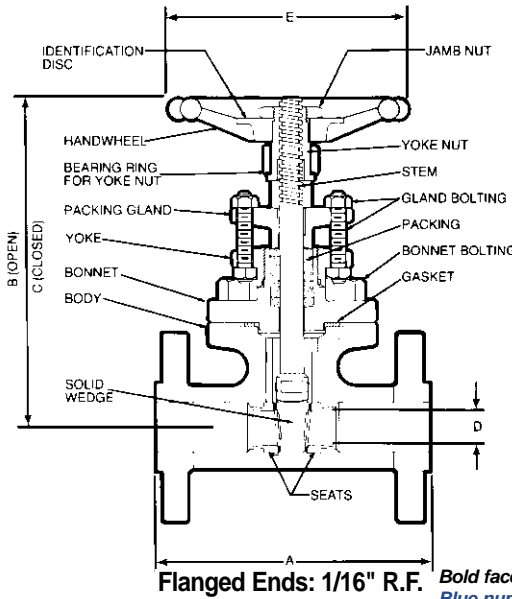

Butt Weld Ends  
Schedule 40

Flanged Ends: 1/16" R.F. *Bold face numerals are in inches and pounds.  
Blue numerals are in millimeters and kilograms.*

**Class 300 (PN 50)**  
Conventional Port  
740PSI @ 100°F (51.0 BAR @ 38°C)  
For other ratings see pgs. 112-115

**A105 Body/Bonnet**

*SERIES NUMBER*

- 363 Trim: 13% Cr. Seats: HF
- 363MB8 Trim: 316 Wedge/Seats: HF
- 363FHF Trim: 13% Cr. Wedge/Seats: HF
- 363MM Trim: Monel
- 13363MMP (Size 2" Only) (Full Port) Trim: Monel

Listed in Phillips Petroleum Company's HF Alkylation Process Design Spec. Manual.

- BW 363 (Sizes 2"-4") Trim: 13% Cr. Seats: HF
- BW 363F8M Trim: 316 Seats: HF
- BW 363MM Trim: Monel

**A350 LF2 Body/Bonnet**

- 32363 Trim: 13% Cr. Seats: HF
- 32363MB8 Trim: 316 Wedge/Seats: HF

**F316/F316L**

- 368 Trim: 316 Seats: HF

MATERIALS MEET REQUIREMENTS OF NACE STANDARD MR-01-75 FOR SOUR SERVICE

**Butt Weld Ends:**

| Size                 | NPS<br>DN | 1/2<br>15   | 3/4<br>20   | 1<br>25     | 1-1/2<br>40  | 2<br>50      | 3<br>80      | 4<br>100     | 2<br>50      | 2-1/2<br>65  | 3<br>80      | 4<br>100     |
|----------------------|-----------|-------------|-------------|-------------|--------------|--------------|--------------|--------------|--------------|--------------|--------------|--------------|
| A-End-to-End         |           | 5.50<br>140 | 6.00<br>152 | 6.50<br>165 | 7.50<br>190  | 8.50<br>216  | 11.12<br>282 | 12.00<br>305 | 8.50<br>216  | 9.50<br>241  | 11.12<br>282 | 12.00<br>305 |
| B-Open               |           | 6.38<br>162 | 6.38<br>162 | 8.31<br>211 | 10.12<br>257 | 11.10<br>282 | 14.06<br>357 | 18.03<br>458 | 11.10<br>282 | 14.06<br>357 | 14.06<br>357 | 18.03<br>458 |
| C-Closed             |           | 5.75<br>146 | 5.75<br>146 | 7.38<br>187 | 8.69<br>221  | 9.41<br>239  | 11.81<br>300 | 14.94<br>379 | 9.41<br>239  | 11.81<br>300 | 11.81<br>300 | 14.94<br>379 |
| D-Seat Diameter      |           | .50<br>12.7 | .50<br>12.7 | .75<br>19.1 | 1.25<br>31.8 | 1.50<br>38.1 | 2.00<br>50.8 | 2.75<br>69.8 | 1.50<br>38.1 | 2.00<br>50.8 | 2.00<br>50.8 | 2.75<br>69.8 |
| E-Handwheel Diameter |           | 4.00<br>102 | 4.00<br>102 | 4.75<br>121 | 5.75<br>146  | 7.00<br>178  | 8.00<br>203  | 9.75<br>248  | 7.00<br>178  | 8.00<br>203  | 8.00<br>203  | 9.75<br>248  |
| Weight               |           | 8.0<br>3.6  | 10.9<br>4.9 | 15.4<br>7.0 | 29.2<br>13.3 | 39.6<br>18.0 | 67.5<br>30.6 | 127<br>57.7  | 24.9<br>11.3 | 34.2<br>15.5 | 44.2<br>20.1 | 77.1<br>35.0 |

Valve flanges conform to ASME Standard B16.5 and end-to-end Dimensions conform to ASME Standard B16.10.

For Cv factors see page 123, Valve Matrix A. Refer to pages 116-120 for full materials description.

GATE CLASS 300 (PN 50) 363, 13363MMP, 32363, 368