

# DIMENSIONAL SPECIFICATIONS

LEAD-FREE DOMESTIC BRASS FITTINGS\* 125 LB.

## CROSS

Part #	Size (IN.)	Approx. Net WT. (LB.)	A	B
NL110-04	1/4	0.16	0.71	0.71
NL110-06	3/8	0.23	0.82	0.82
NL110-08	1/2	0.34	1.01	1.01
NL110-12	3/4	0.55	1.18	1.18
NL110-16	1	0.95	1.43	1.43
NL110-20	1-1/4	1.94	1.69	1.69
NL110-24	1-1/2	2.95	1.84	1.84
NL110-32	2	7.84	2.12	2.12

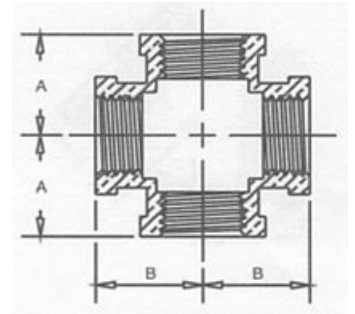

## CAP

Part #	Size (IN.)	Approx. Net WT. (LB.)	A
NL116-02	1/8	0.04	0.49
NL116-04	1/4	0.07	0.59
NL116-06	3/8	0.10	0.66
NL116-08	1/2	0.12	0.78
NL116-12	3/4	0.21	0.84
NL116-16	1	0.30	1.00
NL116-20	1-1/4	0.45	1.13
NL116-24	1-1/2	0.65	1.16
NL116-32	2	1.10	1.34
NL116-40	2-1/2	1.79	1.72
NL116-48	3	1.78	1.81
NL116-64	4	5.59	2.09

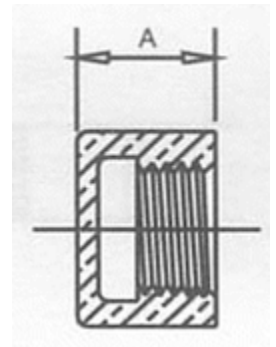

\*Conforms with lead content requirements for lead-free plumbing as defined by the U.S. Safe Drinking Water Act. Certified <0.25 weighted average % lead.



# MERIT BRASS

DIRECTING THE FLOW OF *Quality*