

# DIMENSIONAL SPECIFICATIONS

LEAD-FREE DOMESTIC BRASS FITTINGS\* 125 LB.

## 90 DEGREE ELBOW

Part #	Size (IN.)	Approx. Net WT. (LB.)	A	B
NL101-02	1/8	0.06	0.54	0.54
NL101-04	1/4	0.08	0.71	0.71
NL101-06	3/8	0.16	0.82	0.82
NL101-08	1/2	0.24	1.01	1.01
NL101-12	3/4	0.35	1.18	1.18
NL101-16	1	0.60	1.43	1.43
NL101-20	1-1/4	0.95	1.69	1.69
NL101-24	1-1/2	1.03	1.84	1.84
NL101-32	2	1.95	2.12	2.12
NL101-40	2-1/2	3.45	2.70	2.70
NL101-48	3	5.40	3.08	3.08
NL101-64	4	9.25	3.79	3.79
NL101-96	6	24.22	5.13	5.13

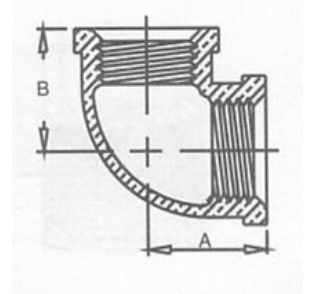

## 90 DEGREE STREET ELBOW

Part #	Size (IN.)	Approx. Net WT. (LB.)	A	B
NL103-02	1/8	0.06	0.55	0.92
NL103-04	1/4	0.11	0.72	1.11
NL103-06	3/8	0.17	0.83	1.24
NL103-08	1/2	0.23	1.03	1.51
NL103-12	3/4	0.35	1.19	1.66
NL103-16	1	0.50	1.43	1.98
NL103-20	1-1/4	0.85	1.71	2.26
NL103-24	1-1/2	1.15	1.87	2.46
NL103-32	2	1.98	2.14	2.98
NL103-40	2-1/2	3.15	2.74	3.92
NL103-48	3	5.26	3.10	4.45

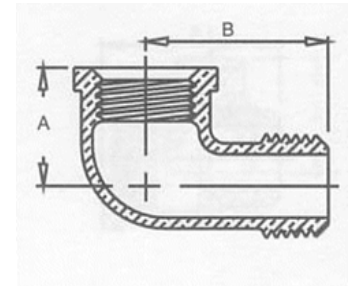

\*Conforms with lead content requirements for lead-free plumbing as defined by the U.S. Safe Drinking Water Act. Certified <0.25 weighted average % lead.



# MERIT BRASS

DIRECTING THE FLOW OF *Quality*