

DIMENSIONAL SPECIFICATIONS

LEAD-FREE DOMESTIC BRASS FITTINGS* 125 LB.

REDUCING COUPLING

Part #	Size (IN.)	Approx. Net WT. (LB.)	A
NL112-0604	3/8 X 1/4	0.09	0.92
NL112-0804	1/2 X 1/4	0.135	1.13
NL112-0806	1/2 X 3/8	0.16	1.17
NL112-1206	3/4 X 3/8	0.23	1.35
NL112-1208	3/4 X 1/2	0.25	1.35
NL112-1612	1 X 3/4	0.35	1.56
NL112-2012	1-1/4 X 3/4	0.62	1.77
NL112-2408	1-1/2 X 1/2	0.59	1.80
NL112-2412	1-1/2 X 3/4	0.65	1.80
NL112-2416	1-1/2 X 1	0.60	1.80
NL112-2420	1-1/2 X 1-1/4	0.75	1.80
NL112-3216	2 X 1	1.00	2.03
NL112-3220	2 X 1-1/4	1.05	2.03
NL112-3224	2 X 1-1/2	1.115	2.085
NL112-4032	2-1/2 X 2	1.71	3.25
NL112-4832	3 X 2	2.70	3.69
NL112-4840	3 X 2-1/2	3.33	3.69
NL112-6432	4 X 2	4.29	4.38

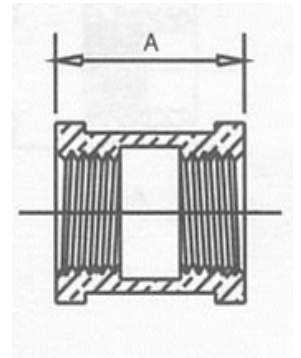

*Conforms with lead content requirements for lead-free plumbing as defined by the U.S. Safe Drinking Water Act. Certified <0.25 weighted average % lead.



MERIT BRASS

DIRECTING THE FLOW OF *Quality*