



Meets California Prop. 65
61<5
Drinking Water Standards



BRONZE & BRASS VALVES



American Valve, Inc
P.O. Box 35229
Greensboro, NC 27425
1.800.645.0101
www.americanvalve.com
sales@americanvalve.com

Brass Ball Valves

M100VL - Viperlok	1
M100	2
M100S	3
T200W	4
T200SW	4
T200C	4
T200BxB	4

Bronze Ball Valves

2A	5
----	---

Bronze Gate Valves

3/3F	6
3S/3FS	6
3FG	7
4FG	7
3R	7

Brass Gate Valves

M300	8
M300S	8
T300	9
T300S	9

Bronze Globe Valve

I3	10
----	----

Bronze Angle Valve

I4N	10
-----	----

Bronze Check Valves

3IF	11
3IFS	11

Brass Check Valves

M3I	12
M3IS	12
M3ISL	12

Bronze Gas Cocks

85CBK	13
86C	13
87CBK	13
88C	13

Bent Nose Garden Valves

M78	15
M78INV	15

Gas Ball Valves

M88C	15
------	----

Gas Appliance Connector Valves

M88CF	16
M88CF12	16
M88CF38A	16
M88CF58	16

Compression Stops

M50	17
M50S	17
M60	17
M60S-CSA	17
M60C	17

Boiler Drains

M75-CSA	18
M75C	18
M76	18

Sillcocks

M74	19
M74S	19

Frost Proof Sillcocks

M72AS	19
MVB	19

Hose Bibbs

M7I	20
M75NK	20
M75CNK	20
M75SNK	20
M76NK	20

Quarter-Turn Hose End Valves

M7IQT	21
M74QT	21
M74SQT	21
M76QT	21

Washing Machine & Utility Vavles

WMV	21
OPWMV	21
WMVCOMP	21
WMVFRONT	21
SV	21
ASTV	21

Chrome Plated Quarter-Turn Washing Machine Valves

WM75CQT	22
WM75CPVCQT	22
WM75PQT	22
WM75QT	22
WM76QT	22

Supply Stops

M63 Straight Pattern	23
M64/M65 Angle Pattern	23
M66 Dual Pattern	23

Bronze Radiator Valves

9	24
7	24
80	24
45	25
45S	25
46	25
46S	25

Bronze Circulator Valves

40	26
40S	26
41	26
41S	26
47	26
47S	26

Bronze Balancing Fittings

42	27
42S	27
43	27
43S	27
44S	27

INDUSTRY LEADING INNOVATION

OUR INDUSTRY LEADING TECHNOLOGY IS MAKING YOUR WATER SAFE.

Brass valves from American Valve are designed and monitored to minimize the impact of harmful chemicals on the health and safety of people and the environment. We offer a full array of brass and bronze valves certified to meet ANSI/NSF Standard 61 as well as California Proposition 65.

We start with the finest materials available. Our raw materials are carefully monitored to ensure proper chemical composition.

Every valve is tested for closing tightness and functionality to ensure safe, dependable operation.

Brass valves from American Valve meet the widest range of code approvals in the market. Our products are certified to USA and international standards by Underwriters Laboratories, CSA International, Factory Mutual, IAPMO, and the American Society of Sanitary Engineers.



M100VL VIPERLOK®

Push-Fit Ball Valve



- Fast, easy, versatile connection to multiple pipe materials



- Removal tool included with each valve

FEATURES:

- 100% Full Port Opening
- Solid Ball
- Push-Fit Ends
- For use with Copper, CPVC, and Pex* Pipe



Meets California Prop. 65
61<5
Drinking Water Standards

RATINGS:

200 psi non-shock water or air

Part	Material
Handle Nut	Stainless Steel
Handle	Steel
Packing	PTFE
Stem	Brass
Body	Brass
Ball	Brass (chrome plated)
Seat	PTFE
O-Ring	NBR
Liner	POM

DIMENSIONS:

		1/2	3/4	1
A	End to End	2 24/32	3 1/2	4 1/8
B	Center of Port to Top	1 15/32	1 25/32	2 1/4
C	Overall Height	3 1/4	3 31/32	4 24/32
	Weight	0.55	0.95	1.47

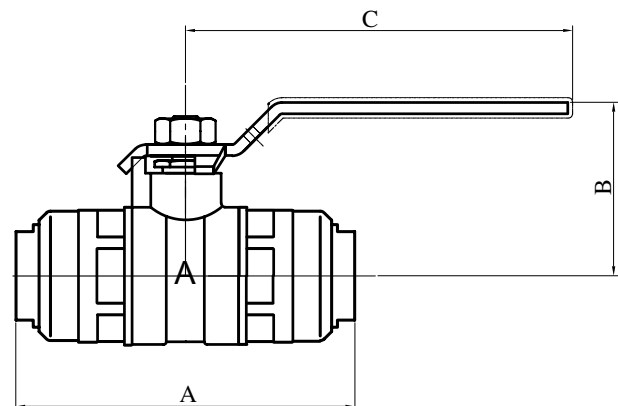

* Not for use with PEX-AL-PEX or PEX tubing with an oxygen barrier

M100

Brass Ball Valve

One valve does it all!



- CSA ½G, 5G, 125G gas ratings (½" -2")
- UL-listed for flammable liquids (¼" -2")
- FM for fire protection (½" -2")
- Conforms to MSS-SP-110

Part	Material
Handle Nut	Steel
Handle	Steel
Stem Gland Screw	Brass ASTM B-16
Packing	Teflon® (PTFE)
Stem	Brass ASTM B-16
Body	Forged/Cast Brass
Ball	Brass/Forged Brass (chrome Plated)

FEATURES:

- 100% Full Port Opening
- Solid Ball
- Threaded Ends
- Most versatile valve available
- Teflon® Seats
- Teflon® Packing

RATINGS:

150 psi WSP
600 psi WOG (400 WOG 2½-4")

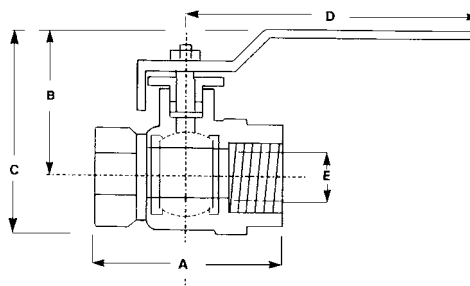

Options - T Handle
- Locking Handle

Pressure/Temperature Rating

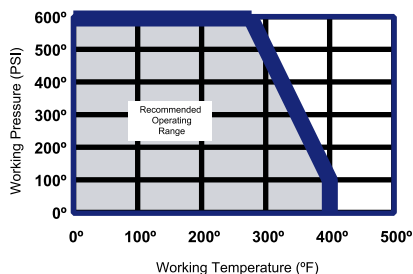

Meets California Prop. 65
61<5
Drinking Water Standards



DIMENSIONS:

		¼	⅜	½	¾	1	1 ¼	1 ½	2	2 ½	3	4
A	End to End	1 ⅞	1 ⅞	1 ⅞	2 ½	3	3 ⅞	3 ⅞	4 ¼	6	6 ½	7 ¾
B	Center of Port to Top	1 ¾	1 ¾	1 ⅞	2 ⅞	2 ¼	2 ⅞	2 ¾	3 ⅞	4 ¾	5 ⅞	6
C	Overall Height	2 ¼	2 ¼	2 ⅞	2 ⅞	3 ¼	3 ¾	4 ⅞	5	6 ⅞	7 ¼	9
D	Center of Valve to End of Handle	3 ½	3 ½	3 ⅞	4 ¾	4 ¾	5 ¼	5 ¼	5 ½	9 ⅞	9 ⅞	10 ½
E	Port Opening	⅜	⅜	⅞	¾	1	1 ¼	1 ½	2	2 ½	3	4
	Weight	0.3	0.3	0.45	0.8	1.2	2	2.7	3.25	7.85	8.65	16.3
	Approx. CV	12	12	20	42	78	132	207	346	470	590	670

M100S

Brass Ball Valve



FEATURES:

- 100% Full Port Opening
- Solid Ball
- Sweat Ends
- Teflon® Seats
- Teflon® Packing



RATINGS:

150 psi WSP
 600 psi WOG (400 WOG 2½-4")
 * Rating may be limited by strength of pipe connection

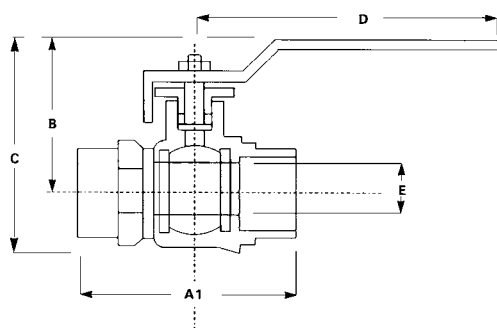

Part	Material
Handle Nut	Steel
Handle	Steel
Stem Gland Screw	Brass ASTM B-16
Packing	Teflon® (PTFE)
Stem	Brass ASTM B-16
Body	Forged/Cast Brass
Ball	Brass/Forged Brass (chrome plated)

DIMENSIONS:

		¾	1½	¾	1	1 ¼	1 ½	2	2 ½	3	4
A	End to End	1 ⅝	1 ⅞	2 ¾	3 ¼	4 ⅛	4 ¾	5 ¼	6 ⅝	7	9 ¼
B	Center of Port to Top	1 ½	1 ⅝	2	2 ⅝	2 ⅞	3 ⅛	3 ⅝	4 ⅛	4 ⅞	5 ⅝
C	Overall Height	1 ⅞	2 ⅛	2 ¾	3 ⅛	3 ¾	4 ¾	5 ⅛	6 ¼	7 ⅝	8 ⅝
D	Center of Valve to End of Handle	3 ⅝	3 ⅝	4 ⅝	4 ⅝	5 ⅝	5 ⅝	5 ⅝	8	9 ⅝	9 ⅝
E	Port Opening	¾	1½	¾	1	1 ¼	1 ½	2	2 ½	3	4
	Weight	0.3	.035	0.75	1.1	1.6	2.25	3.2	6.4	8.9	15.8
	Approx. CV	12	20	42	78	132	207	346	470	590	670

T200 Series Brass Ball Valves

FIGURE: T200W

- Threaded Ends
- Full Port
- Teflon® Seats
- Teflon® Packing
- Waste & Cap

RATING:
600 psi WOG



Meets California Prop. 65
61<5
Drinking Water Standards

FIGURE: T200SW

- Sweat Ends
- Full Port
- Teflon® Seats
- Teflon® Packing
- Waste & Cap

RATING:
600 psi WOG



Meets California Prop. 65
61<5
Drinking Water Standards

FIGURE: T200C

- Compression Ends
- Full Port
- Teflon® Seats
- Teflon® Packing

RATING:
400 psi WOG



Meets California Prop. 65
61<5
Drinking Water Standards

FIGURE: T200BXB

- Pex Ends
- Teflon® Seats
- Teflon® Packing

RATING:
400 psi WOG



Meets California Prop. 65
61<5
Drinking Water Standards

2A Bronze Ball Valves



- Made in USA
- Threaded Ends
- Teflon® Seats
- Teflon® Packing
- Blow-Out Proof Stem

RATING:
200 psi WSP
600 psi WOG

*Rating may be limited by strength of pipe connection

SPECIFICATIONS:
Fed. Spec. WW-V-35
Type 2 Class A



Meets California Prop. 65
61<5
Drinking Water Standards

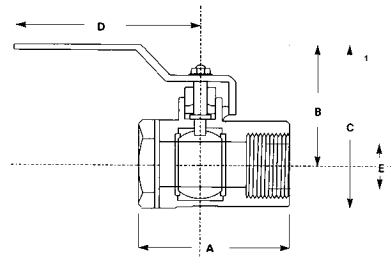

Pressure/Temperature Rating

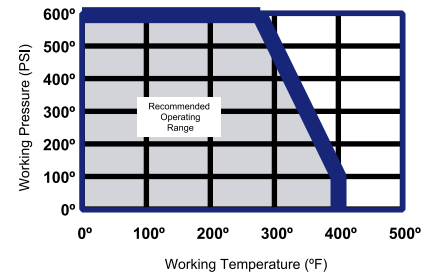

DIMENSIONS:

		1/2	3/4	1
A	End to End	1/2	11/16	7/8
B	Center of Port to Top	1 1/8	1 1/2	1 11/16
C	Overall Height	2 1/4	3	3 3/8
D	Center of Valve to End of Handle	1 3/4	2 1/8	2 1/4
E	Port Opening	3 7/8	4 7/8	4 7/8
	Weight	.63	1.39	1.72
	Approx. CV	15	25	40
	Operating Torque (in lbs.)	30	90	150

Part	Material
Handle Nut	Steel
Handle	Steel Zinc-Plated
Stem	ASTM B-16
Packing Nut	ASTM B-16
Packing	Teflon®
Retainer	ASTM B-16
Body	Bronze ASTM B-145
Bonnet	Bronze ASTM B-145
Seat	Teflon®
Ball	ASTM B-16 Chrome Plated

Bronze Gate Valves

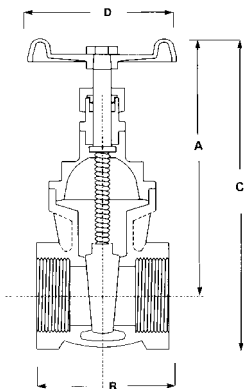

FIGURE: 3/3F

- Threaded Ends
- Non-rising Stem
- Solid Wedge Disc
- Teflon® Packing

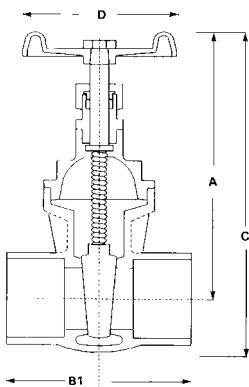

FIGURE: 3S/3FS

- Sweat Ends
- Non-rising Stem
- Solid Wedge Disc
- Teflon® Packing

Part	Material
Wheel Nut	Steel Zinc-Plated
Handlewheel	Cast Iron
Packing Nut	Bronze ASTM B-16
Gland	Bronze ASTM B-16
Packing	Teflon®
Stuffing Box	Bronze ASTM B-16
Bonnet	Bronze ASTM B-62
Stem	Silicon Bronze ASTM B-371
Disc	Bronze ASTM B-62
Body	Bronze ASTM B-62

SPECIFICATIONS:

MSS SP-80-1979
 Type 1 Class 125

Fed. Spec. WW-V-54D
 Type 1 Class A

RATINGS:

125 psi WSP
 200 psi WOG

DIMENSIONS:

	1/4	3/8	1/2	3/4	1	1 1/4	1 1/2	2	2 1/2	3	4
A	3 3/8	3 3/8	3 3/4	4 1/8	5	5 1/2	6	7 1/4	9 1/2	10	10 3/4
B	1 7/8	1 7/8	2	2 1/8	2 3/8	2 5/8	2 7/8	3 1/4	4 1/8	4 3/4	4 3/4
B1		1 3/4	1 7/8	2 1/16	2 3/4	2 7/8	3 1/16	3 3/4	4 3/4	5 1/2	7
C	3 3/4	3 3/4	4 3/8	4 7/8	6	6 3/4	7 3/8	8 7/8	11 1/2	13 7/8	13 1/2
D	2 1/8	2 1/8	2 1/8	2 3/8	2 3/4	3	3 1/4	3 3/4	4 1/2	5	6
Weight lbs. Thd.	.75	.75	.81	.94	1.5	2.06	2.81	4.25	9.19	15.8	20.0
Weight lbs. Swt.		.69	.71	.88	1.39	1.82	2.50	3.96	8.34	15.8	21.0

Bronze Gate Valves

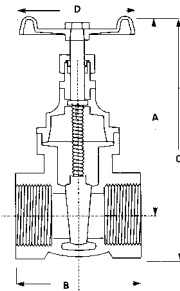

FIGURE: 3FG

- Threaded Ends
- Non-rising Stem
- Solid Wedge Disc
- Teflon® Packing

	1/2	3/4	1	1 1/4	1 1/2	2	2 1/2	3
A	3 7/8	4 1/2	5 1/8	5 3/4	6 1/4	7 3/8	8 1/2	10 1/4
B	1 7/8	2 1/8	2 5/8	2 7/8	3 1/8	3 3/8	4 1/8	4 3/4
C	4 3/8	5 1/8	6	6 7/8	7 3/8	8 3/4	10 1/2	12 1/2
D	2 1/8	2 1/2	2 5/8	3	3 1/2	4 1/8	4 1/2	5
Weight lbs. Thd.	.84	1.31	1.87	2.63	3.44	5.64	9.34	15.84

Part	Material
Wheel Nut	Steel Zinc-Plated
Handlewheel	Cast Iron
Packing Nut	Bronze ASTM B-16
Gland	Bronze ASTM B-16
Packing	Teflon®
Stuffing Box (3FG)	Bronze ASTM B-16
Bonnet	Bronze ASTM B-62
Stem	Silicon Bronze ASTM B-371
Disc	Bronze ASTM B-62
Body	Bronze ASTM B-62

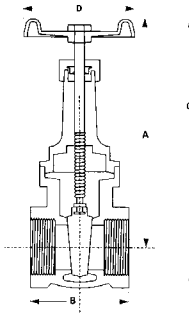

FIGURE: 4FG

- Threaded Ends
- Rising Stem
- Solid Slip-on Wedge Disc
- Teflon® Packing

	1/2	3/4	1	1 1/4	1 1/2	2
A	5 1/4	6 3/8	7 1/2	8 1/4	10 1/8	12 3/8
B	2	2 1/8	2 3/8	2 3/4	2 7/8	3 1/4
C	5 7/8	7 1/8	8 3/8	9 1/2	11 1/2	14
D	2 1/8	2 1/2	2 5/8	3	3 1/2	4 1/8
Weight lbs Thd.	1.14	1.50	2.71	3.38	4.75	7.19

SPECIFICATIONS:

MSS SP-80-1979
Type 1 Class 150

Fed. Spec. ww-V-54D
Type 1 Class B

RATINGS:

150 psi WSP
300 psi WOG

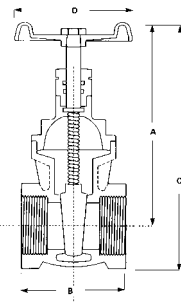

FIGURE: 3R
Pump and Underground

- Threaded Ends
- Non-rising Stem
- Solid Wedge Disc
- Double O-Ring Packing

RATING:
200 psi WOG

	1/2	3/4	1	1 1/4	1 1/2	2	2 1/2	3
A	3 3/4	4 1/8	5	5 1/2	6	7 1/4	9 1/2	10
B	2	2 1/8	2 3/8	2 5/8	2 7/8	3 1/4	4 1/8	4 3/4
C	4 3/8	4 7/8	6	6 3/4	7 3/8	8 7/8	11 1/2	13 7/8
D	2 1/8	2 3/8	2 3/4	3	3 1/4	3 3/4	4 1/2	5
Weight lbs.	.74	.94	2.00	2.00	2.81	4.25	9.19	15.84

Part	Material
Wheel Nut	Steel Zinc-Plated
Handlewheel	Cast Iron
Bonnet	Bronze ASTM B-145
Stem	Bronze ASTM B-16
Body	Bronze ASTM B-145
Disc	Bronze ASTM B-145
O-Ring	Buna N
O-Ring Gland	Bronze ASTM B-16

Recommended for cold water, oil, or gas. Specifically manufactured for pumping systems and installations where maintaining a line vacuum is essential. Operating nuts can be supplied upon request.

M300 Series

Brass Gate Valves - Full Port

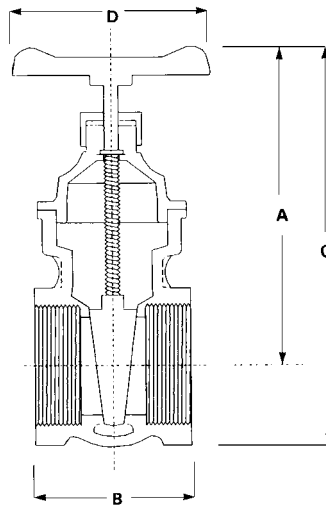

FIGURE: M300

- Full Port
- Threaded Ends
- Non-rising Stem
- Solid Wedge Disc

RATINGS:
200 psi WOG

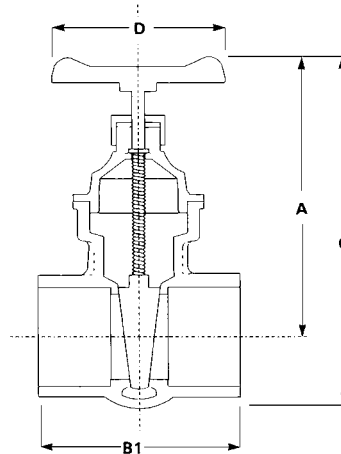

FIGURE: M300S

- Full Port
- Sweat Ends
- Non-rising Stem
- Solid Wedge Disc



DIMENSIONS:

		1/4	3/8	1/2	3/4	1	1 1/4	1 1/2	2	2 1/2	3	4
A	Center of Port to top	2 3/4	2 3/4	2 7/8	3 3/4	3 7/8	4 5/8	5	6	7 5/16	8 1/2	9 5/8
B	End to End	1 5/8	1 5/8	1 5/8	1 7/8	2 1/8	2 3/8	2 1/2	2 3/4	3 1/2	3 15/16	4 9/16
B1	End to End		1 1/2	1 3/4	2 5/16	2 3/4	2 7/8	3 1/4	3 7/8	4 5/8	5 1/4	
C	Overall Height	3 1/8	3 1/8	3 3/8	4	4 5/8	5 5/8	6	7 1/2	9 3/16	10 1/4	12 3/8
D	Wheel Diameter	2 1/8	2 1/8	2 1/8	2 1/8	2 3/8	3	3	3 1/4	4 1/8	5	6 3/4
	Weight lbs. Thd.	0.55	0.5	0.6	0.8	1.1	1.75	2.05	3.35	6.3	9.1	16.4
	Weight lbs. Swt.		0.5	0.55	0.75	1.1	1.65	1.9	3.15	5.75	8.85	

T300 Series

Brass Gate Valves - Compact

FIGURE: T300

- Threaded Ends
- Non-rising Stem
- Solid Wedge Disc
- Compact Design

RATINGS:

200 psi WOG

Meets California Prop. 65
61<5
 Drinking Water Standards

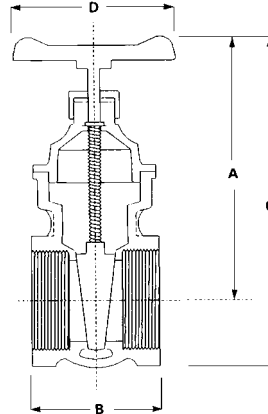

DIMENSIONS:

		1/2	3/4	1
A	Center of Port to top	2 5/8	2 13/16	3 5/16
B	End to End	1 5/8	1 11/16	1 7/8
C	Overall Height	3 1/4	3 1/2	4 1/8
D	Wheel Diameter	2 1/8	2 1/8	2 1/8
	Weight lbs.	0.5	0.6	0.85

FIGURE: T300S

- Sweat Ends
- Non-rising Stem
- Solid Wedge Disc
- Compact Design

Meets California Prop. 65
61<5
 Drinking Water Standards

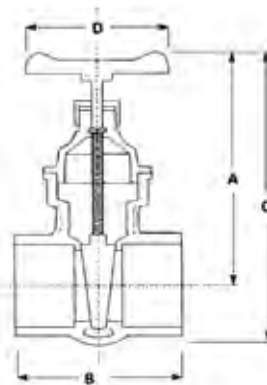

DIMENSIONS:

		1/2	3/4
A	Center of Port to top	2 11/16	2 13/16
B	End to End	1 5/8	2 1/8
C	Overall Height	3 1/8	3 3/8
D	Wheel Diameter	2 1/8	2 1/8
	Weight lbs.	.45	.55

13 Bronze Globe Valve

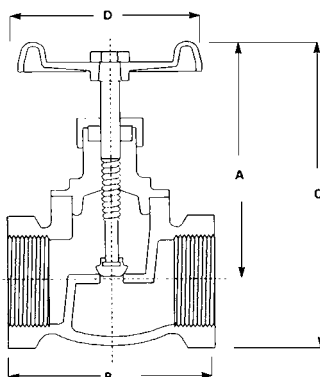

FIGURE: 13

- Threaded Ends
- Bronze Disc
- Teflon® Packing

RATINGS:

125 psi WSP
200 psi WOG

DIMENSIONS:

	1/4	3/8	1/2	3/4	1	1 1/4	1 1/2	2
A	2 3/4	2 3/4	3 1/4	3 5/8	4	4 1/2	5 1/4	6 3/8
B	1 3/4	1 3/4	2	2 1/2	2 7/8	3 3/8	3 3/4	4 1/2
C	3 1/4	3 1/4	3 7/8	4 3/8	4 7/8	5 5/8	6 1/2	8 1/8
D	2	2	2 1/8	2 3/8	2 3/4	3	3 1/4	3 3/4
Weight lbs.	.43	.40	.58	1.00	1.32	2.11	2.72	4.95

Part	Material
Wheel Nut	Steel
Handlewheel	Cast Iron
Packing Nut	Bronze ASTM B-16
Packing	Teflon®
Bonnet	Bronze ASTM B-145
Stem	Bronze ASTM B-16
Disc Lock Nut	Bronze ASTM B-16
Disc	Bronze ASTM B-16
Body	Bronze ASTM B-145

14N Bronze Angle Valve

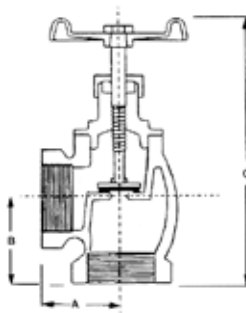

FIGURE: 14N

- Threaded Ends
- Neoprene Disc

RATING:

200 psi WOG

DIMENSIONS:

		1/4	3/8	1/2	3/4	1	1 1/4	1 1/2	2
A	Center of Inlet to Face of Outlet	27/32	15/16	1 3/32	1 7/32	1 15/32	1 3/4	2	2 11/32
B	Center of Outlet to Face of Inlet	27/32	15/16	1 3/32	1 7/32	1 15/32	1 3/4	2	2 11/32
C	Center of Port to Top (Closed)	2 3/4	3	3 1/4	3 5/8	4	4 1/2	5 1/4	6 1/2
D	Diameter of Wheel	1 3/4	1 3/4	2 1/32	2 3/8	2 3/4	3	3 23/32	3 23/32
	Weight lbs.	.44	.56	.69	.94	1.76	2.50	3.26	5.32

31F Series Bronze Check Valves

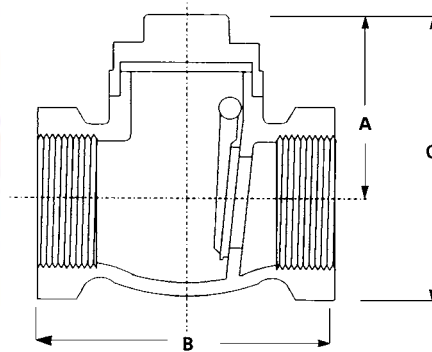

FIGURE: 31F

- Swing Check
- Threaded Ends
- Bronze Disc
- Side Plug

SPECIFICATIONS:
MSS-SP-80
Type 3 Class 125

Fed. Spec. WW-V-51
Type IV, Class A

RATINGS:
125 psi WSP
200 psi WOG

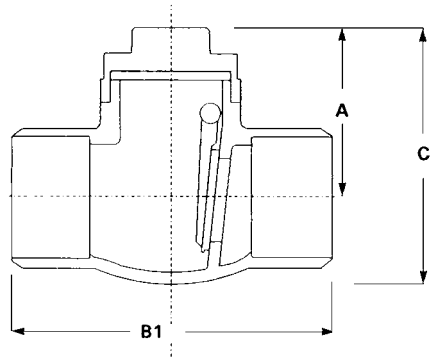

FIGURE: 31FS

- Swing Check
- Sweat Ends
- Bronze Disc
- Side Plug

DIMENSIONS:

	$\frac{3}{8}$	$\frac{1}{2}$	$\frac{3}{4}$	1	$1\frac{1}{4}$	$1\frac{1}{2}$	2	$2\frac{1}{2}$	3
A	$1\frac{5}{8}$	$1\frac{5}{8}$	$1\frac{11}{16}$	$2\frac{3}{16}$	$2\frac{11}{16}$	$3\frac{1}{16}$	$3\frac{3}{16}$	$3\frac{3}{8}$	$4\frac{1}{8}$
B	$2\frac{1}{2}$	$2\frac{1}{2}$	$2\frac{3}{4}$	$3\frac{1}{2}$	$3\frac{15}{16}$	$4\frac{1}{2}$	$4\frac{15}{16}$	6	$7\frac{1}{8}$
B1		$2\frac{7}{16}$	$3\frac{1}{8}$	$3\frac{5}{8}$	$4\frac{3}{16}$	$4\frac{3}{8}$	$4\frac{7}{8}$	7	$8\frac{3}{4}$
C	$2\frac{5}{16}$	$2\frac{5}{16}$	$2\frac{1}{2}$	$3\frac{1}{4}$	4	$4\frac{3}{8}$	$4\frac{15}{16}$	$5\frac{3}{8}$	$6\frac{1}{8}$
C1		$2\frac{1}{4}$	$2\frac{9}{16}$	$3\frac{1}{4}$	$3\frac{15}{16}$	$4\frac{5}{16}$	$4\frac{13}{16}$	$5\frac{3}{8}$	$6\frac{1}{8}$
Weight lbs. Thd.	.61	.61	.84	1.54	2.01	3.11	4.02	7.98	12.00
Weight lbs. Swt.		.53	.80	1.29	1.84	2.55	3.49	7.30	12.15

Part	Material
Nut	Bronze ASTM B-16
Cap	Bronze ASTM B-62
Hinge Pin	Bronze ASTM B-16
Plug	Bronze ASTM B-16
Hinge	Bronze ASTM B-16
Disc	Bronze ASTM B-16
Disc Ring	PTFE
Body	Bronze ASTM B-62

M31 Series Brass Check Valves

FIGURE: M31

- Swing Check
- Threaded Ends

RATINGS:

125 psi WSP
200 psi WOG

Meets California Prop. 65
61<5
Drinking Water Standards

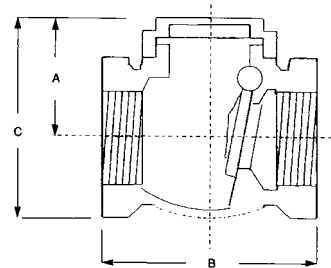
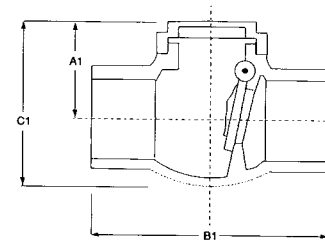

FIGURE: M31S

- Swing Check
- Sweat Ends

Meets California Prop. 65
61<5
Drinking Water Standards



DIMENSIONS:

		1/2	3/4	1	1 1/4	1 1/2	2	2 1/2	3	4
A	Center of Port to Top of Cap	1 1/2	1 5/8	1 3/4	2	2 1/4	2 5/8	2 7/8	3 1/4	3 7/8
A1	Center of Port to Top of Cap	1 3/8	1 1/2	1 7/8	2	2 1/4	2 3/4			
B	End to End	2	2 1/4	2 11/16	3 1/16	3 1/2	4 1/4	5 1/8	5 1/2	6 5/8
B1	End to End	2 3/8	3 1/8	3 1/2	4 3/16	4 1/2	5 3/8			
C	Overall Height	2 1/8	2 1/4	2 3/8	3	3 1/4	4	4 1/2	5 1/4	6 1/2
C1	Overall Height	2	2 1/4	2 5/8	3	3 3/8	4			
	Weight lbs. Thd.	1/3	.55	.8	1.1	1.45	2.35	4.35	5.5	9.4
	Weight lbs. Swt.	.4	.55	.85	1.25	1.6	2.4			

FIGURE: M31SL

- Inline Check
- Spring-loaded
- Threaded Ends
- May be used vertically or horizontally
- Stainless Steel spring

RATINGS:

200 psi WOG

Meets California Prop. 65
61<5
Drinking Water Standards



DIMENSIONS:

	3/4	1	1 1/4
End to End	2 11/16	3 3/16	3 5/8
Center of Port to Top	3/4	7/8	1 1/16
Over all Height	1 1/2	1 3/4	2 1/8
Weight lbs.	0.6	0.9	1.3

BRONZE GAS COCKS

FIGURE: 85CBK

- Square Head
- Double Nut
- With Check
- Massachusetts State Gas Board Approved

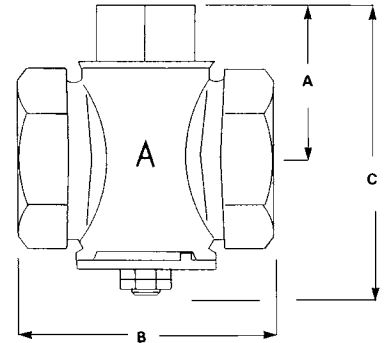

FIGURE: 86C

- Flat Head
- Double Nut
- With Check

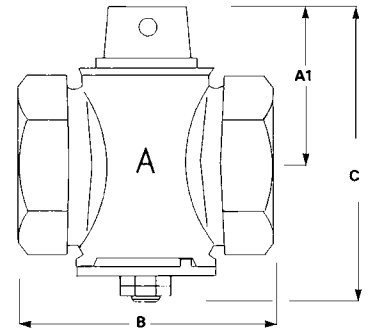

FIGURE: 87CBK

- Tee Handle
- Double Nut
- With Check
- Massachusetts State Gas Board Approved

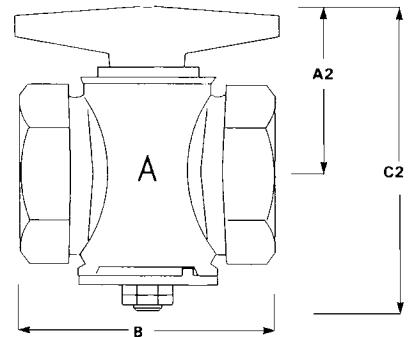
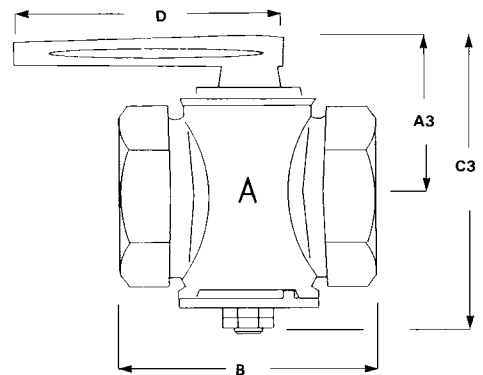

FIGURE: 88C

- Lever Handle
- Double Nut
- With Check



*Please see dimensions and specifications on next page

BRONZE GAS COCKS

DIMENSIONS:

		1/4	3/8	1/2	3/4	1	1 1/4	1 1/2	2
A	Center of Port to Top	1 7/16	1 7/16	1 7/16	1 1/2	1 1/2	2 1/4	2 11/16	3
A1	Center of Port to Top	1 3/8	1 3/8	1 3/8	1 5/8	1 5/8	2 1/4	2 5/8	2 7/8
A2	Center of Port to Top	1 3/16	1 7/16	1 7/16	1 11/16	1 11/16	2 5/8	3 1/4	3 7/16
A3	Center of Port to Top	1 5/8	1 5/8	1 5/8	2 1/4	2 1/4			
B	End to End	2 1/8	2 1/8	2 1/8	2 3/8	2 5/8	3 1/16	3 1/2	4 1/4
C	Overall Height	2 11/16	2 11/16	2 11/16	2 15/16	2 15/16	4 1/16	4 13/16	5 5/8
C1	Overall Height	2 11/16	2 11/16	2 11/16	3	3	4 1/8	4 13/16	5 9/16
C2	Overall Height	2 11/16	2 11/16	2 11/16	3 1/8	3 1/8	4 7/16	5 7/16	6 1/8
C3	Overall Height	2 13/16	2 13/16	2 13/16	3 1/2	3 1/2			
D	Handle Length	1 7/8	1 7/8	1 7/8	2 1/8	2 1/8			
	Weight lbs. 86C	.48	.43	.45	.79	.79	1.8	2.8	3.86
	Weight lbs. 85CBK	.51	.46	.47	.83	.83	1.81	2.80	4.00
	Weight lbs. 87CBK	.48	.44	.47	.81	.81	1.84	2.80	4.70
	Weight lbs. 88C	.52	.49	.51	.92	.92			

Specifications for manually operated low-pressure gas cocks:
Figures: 85CBK, 87CBK, 88C, 86C

	1/4	3/8	1/2	3/4	1	1 1/4	1 1/2	2
Test Pressure	100 psi	100 psi	100 psi	100 psi	100 psi	100 psi	100 psi	100 psi
Max. Line Pressure	12 psi	12 psi	12 psi	12 psi	12 psi	12 psi	12 psi	12 psi
Min. Capacity-BTU/Hr. (1000 BTU per Cu. FT. Gas)	216,000	216,000	260,000	698,000	1,192,000	1,768,000	3,097,000	5,346,000
Lineal & Circumferential Seal	7/64	7/34	7/64	7/64	1/8	5/32	7/32	5/16
Bearing Surface	15/64	15/64	15/64	15/64	1/4	9/32	11/32	13/32
Plug Take-Up	3/64	3/64	3/64	3/64	5/64	5/64	5/64	5/64
Shoulder Distance	7/16	1/2	9/16	5/8	3/4	13/16	13/16	7/8
Minimum Breakage Weight from Extreme Outlet End	65 lbs.	80	100	125	150	175	200	225
Minimum Turning Effort on Thread	157 in. lbs.	225	300	450	600	700	750	950
Minimum Impact Breaking Point	10ft lbs.	15	20	20	20	30	30	30
Minimum Static Load	40 lbs.	40	40	42.5	45	47.5	62.5	85
Maximum Torque	15 in. lbs.	20	25	35	45	60	80	100
# Threads Per Inch	18	18	14	14	11 1/2	11 1/2	11 1/2	11 1/2
Length of Thread	.4051	.4070	.5337	.5457	.6828	.7068	.7235	.7565
Height of Thread	.04444	.04444	.05714	.05714	.06957	.06957	.06957	.06957
Pitch of Thread	.05556	.05556	.07143	.07143	.08696	.08696	.08696	.08696

BENT NOSE GARDEN VALVES

FIGURE: M78

- Bent Nose
- Garden Valve

Meets California Prop. 65
61<5
Drinking Water Standards

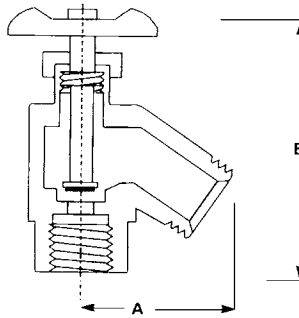

DIMENSIONS:

		1/2	3/4	1
A	Center of Inlet to Face of Hose Connection	1 7/8	1 7/8	1 7/8
B	Center of Port to Top of Stem	4 1/4	4 1/4	4 3/8
	Weight lbs.	.43	.48	.51

FIGURE: M78INV

- Bent Nose
- Garden Valve

Meets California Prop. 65
61<5
Drinking Water Standards

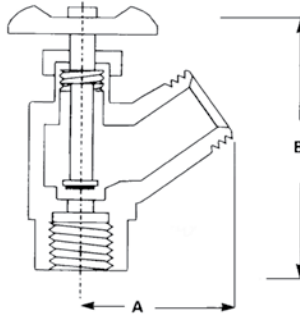

DIMENSIONS:

		1/2	3/4	1
A	Center of Inlet to Face of Hose Connection	1 7/8	1 7/8	1 7/8
B	Center of Port to Top of Stem	4 1/4	4 1/4	4 3/8
	Weight lbs.	.43	.48	.51

GAS BALL VALVES

FIGURE: M88C

- Lever Handle with check

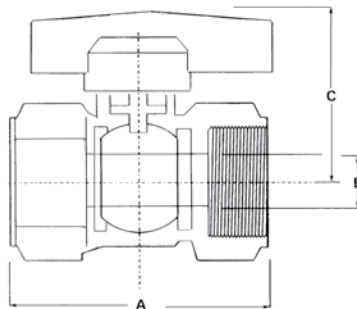

Certified by CSA International to AGA & CGA Standards for Manual gas valves.

Approved in the commonwealth of Massachusetts by the State Board of Examiners of Plumbers and Gas Fitters.



Meets California Prop. 65
61<5
Drinking Water Standards



SPECIFICATIONS:

Tested under ANSI Standards Z21.15 1979 and Z21.15a 1981

		3/8	1/2	3/4	1	1 1/4	1 1/2	2
A	End to End	1 3/4	2 3/16	2 3/8	2 7/8	3 3/8	3 3/4	4 1/8
B	Port Opening	5/16	15/32	19/32	25/32	1 1/4	1 1/2	2
C	Center of Port to Top of Handle	1 1/4	1 11/16	1 3/4	1 3/4	2 2/3	2 13/16	3 3/8
	Capacity (BTU/Hr)	120,000	295,000	795,000	1,240,000			
	Weight lbs.	.38	.43	.55	.93	1.4	2.9	

M88CF Series

Gas Ball Appliance Connector Valves

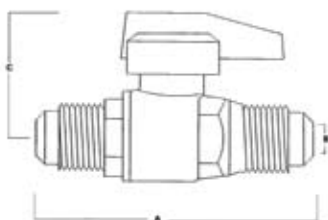

Figure: M88CF		3/8	1/2
		3/8 Flare 5/8-18 Thread	1/2 Flare 3/4-16 Thread
A	End to End	2 5/8	2 13/16
B	Port Opening	5/16	5/16
C	Center of Port to Top	1 1/4	1 1/4
	Capacity (BTU/Hr)	103,000	339,000
	Weight lbs.	.29	.36

- IPS Threaded Ends
- Flare Fitting
- Chrome Plated Ball
- 1/4 Turn to open
- Teflon Seat

SPECIFICATIONS:
 Tested under ANSI
 Standards Z21.15 1979
 and Z21.15a 1981

Approved in the Commonwealth of Massachusetts by the State Board of Examiners of Plumbers and Gas Fitters

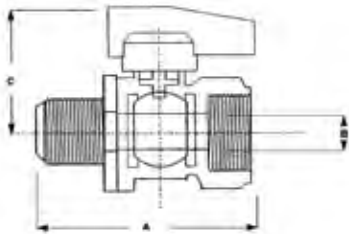
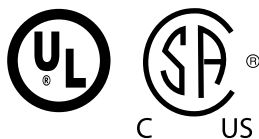

Figure: M88CF12		1/2 IPS x 1/2 Flare 3/4-16 Thread
A	End to End	2 1/2
B	Port Opening	3/8
C	Center of Port to Top	1 5/16
	Capacity (BTU/Hr)	301,000
	Weight lbs.	.36

Figure: M88CF38A		1/2 IPS x 3/8 Flare 5/8-18 Thread
A	End to End	2 1/2
B	Port Opening	3/8
C	Center of Port to Top	1 5/16
	Capacity (BTU/Hr)	301,000
	Weight lbs.	.36

Figure: M88CF58		3/4 IPS x 5/8 Flare 1 5/16 - 16 Thread
A	End to End	2 1/2
B	Port Opening	3/8
C	Center of Port to Top	1 5/16
	Capacity (BTU/Hr)	301,000
	Weight lbs.	.36

COMPRESSION STOPS

FIGURE: M50

- Stop
- Threaded Ends

Meets California Prop. 65
61<5
Drinking Water Standards

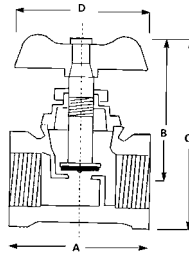

		1/2	3/4
A	End to End	2 1/8	2 3/16
B	Center of Port to Top of Stem	Open	2 11/16
		Closed	2 7/16
C	Overall Height	Open	3 1/4
		Closed	3
D	Diameter of Wheel	2	2
	Weight lbs.	.53	.60

FIGURE: M50S

- Stop
- Sweat Ends

Meets California Prop. 65
61<5
Drinking Water Standards

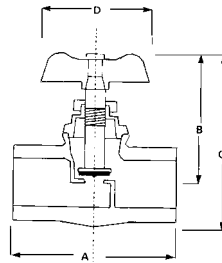

		1/2	3/4
A	End to End	2 3/16	2 3/4
B	Center of Port to Top of Stem	Open	2 3/4
		Closed	2 1/2
C	Overall Height	Open	3 1/4
		Closed	3
D	Diameter of Wheel	2	2
	Weight lbs.	.45	.51

FIGURE: M60

- Stop & Waste
- Threaded Ends

Meets California Prop. 65
61<5
Drinking Water Standards

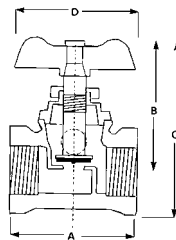

		1/2	3/4
A	End to End	2 1/8	2 3/16
B	Center of Port to Top of Stem	Open	2 11/16
		Closed	2 7/16
C	Overall Height	Open	3 1/4
		Closed	3
D	Diameter of Wheel	2	2
	Weight lbs.	.53	.60

FIGURE: M60S-CSA

- Stop & Waste
- Sweat Ends

Meets California Prop. 65
61<5
Drinking Water Standards

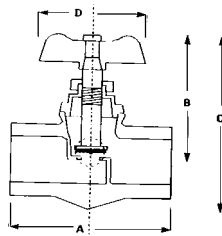

		1/2	3/4
A	End to End	2 3/16	2 3/4
B	Center of Port to Top of Stem	Open	2 3/4
		Closed	2 1/2
C	Overall Height	Open	3 1/4
		Closed	3
D	Diameter of Wheel	2	2
	Weight lbs.	.46	.52

FIGURE: M60C

- Stop & Waste
- Compression Ends

Meets California Prop. 65
61<5
Drinking Water Standards

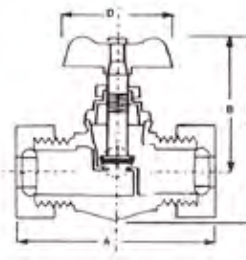

		1/2	3/4
A	End to End	2 7/8	3 1/4
B	Center of Port to Top of Stem	Open	2 11/16
		Closed	2 7/16
C	Overall Height	Open	3 1/4
		Closed	3
D	Diameter of Wheel	2	2
	Weight lbs.	.625	.75

BOILER DRAINS

FIGURE: M75-CSA

- Deluxe Pattern
- With Stuffing Box
- 1/2": Duo Pattern-Sweat and IPS
- 3/4": IPS Only

Meets California Prop. 65
61<5
Drinking Water Standards

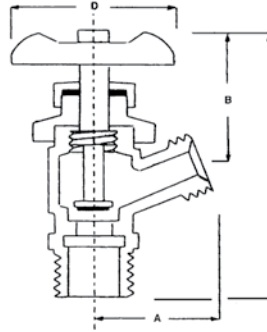

DIMENSIONS:

		1/2	3/4
A	Center of Inlet to Face of Hose Connection	1 5/8	1 5/8
B	Center of Port to Top of Stem	2	2 1/8
C	Overall Height	3 1/2	3 5/8
D	Diameter of Wheel	2	2
	Weight lbs.	.44	.48

*Also available as M75S CSA 3/4" Sweat

FIGURE: M75C

- Full Pattern
- With Stuffing Box
- Compression End

Meets California Prop. 65
61<5
Drinking Water Standards

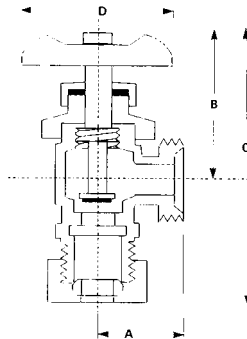

DIMENSIONS:

		1/2
A	Center of Inlet to Face of Hose Connection	2 1/16
B	Center of Port to Top of Handwheel	3 1/4
C	Overall Height	1 15/16
D	Diameter of Wheel	2
	Weight lbs.	.37

FIGURE: M76

- Full Pattern
- With Stuffing Box
- Female Thread

Meets California Prop. 65
61<5
Drinking Water Standards

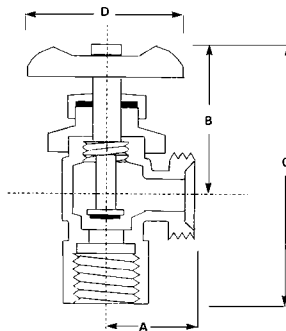

DIMENSIONS:

		1/2	3/4
A	Center of Inlet to Face of Hose Connection	1 1/4	1 1/4
B	Center of Port to Top of Handwheel	2 3/8	2 3/8
C	Overall Height	3 7/16	3 11/16
D	Diameter of Wheel	2	2
	Weight lbs.	.44	.48

SILLCOCKS

FIGURE: M74

- FIP Threaded Inlet

Meets California Prop. 65
61<5
Drinking Water Standards

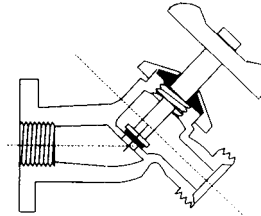

DIMENSIONS:

		1/2	3/4
A	End to End	2 3/4	2 3/4
B	Overall Height	3 1/4	3 1/4
C	Diameter of Wheel	2	2
	Weight lbs.	.48	.49

FIGURE: M74S

- Sweat End

Meets California Prop. 65
61<5
Drinking Water Standards

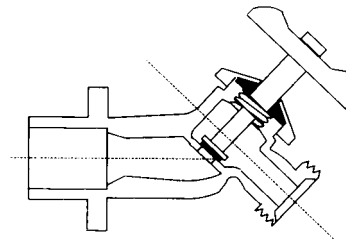

DIMENSIONS:

		1/2	3/4
A	End to End	3 1/4	3 3/8
B	Overall Height	3 1/4	3 1/4
C	Diameter of Wheel	2	2
	Weight lbs.	.51	.52

FROST PROOF SILLCOCKS

FIGURE: M72AS

- 1/2" Sweat x 1/2" IPS Male
- Anti-Siphon
- ASSE certified 1019
- Built-in Vacuum Breaker

Meets California Prop. 65
61<5
Drinking Water Standards

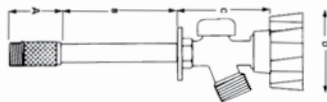

DIMENSIONS:

	4	6	8	10	12	14
A	2	2	2	2	2	2
B	4	6	8	10	12	14
C	2 1/4	2 1/4	2 1/4	2 1/4	2 1/4	2 1/4
D	2 1/4	2 1/4	2 1/4	2 1/4	2 1/4	2 1/4
Weight lbs.	.88	1.00	1.10	1.13	1.25	1.28

FIGURE: MVB

- Hose Connection Vacuum Breaker

Meets California Prop. 65
61<5
Drinking Water Standards



FIGURE: TMVB2

- Hose Connection Vacuum Breaker
- Automatically Drains When Hose is Removed

Meets California Prop. 65
61<5
Drinking Water Standards



HOSE BIBBS

FIGURE: M71

- Deluxe Pattern
- With Stuffing Box
- 1/2": Duo Pattern-Sweat and IPS
- 3/4": IPS Only

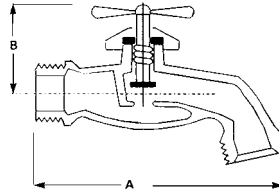

DIMENSIONS:

		1/2	3/4
A	Inlet to Center of Hose Connection	3 3/8	3 3/8
B	Center of Inlet to Top	2	2
	Weight lbs.	.43	.48

FIGURE: M75NK

- Male Thread
- No Kink

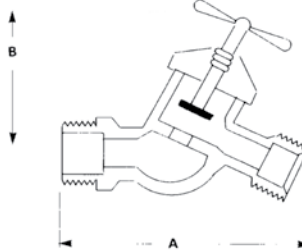

DIMENSIONS:

		1/2	3/4
A	Inlet to Center of Hose Connection	2 1/2	2 5/8
B	Center of Inlet to Top	2 3/8	2 3/8
	Weight lbs.	.43	.48

FIGURE: M75CNK

- Compression
- No Kink

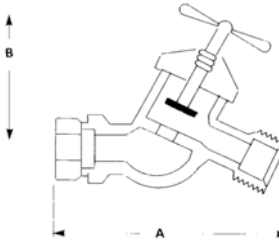

		1/2
A	Inlet to Center of Hose Connection	3
B	Center of Inlet to Top	2 3/8
	Weight lbs.	.43

FIGURE: M75SNK

- 1/2 x 3/4 Sweat
- No Kink

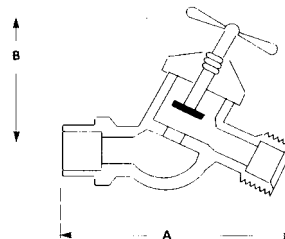

DIMENSIONS:

A	Inlet to Center of Hose Connection	2 5/8
B	Center of Inlet to Top	2 3/8
	Weight lbs.	.42

FIGURE: M76NK

- Female Threaded
- Male Thread

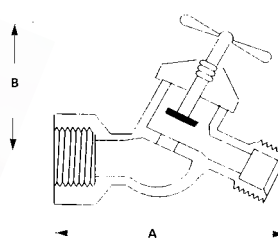

DIMENSIONS:

		1/2	3/4
A	Inlet to Center of Hose Connection	2 1/2	2 5/8
B	Center of Inlet to Top	2 3/8	2 3/8
	Weight lbs.	.42	.46

QUARTER-TURN HOSE END VALVES

FIGURE: M71QT

- Duo Inlet: 1/2" Solder/ MIP Thread
- Ball valve design for reliability
- Full port for maximum flow

Meets California Prop. 65
61<5
Drinking Water Standards



FIGURE: M74QT

- FIP Threaded Inlet
- Sill Flange

Meets California Prop. 65
61<5
Drinking Water Standards



FIGURE: M76QT

- Female Threaded
- FIP Threaded Inlet

Meets California Prop. 65
61<5
Drinking Water Standards



FIGURE: M74SQT

- Sweat Inlet
- Sill Flange

Meets California Prop. 65
61<5
Drinking Water Standards



WASHING MACHINE & UTILITY VALVES

FIGURE: WMV

- Single Lever Control
- Easy to Operate
- Fits any Standard Valve Box



FIGURE: OPWMV

- Top Operated
- 1/2" MIP Inlet
- Female Hose Outlet
- Nickel Plated



FIGURE: WMVCOMP

- Compression Inlet
- Hose Outlet
- Nickel Plated
- Tee Handle



FIGURE: WMVFRONT

- Front Operated
- 1/2" FIP Inlet
- Hose Outlet
- Nickel Plated



FIGURE: SV

- Self Closing
- With Handy Pull-chain
- Durable Chrome Finish



FIGURE: ASTV

- 2 Hot/Cold Inlets
- 1 Mixed Outlet (1/2" IPS)
- Adjustable
- Not for Drinking Water Systems



CHROME PLATED QUARTER-TURN WASHING MACHINE VALVES

FIGURE: WM75CQT

- Quarter Turn
- Compact
- Compression Inlet

Meets California Prop. 65
61<5
 Drinking Water Standards



FIGURE: WM75CPVCQT

- Quarter Turn
- Compact
- CPVC Inlet

Meets California Prop. 65
61<5
 Drinking Water Standards



FIGURE: WM75PQT

- Quarter Turn
- Compact
- Pex Inlet

Meets California Prop. 65
61<5
 Drinking Water Standards



FIGURE: WM75QT

- Quarter Turn
- Compact
- Male IPS Inlet

Meets California Prop. 65
61<5
 Drinking Water Standards



FIGURE: WM76QT

- Quarter Turn
- Compact
- Female IPS Inlet

Meets California Prop. 65
61<5
 Drinking Water Standards



SUPPLY STOPS

Straight Pattern:



Fig.	Size
M63	3/8" IPS x 3/8" Compression
M63	1/2" IPS x 3/8" Compression
M63S	1/2" CxC x 3/8" Compression
M63C	5/8" Comp. x 3/8" Comp.
M63P	1/2" PEX x 3/8" Compression
M63PP	1/2" PEX x 1/2" PEX
M63CPVC	1/2" CPVC x 3/8" Comp.

Specifications:

CSA B125-93
IAPMO/UPC ASME
4A112.18M

- Chrome Plated
- Quarter Turn
- Angle
- Straight
- Dual Outlet

Angle Pattern:



Fig.	Size
M64	3/8" IPS x 3/8" Compression
M64	1/2" IPS x 3/8" Compression
M64S	1/2" CxC x 3/8" Compression
M64C	5/8" Comp. x 3/8" Comp.
M64P	1/2" PEX x 3/8" Compression
M64CPVC	1/2" CPVC x 3/8" Comp.
M65	1/2" IPS x 1/4" Compression
M65S	1/2" CxC x 1/4" Compression
M65C	5/8" Comp. x 1/4" Comp.
M65P	1/2" PEX x 1/4" Compression
M65CPVC	1/2" CPVC x 1/4" Comp.



Meets California Prop. 65
61<5
Drinking Water Standards



Dual Pattern:



Fig.	Size
M66	1/2" IPS x 3/8" Comp. x 3/8" Comp.
M66-14	1/2" IPS x 3/8" Comp. x 1/4" Comp.
M66C	5/8" x 3/8" x 3/8" Compression
M66C-14	5/8" x 3/8" x 1/4" Compression

BRONZE RADIATOR VALVES

For steam and hot water systems

FIGURE: 9

- Steam Angle Valve
- Rising Stem
- Renewable Packing
- Composition Disc
- Composition Wheel

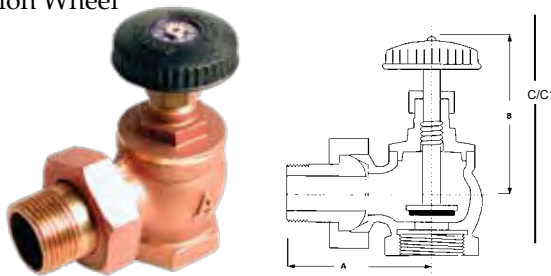

DIMENSIONS:

		1/2	3/4	1	1 1/4	1 1/2	2
A	Center of Inlet to Face	2 5/16	2 9/16	3	3 5/8	3 3/4	4 1/2
B	Center of Port to Top (open)	3 9/16	3 3/16	3 3/8	3 1/2	3 3/4	4 7/8
C	Total Height Closed	3 7/8	3 7/8	4 1/8	4 9/16	4 3/4	5 7/8
C1	Total Height Open	4 1/2	4 1/4	4 3/4	5 1/4	5 3/8	7 1/16
	Weight lbs.	.86	1.24	1.78	2.48	3.08	4.86

FIGURE: 7

- Radiator Gate
- Non-Rising Stem
- Solid Wedge
- Composition Wheel

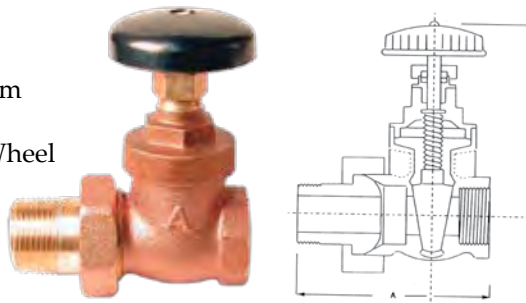

DIMENSIONS:

		1/2	3/4	1	1 1/4	1 1/2
A	End to End	3 1/8	3 1/4	3 7/8	4 1/16	4 11/16
B	Center of Port to Top	3 1/2	3 13/16	4 5/8	5	5 7/8
	Weight lbs.	1.05	1.25	1.90	2.50	4.10

FIGURE: 80

- Convector Female Angle
- Rising Stem
- Renewable Composition Disc
- Composition Wheel
- Female Union Inlet

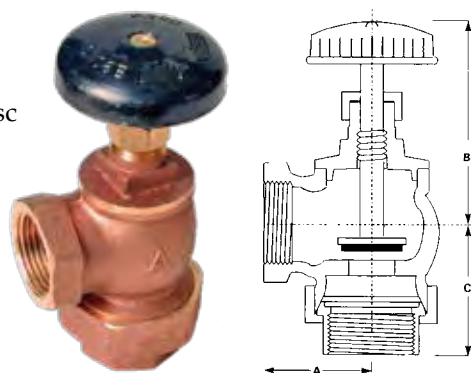

DIMENSIONS:

		1	1 1/4
A	Center of Inlet to Face	1 3/4	1 3/4
B	Center of Port to Top	3 1/2	3 3/4
C	Center of Port to Inlet	2 11/16	2 15/16
	Weight lbs.	1.96	2.35

BRONZE RADIATOR VALVES

For gravity and hot water heating systems

FIGURE: 45

- Hot Water Angle Valve
- Screwed Connection
- Composition Wheel

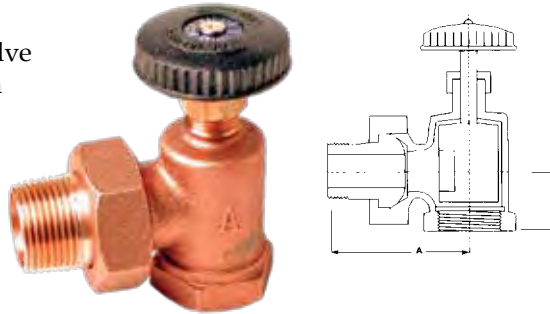

DIMENSIONS:

	1/2	3/4	1	1 1/4
A	2 3/16	2 1/2	2 7/8	3 1/8
B	1 1/8	1 5/16	1 7/16	1 5/8
Weight lbs.	.75	1.10	1.45	2.25

FIGURE: 45S

- Hot Water Angle Valve
- Sweat Connection
- Composition Wheel

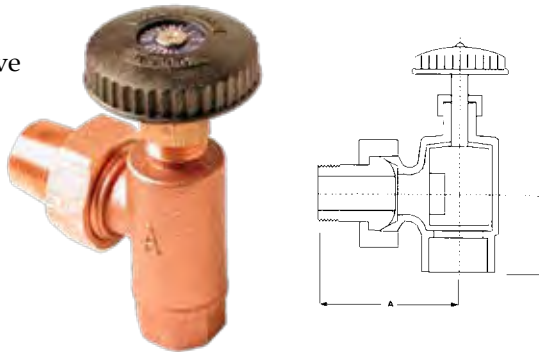

DIMENSIONS:

	1/2	3/4
A	2 1/8	2 7/16
B	1 1/8	1 3/8
Weight lbs.	.72	1.20

FIGURE: 46

- Hot Water Union Elbow
- Screwed Connection

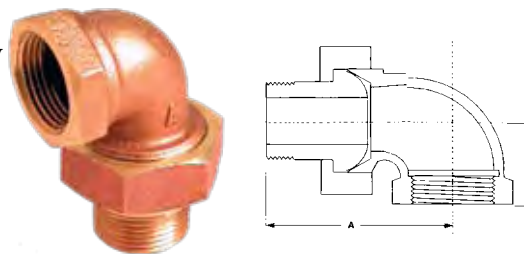

DIMENSIONS:

	1/2	3/4	1	1 1/4
A	2 5/16	2 1/2	2 13/16	3 13/16
B	1 1/8	1 1/4	1 1/2	1 3/4
Weight lbs.	.42	.65	.92	1.52

FIGURE: 46S

- Hot Water Union Elbow
- Sweat Connection

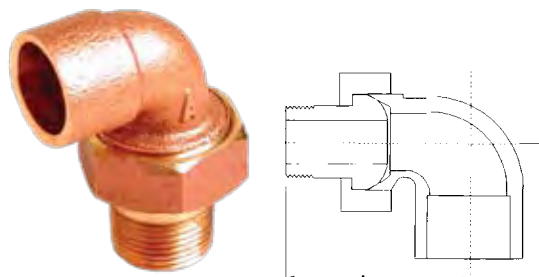

DIMENSIONS:

	1/2	3/4
A	2	2 1/4
B	1 3/16	1 3/8
Weight lbs.	.32	.55

BRONZE CIRCULATOR VALVES

For forced hot water heating systems

FIGURE: 40

- Angle
- Male Union
- Threaded End

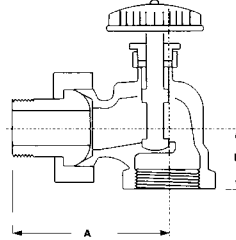

DIMENSIONS:

	1/2	3/4
A	2 3/8	2 13/16
B	1 1/4	1 1/2
Weight lbs.	.75	1.1

FIGURE: 40S

- Angle
- Male Union
- Sweat End

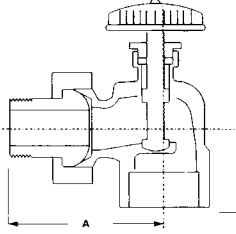

DIMENSIONS:

	1/2	3/4
A	2 3/8	2 3/4
B	1 1/4	1 1/2
Weight lbs.	.75	1.1

FIGURE: 41

- Straight
- Male Union
- Threaded End

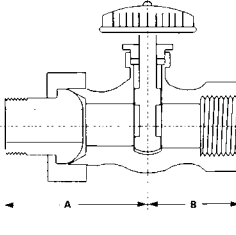

DIMENSIONS:

	1/2	3/4
A	2	2 3/16
B	1	1 1/8
Weight lbs.	.70	1.05

FIGURE: 41S

- Straight
- Male Union
- Sweat End

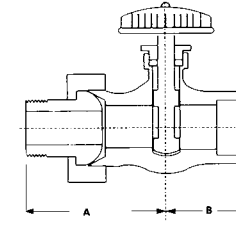

DIMENSIONS:

	1/2	3/4
A	2	2 1/4
B	1	1 1/4
Weight lbs.	.70	1.05

FIGURE: 47

- Reverse Angle
- Male Union
- Threaded End

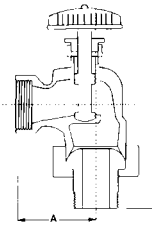

DIMENSIONS:

	1/2	3/4
A	1 3/8	1 5/8
B	2 1/4	2 11/16
Weight lbs.	.75	1.10

FIGURE: 47S

- Reverse Angle
- Male Union
- Sweat End

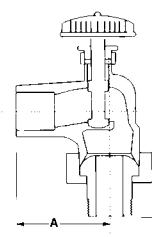

DIMENSIONS:

	1/2	3/4
A	1 7/16	1 7/8
B	2 1/4	2 1/2
Weight lbs.	.75	1.10

BRONZE BALANCING FITTINGS

For forced hot water heating systems

FIGURE: 42

- Elbow Fitting
- Male Union
- Threaded End

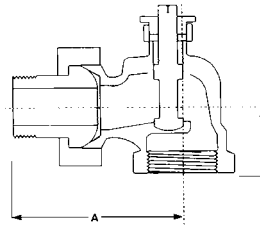

DIMENSIONS:

	1/2	3/4
A	2 3/8	2 13/16
B	1 1/4	1 1/2
Weight lbs.	.75	1.10

FIGURE: 42S

- Elbow Fitting
- Male Union
- Sweat End

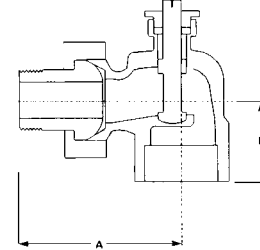

DIMENSIONS:

	1/2	3/4
A	2 3/8	2 3/4
B	1 1/4	1 11/16
Weight lbs.	.75	1.10

FIGURE: 43

- Straight Fitting
- Male Union
- Threaded End

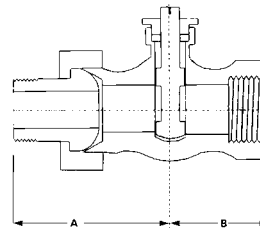

DIMENSIONS:

	1/2	3/4
A	2	2 3/16
B	1	1 1/8
Weight lbs.	.60	.95

FIGURE: 43S

- Straight Fitting
- Male Union
- Sweat End

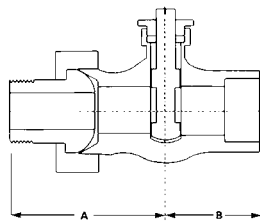

DIMENSIONS:

	1/2	3/4
A	2	2 1/4
B	1	1 1/4
Weight lbs.	.60	.95

FIGURE: 44S

- Straight Fitting
- No Union
- Sweat Ends

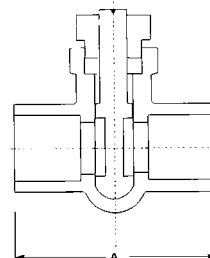

DIMENSIONS:

	1/2	3/4
A	1 15/16	2 7/16
Weight lbs.	.35	.55

AMERICAN VALVE TERMS & CONDITIONS

SELLING POLICY

The possession of this catalog and or price lists by any person is not to be construed as an offer to sell him or anyone, the items listed herein at the price indicated. We reserve the right to limit quantities and accept all orders subject to our ability to fill. Our minimum order is \$100 net.

We will acknowledge the receipt of your order; however our acknowledgment does not constitute an agreement to fulfill or ship same in any specified time or at prices other than those in effect at the time of shipment or to fulfill same on items or products not in production. Our conditions and terms of sale are per the current price list at the time of the sale and no waiver, alteration or modification of these terms and conditions whether on buyer's purchase order or otherwise shall be valid unless the waiver, alteration or modification is specifically accepted in writing and signed by an authorized representative of Seller.

CANCELLATIONS

Orders accepted by Seller cannot be countermanded, cancelled, changed, or deliveries deferred except with the Seller's consent and upon terms that will indemnify Seller against loss.

RETURNED GOODS

We reserve the right to refuse acceptance of material returned without our written permission. Transportation charges must be prepaid on return shipments and our acceptance of same is subject to a 20% charge for rehandling plus any outgoing freight charges and any costs to put material into saleable condition. We reserve the right to issue merchandise credits for returned materials.

CLAIMS

Claim for shortage must be made within 20 days after receipt of shipment. Any shortage or damage should be noted on B/L or transport receipt when signing. Our proof of shortage is by weight of shipment and shortage claims are subject to such weight.

TERMS OF PAYMENT

2% cash discount, if paid on or before the 10th of the month following the date of invoice. A service charge of 1 1/2% per month will be charged on past due accounts beyond 30 days from date of invoice.

FREIGHT TERMS

Brass, Thermoplastic, HotStop, and Ameri-Connect Couplings	Full freight allowed on single orders of \$1250 or more within the continental United States (excluding Alaska & Hawaii)
3700 Series ball valves	May be combined with the above products to meet freight minimum in states east of Colorado
4000 Series ball valves	No free freight allowance except by prior arrangement with American Valve

Freight allowance for factory shipments only on protected through rates from origin to destination. No allowance on UPS, parcel post, or air shipments.

If requested to ship other than our choice, any additional freight charges incurred must be borne by customer.

DESIGN

American Valve reserves the right to change design, specification or materials without notice, due to a research and development program of continuous product improvement and reserves all rights to label products covered hereunder with appropriate directions or warnings as may be required in its opinion.

ILLUSTRATIONS

Catalog illustrations are representations of a certain size of each product line but do not necessarily represent all sizes in all details. We reserve the right to institute changes in materials, designs, and specifications, without notice in keeping with our policy on continuing product improvement.

WEIGHTS

Weights in catalogs, price schedules, quotations, and acknowledgements of all orders are approximate and in no sense guaranteed. They represent the average weight of products as made from patterns in use at time weights were compiled.

American Valve warrants, to its initial purchaser only, that its products which are delivered to this initial purchaser will be the kind described in the order or price list and will be free of defects in workmanship or material for a period of one year from the date of delivery to you, our initial purchaser.

Should any failure to conform to this warranty appear within one year after the date of the initial delivery to our initial purchaser, American Valve will, upon written notification thereof and substantiation that the goods have been stored, installed, maintained and operated in accordance with American Valve's recommendation and standard industry practice, correct such defects by suitable repair or replacement at American Valve's own expense. If any valve alleged to be defective, is returned to our factory at Greensboro, NC, it will be examined and, if found to be defective under the warranty, it will be replaced at no charge.



P.O. BOX 35229
GREENSBORO, N.C. 27425
1.800.645.0101
FAX-1.800.876.0109
www.americanvalve.com