

# DIMENSIONAL SPECIFICATIONS

LEADED DOMESTIC BRASS FITTINGS\*\* 125 LB.

## 90 DEGREE STREET ELBOW

Part #	Size (IN.)	Approx. Net WT. (LB.)	A	B
103-02	1/8	0.06	0.55	0.92
103-04	1/4	0.11	0.72	1.11
103-06	3/8	0.17	0.83	1.24
103-08	1/2	0.23	1.03	1.51
103-12	3/4	0.35	1.19	1.66
103-16	1	0.50	1.43	1.98
103-20	1-1/4	0.85	1.71	2.26
103-24	1-1/2	1.15	1.87	2.46
103-32	2	1.98	2.14	2.98
103-40	2-1/2	3.15	2.74	3.92
103-48	3	5.00	3.10	4.45

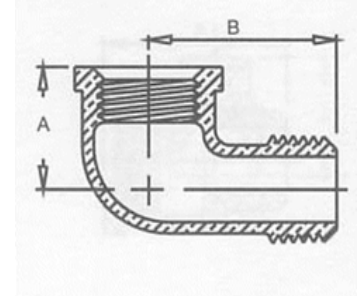

\*\*⚠️WARNING: This product can expose you to Lead, which is known to the State of California to cause cancer and birth defects or other reproductive harm. For more information go to [www.P65Warnings.ca.gov](http://www.P65Warnings.ca.gov). Leaded product is not for use in potable water.

**MERIT**  
**BRASS**  
DIRECTING THE FLOW OF *Quality*