

Submittal Package



ProPress® System

- ☐ Potable Water
- ☐ Hydronic Heating
- ☐ Chilled Water
- ☐ Compressed Air
- ☐ Nitrogen N₂
- ☐ Argon
- ☐ Low Pressure Steam
- ☐ Fire Protection
- ☐ Vacuum
- ☐ Corgon
- ☐ Oxygen O₂ (non medical)
- ☐ _____

System Data Sheet 2

ProPress Product Instructions

 ProPress for ½" to 2" copper tubing 3

 ProPress XL for 2¼" to 4" copper tubing 4

ProPress® Dimensional Documentation

 ProPress for ½" to 2" copper tubing 5

 ProPress XL for 2¼" to 4" copper tubing 17

Viega Limited Warranty ProPress® Fittings And Valves 23

Submittal Package

viega

System Data Sheet

ProPress® and ProPress XL (Copper) are safe, reliable and economical copper pipe installation systems that use modern cold press connection technology.

Viega® ProPress fittings are for use with type K, L and M hard copper tubing from ½" to 4" and soft copper tubing in ½" to 1¼" diameters. All tubing must comply with the ASTM B88 standard. ProPress fittings are approved for installations in both above and below ground applications. Per code, local inspector approval must be obtained prior to installation below ground.

ProPress has been used in Europe since the late 1980s and in the United States since the late 1990s for a variety of applications. Backed by two plumbing leaders with over 175 years of combined excellence.

Listings and Certificates

- NSF 61G
- IAPMO PS117
- UL 213
- FM Class 1920
- ICC LC 1002
- CSA MSE-13
- ABS

International Listings and Certificates

- Deutsch Verein des Gas-und Wasserfachese.V. (DVGW)
- Lloyd's Register (LR)
- Det Norske Veritas (DNV)
- Registro Italiano Navale (RINA)
- Bureau Veritas (BV)
- KIWA

Compliant with:

- ICC International Plumbing Code
- IAPMO Uniform Plumbing Code
- PHCC National Standard Plumbing Code
- Florida Building Code, Volume II Plumbing Code
- NFPA 13, 13D and 13R
- ASME B16.51
- U.S. Coast Guard

Viega ProPress fittings are offered in configurations including: Elbows, Couplings, Reducers, Tees, Reducing Tees, Threaded Adapters, Unions, Caps and Flanges. All threaded ½" to 2" fittings are Zero Lead bronze.

Operating Parameters

Operating Pressure: 200 PSI maximum
Test Pressure: 600 PSI maximum
Operating Temperature: 0°F to 250°F



Approved Applications:

- Potable Water
- Hydronic Heating (w/ Glycol)
- Chilled Water
- Compressed Air
- Non-medical Gases
- Fire Sprinkler (175 PSI maximum)
- Low Pressure Steam (15 PSI maximum)
- Vacuum (29.2 in. Hg maximum @ 68°F)

In ProPress ½" to 4" dimensions, Smart Connect technology assures leakage of liquids and/or gases from inside the system past the sealing element of an unpressed connection. The function of this feature is to provide the installer quick and easy identification of connections which have not been pressed prior to putting the system into operation.

Recommended Tools:

- RIDGID RP 200-B (½" to 1¼")
- RIDGID RP 210-B (½" to 1¼")
- RIDGID RP 320-E
- RIDGID RP 330-B or 330-C
- RIDGID RP 340
- RIDGID CT 400

Contact your local Viega representative for details on local approvals.

Submittal Package

viega

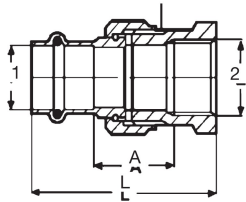

Viega ProPress Union Zero Lead Bronze P x FPT - Model 2962ZL

Part No.	Size	A (in)	L (in)
	1 2		
79700	1/2" x 1/2" FPT	0.91	2.27
79705	3/4" x 3/4" FPT	0.96	2.42
79710	1" x 1" FPT	1.31	2.88
79715	1 1/4" x 1 1/4" FPT	1.27	2.97
79720	1 1/2" x 1 1/2" FPT	1.77	3.87
79725	2" x 2" FPT	1.65	3.92

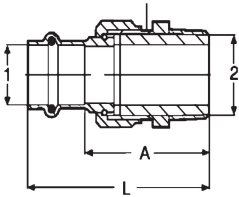

Viega ProPress Union Zero Lead Bronze P x MPT - Model 2965ZL

Part No.	Size	A (in)	L (in)
	1 2		
79730	1/2" x 1/2" MPT	1.86	2.69
79735	3/4" x 3/4" MPT	2.00	2.90
79740	1" x 1" MPT	2.54	3.45
79745	1 1/4" x 1 1/4" MPT	2.49	3.52
79750	1 1/2" x 1 1/2" MPT	3.05	4.47
79755	2" x 2" MPT	2.99	4.57

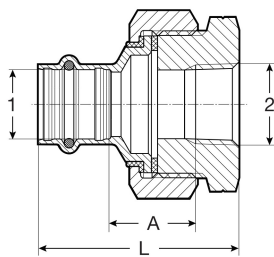

Viega ProPress Dielectric Union Zero Lead Bronze P x FPT - Model 2967ZL

Part No.	Size	A (in)	L (in)
	1 2		
79155	1/2" x 1/2" FPT	0.88	2.24
79160	3/4" x 3/4" FPT	1.11	2.57
79165	1" x 1" FPT	1.00	2.57
79170	1 1/4" x 1 1/4" FPT	0.97	2.68
79175	1 1/2" x 1 1/2" FPT	1.01	3.11
79180	2" x 2" FPT	1.26	3.53

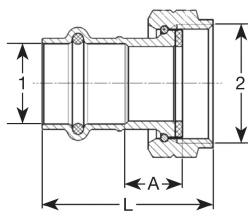

Viega ProPress Tailpiece Zero Lead Bronze P x F BSP - Model 2957ZL

Part No.	Size	A (in)	L (in)
	1 2		
79800	1/2" x 1" BSP	0.39	1.57
79805	3/4" x 1" BSP	0.63	1.87
79810	1" x 1" BSP	0.91	2.14
79815	1" x 1 1/4" BSP	0.73	2.04