

PRODUCT CATALOG



Arrowhead

RELIABLE - PROVEN - TRUSTED - SINCE 1936
www.arrowheadbrass.com



no lead no worries

because your health matters

- The EPA regulations state that hose bibs and valves **MUST** be **Lead-free** if potable use can be anticipated.
- Arrowhead products are 3rd-party certified to Lead-free standard by IAPMO.
- Pending changes to the EPA standards will likely require that all plumbing valves be Lead-free.



ASSE 1011

ASSE 1019-A: Anti-Siphon

NSF/ANSI 372: Lead-free

The Arrowhead Mission

Arrowhead is a US-based manufacturer of plumbing valves and irrigation products with a rich history dating back to 1936. Our mission is to be the global premier provider of these products and to stay true to our seven core values; customer commitment, quality, integrity, teamwork, respect, personal accountability, and good citizenship.

Our Seven Core Values



CUSTOMER COMMITMENT

We strive to foster relationships that have a positive impact on our customers' success.



QUALITY

We provide outstanding products and unsurpassed customer service that bring premium value to our customers every day.



RESPECT

We value and respect our people, encourage their growth and celebrate their successes.



INTEGRITY

We uphold the highest standards of integrity in all our actions.



TEAMWORK

We work together across all functions to meet the needs of our customers and create a winning company culture.



PERSONAL ACCOUNTABILITY

We are all accountable for delivering on our commitments.



GOOD CITIZENSHIP

We commit to being good citizens in the communities which we live and work and strive to improve the quality of life for communities in need.

TABLE OF CONTENTS



- 02 Hose Bibs**
02 Standard Hose Bibs
04 No-Kink Hose Bibs
08 Arrow-Breaker Hose Bibs
12 Ball Valve Hose Bibs



- 06 Sillcocks**
06 Solid Flange Sillcocks
07 Sillcocks
09 Arrow-Breaker Sillcocks & Garden Valves
10 Commercial Sillcocks



- 13 Garden Valves**
13 Garden Valves



- 14 Ball Valves**
14 Ball Valves



- 16 Log Lighter Valves**
16 Log Lighter Valves



- 17 Gas Ball Valves**
17 Gas Ball Valves



- 18 Washing Machine Valves**
18 Washing Machine Valves



- 20 Boiler Drains**
20 Evaporative Coolers
21 Boiler Drains



- 22 Tankless Water Heater Kits**
22 Tankless Water Heater Kits



- 23 Stop & Waste Valves**
23 Stop & Waste Valves



- 24 Wall Hydrants**
24 420 Series
26 450 Series
28 460 Series
30 480 Series
32 490 Series
34 ICEBREAKER - 600 Series
36 Stainless Steel Bulk Economy
37 500 Series
38 Install Guide
40 Repair Guide



- 41 Accessories**
41 Hose Bib Locks



- 42 Push-Fittings**
42 Push-Fittings



- 44 Vacuum Breakers**
44 Self-Draining Vacuum Breakers
45 Vacuum Breakers



- 46 Replacement Handles**
46 Round handles
Tee Handles
Oval Handles
QuickTurn Handles



- 47 Hose Bib Repair**
47 Hose Bib Repair Parts



- 48 Wall Hydrants Repair**
48 Wall Hydrant Repair Parts
49 Select-A-Length Universal Stem Replacement Kit

Standard Hose Bibs

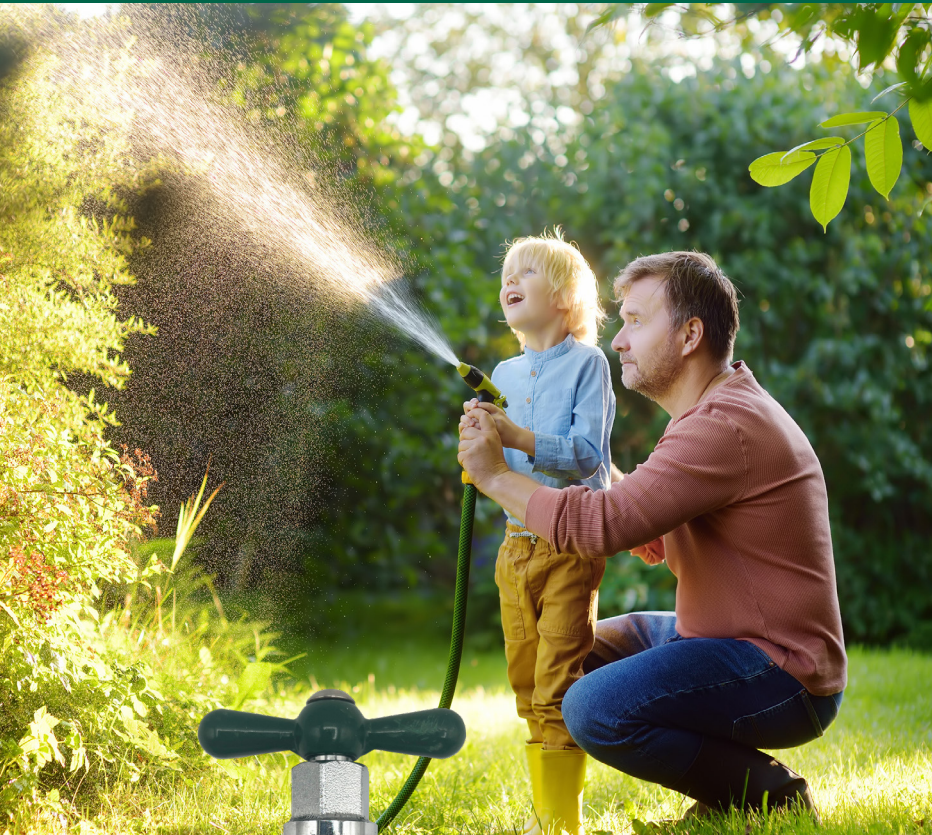

Features

Brass Hose Bibs

- Lead-free brass construction
- Available in 1/2" and 3/4" MIP inlets
- NSF/ANSI 372 certified, IAPMO listed
- Exclusive one piece O-ring style bonnet and green tee handle
- HBM-QT series features QuickTurn 1/4 operation
- 3-year limited warranty
- Max pressure: 125 PSI
- Max temperature: 180° F

Stainless Steel Hose Bibs

- Made with 316 marine-grade stainless steel
- Available in 1/2" and 3/4" MIP inlets
- Superior corrosion resistance - does not erode in humid or extreme weather environments. Reducing maintenance, replacement, and other upkeep costs.
- Perfect for coastal environments
- Exclusive one piece O-ring style bonnet and green tee handle
- Compatible with existing Arrowhead repair kits
- 3-year limited warranty



301SS & 302SS

301SS

1/2" MIP
316 marine-grade stainless steel
Weight (lbs) 0.55

302SS

3/4" MIP
316 marine-grade stainless steel
Weight (lbs) 0.56

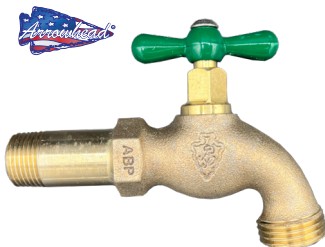

201LF & 202LF

201LF

1/2" MIP with shank
Lead-free
Weight (lbs) 0.848
Pack Qty 6
Case Qty 36

202LF

3/4" MIP with shank
Lead-free
Weight (lbs) 0.889
Pack Qty 6
Case Qty 36

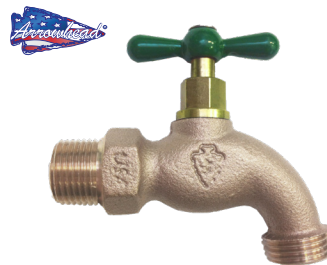

301LF & 302LF

301LF

1/2" MIP
Lead-free
Weight (lbs) 0.695
Pack Qty 12
Case Qty 72

302LF

3/4" MIP
Lead-free
Weight (lbs) 0.737
Pack Qty 12
Case Qty 72

Standard Hose Bibs



HBM series

HB50M

1/2" MIP
Lead-free
Weight (lbs) 0.32

HB75M

3/4" MIP
Lead-free
Weight 0.49

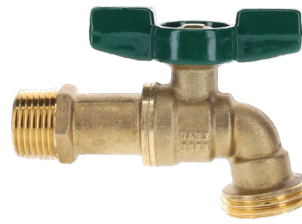

HBM-QT series

HB50M-QT

QuickTurn hose bib
1/2" MIP
Lead-free
Weight (lbs) 0.32

HB75M-QT

QuickTurn hose bib
3/4" MIP
Lead-free
Weight 0.49

Available Options

LooseKey



#301LKLF
#301LSLF

LK: lock-shield
with key
LS: lock-shield;
no key

anti-siphon back- flow preventer



#301BFPLF

factory installed
vacuum
breaker- ASSE
1011 certified

plain-end



#301PELF

plain/no-thread
outlet perfect for
parks &
campgrounds

QuickTurn®



#301QTLF

easy on-off
operation without
letting go of the
handle

self-closing



#301SCLF

5 lbs of pressure
to operate

Accessories

replacement loose key



PK1300

loose key for LK
style valves

replacement back- flow preventer



58BFP

ASSE 1011;
replacement fine thread
vacuum breaker

QuickTurn® Stem Assembly



PK-QTASSY

QT stem assembly
with oval handle &
screw

loose key stem assembly



PK1150

loose key & lock-shield
stem assembly

Repair & Replacement Parts

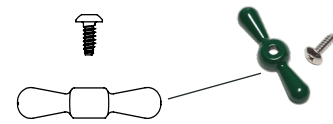

PK1270

replacement green
tee handle & screw



PK1100

replacement stem
assembly



No-Kink Hose Bibs

Features

- Heavy-duty lead-free brass: IAPMO listed
- Exclusive one piece O-ring style bonnet & green tee handle
- 3-year limited warranty
- Max pressure: 125 PSI
- Max temperature: 180° F

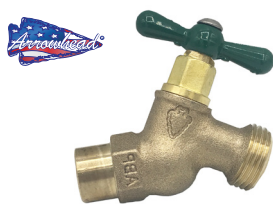

252LF

252LF

1/2" or 3/4" Sweat
Lead-free
Weight (lbs) 0.569
Pack Qty 12
Case Qty 72



NK50F

NK50F

1/2" FIP
Lead-free
Weight (lbs) 0.36
Pack Qty 12
Case Qty 72

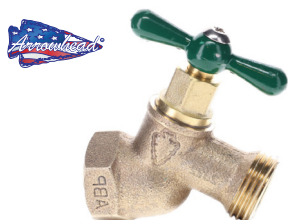

253LF & 353LF

253LF

1/2" FIP
Lead-free
Weight (lbs) 0.5
Pack Qty 12
Case Qty 72

353LF

3/4" FIP
Lead-free
Weight (lbs) 0.541
Pack Qty 12
Case Qty 72



NK50M

NK50M

1/2" MIP
Lead-free
Weight (lbs) 0.36
Pack Qty 12
Case Qty 72

NK75M

3/4" MIP
Lead-free
Weight (lbs) 0.45
Pack Qty 12
Case Qty 72



254CCLF

254CCLF

1/2" Compression
Lead-free
Weight (lbs) 0.625
Pack Qty 12
Case Qty 72

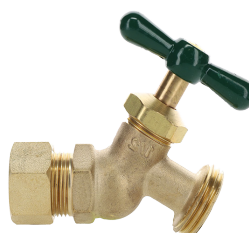

NK50C

NK50C

1/2" Compression
Lead-free
Weight (lbs) 0.44
Pack Qty 12
Case Qty 72



251LF
1/2" MIP
Lead-free Brass
Weight (lbs) 0.556
Package 12 / Case 72

351LF
3/4" MIP
Lead-free Brass
Weight (lbs) 0.612
Package 12 / Case 72



251LF & 351LF

Available Options

loose key



251LKLF
251LSLF

LK: lock-shield with key
LS: lock-shield; no key

anti-siphon back-flow preventer



253BFPLF

Factory installed vacuum breaker- ASSE 1011 certified

QuickTurn®



252QTLF

easy on-off operation without letting go of the handle

No-Kink Hose Bibs



NK50F-QT

NK50F-QT

1/2" FIP
QuickTurn
Lead-free
Weight (lbs) 0.26
Pack Qty 12
Case Qty 72



NK50M-QT

NK50M-QT

1/2" MIP
QuickTurn
Lead-free
Weight (lbs) 0.24
Pack Qty 12
Case Qty 7

NK75F-QT

3/4" FIP
QuickTurn
Lead-free
Weight (lbs) 0.28
Pack Qty 12
Case Qty 72

NK75M-QT

3/4" MIP
QuickTurn
Lead-free
Weight (lbs) 0.28
Pack Qty 12
Case Qty 72

Repair & Replacement Parts

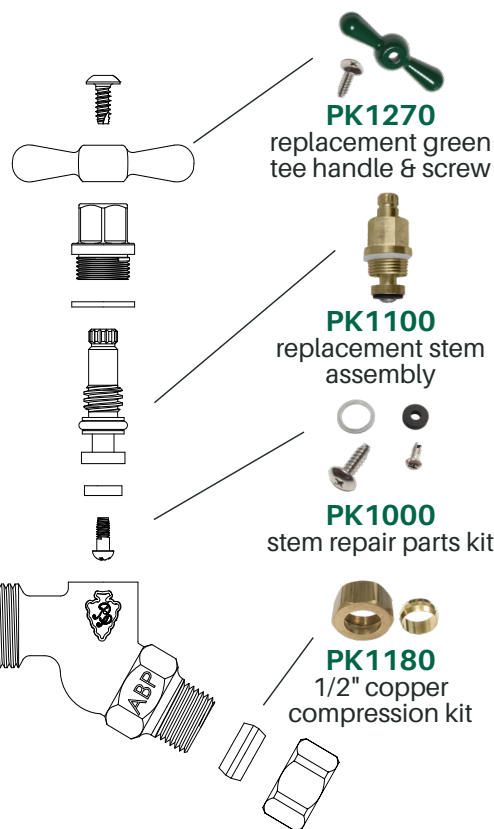

Solid Flange Sillcocks



255LF & 355LF

255LF

1/2" FIP
Lead-free
Weight (lbs) 0.639
Pack Qty 6
Case Qty 36

355LF

3/4" FIP
Lead-free
Weight (lbs) 0.67
Pack Qty 6
Case Qty 36

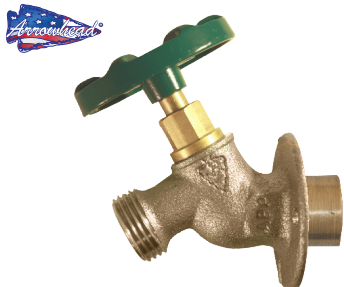

255SWLF & 355SWLF

255SWLF

1/2" Sweat
Lead-free
Weight (lbs) 0.694
Pack Qty 6
Case Qty 36

353SWLF

3/4" Sweat
Lead-free
Weight (lbs) 0.67
Pack Qty 6
Case Qty 36

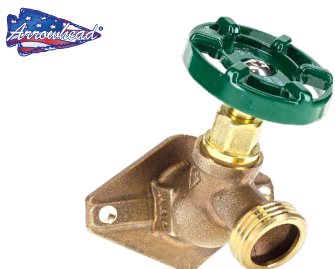

255XLF & 355XLF

255XLF

1/2" FIP
Extra Large Flange
Lead-free
Weight (lbs) 0.694
Pack Qty 6
Case Qty 36

355XLF

3/4" FIP
Extra Large Flange
Lead-free
Weight (lbs) 0.67
Pack Qty 6
Case Qty 36

Features

- Heavy-duty lead-free brass
- Exclusive one piece O-ring style bonnet & green oval handle
- 255XLF/355XLF features a 3-1/4" extra-wide integrated brass flange with a 2-3/4" spread between mounting screw holes
- QuickTurn ball valve operation on "QT" models.
- Max pressure 125 PSI
- Max temperature 180° F
- 3-year limited warranty





SC50F

SC50F
1/2" FIP
Lead-free
Weight (lbs) 0.57
Pack Qty 12
Case Qty 72

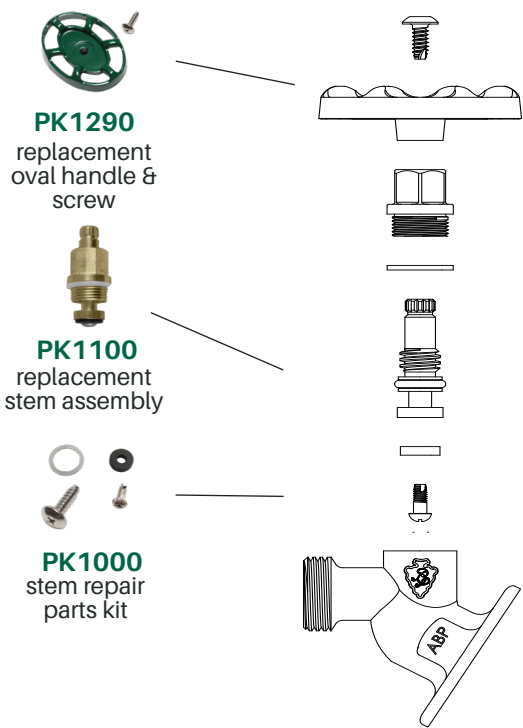

PK1290
replacement
oval handle &
screw

PK1100
replacement
stem assembly

PK1000
stem repair
parts kit

Available Options

anti-siphon
back-flow preventer



255BFPLF
factory installed
vacuum breaker
ASSE 1011 certified

QuickTurn®



255QTLF
easy on-off
operation without
letting go of the handle

loose key



255LKLF
255LSLF
LK: Lock-shield with key
LS: Lock-shield; no key

self-draining
vacuum breaker



255BFPSDLF
self-draining
anti-siphon vacuum
breaker

1/2" PEX Inlet



255PEXLF
1/2" PEX inlet

Arrow-Breaker® Hose Bibs



261LF - 361LF

261LF

1/2" MIP
No-Kink Hose Bib
Lead-free
Weight (lbs) 0.59
Pack Qty 12
Case Qty 72

361LF

3/4" MIP
Lead-free
No-Kink Hose Bib
Weight (lbs) 0.602
Pack Qty 12
Case Qty 72



262LF

262LF

1/2" or 3/4" Sweat
Lead-free
No-Kink Hose Bib
Weight (lbs) 0.59
Pack Qty 12
Case Qty 72



263LF - 363LF

263LF

1/2" FIP
No-Kink Hose Bib
Lead-free
Weight (lbs) 0.518
Pack Qty 12
Case Qty 72

363LF

3/4" FIP
Lead-free
No-Kink Hose Bib
Weight (lbs) 0.552
Pack Qty 12
Case Qty 72



264CCLF

264CCLF

1/2" Compression
Lead-free
No-Kink Hose Bib
Weight (lbs) 0.59
Pack Qty 12
Case Qty 72



261LKLF

LK: lock-shield with key
LS: lock-shield; no key

261LKLF

1/2" or 3/4" Sweat
Lead-free
No-Kink Hose Bib
Lose Key
Weight (lbs) 0.59
Pack Qty 12
Case Qty 72

Features

- Heavy-duty lead-free brass
- Patented Arrow-Breaker®: built-in anti-siphon back-flow preventer that protects your water supply from harmful contaminants
- ASSE 1011 approved, IAPMO certified
- Exclusive one piece O-ring style bonnet & green tee handle
- 3-year limited warranty
- Max pressure: 125 PSI
- Max temperature: 180° F
- High flow rate: 11-12 gallons per minute at 50 PSI

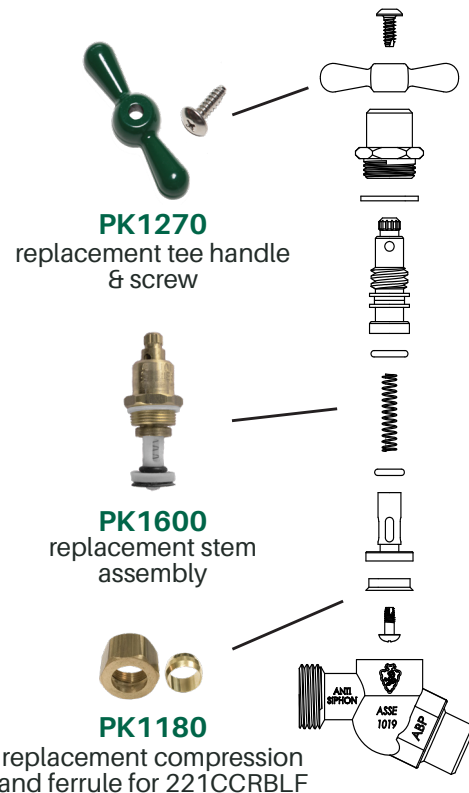

Arrow-Breaker® Sillcocks & Garden Valves



265LF - 365LF

265LF

1/2" FIP

Lead-free

Weight (lbs) 0.656

Pack Qty 6

Case Qty 36

365LF

3/4" FIP

Lead-free

Weight (lbs) 0.686

Pack Qty 6

Case Qty 36



265SWLF - 365SWLF

265LF

1/2" Sweat

Lead-free

Weight (lbs) 0.656

Pack Qty 6

Case Qty 36

365LF

3/4" Sweat

Lead-free

Weight (lbs) 0.715

Pack Qty 6

Case Qty 36

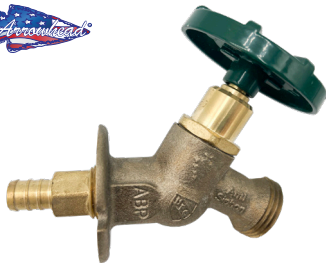

269LF

269LF

1/2" PEX

Lead-free

Weight (lbs) 0.686

Pack Qty 6

Case Qty 36



965LF

965LF

1/2" & 3/4" FIP

Nested Threads

Lead-free

Weight (lbs) 0.667

Pack Qty 6

Case Qty 36

Features

- Heavy-duty lead-free brass
- Patented **Arrow-Breaker®**: built-in anti-siphon back-flow preventer that protects your water supply from harmful contaminants
- ASSE 1011 approved, IAPMO certified
- Exclusive one piece O-ring style bonnet & green oval handle
- 3-year limited warranty
- Max pressure: 125 PSI
- Max temperature: 180° F
- High flow rate: 11-12 gallons per minute at 50 PSI
- 965LF features nested 1/2" & 3/4" FIP threads

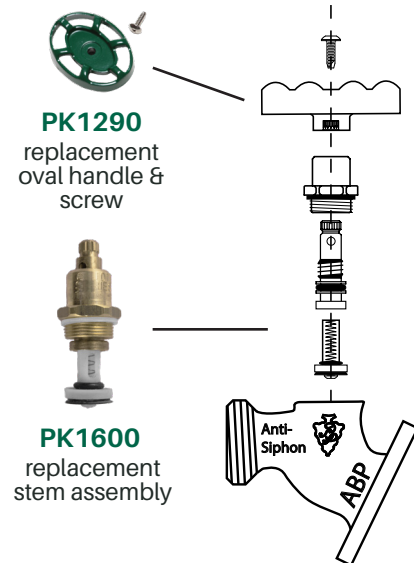

Commercial Sillcocks

Features

- Heavy-duty lead-free brass
- 3-year limited warranty
- Max pressure: 125 PSI
- Max temperature: 180° F
- Individually packaged
- Available in rough brass, nickle-plated (P) or polished chrome finishes (C)



ACSB
Commercial Sillcock
Box

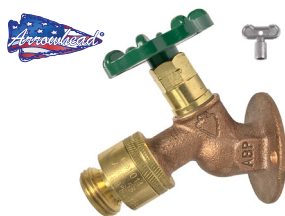

25LF & 35LF

25LF

1/2" FIP
Brass
Lead-free
Pack Qty 1

35LF

3/4" FIP
Brass
Lead-free
Pack Qty 1

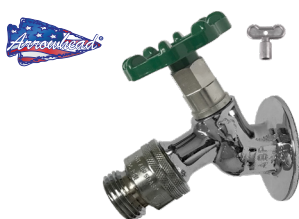

25CLF & 35CLF

25CLF

1/2" FIP
Polished Chrome
Lead-free
Pack Qty 1

35CLF

3/4" FIP
Polished Chrome
Lead-free
Pack Qty 1

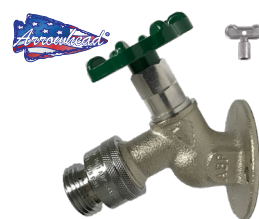

25PLF & 35PLF

25PLF

1/2" FIP
Nickel-Plated
Lead-free
Pack Qty 1

35PLF

3/4" FIP
Nickel-Plated
Lead-free
Pack Qty 1

25SWLF

1/2" Copper Sweat
Brass
Lead-free
Pack Qty 1

35SWLF

3/4" Copper Sweat
Brass
Lead-free
Pack Qty 1

25SWCLF

1/2" Copper Sweat
Polished Chrome
Lead-free
Pack Qty 1

35SWCLF

3/4" Copper Sweat
Polished Chrome
Lead-free
Pack Qty 1

25SWPLF

1/2" Copper Sweat
Nickel-Plated
Lead-free
Pack Qty 1

35SWPLF

3/4" Copper Sweat
Nickel-Plated
Lead-free
Pack Qty 1

Commercial Sillcocks

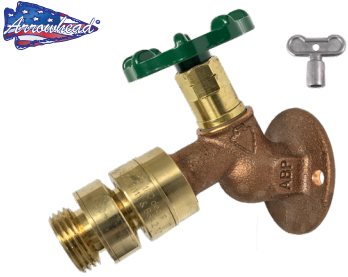

28LF & 38LF

28LF

1/2" FIP
Brass
Self-Draining
Lead-free
Pack Qty 1

38LF

3/4" FIP
Brass
Self-Draining
Lead-free
Pack Qty 1

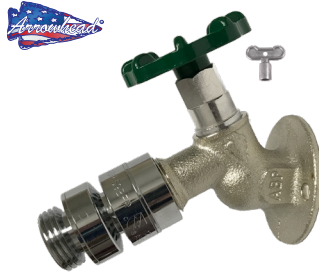

28PLF & 38PLF

28PLF

1/2" FIP
Nickel-Plated
Self-Draining
Lead-free
Pack Qty 1

38PLF

3/4" FIP
Nickel-Plated
Self-Draining
Lead-free
Pack Qty 1

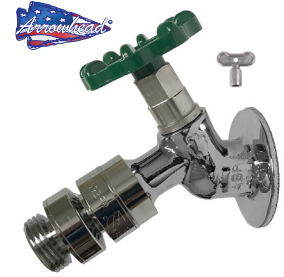

28CLF & 38CLF

28CLF

1/2" FIP
Polished Chrome
Self-Draining
Lead-free
Pack Qty 1

38CLF

3/4" FIP
Polished Chrome
Self-Draining
Lead-free
Pack Qty 1

28SWLF

1/2" Copper Sweat
Brass
Self-Draining
Lead-free
Pack Qty 1

38SWLF

3/4" Copper Sweat
Brass
Self-Draining
Lead-free
Pack Qty 1

28SWCLF

1/2" Copper Sweat
Polished Chrome
Self-Draining
Lead-free
Pack Qty 1

38SWCLF

3/4" Copper Sweat
Polished Chrome
Self-Draining
Lead-free
Pack Qty 1

28SWPLF

1/2" Copper Sweat
Nickel-Plated
Self-Draining
Lead-free
Pack Qty 1

38SWPLF

3/4" Copper Sweat
Nickel-Plated
Self-Draining
Lead-free
Pack Qty 1

Ball Valve Hose Bibs

Features

- Reliable brass construction with full-port ball valve operation
- NSF/ANSI 372 certified, IAPMO listed
- Bi-direction QuickTurn operation
- Max pressure: 125 PSI
- Max temperature: 180° F
- Lead-free certified by IAPMO



251BVLFF

251BVLFF

1/2" MIP
Ball Valve Hose Bib
Lead-Free
Brass
Weight 0.7000
Case Qty10



252BVLFF

252BVLFF

1/2" Sweat
Ball Valve Hose Bib
Lead-Free
Brass
Weight 0.7000
Case Qty10



253BVLFF

253BVLFF

1/2" FIP
Ball Valve Hose Bib
Lead-Free
Brass
Weight 0.629
Case Qty10

351BVLFF

3/4" MIP
Ball Valve Hose Bib
Lead-Free
Brass
Weight 0.70730
Case Qty10

352BVLFF

3/4" Sweat
Ball Valve Hose Bib
Lead-Free
Brass
Weight 0.660
Case Qty10

353BVLFF

3/4" FIP
Ball Valve Hose Bib
Lead-Free
Brass
Weight 0.760
Case Qty10



255BVLFF

255BVLFF

1/2" MIP
Ball Valve Hose Bib
Lead-Free
Brass
Weight 0.70780
Case Qty10



Garden Valves



925LF

925LF

1/2" and 3/4" FIP
Nested Threads
Lead-Free
Brass
Weight 0.67
Pack Qty 6
Case Qty 36



930LF

930LF

1" FIP
Lead-Free
Brass
Weight 0.67
Pack Qty 6
Case Qty 36



975LF

975LF

1/2" and 3/4"
Inlet: Inverted Nose
Lead-Free
Brass
Weight 0.78
Pack Qty 6
Case Qty 36



980LF

980LF

1" FIP
Inlet: Inverted Nose
Lead-Free
Brass
Weight 0.89
Pack Qty 6
Case Qty 36

Features

- Heavy-duty lead-free brass
- NSF/ANSI 372 Certified, IAPMO listed
- Full-flow design, available in bent nose or inverted nose models
- 3-year limited warranty
- Max pressure: 125 PSI
- Max temperature: 180° F
- 925LF & 975LF models feature dual "nested" 1/2" & 3/4" FIP threads
- Loose key options: 925LKLF

Available Options

loose key



925LKLF
925LSLF

LK: lock-shield with key
LS: lock-shield; no key

anti-siphon back-flow preventer



930BFPLF

Factory installed
vacuum breaker-
ASSE 1011 certified

Repair & Replacement Parts

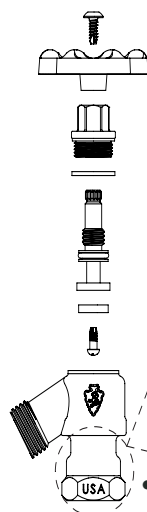

925LF
975LF

- *Nested threads:
- 1/2" & 3/4" FIP Inlet

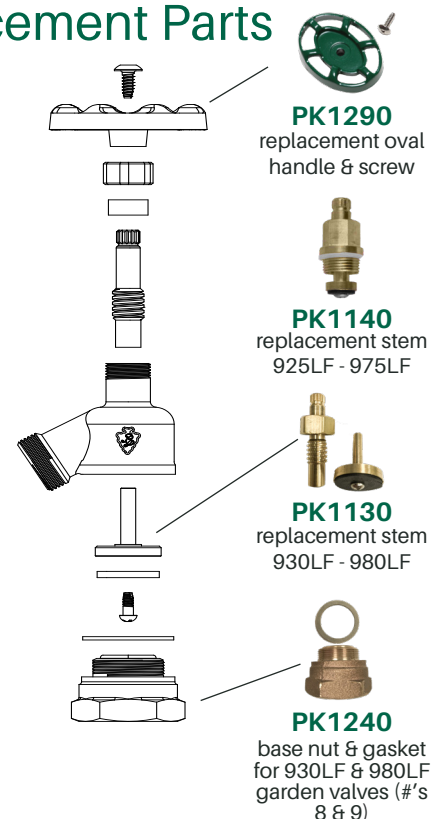

Ball Valves

Features

- Full-port, forged lead-free brass construction. NSF/ANSI 61 certified Lead-free by IAPMO
- Two-part brass body with chrome-plated solid brass ball and QuickTurn operation
- **BVS & BVF** series are certified to IAPMO/ANSI Z115-2014e1 and NSF/ANSI 14-2010a.cUPC, NSF61, CSA, UL, and FM approved
- Two-part brass body with chrome-plated solid brass ball and QuickTurn operation
- **BVS** Series comply with ANSI B16.18 max pressure: 600 PSI Non-Shock WOG (1/2" to 2" models), 400 PSI Non-Shock WOG (2-1/2" models to 3" models), max temp: 300° F
- **BVF** series comply with ANSI B1.20.1 max pressure: 600 PSI Non-Shock WOG (1/2" to 2" models) 400 PSI pressure Non-Shock WOG(2-1/2" to 3" models): max temp: 300° F
- **BVR** series: REDIGRIP Push-Fit connections certified to ASSE 1061. max pressure: 232 PSI, max temp: 203° F.
- **BVX** series: ASTM F1807 PEX Connections max pressure: 400 PSI, max temp: 200° F
- **BVP** series: Copper Press-Fit connections- works with a variety of press-fit tools. max pressure: 250 PSI: max temperature: 203° F
- **BVC** series: copper compression connection, max pressure: 200 PSI, max temp: 300° F
- For water use only
- 3-year limited warranty



BVS series

BV50S

1/2" Sweat
Full Port
Lead-Free
Brass
Weight 0.33

BV75S

3/4" Sweat
Full Port
Lead-Free
Brass
Weight 0.58

BV100S

1" Sweat
Full Port
Lead-Free
Brass
Weight 1.05

BV125S

1-1/4" Sweat
Full Port
Lead-Free
Brass
Weight 1.39

BV150S

1-1/2" Sweat
Full Port
Lead-Free
Brass
Weight 2.34

BV200S

2" Sweat
Full Port
Lead-Free
Brass
Weight 3.48

BV250S

2-1/2" Sweat
Full Port
Lead-Free
Brass
Weight 6.13



BVR series

BV50R

1/2" REDIGRIP
Push-Fitting
Lead-Free
Brass
Weight 0.33

BV75R

3/4" REDIGRIP
Push-Fitting
Lead-Free
Brass
Weight 0.58

BV100R

1" REDIGRIP
Push-Fitting
Lead-Free
Brass
Weight 1.05

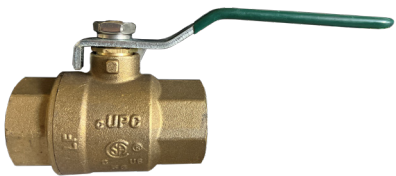

BVF series

BV50F

1/2" Threaded
Full Port
Lead-Free
Brass
Weight 0.33

BV75F

3/4" Threaded
Full Port
Lead-Free
Brass
Weight 0.58

BV100F

1" Threaded
Full Port
Lead-Free
Brass
Weight 1.05

BV125F

1-1/4" Threaded
Full Port
Lead-Free
Brass
Weight 1.39

BV150F

1-1/2" Threaded
Full Port
Lead-Free
Brass
Weight 2.36

BV200F

2" Threaded
Full Port
Lead-Free
Brass
Weight 3.44



BVX series

BV50X

1/2" PEX
Lead-Free
Brass
Weight 0.33

BV75X

3/4" PEX
Lead-Free
Brass
Weight 0.58

BV100C

1" PEX
Lead-Free
Brass
Weight 1.05



BVP series

BV50P

1/2"
Push-Fitting
Lead-Free
Brass

BV75P

3/4"
Push-Fitting
Lead-Free
Brass

BV100P

1"
Push-Fitting
Lead-Free
Brass

BV125P

1-1/4"
Push-Fitting
Lead-Free
Brass

BV150P

1-1/2"
Push-Fitting
Lead-Free
Brass

BV200P

2"
Push-Fitting
Lead-Free
Brass



BVC series

BV50C

1/2"
Push-Fitting
Lead-Free
Brass
Weight 0.33

BV75C

3/4"
Push-Fitting
Lead-Free
Brass
Weight 0.58

Gas Ball Valves, Log Lighter Valves & Kits

Features

- Heavy-duty brass construction
- 1/2" female iron pipe connections
- ANSI Z21.15-2009/CSA 9.1-2009 (R2014)
- Teflon seat washer
- Valves are rated at 154,000 BTU per hour rating at a 1.0" water column
- Log lighter bar has three 1/2" IPS inlets with 2 countersunk plugs
- All valves are tested to 100 PSI
- Log lighter keys have 5/16" square drive



258 Series

258

1/2" FIP
Straight gas
log lighter with
chrome flange
and key
Weight 1.194
Pack qty 6
Case Qty 36

258KIT

1/2" FIP
Straight gas
log lighter with
chrome flange
and key LL bar
Weight 3.887
Pack qty 1
Case Qty 1

258LP

1/2" FIP
Straight propane
log lighter with
chrome flange
and key
Weight 1.194
Pack qty 6
Case Qty 36

258NC

1/2" FIP
Straight gas log
lighter only
Weight 0.81
Pack qty 12
Case Qty 72



259 Series

259

1/2" FIP
Angle gas log
lighter with
chrome flange
and key
Weight 1.194
Pack qty 6
Case Qty 36

259KIT

1/2" FIP
Angle gas log
lighter with
chrome flange
and key LL bar
Weight 3.887
Pack qty 1
Case Qty 1

259LP

1/2" FIP
Angle propane
log lighter with
chrome flange
and key
Weight 1.194
Pack qty 6
Case Qty 36

259NC

1/2" FIP
Angle gas log
lighter only
Weight 0.81
Pack qty 12
Case Qty 72



258KIT - 259KIT



258LLB

258LLB

Log Lighter Bar
Weight 2.68
Pack qty 1
Case qty 12



258LPA

258-LPA

Liquid Propane
Adapter
Weight 2.68
Pack qty 1
Case qty 12



Gas Ball Valves, Log Lighter Valves & Kits

Valve Accessories

polished brass
key & flange



PK1330

polished brass key
& flange for
Arrowhead log
lighter valves

log lighter
key



51
PK1345

standard LL key
(PK - retail
packaged)

flange -
polished brass



44PB

polished brass
log lighter valve
flange

chrome key
& flange



PK1320

replacement
key & flange for
Arrowhead log
lighter valves

polished
brass key



51PB
PK1340

LL key -
polished brass
(PK - retail
packaged)

flange -
chrome



44

chrome log
lighter valve
flange

12" log lighter key



52-12
12" LL key

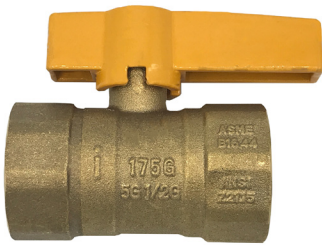

GBF series

GB50F

1/2"

AGA Gas Ball Valve
Female Thread
Brass
Weight 0.32

GB75F

3/4"

AGA Gas Ball Valve
Female Thread
Brass
Weight 0.47

Features

- Forged heavy construction two-part brass body
- QuickTurn ball valve operation
- Standard port, 1/2 PSIG & 5 PSIG ball valves
- Approved for use with natural, manufactured, mixed, liquefied petroleum, or propane gases
- ANSI Z21.15/CGA9.1 (1/2PSI) approved
- ASME B16.44 (1/2, 2, 5 PSI) approved
- CR91-002 approved
- 3-year limited warranty



Washing Machine Valves

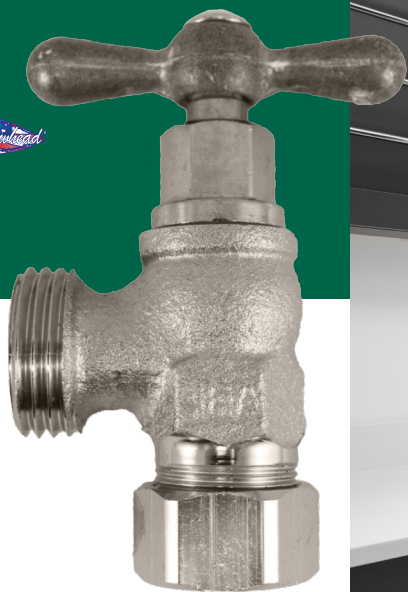

221CCLF

221CCLF

WMV 1/2" Compression Inlet
x 3/4" Male Hose Thread
Lead-free
Weight 0.514
Pack Qty 12
Case Qty 72

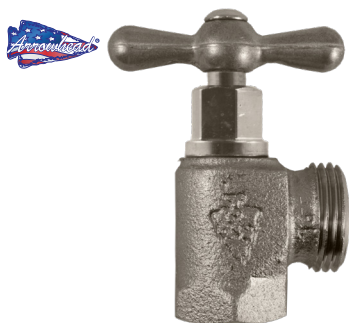

247LF

247LF

WMV 1/2" FIP Inlet
x 3/4" Hose Thread
Lead-free
Weight 0.486
Pack Qty 12
Case Qty 72



248LF

248LF

WMV 1/2" FIP Inlet
x MIP reversible bypass with
side 3/4" thread
Lead-free
Weight 0.737
Pack Qty 12
Case Qty 72



249LF

249LF

WMV 1/2" FIP Inlet
x 3/4" Male Hose Thread
Top handle
Lead-free
Weight 0.389
Pack Qty 12
Case Qty 72

Features

- Heavy-duty lead-free brass
- NSF/ANSI 372 Certified, IAPMO listed
- Exclusive one piece O-ring style bonnet & burnished tee handle
- WM50M-R & WM50M-B feature QuickTurn operations, color-coded handles, and a nylon lock nut
- Satin/nickel plated finish
- Max pressure: 125 PSI
- Max temperature: 180° F.
- 3-year limited warranty



250LF

250LF

WMV 1/2" FIP Inlet
x 1/2 MIP bypass with 3/4"
bottom thread
Lead-free
Weight 0.653
Pack qty 12
Case Qty 72



WM50M-B

WM50M-B

1/2"
Long stem
Lead-free
Blue handle
Weight 0.46



WM50M-R

WM50M-R

1/2"
Long stem
Lead-free
Red handle
Weight 0.46

Repair & Replacement Parts

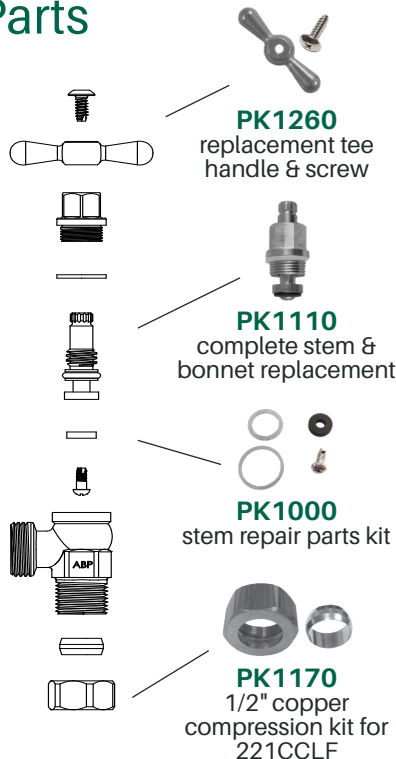
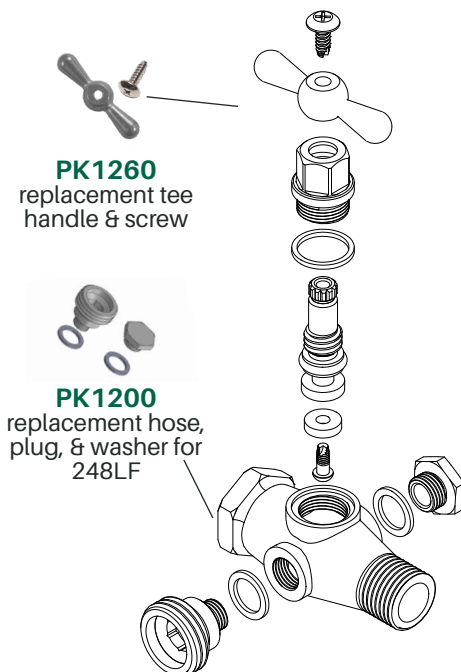

Accessories

loose key stem assembly



PK1155

loose key &
lock-shield stem
assembly; nickel-plated

Boiler Drains & Evaporative Cooler



220LF
3/4" FIP
Lead-free
Brass
Weight 0.569
Pack Qty 12
Case Qty 72

220LF - 222LF

222LF
1/2" FIP
Lead-free
Brass
Weight 0.486
Pack Qty 12
Case Qty 72



221CCRBLF
1/2"
Compression
Lead-free
Brass
Weight 0.514
Pack Qty 12
Case Qty 72

221CCRBLF



221LF
3/4" MIP
Lead-free
Brass
Weight 0.444
Pack Qty 12
Case Qty 72

221LF - 223LF



223LF
3/4" MIP
Lead-free
Brass
Weight 0.458
Pack Qty 12
Case Qty 72

Features

- Heavy-duty lead-free brass
- NSF/ANSI 372 certified, IAPMO listed
- Exclusive one piece O-ring style bonnet
- 3-year limited warranty
- Max pressure: 125 PSI
- Max temperature: 180° F
- Models 240LF and 245LF evaporative cooler valves feature 1/8" side tap



225LF

225LF
1/2" MIP
Inverted Nose
Lead-free
Brass
Weight 0.49
Pack Qty 12
Case Qty 72



240LF - 245LF

240LF
3/4" FIP 1/8 tap
Evaporative Cooler
Lead-free
Brass
Weight 0.556
Pack Qty 12
Case Qty 72

245LF
3/4" FIP 1/8 tap
Evaporative Cooler
Lead-free
Brass
Weight 0.556
Pack Qty 12
Case Qty 72

Repair Parts

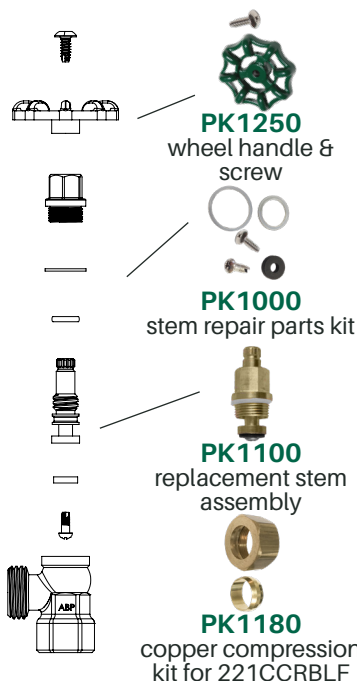

Boiler Drains

Features

- Forged lead-free dezincification resistant brass construction
- NSF/ANSI 61 certified IAPMO
- Multi-purpose supply/drain valves for use in low pressure water systems
- QuickTurn easy on/off operation included in all "-QT" models
- Max pressure 125 PSI
- 3-year limited warranty



BD50C

BD50C
1/2"
Compression
Lead-Free
Brass
Weight 0.56



BDM series

BD50M
1/2" MIP
Lead-Free
Brass
Weight 0.49

BD75M
3/4" MIP
Lead-Free
Brass
Weight 0.55



BDM-QT

BD50M- QT
1/2" MIP
QuickTurn
Lead-Free
Brass
Weight 0.28

BD75M-QT
3/4" MIP
QuickTurn
Lead-Free
Brass
Weight 0.30



BDF Series

BD50F
1/2" FIP
Lead-free
Brass
Weight 0.48

BD75F
3/4" FIP
Lead-free
Brass
Weight 0.53



BDF-QT

BD50F-QT
1/2" FIP
QuickTurn
Lead-free
Brass
Weight 0.27

BD75F-QT
3/4" FIP
QuickTurn
Lead-free
Brass
Weight 0.30

Tankless Water Heater Kits



TKC150

TKC150

Pressure Relief Valve
NPT 3/4"
Ball Valves
3/4"
Lead-free
Brass
Pack Qty 1

Features

- Tankless water heater kit includes hot and cold valves and a pressure release valve
- Easily and quickly connects to any tankless hot water heater
- Color coded handles for easy identification of hot and cold valves
- Large drain port outlets
- Made of heavy-duty lead-free brass
- 3/4" NPT connection
- Ball valve connections 3/4"
- NSF / ANSI 372, ASME IV & ANSI Z21.22•CSA4.4 certified
- Maximum inlet pressure: 200 PSI
- Maximum temperature: 200° F
- Relief pressure: 150 PSI



Stop And Waste Valves

Features

- Forged lead-free brass construction
- NSF/ANSI 61 certified by IAPMO
- Max pressure: 125 PSI
- Max temperature: 160° F

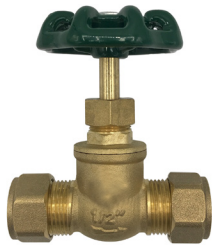

SVC Series

SV50C

Stop Valve 1/2"
compression
lead-free
Weight 0.21

SV75C

Stop Valve 3/4"
compression
lead-free
Weight 0.17



SVC-W Series

SV50C-W

Stop and Waste Valve 1/2 "
compression
Lead-free
Weight 0.20

SV75C-W

Stop and Waste Valve 3/4"
compression
lead-free
Weight 0.25



SVS Series

SV50S

Stop Valve 1/2"
sweat
lead-free
Weight 0.21

SV75S

Stop Valve 3/4"
sweat
lead-free
Weight 0.17



SVS-W Series

SV50S-W

Stop and Waste Valve 1/2"
sweat
Lead-free
Weight 0.20

SV75C-W

Stop and Waste Valve 3/4"
sweat
lead-free
Weight 0.25



SVF Series

SV50F

Stop Valve 1/2"
FIP
lead-free
Weight 0.21

SV75F

Stop Valve 3/4"
FIP
lead-free
Weight 0.17



SVF-W Series

SV50F-W

Stop and Waste Valve 1/2"
FIP
Lead-free
Weight 0.20

SV75F-W

Stop and Waste Valve 3/4"
FIP
lead-free
Weight 0.25





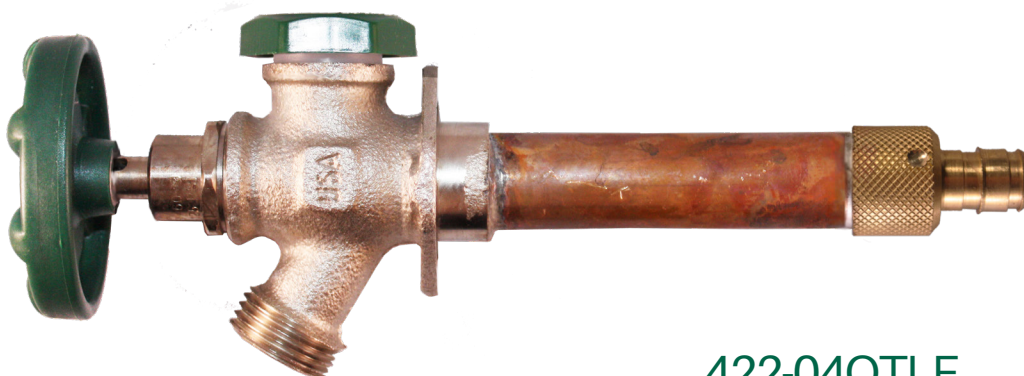

420 Series Anti-Siphon Wall Hydrants

Frost-Proof ✓
 Anti-Siphon ✓
 Lead-Free ✓
 QuickTurn® ✓



422-04QTLF



Base Model	Inlet Connections		Case Qty
422-xxQTLF	1/2" Uponor - PEX A Inlet		24
424-xxQTLF	1/2" Push-Fit Inlet		24
425-xxQTLF	1/2" Female Pipe Thread ID / 3/4" Male Pipe Thread OD Inlet		24
426-xxQTLF	1/2" Copper Sweat ID / 1/2" Male Pipe Thread OD Inlet		24
428-xxQTLF	3/4" Copper Sweat ID / 3/4" Male Pipe Thread OD Inlet		24
429-xxQTLF	1/2" Crimp PEX (ASTM F1807) Inlet		24

Available Option

removable loose key
 lock-shield
 insert "LK": 425-04LKLF

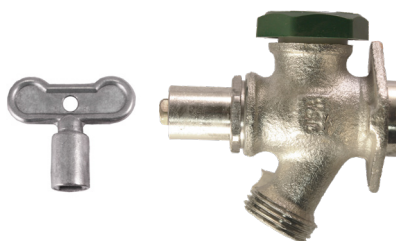

loose key
 lock-shield & removable loose key
 to prevent use without the key

Features

- Heavy-pattern lead-free brass
- NSF/ANSI 372 certified, IAPMO listed
- Exclusive O-ring bonnet & stem design.
- Integral anti-siphon back-flow prevention: ASSE 1019-A approved, IAPMO certified
- Includes QuickTurn® style operation: easy on/off without letting go of the handle
- Rubber-coated oval handle
- Available in 2, 4, 6, 8, 10, 12 & 14 inch lengths (longer lengths available by special order)

420 Series Repair & Replacement Parts

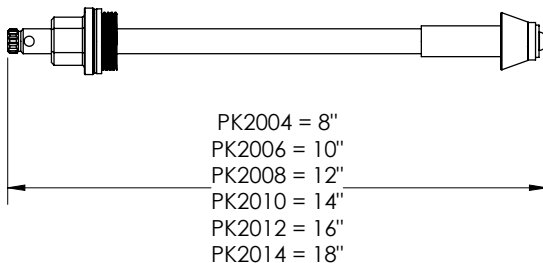
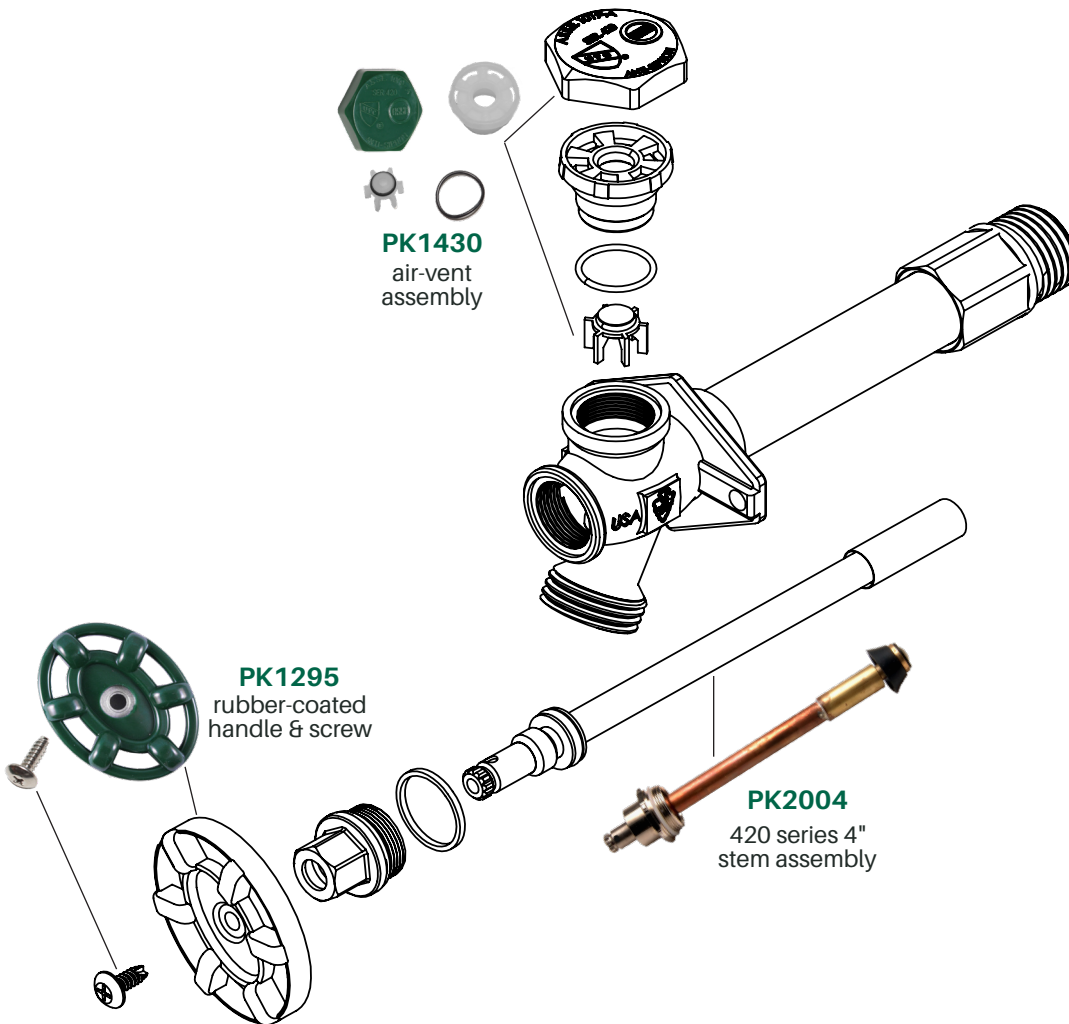

**for 420 series hydrants installed prior to 1999, use PK20__SP stem assembly to replace old style stems that have a spring check assembly. contact Arrowhead Brass for more details*



PK1450
replacement gap spacer, used
to tilt faucet downward

PK2006
6-inch hydrant stem assembly
(10" total length)

PK2008
8-inch hydrant stem assembly
(12" total length)

PK2010
10-inch hydrant stem assembly
(14" total length)

PK2012
12-inch hydrant stem assembly
(16" total length)

PK2014
14-inch hydrant stem assembly
(18" total length)







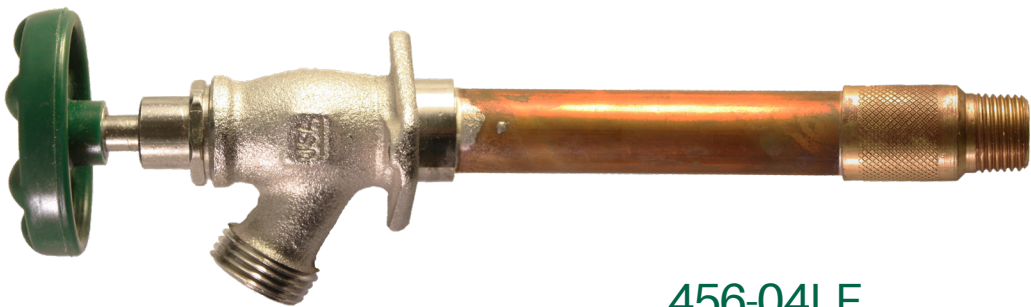

450 Series Standard Wall Hydrants

- Frost-Proof ☒
- Anti-Siphon ☐
- Lead-Free ☒
- QuickTurn® ☐



456-04LF



Base Model	Inlet Connections		Case qty
452-xxLF	1/2" Uponor - PEX A Inlet		24
454-xxLF	1/2" Push-Fit Inlet		24
455-xxLF	1/2" Female Pipe Thread ID / 3/4" Male Pipe Thread OD Inlet		24
456-xxLF	1/2" Copper Sweat ID / 1/2" Male Pipe Thread OD Inlet		24
458-xxLF	3/4" Copper Sweat ID / 3/4" Male Pipe Thread OD Inlet		24
459-xxLF	1/2" Crimp PEX (ASTM F1807) Inlet		24

Available Option

removable loose key
lock-shield
insert "LK": 455-04LKLF

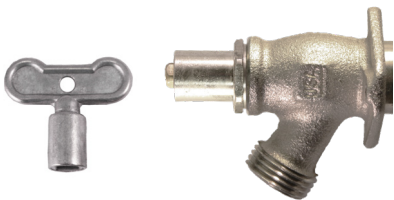

loose key
lock-shield & removable
loose key to prevent use
without the key

Features

- Heavy-pattern lead-free brass
- NSF/ANSI 372 certified, IAPMO listed
- Exclusive O-ring bonnet and stem design
- Green oval handle
- Available in 2, 4, 6, 8, 10, 12 & 14 inch lengths (longer lengths available by special order)
- Does not offer anti-siphon protection

450 Series Repair & Replacement Parts



pictured 450LF Series

PK1295
green oval
handle & screw



PK1000
stem rebuild kit



PK8004
450 series 4"
stem assembly

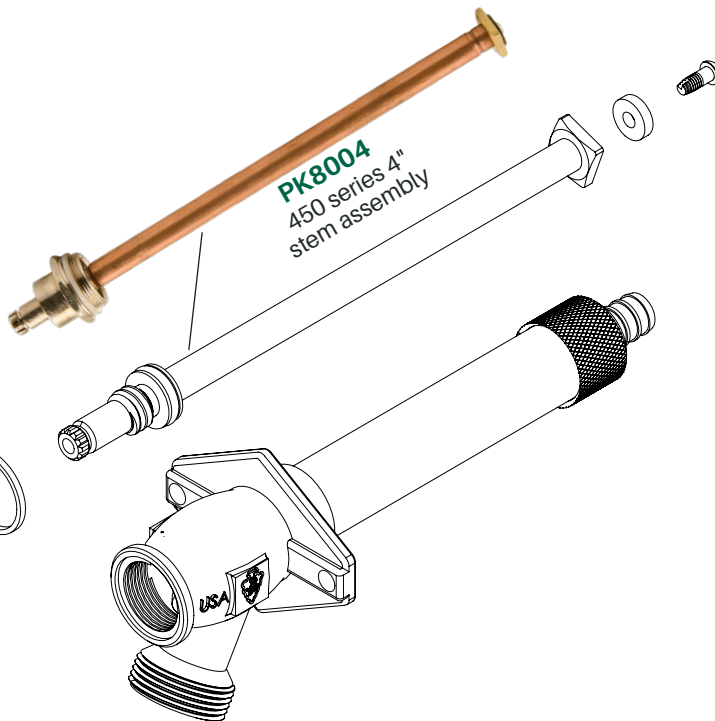

**gap-spacer
wedge**



PK1450
replacement gap spacer,
used to tilt faucet downward

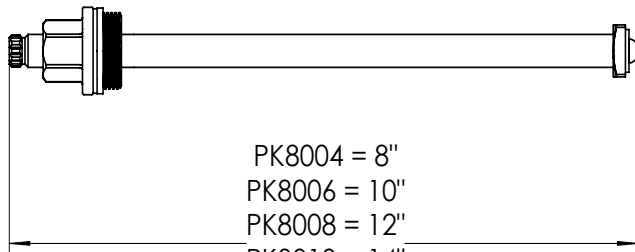

PK8004 = 8"
PK8006 = 10"
PK8008 = 12"
PK8010 = 14"
PK8012 = 16"
PK8014 = 18"

**450 series
stem assembly**



PK8006
6-inch hydrant stem assembly
(10" total length)

PK8008
8-inch hydrant stem assembly
(12" total length)

PK8010
10-inch hydrant stem assembly
(14" total length)

PK8012
12-inch hydrant stem assembly
(16" total length)

PK8014
14-inch hydrant stem assembly
(18" total length)



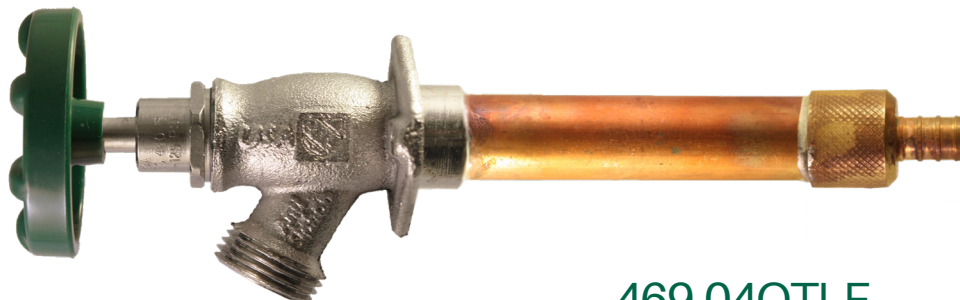

460 Series Arrow-Breaker® Wall Hydrants

Frost-Proof ✓
Anti-Siphon ✓
Lead-Free ✓
QuickTurn® ✓



469-04QTLF



Base Model	Inlet Connections		Case qty
462-xxQTLF	1/2" Uponor - PEX A Inlet		24
465-xxQTLF	1/2" Female Pipe Thread ID / 3/4" Male Pipe Thread OD Inlet		24
466-xxQTLF	1/2" Copper Sweat ID / 1/2" Male Pipe Thread OD Inlet		24
468-xxQTLF	3/4" Copper Sweat ID / 3/4" Male Pipe Thread OD Inlet		24
469-xxQTLF	1/2" Crimp PEX (ASTM F1807) Inlet		24

Available Option

removable loose key
lock-shield
insert "LK": 465-04LKLF

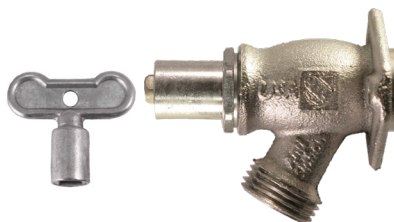

loose key

lock-shield & removable loose key to prevent use without the key

Features

- Heavy-pattern lead-free brass
- NSF/ANSI 372 certified lead-free, IAPMO listed
- Patented Arrow-Breaker integral anti-siphon back-flow prevention: ASSE 1019-A approved, IAPMO certified
- Includes QuickTurn® style operation: easy on/off without letting go of the handle
- Exclusive O-ring bonnet & stem design with rubber coated oval handle
- Available in 2, 4, 6, 8, 10, 12 & 14 inch lengths (longer lengths available by special order, contact Arrowhead Brass for details)

460 Series Arrow-Breaker® Repair & Replacement Parts

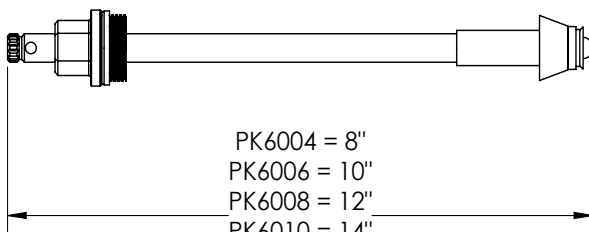
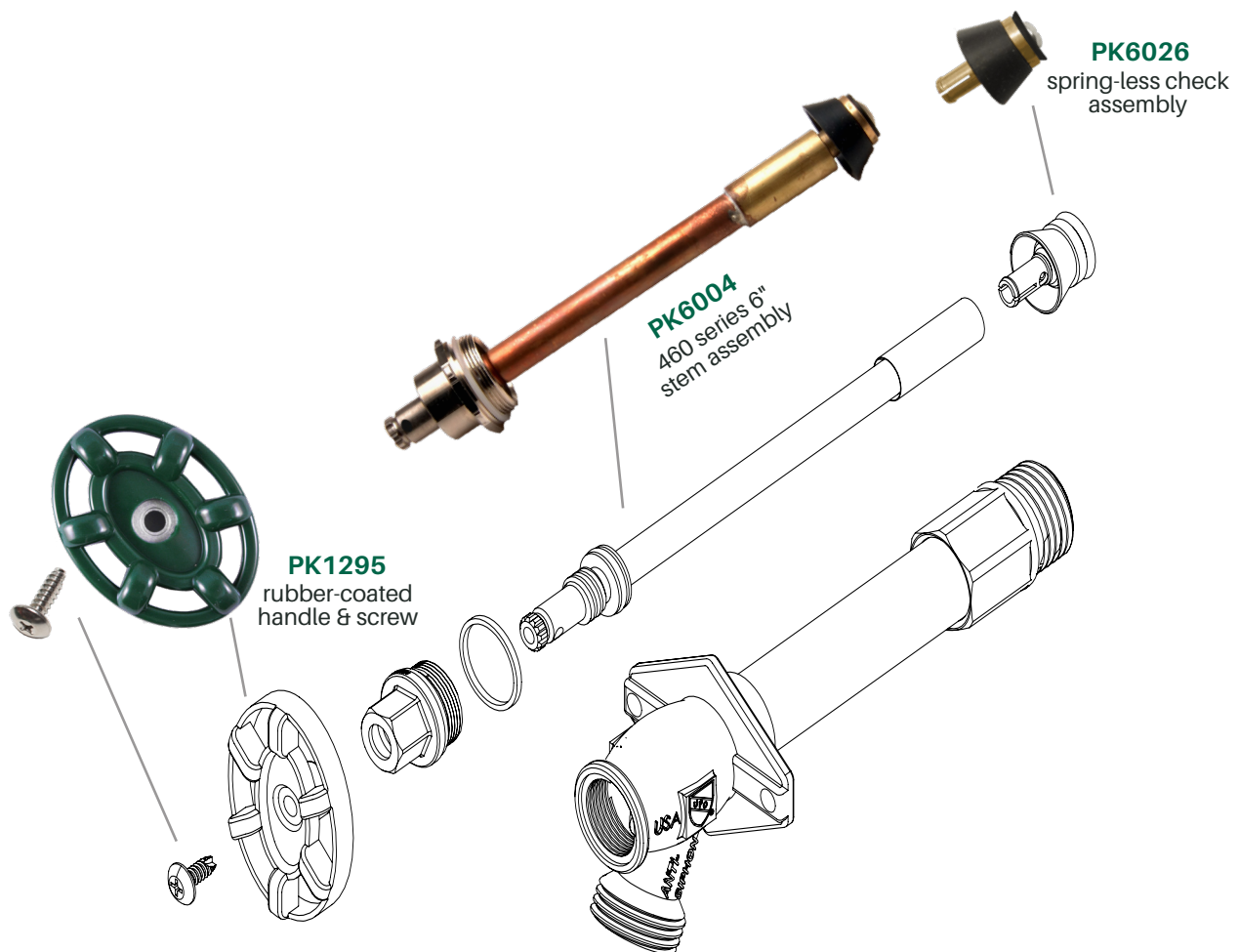

PK1450
replacement gap spacer,
used to tilt faucet downward





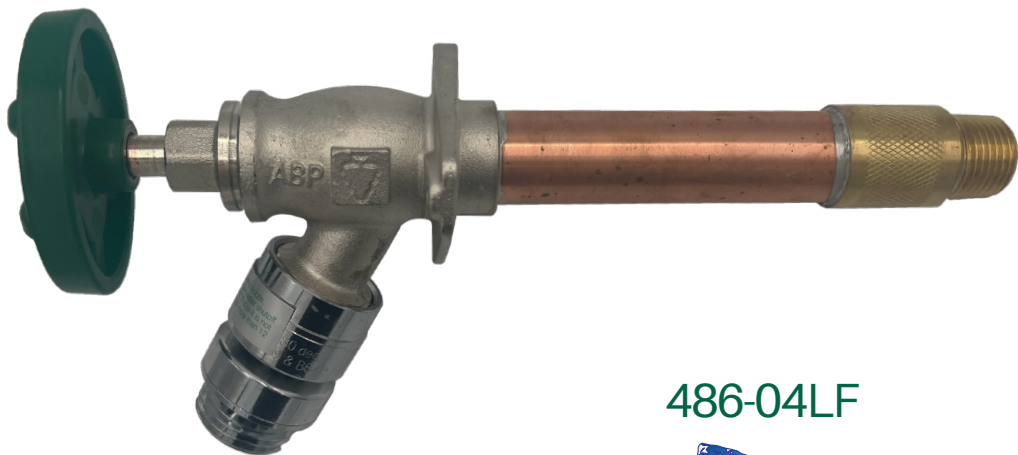

480 Series Self-Draining A-S Wall Hydrants

Frost-Proof ✓
Anti-Siphon ✓
Self-Draining ✓
Lead-Free ✓



486-04LF



Base Model	Inlet Connections		Case Qty
482-xxLF	1/2" Uponor - PEX A Inlet		24
485-xxLF	1/2" Female Pipe Thread ID / 3/4" Male Pipe Thread OD Inlet		24
486-xxLF	1/2" Copper Sweat ID / 1/2" Male Pipe Thread OD Inlet		24
488-xxLF	3/4" Copper Sweat ID / 3/4" Male Pipe Thread OD Inlet		24
489-xxLF	1/2" Crimp PEX (ASTM F1807) Inlet		24

Available Option

removable loose key
lock-shield
insert "LK": 485-04LKLF



loose key
lock-shield & removable loose key to prevent use without the key

Features

- Heavy-pattern lead-free brass
- NSF/ANSI 372 certified lead-free, IAPMO listed
- Exclusive O-ring bonnet & stem design
- External self-draining vacuum breaker: drains hydrant upon shut-off to prevent freezing
- ASSE 1019-A approved, IAPMO certified
- Rubber-coated oval handle
- Available in 2, 4, 6, 8, 10, 12 & 14 inch lengths (longer lengths available by special order)

480 Series Repair & Replacement Parts

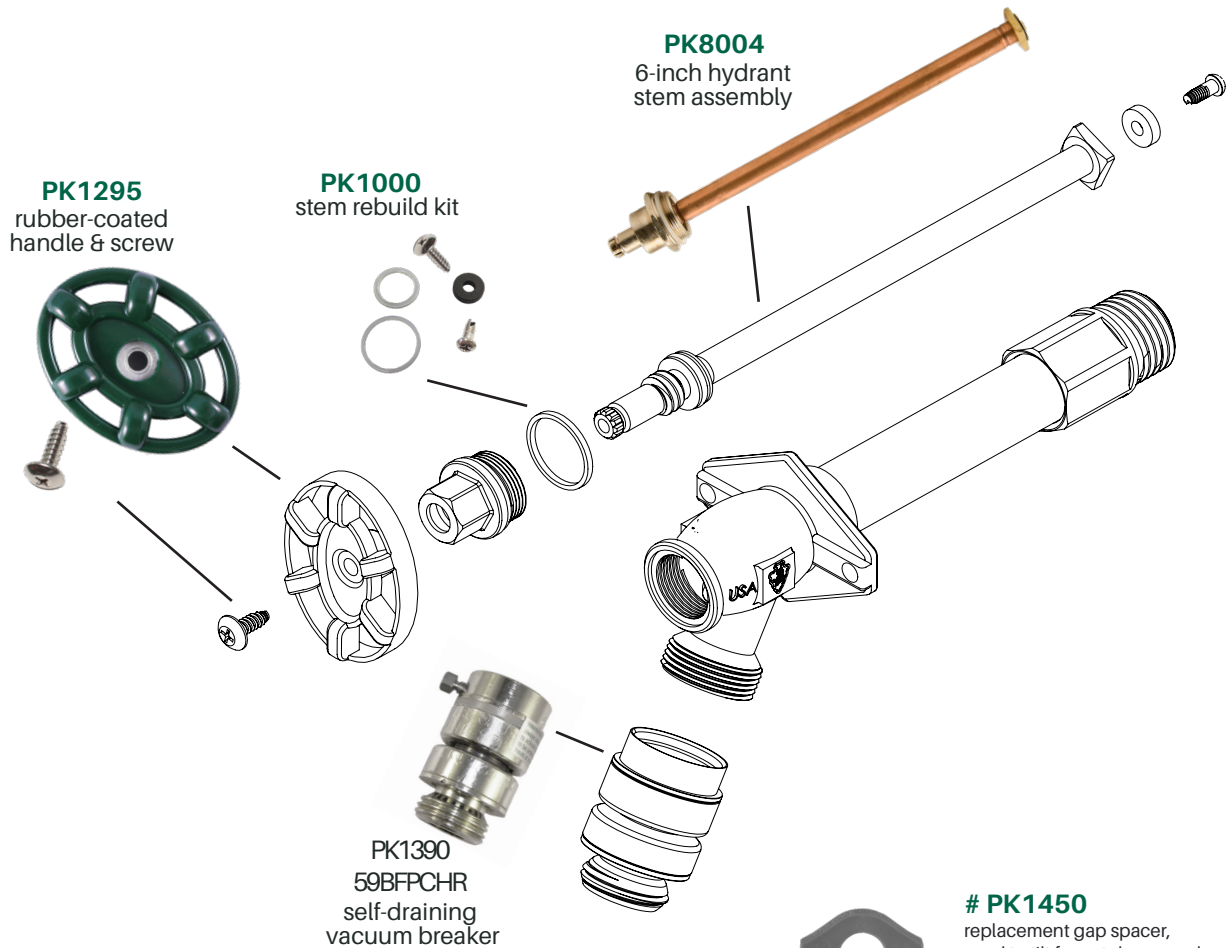

PK1450
replacement gap spacer,
used to tilt faucet downward

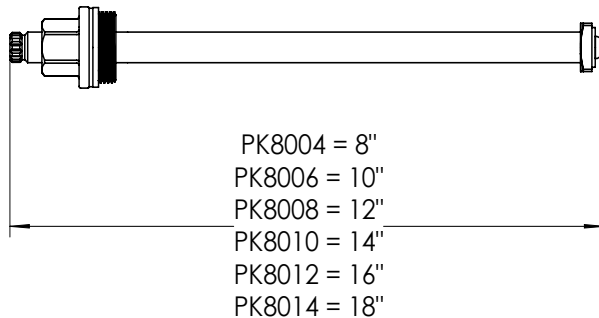

480 series stem
assembly

PK8006
6-inch hydrant stem assembly
(10" total length)

PK8008
8-inch hydrant stem assembly
(12" total length)

PK8010
10-inch hydrant stem assembly
(14" total length)

PK8012
12-inch hydrant stem assembly
(16" total length)

PK8014
14-inch hydrant stem assembly
(18" total length)



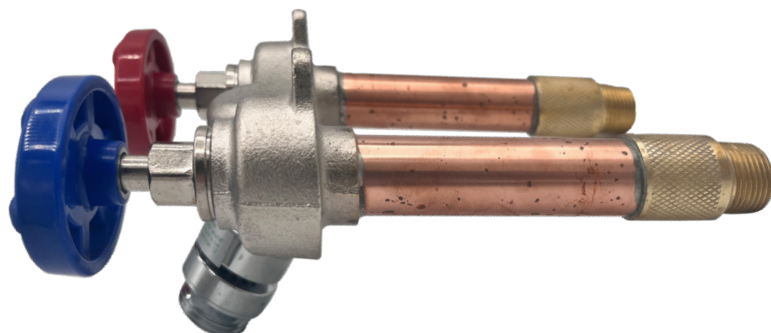

490 Series Hot & Cold A-S Hydrants



498-04LF



498-04VLF

Base Model	Inlet Connections		Case Qty
492-xxLF	1/2" Uponor - PEX A Inlet		24
495-xxLF	1/2" Female Pipe Thread ID / 3/4" Male Pipe Thread OD Inlet		24
496-xxLF	1/2" Copper Sweat ID / 1/2" Male Pipe Thread OD Inlet		24
498-xxLF	3/4" Copper Sweat ID / 3/4" Male Pipe Thread OD Inlet		24
499-xxLF	1/2" Crimp PEX (ASTM F1807) Inlet		24

Frost-Proof



Hot & Cold



Anti-Siphon



Lead-Free



Features

- Heavy-pattern lead-free brass
- NSF/ANSI 372 certified lead-free, IAPMO listed
- Hot & cold mixing, with color coded red & blue handles
- External self-draining vacuum breaker: drains hydrant upon shut-off to prevent freezing
- ASSE 1019-A approved, IAPMO certified
- Exclusive O-ring bonnet & stem design
- Available in 4, 6, 8, 10, 12 & 14 inch lengths (longer lengths available by special order)

490 Series Repair & Replacement Parts

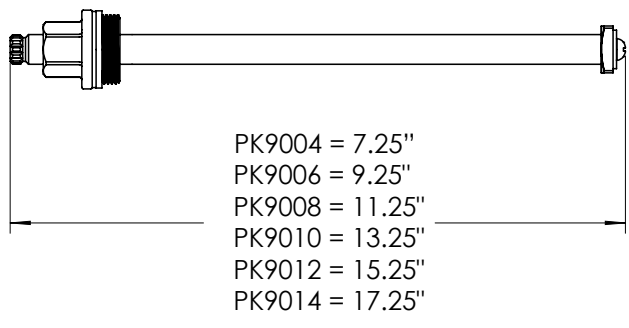
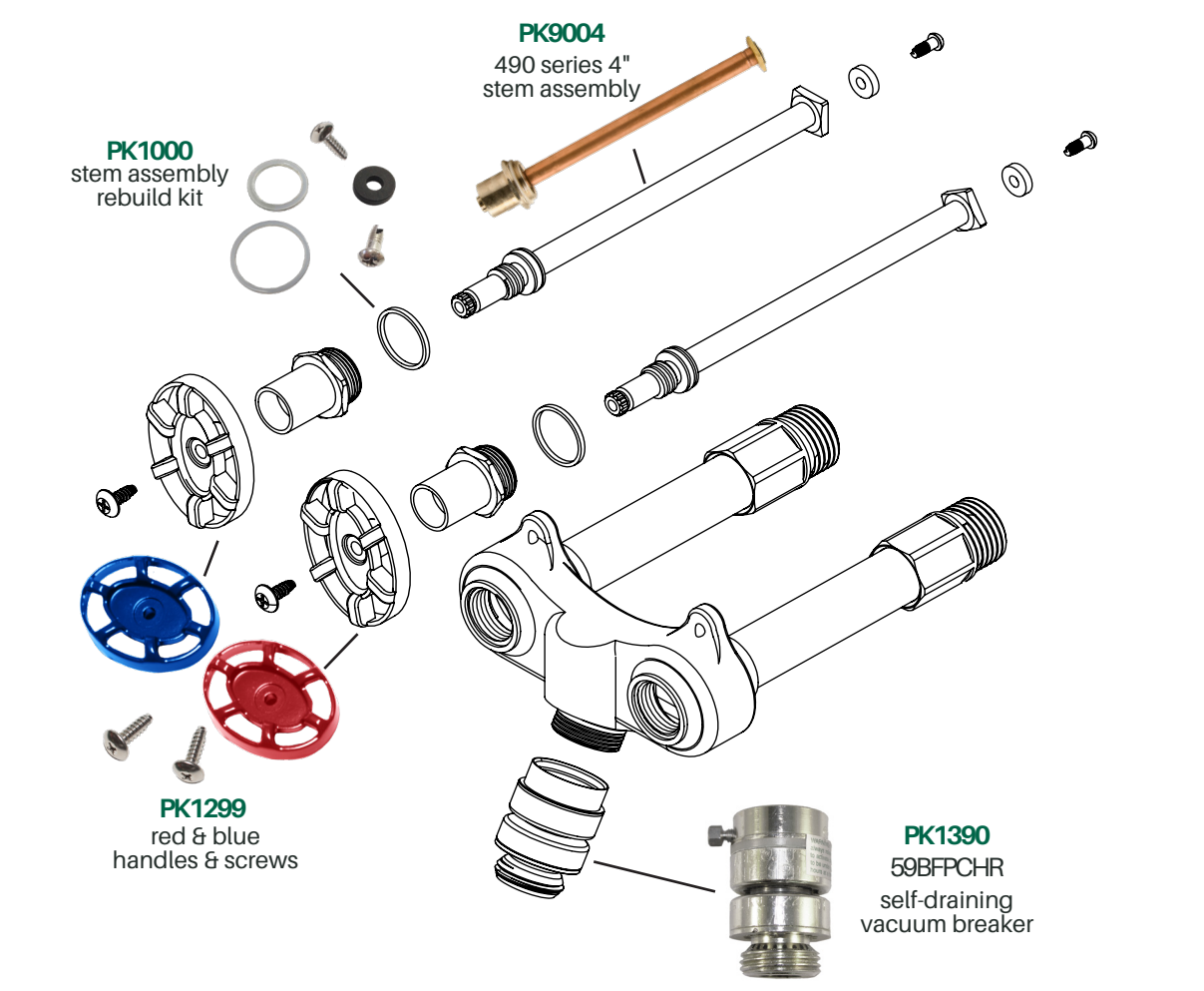







- 

490 series stem assembly
- # **PK9006**
6-inch hydrant stem assembly
(10" total length)
- # **PK9008**
8-inch hydrant stem assembly
(12" total length)
- # **PK9010**
10-inch hydrant stem assembly
(14" total length)
- # **PK9012**
12-inch hydrant stem assembly
(16" total length)

ICEBREAKER Freeze-Proof Wall Hydrants



Base Model	Inlet Connections		Case Qty
602-xxLF	1/2" Uponor - PEX A Inlet		24
604-xxLF	1/2" Push-Fit Inlet		24
605-xxLF	1/2" Female Pipe Thread ID / 3/4" Male Pipe Thread OD Inlet		24
606-xxLF	1/2" Copper Sweat ID / 1/2" Male Pipe Thread OD Inlet		24
608-xxLF	3/4" Copper Sweat ID / 3/4" Male Pipe Thread OD Inlet		24
609-xxLF	1/2" Crimp PEX (ASTM F1807) Inlet		24

Features

- Heavy-pattern lead-free brass
- NSF/ANSI 372 certified lead-free, IAPMO listed
- Pressure release vent to protect your home from burst pipes and severe water damage
- Exclusive O-ring bonnet & stem design
- Rubber-coated oval handle
- 5-year limited warranty
- Available in 4, 6, 8, 10, 12 & 14-inch lengths (longer lengths available by special order)

ICEBREAKER Freeze-Proof Wall Hydrants

Installation Use & Requirements

- The correct ICEBREAKER wall hydrant length must be used to ensure the inlet connection is located in a heated area of the building.
- To help prevent leaks all gaps between the wall and the ICEBREAKER hydrant must be sealed.
- The ICEBREAKER wall hydrant must be installed at a downward angle towards the hose outlet.
- The ICEBREAKER wall hydrant must have adequate insulation around the wall hydrant and wallboard. The ICEBREAKER wall hydrant must be turned off during cold weather.

Repair & Upgrade Kits

Vent Assembly Replacement



PK-ICE

Replacement ICEBREAKER vent assembly

ICEBREAKER Upgrade Kit



UK-ICE

ICEBREAKER upgrade kit - Vent assembly with blue handle and screw



PK8002

2-inch hydrant stem assembly (6" total length)

PK8004

4-inch hydrant stem assembly (8" total length)

PK8006

6-inch hydrant stem assembly (10" total length)

PK8008

8-inch hydrant stem assembly (12" total length)

PK8010

10-inch hydrant stem assembly (14" total length)

PK8012

12-inch hydrant stem assembly (16" total length)

PK8014

14-inch hydrant stem assembly (18" total length)



pictured UK-ICE

Stainless Steel Wall Hydrants



466SS

460SS:

- Available lengths: 2", 4", 6", 8", 10", 12", 14"
- 316 marine / food-grade stainless steel
- 1/2" Sweat ID x 1/2" Male Pipe Thread OD
- Corrosion Resistance- ensures long service life
- Gets colder---gets stronger
- 1019-A IAPMO certified
- NSF/ANSI 372 Certified



482SS

480SS:

- **482SS** 1/2" Uponor - PEX A ID x 1/2" Male Pipe Thread OD - Available lengths: 4", 6", 8", 10"
- **486SS** 1/2" Sweat ID x 1/2" Male Pipe Thread OD - Available lengths: 2", 4", 6", 8", 10", 12"
- **489SS** 1/2" Crimp PEX ID - Available lengths: 8", 10"
- Factory installed vacuum breaker
- 316 Marine / Food-grade stainless steel
- 1019-A IAPMO certified
- NSF/ANSI 372 Certified



486ESS

486ESS---Economy:

- 316 marine / food-grade stainless steel
- Corrosion Resistance- ensures long service life
- 1/2" Sweat ID x 1/2" Male Pipe Thread OD
- Factory installed vacuum breaker
- Gets colder---gets stronger
- Available lengths: 2", 4", 6"

Bulk Economy Wall Hydrants

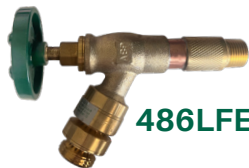

486LFE-02



486LFE-04



486LFE-06

486E bulk:

- Designed specifically for new construction
- Economy variant of our 486 model
- Factory installed vacuum breaker
- 1/2" Copper Sweat ID x 1/2" Male Pipe Thread OD
- 1019-A IAPMO certified
- NSF/ANSI 372 Certified
- Available lengths: 2, 4, 6, 8, 10"

500 Series Commercial Hydrant



ACH2

ACH2 - SIDE VIEW

500 Series Commercial Hydrants:

- Non-freeze and anti-siphon
- Automatic draining
- Quater-turn loose-key on/off access
- Ceramic Cartridge
- Lead-free
- 3/4" MIP x 3/4" SWT
- Complete with a built in vacuum breaker
- cUPC CERTIFIED, NSF/ANSI 61 & 372
- ASSE 1019-B
- Available lengths: 2", 4", 6", 8", 10"

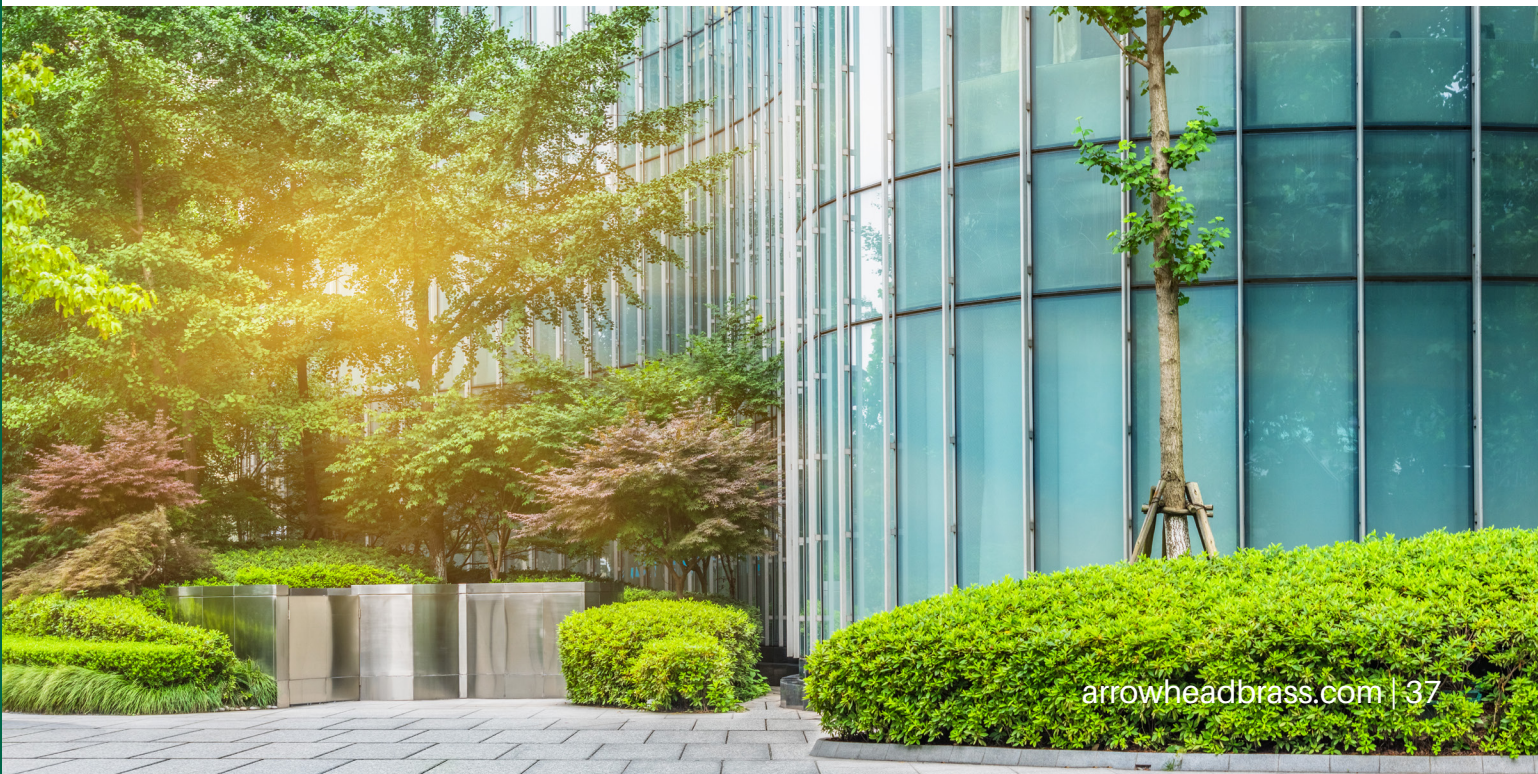





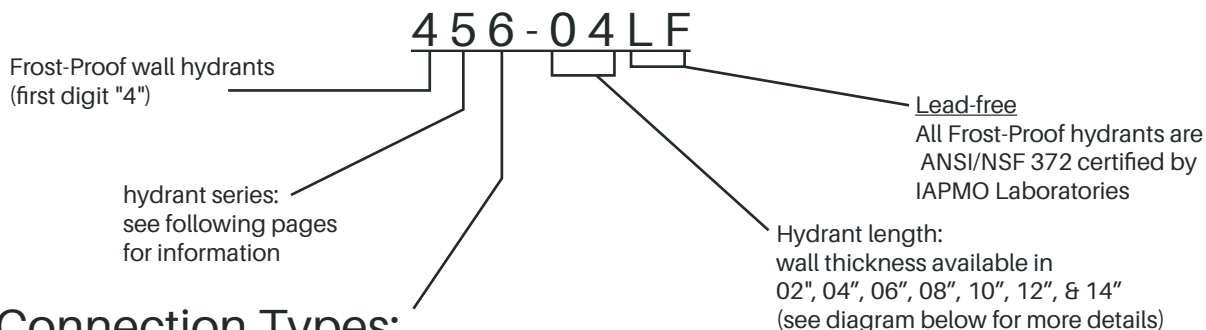

Wall Hydrants Installation & Repair Guide

Frost-Proof Model # Identification:



Inlet Connection Types:

<u>2</u>	1/2" Uponor style Pex	 1.7"
<u>4</u>	Push-Fit	 1.6"
<u>5</u>	dual connections 1/2" female pipe thread ID. 3/4" male pipe thread OD.	 1.80"
<u>7</u>	dual connections: 1/2" copper sweat ID. 1/2" male pipe thread OD.	 1.75"
<u>8</u>	dual connections: 3/4" copper sweat ID. 3/4" male pipe thread OD.	 1.75"
<u>9</u>	1/2" PEX (crimp type)	 1.4"

How to Measure a Frost-Proof Stem:

1- identify the model of frost-proof hydrant installed

2- measure overall length of the stem assembly



3- subtract 4" & add to PK #:

PK2004: 8" overall length stem for 420 Series hydrant with 4" wall depth

Hydrant Dimensions

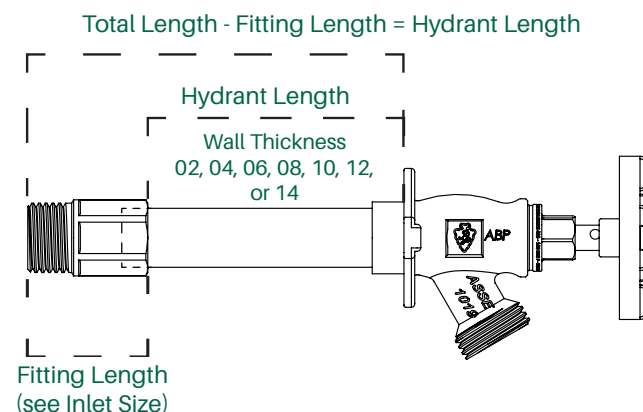

This ASSE 1019 device shall not be subjected to more than 12 hours of continuous water pressure.

Wall Hydrants Installation & Repair Guide

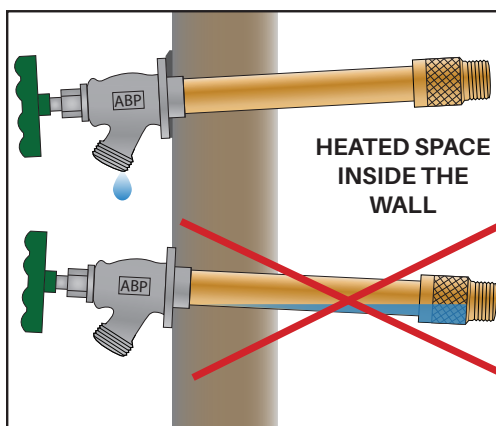

- Frost-proof wall hydrants are designed to prevent damage from freezing water in plumbing systems. Frost-proof wall hydrants separate the water supply from the cold weather by shutting off flow at the heated area inside wall.
- For a frost-proof wall hydrant to work properly, it must be installed at a slight downward angle toward the spout (as shown to left) so water will drain when it is shut-off. The gap spacer wedge sold with every Arrowhead Brass frost-proof hydrant should be used to ensure proper installation with a downward tilt.
- If the hydrant is installed level or at an upward angle, water will not drain properly and may freeze inside the faucet and cause the copper tube to burst.

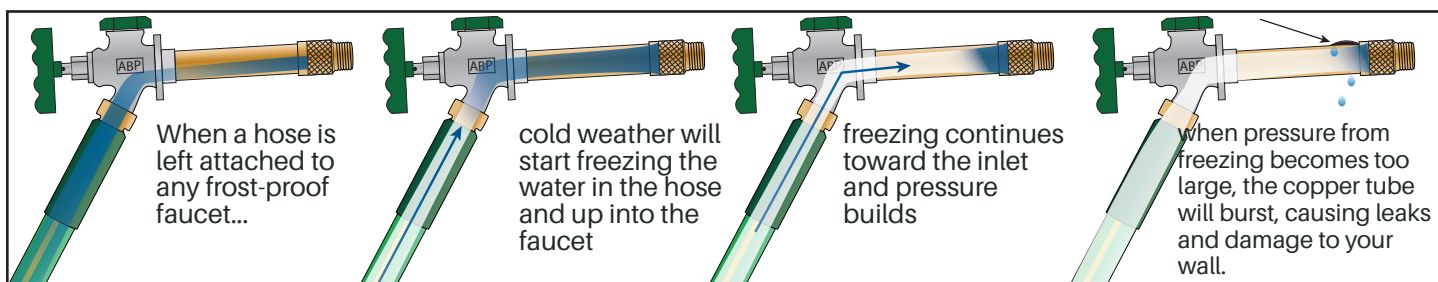

When a hose or other restriction is left attached to the faucet (such as an irrigation timer, “y” hose splitter, or add-on back-flow preventer), water will not drain from the faucet properly. Water inside the hose will begin to freeze upward toward the back, or “seat”, of the faucet, and the pressure inside the copper tubing will exceed capacity and burst. This will cause leaks within the wall, usually after some time when the faucet is turned on next, and can cause considerable damage. Frost-proof wall hydrants are designed in such a way that this sort of damage can be avoided as long as the user ensures the faucets are angled downward and all hoses/devices are removed so the faucets can drain.

The only cause of a burst frost-proof hydrant is water expansion from freezing inside the copper tube that was not drained properly. Properly installed valves (with downward tilt) will always drain unless a hose or other device was left attached.



- gray gap spacer included with every wall hydrant. Labeled: “REMOVE HOSE IN FREEZING WEATHER”
- use to tilt hydrant downward to allow draining

Wall Hydrants Installation & Repair Guide

420 Series Trouble Shooting

leaking out of the weep hole during use:

- Cause: worn out O-ring on inside of check assembly. Occurs over time or if the faucet is left "ON" for long periods of time.
- Solution: faucet installed after 1999 or the faucet stem check assembly is spring-less replace with PK2016 check assembly or full stem PK2004-PK2014.

leaking out of the green cap air-vent:

- Cause: worn, broken or missing parts.
- Solution: remove old parts and replacing with PK1430 components.
- Follow assembly diagram.

leaking faucet with spring-loaded check:

- Cause: worn out parts and seals
- Solution: replace stem assembly with a "SP" stem (PK-2004SP-PK2014SP) with added 1/4 " length or replace hydrant.

leaking when "OFF":

- Cause: worn washer or broken faucet seat.
- Solution: replace the check-assembly or entire stem.
- If replacement parts do not work, contact Arrowhead Brass

450 Series Trouble Shooting

leaking when "OFF":

- Cause: worn out washer or broken faucet seat.
- Replace entire stem [PK8004-PK8014]- suggested.
- Replace seat washer & screw at end of the stem [PK1000].
- If original stem is not a standard length (even lengths 4"-18" total length), special order stems are available.

leaking out of the packing nut or bonnet:

- Cause: loose bonnet or worn out seals in the bonnet.
- If the bonnet has the old 2-piece style with graphite packing, suggested to replace stem [PK8004-PK8014].
- If the bonnet is the new O-ring style, repair stem with PK1000.

460 Series Trouble Shooting

leaking hose thread when off:

- Cause: worn out washer or broken faucet seat.
- Repair by replacing the spring-less check assembly (PK6026) or replacing the entire stem assembly (PK6004-PK6014).
- If faucet continues to leak when OFF, the faucet seat might be broken and the faucet will need to be replaced.

leaking out of the packing nut or bonnet:

- Cause: loose bonnet or worn out seals in the bonnet.
- If tightening the bonnet does not stop leaking from the threads, replace nylon washer (in PK1000) or the entire stem (PK6004-PK6014).

leaking out of the Weep Hole during use:

- Cause: worn out O-ring on the check assembly. this happens over time or if the faucet is left "ON" for long periods of time (over 12 hrs).
- Repair by replacing the spring-less check assembly (PK6026).
- If the leak still occurs, replace the entire stem assembly (PK6004-PK6014).

480 Series Trouble Shooting

leaking vacuum breaker:

- Cause: worn out gasket and seals caused by age or when left pressurized (turned on) for long periods of time.
- Repair by replacing vacuum breaker with PK1390 or 59BFPCR.
- Ensure all sections of vacuum breaker have been removed.
- Use liquid thread sealant when installing replacement vacuum breaker.

leaking when off:

- Cause: worn out washer or broken faucet seat.
- Replace stem (PK8004 - PK8014) or rebuild stem with part kit PK1000.
- If leak persists, replace the faucet.

Accessories

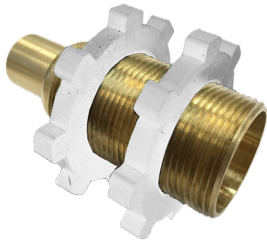

55CC

55CC

1/2" sweat x MIP
straight shower
head adapter
Weight(lbs) 0.324
Pack Qty 18
Case Qty 108

Features

- Brass adapter with 2 nylon nuts
- Straight or angle configuration
- 1/2" sweat x 1" MIP thread

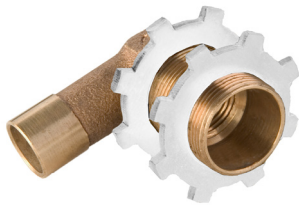

56CC

56CC

1/2" sweat x 1" MIP
angle shower head
adapter
Weight(lbs) 0.324
Pack Qty 18
Case Qty 108



PK-HBL

PK-HBL

Hose bib lock
Weight(lbs) 0.35
Pack Qty 12
Case Qty 24

Features

- Protect your hose bib from unwanted use
- Sold in retail packaging
- For use with any padlock (not included)

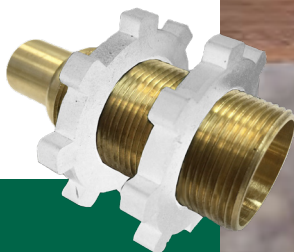

pictured 55CC



Push-Fittings

RGC series



RGC50

REDIGRIP Push-Fit Coupler
lead-free
1/2" x 1/2"
Weight 0.159

RGC75

REDIGRIP Push-Fit Coupler
lead-free
3/4" x 3/4"
Weight 0.251

RGC100

REDIGRIP Push-Fit Coupler
lead-free
1" x 1"
Weight 0.43



RGC75-R

REDIGRIP Push-Fit
Coupler
reducing coupling
lead-free
3/4" x 1/2"
Weight 0.196

RGC100-R

REDIGRIP Push-Fit
Coupler
reducing coupling
lead-free
3/4" x 3/4"
Weight 0.353

RGE series



RGE50

REDIGRIP Push-Fit Elbow
lead-free
1/2" x 1/2"
Weight 0.201

RGE75

REDIGRIP Push-Fit Elbow
lead-free
3/4" x 3/4"
Weight 0.304

RGE100

REDIGRIP Push-Fit Elbow
lead-free
1" x 1"
Weight 0.575



RGE75-R

REDIGRIP Push-Fit
Reducing Elbow
lead-free
3/4" x 1/2"
Weight 0.26

RGE50-F

REDIGRIP Push-Fit
drop ear 90° elbow
FNPT with
mounting flange
lead-free
1/2" x 1/2"
Weight 0.353

RGT series



RGT50

REDIGRIP Push-Fit Tee
lead-free
1/2" x 1/2" x 1/2"
Weight 0.304

RGT75

REDIGRIP Push-Fit Tee
lead-free
3/4" x 3/4" x 3/4"
Weight 0.454

RGT100

REDIGRIP Push-Fit Tee
lead-free
1" x 1" x 1"
Weight 0.772



RGT75-R

REDIGRIP Push-Fit Tee
lead-free
3/4" x 1/2" x 1/2"
Weight 0.337



RGT100-RS

REDIGRIP Push-Fit Tee
lead-free
1" x 1" x 3/4"
Weight 0.639



RGT75-RT

REDIGRIP Push-Fit Tee
lead-free
3/4" x 1/2" x 3/4"
Weight 0.386

RGEA series



RGEA50M50

REDIGRIP Push-Fit Elbow
Adapter
lead-free
1/2" x 1/2" MNPT
Weight 0.216

RGEA50F50

REDIGRIP Push-Fit Elbow
Adapter
lead-free
1/2" x 1/2" FNPT
Weight 0.196

Push-Fittings

Features

- Forged lead-free brass construction
- IAPMO certified and list to NSF/ANSI 61 and ASSE 1061
- For use in potable water and hydronic heating and water distribution
- Easily connects to copper, CPVC, or PEX
- Approved for underground and behind-the-wall installations
- Available in 1/2, 3/4, and 1-inch sizes
- Max pressure: 232 PSI
- Max temperature: 203° F

RGAM series

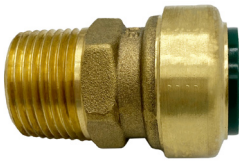

RGAM50M

REDIGRIP Push-Fit Adapter
lead-free
1/2" x 1/2" MNPT
Weight 0.216

RGAM50M75

REDIGRIP Push-Fit Adapter
lead-free
1/2" x 3/4" MNPT
Weight 0.218

RGAM75M75

REDIGRIP Push-Fit Adapter
lead-free
3/4" x 3/4" MNPT
Weight 0.196

RGAM100M100

REDIGRIP Push-Fit Adapter
lead-free
1" x 1" MNPT
Weight 0.401

RGAM100M75

REDIGRIP Push-Fit Adapter
lead-free
1" x 3/4" MNPT
Weight 0.353

RGP series



RGP50

REDIGRIP Push-Fit End Cap
lead-free
1/2"
Weight 0.077

RGP75

REDIGRIP Push-Fit End Cap
lead-free
3/4"
Weight 0.13

RGP100

REDIGRIP Push-Fit End Cap
lead-free
1"
Weight 0.258

RGA series

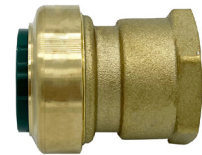

RGA50F50

REDIGRIP Push-Fit Adapter
lead-free
1/2" x 1/2" FNPT
Weight 0.157

RGA50F75

REDIGRIP Push-Fit Adapter
lead-free
1/2" x 3/4" FNPT
Weight 0.181

RGA75F75

REDIGRIP Push-Fit Adapter
lead-free
3/4" x 3/4" FNPT
Weight 0.223

RGA100F100

REDIGRIP Push-Fit Adapter
lead-free
1" x 1" FNPT
Weight 0.353

Push-Fit Release Tool



RGR50

Push-Fit
release tool
1/2"
Weight 0.013

RGR75

Push-Fit
release tool
3/4"
Weight 0.018

RGR100

Push-Fit
release tool
1"
Weight 0.031

Self-Draining Vacuum Breakers

Features

- Lead-free brass self-draining vacuum breaker
- Allows faucet to drain upon shut-off to prevent freezing
- Includes set screw to prevent device removal
- Fine thread (BFP) inlet used to connect to Arrowhead Brass valves with fine threaded connections
- ASSE 1011 approved, IAPMO certified

PK1380



PK1380

Self-Draining
vacuum breaker
1-1/16"
fine thread
Weight(lbs) 0.260
Pack Qty 12
Case Qty 72



pictured PK1390



PK1390



PK1390

Self-Draining
vacuum breaker
1-1/16"
fine thread
polished chrome
Weight(lbs) 0.270
Pack Qty 12
Case Qty 72

PK1400



PK1400

Self-Draining
vacuum breaker
3/4" FHT
Weight(lbs) 0.270
Pack Qty 12
Case Qty 72

PK1395



PK1395

Self-Draining
vacuum breaker
3/4" FHT
polished chrome
Weight(lbs) 0.270
Pack Qty 12
Case Qty 72

Vacuum Breakers

58ABP



58ABP

Vacuum breaker
3/4" hose thread
Weight(lbs) 0.204
Pack Qty 20
Case Qty 72

58ABPCHR



58ABPCHR

Vacuum breaker
3/4" hose thread
chrome plated
Weight(lbs) 0.204
Pack Qty 20
Case Qty 72

Features

- Lead-free back-flow preventers: protect your drinking water from harmful contaminants
- Hose thread (ABP) & fine thread (BFP) models
- ASSE 1011 approved; IAPMO listed
- Individually boxed or in "PK" clamshell
- VB75: for light-duty vacuum

PK1360



PK1360

Vacuum breaker
3/4" fine thread
Weight(lbs) 0.204
Pack Qty 12
Case Qty 72

PK1370



PK1370

Vacuum breaker
3/4" fine thread
chrome-plated
Weight(lbs) 0.737
Pack Qty 12
Case Qty 72

VB75F



VB75

Light-duty vacuum
breaker
3/4" hose thread
Weight(lbs) 0.15
Pack Qty 1
Case Qty 10

Replacement Handles

PK1250



PK1250

Replacement green wheel handle (12 pt) & screw
Pack Qty 12
Case Qty 72

PK1260



PK1260

Replacement tee handle (12 pt) & screw
Pack Qty 12
Case Qty 72

PK1270



PK1270

Replacement green tee handle (12 pt) & screw
Pack Qty 12
Case Qty 72

PK1280



PK1280

Replacement chrome tee handle (12 pt) & screw
Pack Qty 12
Case Qty 72

PK1290



PK1290

Replacement green oval handle (12 pt) & screw
Pack Qty 12
Case Qty 72

PK1295



PK1295

Replacement rubber-coated green oval handle (12 pt) & screw
Pack Qty 12
Case Qty 72

PK1297



PK1297

Replacement 470 series green oval handle (12 pt) & screw
Pack Qty 12
Case Qty 72

PK1299



PK1299

Red & blue oval handles (12 pt) & screws for 490 series
Pack Qty 12
Case Qty 72

Features

- All handles have a 12-point spline broach and are completely interchangeable, (excluding the loose key- PK1300 & Freeze-Proof® 470 series handle- PK1297)
- All handles are made out of die-cast aluminum
- Kits include our self-tapping stainless steel screw
- Sold in clamshell package
- bulk handles & screws available by special order, contact Arrowhead Brass for details
- Part kits are assembled in Los Angeles, CA, using domestic and some foreign components

PK1300



PK1300

Replacement removable loose key
Pack Qty 12
Case Qty 72

Hose Bib Repair

Features

- Low-lead brass components
- Stainless steel screws
- Long-lasting EPDM washers and O-rings
- Bulk components available, please contact Arrowhead Brass for details
- Part kits are assembled in Los Angeles, CA, using domestic and some foreign components

PK1000



PK1000

Stem washer, screw, nylon washers & handle screws
Pack Qty 12
Case Qty 72

PK1100



PK1100

Replacement hose bib stem assembly
Pack Qty 12
Case Qty 72

PK1110



PK1110

Replacement hose bib stem assembly
nickel-plated
Pack qty 6
Case Qty 36

PK1130

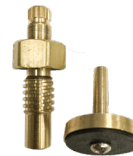

PK1130

Stem assembly for old style 900 garden valves
Pack qty 12
Case Qty 72

PK1140



PK1140

Replacement o-ring stem & assembly 925LF & 975LF.
Pack qty 12
Case Qty 72

PK1150



PK1150

Replacement LK hose bib stem assembly
Pack Qty 12
Case Qty 72

PK1155



PK1155

Replacement LK hose bib stem assembly
nickel-plated
Pack Qty 12
Case Qty 72

PK1170

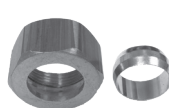

PK1170

1/2" compression kit
nickel-plated
Pack Qty 12
Case Qty 72

PK1180



PK1180

1/2" copper compression kit
Pack Qty 12
Case Qty 72

PK1200



PK1200

Hose attachment & plug for 248LF Washing machine valves
Pack Qty 12
Case Qty 72

PK1240



PK1240

Brass inlet nut for 2-piece garden valve (1")
Pack Qty 12
Case Qty 72

PK-QTASSY



PK-QTASSY

QuickTurn® assembly (fits all standard valves)
Pack Qty 12
Case Qty 72

PK1600



PK1600

Arrow-Breaker® stem assembly (fits 260, 360, & 965 series)
Pack Qty 12
Case Qty 72

PK1600LK



PK1600LK

Arrow-Breaker® lose key stem assembly (fits 260, 360, & 965 series)
Pack Qty 12
Case Qty 72

Hydrant Repair

PK2004



PK20XX

420 series
QuickTurn® style
stem kit
Pack Qty 6
Case Qty 12

PK6004



PK60XX

460 series
QuickTurn® style
stem kit
Pack Qty 6
Case Qty 12

PK8004



PK80XX

480 & 450 series
(multi-turn)
stem kit
Pack Qty 6
Case Qty 12

PK9004



PK90XX

490 series
style stem kit
Pack Qty 6
Case Qty 12

PK1000



PK1000

Stem rebuild
parts for 450 or
480 series
Frost-Proof wall
hydrants
Pack Qty 12
Case Qty 72

PK1430



PK1430

Replacement
air-vent assembly
Pack Qty 12
Case Qty 72

PK6026



PK6026

Replacement
460 series
anti-siphon
check assembly
Pack Qty 12
Case Qty 72

Features

- Low-lead brass components
- stainless steel screws
- Long-lasting EPDM washers and O-rings
- Bulk components available, please contact Arrowhead Brass for details
- Part kits are assembled in Los Angeles, CA, using domestic and some foreign components

Available Option



loose key

PK20__LK

LK: lock-shield stem
assembly

Select-A-Length Universal Stem Replacement Kit



SL14-ST

SL14ST

Select-A-Length
universal 4" - 14"
standard stem

AB wall hydrant replacement kit

Case Qty 24

Weight 0.077



SL14-AS

SL14-AS

Select-A-Length
universal 4" - 14"
anti-siphon stem

AB wall hydrant replacement kit

Case Qty 24

Weight 0.077

Select-A-Length Tools



Wrench & Screws

Features

- Lead-free universal replacement stem for genuine Arrowhead Brass wall hydrants
- Uses genuine Arrowhead Brass parts
- No need to remove the existing stem to determine the correct length
- Easy installation
- Instructions and template included
- ST model replaces 4" - 14" Arrowhead Brass standard stems (450, 480, and 490 series wall hydrants)
- AS model replaces 4" - 14" Arrowhead Brass anti-siphon stems (420 and 460 series wall hydrants)
- 3-year limited warranty

Arrowhead FAQs

Q: Why doesn't my replacement vacuum breaker (PK1390) fit on my faucet?

A: The PK1390 is comprised of 3 sections and in many instances only the middle and bottom collars are removed, and the top collar is still attached to the faucet. If the top collar does not twist off, use a heat source around the collar which should help loosen the connection and make it easier to remove.

Q: Why is there water dripping from behind the handle after the water is turned off?

A: The stem on our 420 & 460 series of anti-siphon hydrants comes with a weep hole located just behind the handle. It is designed to drain any excess water which may be inside the tube when the water is turned off. The drip typically lasts a few seconds and then stops. If water continues to drip after a minute or so, then it might be time to inspect the check assembly and possibly replace the stem.

Q: Can I attach a hose timer or Y-splitter to my Arrowhead Brass hydrant?

A: We do not recommend attaching a hose timer or Y-splitter. Arrowhead Brass hydrants are not designed to be pressurized (left open) for more than 12 hours. This includes sprinkler & drip timers or "Y" shutoffs.

Q: Can I leave my hose connected during the winter?

A: This is NOT recommended as it allows water to remain in the hose and the cold air flows back into the faucet and tube, and in freezing conditions this can result in the pipe bursting inside the walls and leading to property damage.

Q: Does Arrowhead Brass have repair kits for their hydrants that are over 20 years of age?

A: Arrowhead Brass does carry repair kits for older model hydrants, but there are some discontinued series where repair kits are limited or no longer available. These specific series are the 470 freeze-proof hydrant and the 455BFP Apache. Additionally, for hydrants that pre-date 1999, some will require special repair kits that could take longer to produce, and in all cases, they are not guaranteed to work and non-returnable.

Q: Sometimes I cannot find Arrowhead Brass repair kits or replacement parts; will another brand's repair kit work on my Arrowhead hydrant?

A: Arrowhead Brass repair kits and replacement parts are made specifically for Arrowhead Brass products, so we do not recommend using another brand's items on ours. Further, it negates any warranty coverage on the Arrowhead valves.

Q: I saw some of your products on Amazon and was wondering why you don't promote that or send your customers to this site.

A: We do not have any agreements with 3rd party sellers on Amazon.com. Any Arrowhead Brass product that is purchased on Amazon is at the risk of the purchaser and should anything go wrong, the purchaser will have to go back to the seller. Also, any Arrowhead Brass product sold on Amazon is not covered under warranty.

Q: Why are Arrowhead Brass products priced so high?

A: Arrowhead Brass products are made from the highest quality materials (i.e., brass, copper) and are typically heavier than lower priced competitive brands, and with the continued increase in costs of raw materials, labor, manufacturing and transportation require us to have a slightly higher price for our higher quality products. Additionally, Arrowhead Brass is a domestic brand where many competitors are made overseas and do not incur the same overhead costs that we do here.

Q: I have an Arrowhead Brass product and cannot find a certain repair part for it; can I use a different brand's product instead?

A: Arrowhead Brass repair kits/parts are made specifically for Arrowhead Brass products only. We do not recommend using a different brand item in one of our products as may cause more harm than good and will also negate any existing warranty coverage.

Q: Where can I purchase repair parts/kits for my Arrowhead Brass hydrants/hose bibs?

A: You can always try your local hardware store or plumbing supply store, as well as their websites. If that does not work, you can always contact our Product Support department for more details.



INTRODUCING **REDIFLO**

- Stainless steel frost-proof wall hydrant
- Clean, modern look
- Built-in vacuum breaker
- Lead-free



RELIABLE - PROVEN - TRUSTED - SINCE 1936

Terms and Conditions

TERMS:	Net 30 days after invoice date. All invoices mature from invoice date, not from receipt of invoice or material.
F.O.B.:	All sales are F.O.B. Factory. Will-calls not picked up after 5-days from notification will be shipped by common carrier under normal freight terms.
FREIGHT:	Prepaid to one location within the continental United States (48 contiguous states) on Net Invoice over \$1,500. All other shipments are shipped freight collect.
CREDIT:	Credit and eligibility for distributor prices must be established prior to initial order. Shipments will be held on accounts with unsatisfactory payment status. Past due accounts are subject to a monthly service charge.
PRICES:	Prices are subject to change without notice.
SHORTAGE:	Factory must be notified within 5 days from receipt of goods or shipment will be considered correct. No debits will be accepted until the factory determines final disposition.
PRODUCT DESIGN:	Manufacturer reserves the right to redesign, alter, or modify its product without incurring liability for customer inventory and future repair problems.
DEFECTIVE RETURNS:	Written Return Goods Authorization (RGA) must be obtained prior to returning any defective material. Freight must be prepaid by customer with proof of purchase or invoice number. Freight will be credited on warranty items only. Parts returned without proof of purchase will be credited at Company's discretion.
OVERSTOCK:	Written factory authorization must be obtained prior to any returns. A 30% restocking charge will be deducted from returned goods. All products are subject to inspection and, if found unsellable, will be discarded or returned at customers request and cost.

Limited Warranty

Arrowhead Brass warrants this products to be free from defects in material or workmanship, under normal use and service, for a period of three years from date of purchase by the original buyer (the "Warranty Period") from an authorized Arrowhead Brass dealer. Arrowhead Brass promises to replace or repair any part of this product that proves to be defective in material or workmanship during the warranty period. Company's liability is solely limited to original purchase price of the parts or products and no payment will be made for consequential or incidental costs or damages that may have been caused by part of product failure. Buyer's remedies are limited to return of the products and either repayment of the original purchase price or repair and/or replacement of nonconforming parts or products. **Products alleged to be defective must be returned to Company in a timely manner for inspection before any remedy may be applied.** The decision on how to remedy parts or products found to be defective will be made at the sole discretion of Arrowhead Brass. In no event shall Arrowhead Brass be liable for incidental or consequential damages, for damages resulting from improper installation, improper repair, or damages caused by neglect, abuse, or alteration. All implied warranties including any implied warranty of merchantability or fitness for any particular purpose are limited to a period of three years from the date of purchase. No person is authorized to change, add to, or create any warranty or obligation other than that set for here in. To obtain warranty service, contact your local dealer and/or contractor from whom you purchased this product. There are no warranties, express or implied, of the merchantability or fitness for a particular purpose, except as expressly described herein.



PROUD TO BE Lead-free

