

BOM			
ITEM	PART NUMBER	DESCRIPTION	QTY
1	408424	HEX HEAD SCREW 1/4-20 X 2.0IN 18-8 SS	2
2	419061	LOCK WASHER 1/4IN SPLIT 18-8 SS	6
3	407014	QUAD RING, RUBBER	2
4	408410	FLAT HEAD SRW 10-24 X 3/8IN PHILLIPS 18-8 SS	1
5	403008	SPACER, HOUSING, RYTON	1
6	426191	BRACKET QTZ MTG	1
7	624209	COUPLING TORQUE	1
8	414024	COUPLING QTZ DRIVE	1
9	408397	CUP PT SET SCREW 10-32 X 3/16IN 18-8 SS	2
10	408364	HEX HEAD SCREW 1/4-20 X 1/2IN 18-8 SS	4

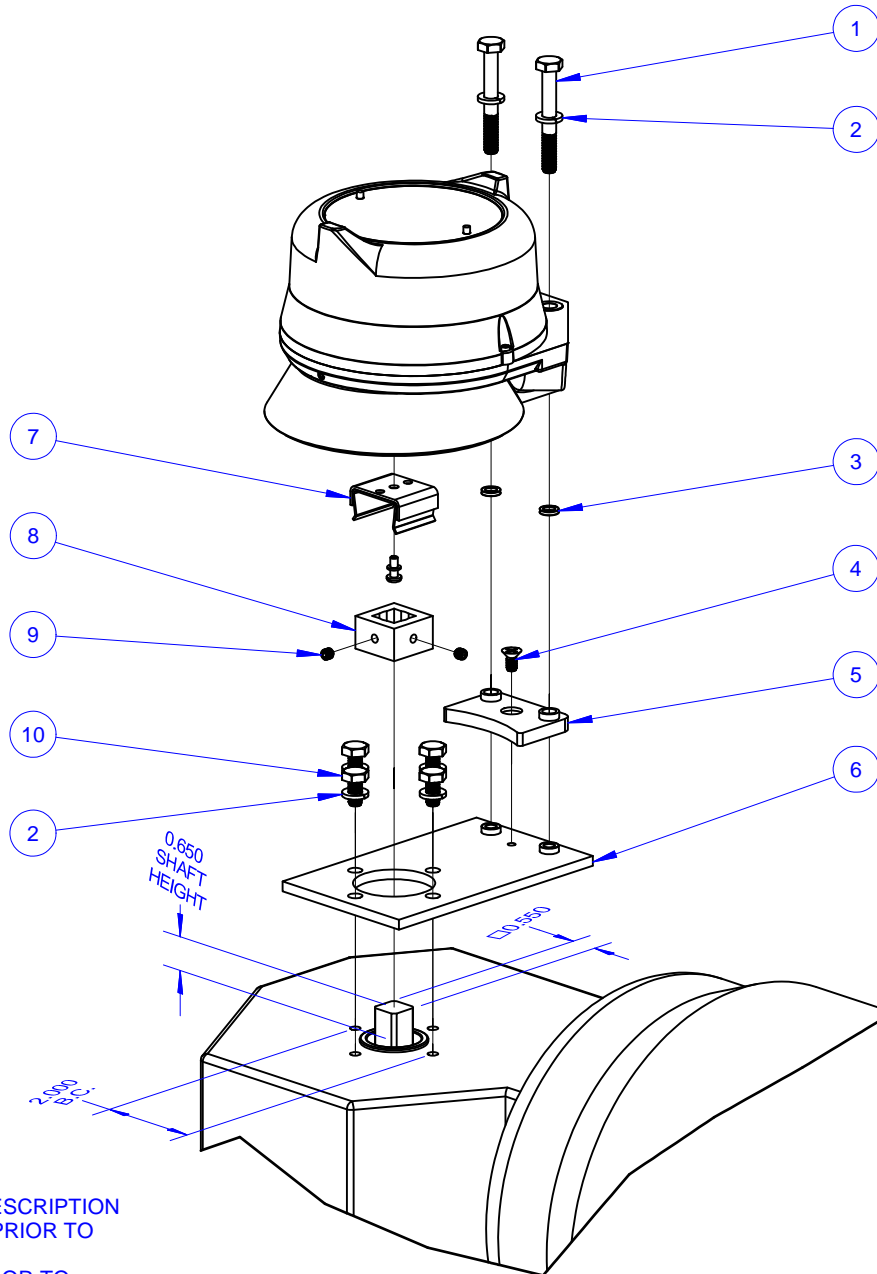

# NOTE:

- 1) SEE BOM FOR PART # AND DESCRIPTION
- 2) ASSEMBLE ITEMS 4, 5 AND 6 PRIOR TO PACKAGING KIT
- 3) ASSEMBLE ITEMS 8 AND 9 PRIOR TO PACKAGING KIT

REVISIONS	D	10472	02/11/15	MK	<div>CONFIDENTIAL</div> <div>THIS DRAWING AND ALL INFORMATION CONTAINED HEREIN IS THE PROPERTY OF AND IS SUBJECT TO CHANGE BY STONEL. DRAWING IS NOT TO BE REPRODUCED OR REVEALED TO ANY OTHER PARTY UNLESS AUTHORIZED BY STONEL.</div> <div><div>Stonel<sup>®</sup></div><div>METSO AUTOMATION, FERGUS FALLS, MN U.S.A.</div></div>			
	C	5987	06/25/10	MB				
	B	380	02/03/93	MMW				
	REVISION	ECO	DATE	BY				
TOLERANCES (UNLESS OTHERWISE SPECIFIED):				DR. BB	TITLE NELES-JAMESBURY, QP / QPX1 & 2			
X.XXX ± .005      ANGLES ± 0° 30'				CHK. BJ				
X.XX ± .010      FINISH f 125 RMS				APPD. GN				
X/X ± .015					SCALE 1:3.5	SHEET 1 OF 1	DRAWING NO.	REV.
					SIZE A	DATE 2/12/2015	795101	D