

BOM			
ITEM	PART NUMBER	DESCRIPTION	QTY
1	408426	HEX HEAD SCREW 1/4-20 X 2 1/2IN 18-8 SS	2
2	419061	LOCK WASHER 1/4IN SPLIT 18-8 SS	2
3	419146	FLAT WASHER 1/4IN 18-8 SS	2
4	407014	QUAD RING, RUBBER	2
5	408537	FLAT HEAD SCREW 10-24 X 3/4" PHILLIPS, 18-8 SS	1
6	403024	SPACER HOUSING HALF RYTON	1
7	403009	SPACER, HOUSING, RYTON	2
8	444504	BRACKET QTZ MTG, SS	1
9	414208	COUPLING DRIVE	1
10	408031	PACKAGE QTZ SCREW ISO-NAMUR SS	1

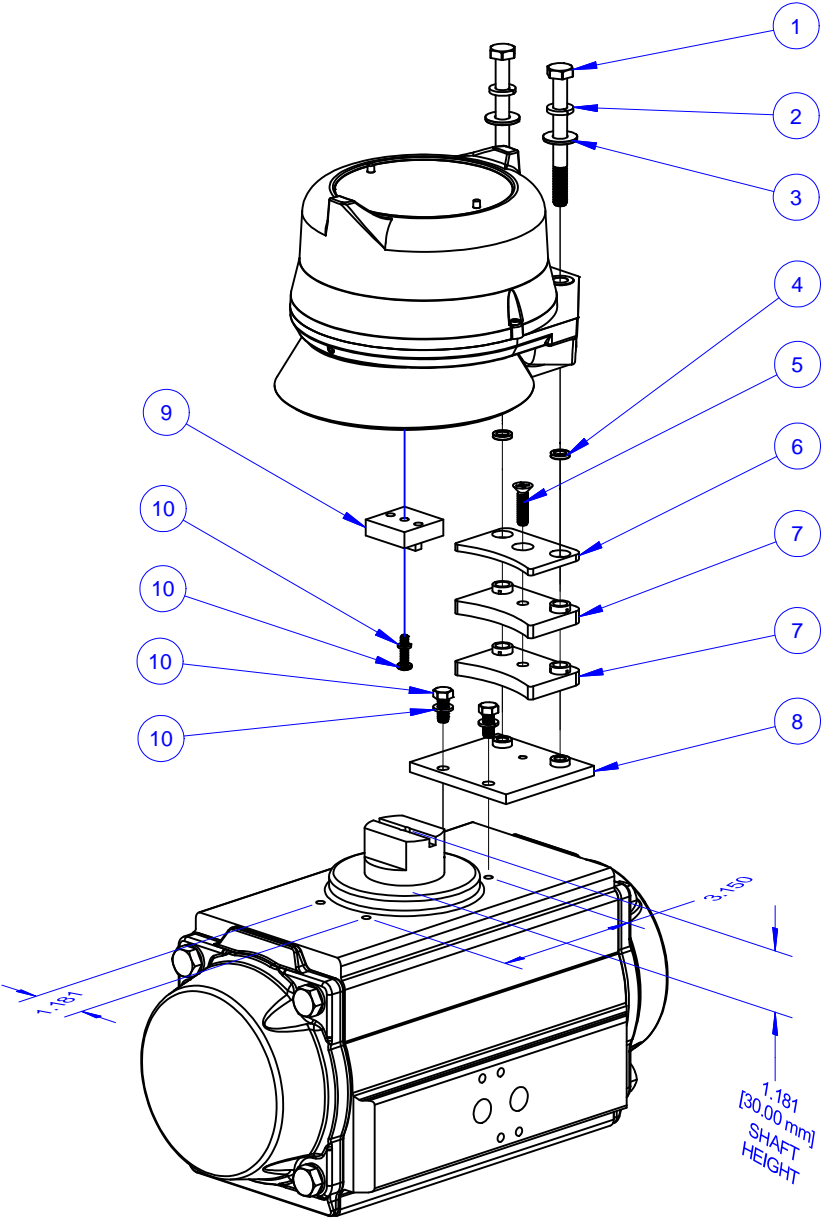

NOTE:
 1) SEE BOM FOR PART # AND DESCRIPTION.
 2) ASSEMBLE ITEMS 5, 6, 7, AND 8 PRIOR TO PACKAGING KIT.

REVISIONS	D	10047	09/09/2014	MB	CONFIDENTIAL THIS DRAWING AND ALL INFORMATION CONTAINED HEREIN IS THE PROPERTY OF AND IS SUBJECT TO CHANGE BY STONEL. DRAWING IS NOT TO BE REPRODUCED OR REVEALED TO ANY OTHER PARTY UNLESS AUTHORIZED BY STONEL.			<div>Stonel®</div> <div>METSO AUTOMATION, FERGUS FALLS, MN U.S.A.</div>			
	C	5804	03/08/2010	MB							
	B	5533	12/24/2009	MB							
	REVISION	ECO	DATE	BY							
TOLERANCES (UNLESS OTHERWISE SPECIFIED): X.XXX ± .005 ANGLES ± 0° 30' X.XX ± .010 FINISH f 125 RMS X/X ± .015				DR.	BL	TITLE					
				CHK.	BB	SCALE 1:3.5		SHEET 1 OF 1	DRAWING NO.		REV.
				APPD.	RK	SIZE A		DATE 2/4/2000	960102		D