

March 2004

## Type R622-LBW Regulator

### Introduction

This installation sheet covers the installation, startup, and adjustment procedures for Type R622-LBW pressure reducing regulator. These regulators have internal relief to help minimize overpressurization of the downstream system.

### Specifications<sup>(1)</sup>

#### Maximum Allowable Inlet Pressure

10 psig (0,69 bar)

#### Maximum Emergency Outlet Pressure

20 psig (1,4 bar)

#### Maximum Operating to Avoid Internal Part Damage

3 psid (0,21 bar d) above outlet pressure setting

#### Outlet Pressure Ranges

13 to 20-inches w.c. (32 to 50 mbar)

#### Material Temperature Capabilities

-40° to 160°F (-40° to 71°C)

### Installation



#### WARNING

**Personal injury, equipment damage, or leakage due to escaping accumulated gas or bursting of pressure-containing parts may result if this regulator is overpressured or is installed where service conditions could exceed the limits given in the Specifications. To avoid such injury or damage, provide pressure-relieving or pressure-limiting devices to prevent service conditions from exceeding those limits. Also, physical damage to the regulator can result in personal injury or property damage due to escaping gas. To avoid such injury and damage, install the regulator in a safe location.**

1. Only personnel qualified through training and experience should install, operate, and maintain a regulator. Before installing, check for damage which may have occurred in shipment. Also check the regulator and pipeline for debris.

2. The Type R622-LBW may be installed in any position. Apply a good grade of pipe compound to the male threads of the pipe (being sure not to apply pipe compound to flow path of the pipe) and install the regulator so that the flow is in the direction of the arrow cast on the body. Use approved piping procedures when installing the regulator.



#### WARNING

**A regulator may vent some gas to the atmosphere. In hazardous or flammable gas service, vented gas may accumulate, and cause personal injury, death, or property damage due to fire or explosion. Vent a regulator in hazardous gas service to a remote, safe location away from air intakes or any hazardous location. The vent line or stack opening must be protected against condensation or clogging. Under enclosed conditions, the vent should be piped away from the regulator to a safe location.**

3. On outdoor installations, regulators installed with vents in positions other than vertically down require additional vent protection from the elements.
4. Regulator operation within ratings does not preclude the possibility of damage from debris in the lines or from external sources. A regulator should be inspected for damage periodically and after any overpressure condition.
5. To adjust the regulator, monitor downstream pressure with a gauge during the adjustment procedure. To increase the outlet pressure, the adjustment screw (key 23, Figure 1) must be turned clockwise. This requires removal of the closing cap (key 31, Figure 1). To reduce the outlet pressure setting, turn the adjusting screw counterclockwise. Do not adjust the spring above the limit stamped on the regulator.

1. The pressure/temperature limits in this installation sheet, and any applicable code or standard limitations, should not be exceeded.



# Type R622-LBW

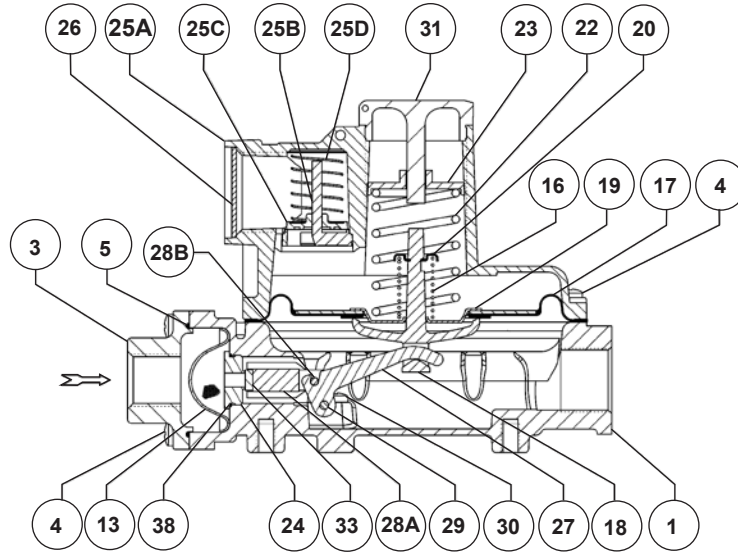

T80577

Figure 1. Type R622 Regulator

## Parts List

| Key | Description    | Key | Description       | Key | Description            | Key | Description       |
|-----|----------------|-----|-------------------|-----|------------------------|-----|-------------------|
| 1   | Body           | 10  | O-ring            | 20  | Relief Spring Retainer | 29  | Pin Lever         |
| 2   | Pipe Plug      | 11  | Disc Assembly     | 22  | Spring                 | 30  | Machine Screw     |
| 3   | Inlet Fitting  | 13  | Inlet Screen      | 23  | Adjusting Screw        | 31  | Closing Cap       |
| 4   | Machine Screw  | 15  | Vent Screen       | 24  | Orifice                | 33  | Disc              |
| 5   | O-ring         | 16  | Relief Spring     | 25  | Spring Case Assembly   | 38  | O-ring            |
| 6   | Closing Spring | 17  | Diaphragm         | 26  | Vent Screen            | 40  | Set Spring        |
| 7   | Diaphragm      | 18  | Pusher Post       | 27  | Lever                  | 41  | Information Label |
| 8   | Diaphragm Head | 19  | Lower Spring Seat | 28  | Stem Assembly          | 43  | Packaged Screws   |
| 9   | Orifice        |     |                   |     |                        |     |                   |

### Regulator Division Industrial

USA - Headquarters  
McKinney, Texas 75070 USA  
Tel: 1-800-558-5853  
Outside U.S. 1-469-293-4201

Asia-Pacific  
Shanghai, China 201206  
Tel: +86 21 2892 9000

Europe  
Bologna, Italy 40013  
Tel: +39 051 4190611

### Regulator Division Natural Gas Technologies

USA - Headquarters  
McKinney, Texas 75070  
Tel: 1-800-558-5853  
Outside U.S. 1-469-293-4201

Asia-Pacific  
Singapore, Singapore 128461  
Tel: +65 6777 8211

Europe  
Bologna, Italy 40013  
Tel: +39 051 4190611  
Gallardon, France 28320  
Tel: +33 (0)2 37 33 47 00

### Regulator Division Industrial/High Purity

TESCOM  
Elk River, Minnesota 55330 USA  
Tel: 1-763-241-3238  
Selmsdorf, Germany 23923  
Tel: +49 (0) 38823 31 0

For further information visit [www.emersonprocess.com/regulators](http://www.emersonprocess.com/regulators)

The Emerson logo is a trademark and service mark of Emerson Electric Co. All other marks are the property of their prospective owners. Fisher is a mark owned by Fisher Controls, Inc., a business of Emerson Process Management.

The contents of this publication are presented for informational purposes only, and while every effort has been made to ensure their accuracy, they are not to be construed as warranties or guarantees, express or implied, regarding the products or services described herein or their use or applicability. We reserve the right to modify or improve the designs or specifications of such products at any time without notice.

Emerson Process Management does not assume responsibility for the selection, use or maintenance of any product. Responsibility for proper selection, use and maintenance of any Emerson Process Management product remains solely with the purchaser.