

INSTRUCTIONS FOR MODELS

VS-152
VS-152-6FT

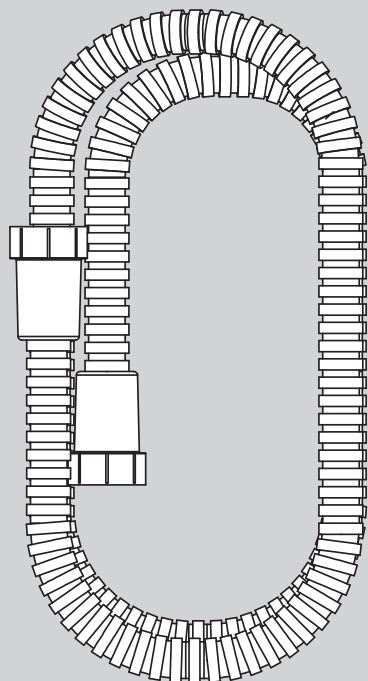

NEED HELP?

For additional assistance or service please contact:

SPEAKMAN® Company
400 Anchor Mill Road
New Castle, DE 19720

800-537-2107

customerservice@speakman.com

www.speakman.com

92-VS-152-01



IMPORTANT



Be sure to read instructions thoroughly before beginning installation. Do not overtighten any connections or damage may occur.

SAFETY TIPS

Cover your drain to prevent loss of parts.

MAINTENANCE

Periodic cleaning using a mild soap and warm water will help keep your Hand Shower Hose in its original condition.

For best results, dry immediately with a soft, clean cloth. **DO NOT USE** harsh and/or abrasive cleaners.

WARRANTY

Additional warranty information can be found at:
www.speakman.com

1

Thread end of hose to the outlet port of Bracket. Hand tighten. **WATER WILL NOT FLOW THROUGH THE HOSE IF THE WRONG SIDE IS CONNECTED.**

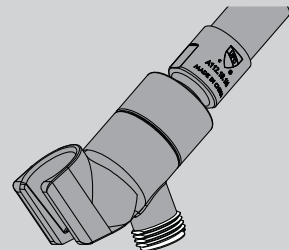

NOTE: Paper tab inserted to show this end of the hose assembles to water supply. Remove tab.



2

Thread Hose End with Label to base of Hand Shower. Hand tighten. Remove label.

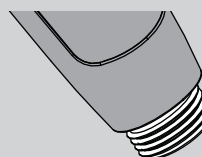

NOTE: Paper tab inserted to show this end of the hose assembles to hand held. Remove tab.



ROUGH IN DIMENSIONS

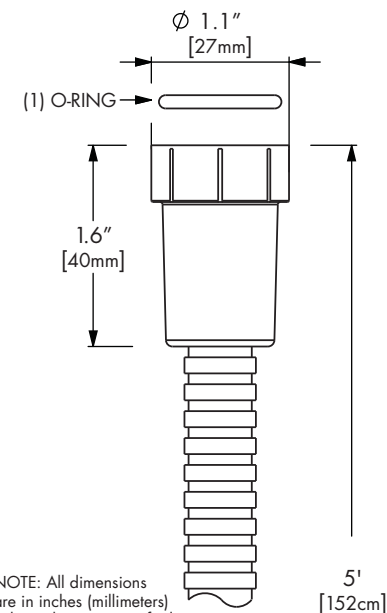

NOTE: All dimensions are in inches (millimeters) unless otherwise specified and are subject to change.

* = 6ft Dimension

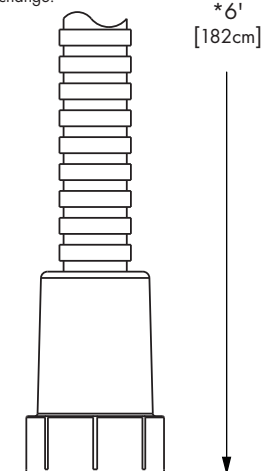

(2) RUBBER WASHERS

Specifications:

Inlet / Outlet: 1/2"-14 NPSM Threaded Swivel Connector