

BEFORE YOU BEGIN

HOW TO USE THESE INSTRUCTIONS

These instructions contain important service information.
Please leave instructions for the consumer.

ROUGHING-IN

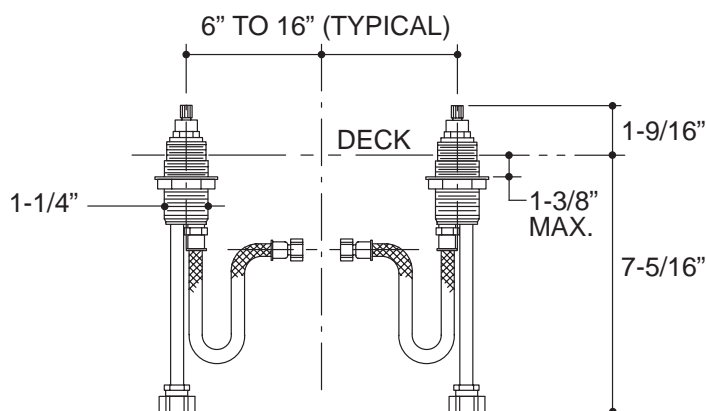

Fig. #1

INSTALLATION

NOTE: Handles will be assembled to end bodies in most kits. If washer and nut are assembled to end bodies, remove before installing.

Thread hoses (O-ring end) to end body outlets. Do not overtighten.

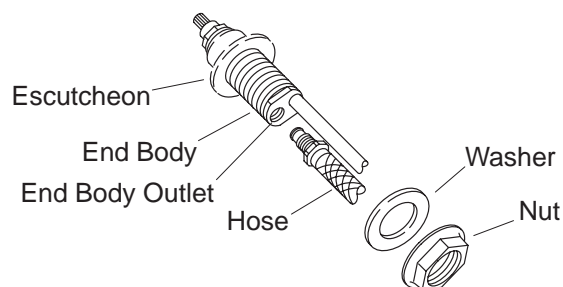

Fig. #2

CAUTION: Risk of property damage. Do not use plumbers putty on marble or plastic, as it may stain the surface.

Apply a ring of plumbers putty or suitable sealant under escutcheons.

Insert end bodies into mounting holes from top. Ensure end body marked cold is installed in right-hand hole.

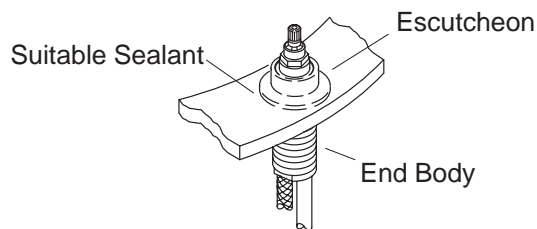

Fig. #3

Place washer on bottom of end bodies. Thread nut on bottom of end bodies.

Align end bodies so that copper tubing faces the outside. When installing end bodies with lever handles, ensure that handles are properly aligned when valves are in closed position. Tighten nuts.

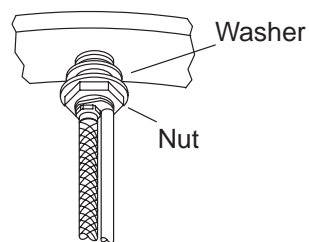

Fig. #4

If fixture is not installed, install at this time.

Slide coupling nuts and ferrules onto supply tubes. Carefully insert supply tubes into end body inlets and shut-off valve outlets (if used); secure with coupling nuts.

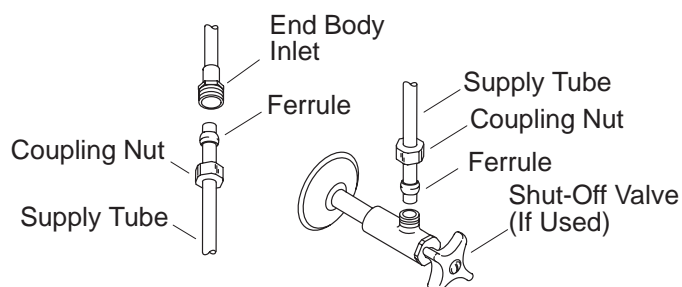

Fig. #5

SERVICE PARTS

