



Company name: -
 Created by: -
 Phone: -
 Fax: -
 Date: -

Position	Count	Description	Unit price
	-1	<p>ALPHA 15-55 LCFS 165</p>  <p>Product photo could vary from the actual product</p> <p>Product No.: 59896834</p> <p>GRUNDFOS ALPHA The next generation of energy efficient circulators.</p> <p>ALPHA is the latest and most innovative member of the Grundfos family of high-quality circulators. By incorporating a permanent magnet motor design, power consumption is now reduced by 50%. ALPHA adapts to the seasonal demands of your system without sacrificing comfort.</p> <p>With ALPHA, you can stop worrying about complicated pump settings. Simply install the pump and leave it in the factory setting, AUTOADAPTTM. ALPHA will automatically analyze the heating system, find the optimum setting and continue to adjust its operation to changes in demand. The result is optimum comfort and minimum energy consumption.</p> <p>AUTOADAPT The factory setting, AUTOADAPT, analyses the heating system and automatically adjusts the pump setting to meet changes in heating demand. Ensuring lowest possible energy consumption, while maintaining maximum comfort levels.</p> <p>Compact design The innovative design makes ALPHA the most compact Grundfos circulator available. With the electronics integrated into the motor housing and standard 2-Bolt flange connection, confined spaces and challenging applications are now possible.</p> <p>Two options for power connections Option 1: 6-foot line cord with three prong plug Option 2: Conduit terminal box with push pin wire connection</p> <p>One-touch operation Intuitive one-touch operation for selecting seven different hydraulic settings. 3 Fixed Speeds 3 Constant Pressure settings AUTOADAPT</p> <p>LED Display The easy-to-read LED display indicating power (Watts) consumption and flow (GPM)</p>	On request

Position	Count	Description	Unit price
		<p>estimation.</p> <p>Liquid:</p> <p>Liquid temperature range: 35.6 .. 230 °F</p> <p>Density: 62.4 lb/ft³</p> <p>Technical:</p> <p>TF class: 110</p> <p>Maximum operating pressure: 145 psi</p> <p>Approvals on nameplate: CUL, FCC</p> <p>Materials:</p> <p>Pump housing: S</p> <p>DIN W.-Nr. 14308</p> <p>ASTM CF8</p> <p>Impeller: Composite, PES</p> <p>Installation:</p> <p>Range of ambient temperature: 32 .. 104 °F</p> <p>Maximum operating pressure: 145 psi</p> <p>Pipe connection: GF 15/26</p> <p>Pressure stage: PN 10</p> <p>Port-to-port length: 6 1/2 in</p> <p>Electrical data:</p> <p>Power input - P1: 5 .. 45 W</p> <p>Maximum current consumption: 0.1 .. 0.65 A</p> <p>Main frequency: 60 Hz</p> <p>Rated voltage: 1 x 115 V</p> <p>Enclosure class (IEC 34-5): 42</p> <p>Insulation class (IEC 85): F</p> <p>Others:</p> <p>Net weight: 5.95 lb</p> <p>Gross weight: 6.17 lb</p> <p>Shipping volume: 87.6 ft³</p> <p>Energy label: A</p>	

59896834 ALPHA 15-55 LCFS 165 60 Hz

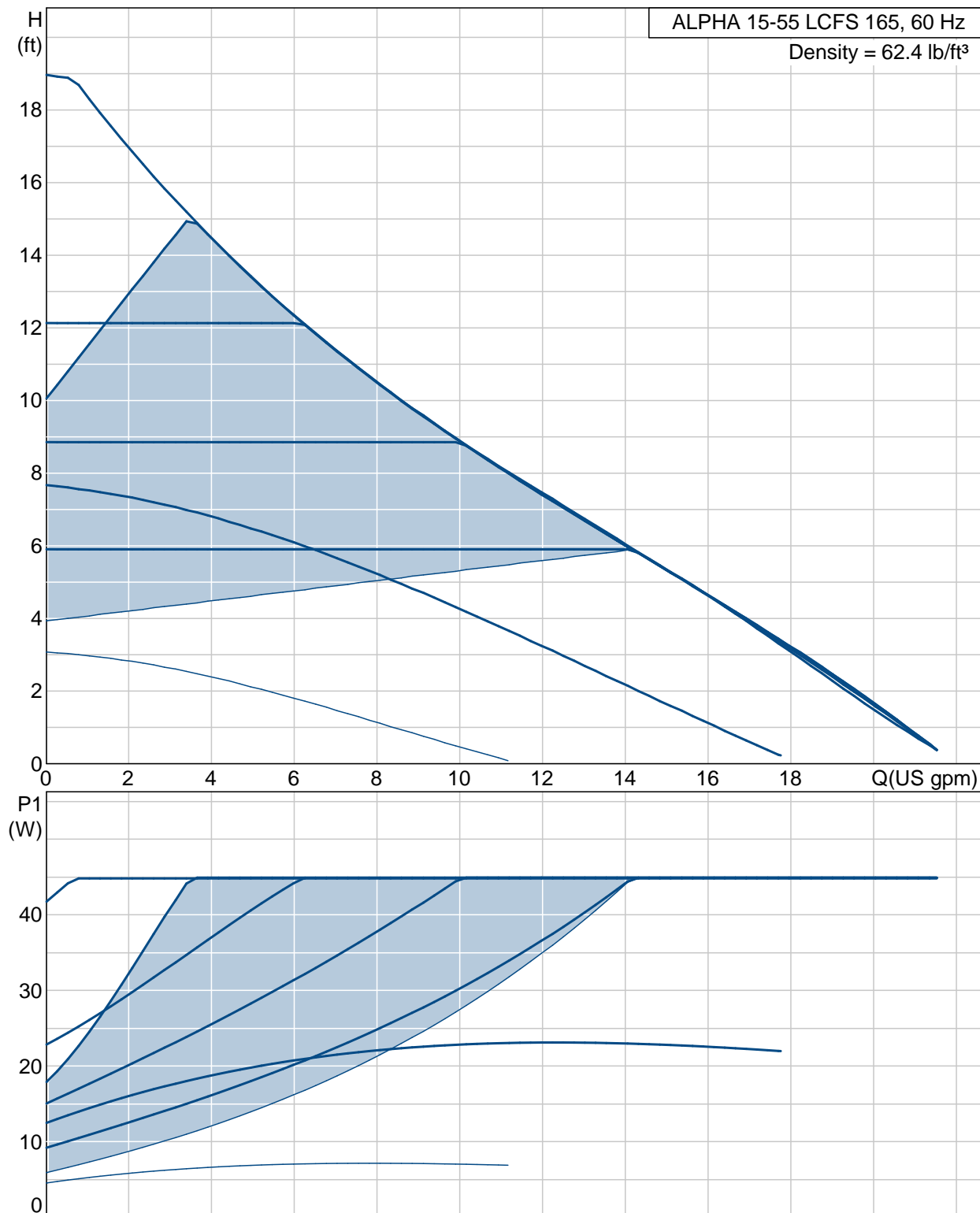

Description	Value
Product name:	ALPHA 15-55 LCFS 165
Product Number:	59896834
EAN number:	5700312930129
Technical:	
Head max:	18 ft
TF class:	110
Maximum operating pressure	145 psi
Approvals on nameplate:	CUL, FCC
Materials:	
Pump housing:	S
	DIN W.-Nr. 14308
	ASTM CF8
Impeller:	Composite, PES
Installation:	
Range of ambient temperature	32 .. 104 °F
Maximum operating pressure	145 psi
Pipe connection:	GF 15/26
Pressure stage:	PN 10
Port-to-port length:	6 1/2 in
Liquid:	
Liquid temperature range	35.6 .. 230 °F
Density:	62.4 lb/ft³
Electrical data:	
Power input - P1	5 .. 45 W
Maximum current consumption:	0.1 .. 0.65 A
Main frequency:	60 Hz
Rated voltage:	1 x 115 V
Enclosure class (IEC 34-5):	42
Insulation class (IEC 85):	F
Motor protection:	NONE
Thermal protec:	ELEC
Controls:	
Pos term box:	6H
Others:	
Net weight:	5.95 lb
Gross weight:	6.17 lb
Shipping volume:	87.6 ft³
Energy label:	A
Sales region:	Namreg

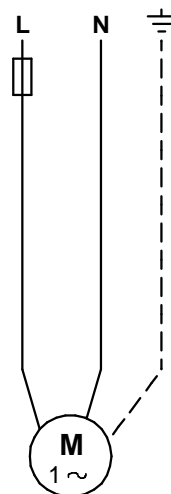
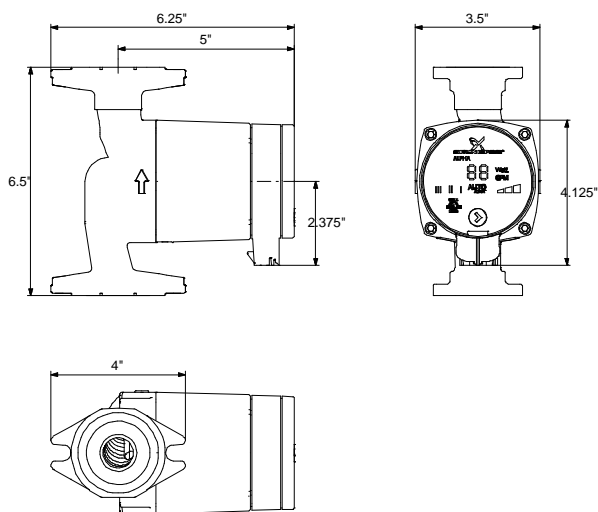
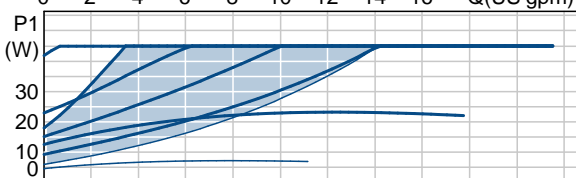
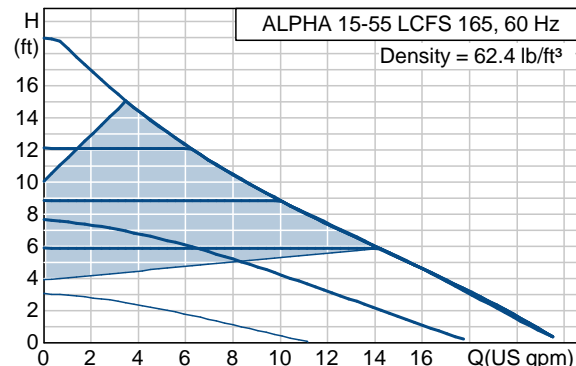



59896834 ALPHA 15-55 LCFS 165 60 Hz

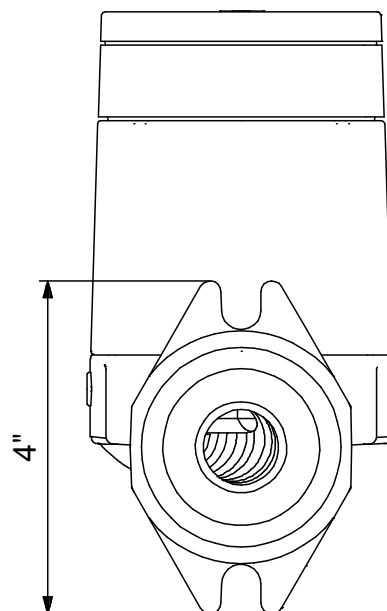
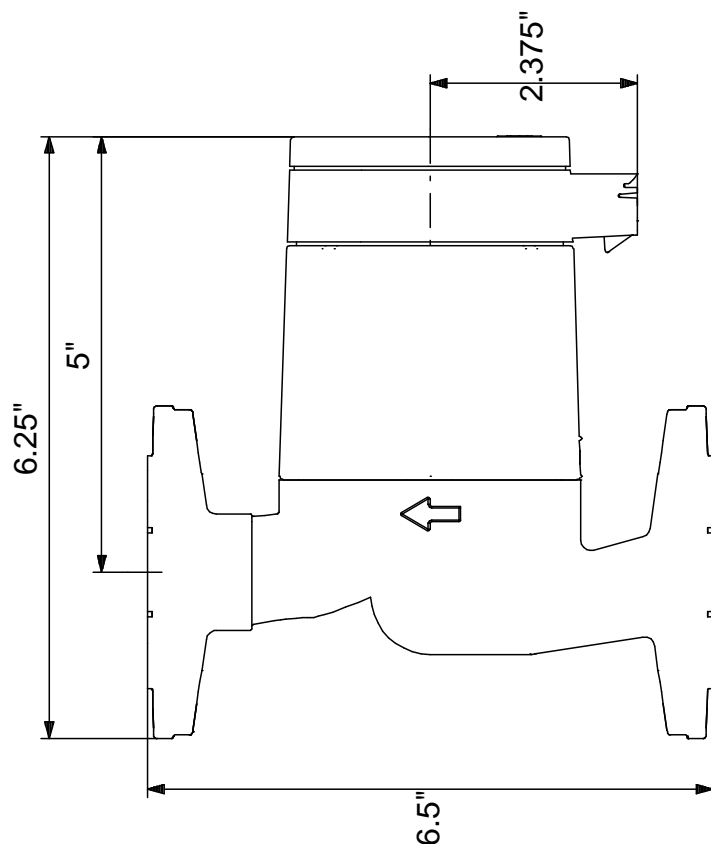
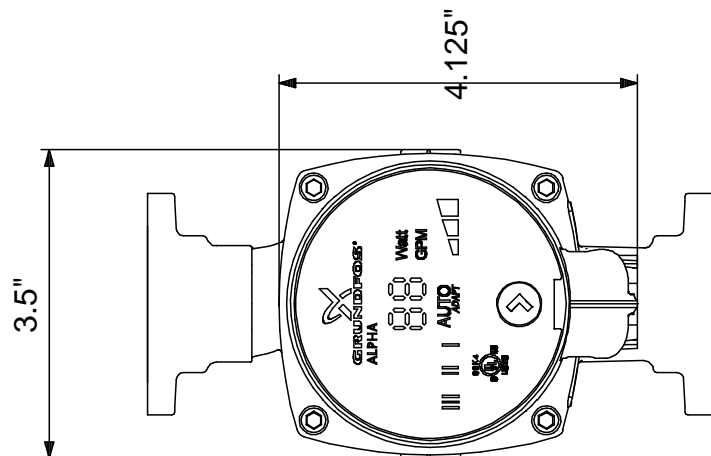

Note! All units are in [mm] unless others are stated.
 Disclaimer: This simplified dimensional drawing does not show all details.