

INSTALLATION

G U I D E

FLAIR™
KITCHEN SINK
FAUCETS WITH
MULTI-SWIVEL
SPOUT

THE BOLD LOOK
OF **KOHLER®**

RECOMMENDED TOOLS AND MATERIALS

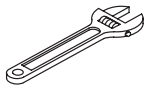

Adjustable Wrench



Pliers



Plumbers Putty

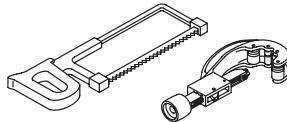

Hacksaw or Tubing Cutter

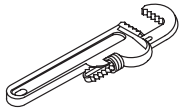

Pipe Wrench

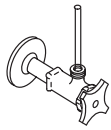

Supply Stop(s) and Tubing



P-Trap



Thread Sealant

BEFORE YOU BEGIN

- The maximum fixture or deck thickness for installation of this faucet is 1-1/2".
- Shut off the main water supply.
- Observe all local plumbing codes.
- Inspect the supply tubing for damage. Replace as necessary.
- If possible, install this faucet onto the sink before installing the sink.
- Kohler Co. reserves the right to make revisions in the design of faucets without notice, as specified in the Price Book.

1. INSTALLATION

FAUCET INSTALLATION

⚠ CAUTION: Risk of product damage. To prevent scratching, do not allow the retaining collar to slide up on the spout neck during installation.

Unthread retaining collar from shank and remove spout.

Unthread escutcheon.

Thread the bottom nut down tightly against the washer and sleeve.

Loosely thread the top nut down to rest against the bottom nut. Slide top washer down.

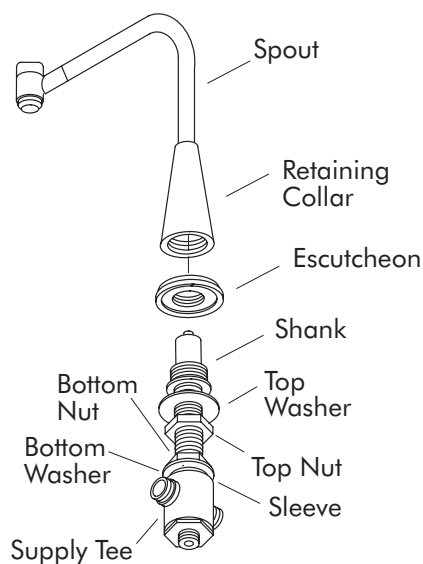

Insert shank through fixture from underneath.

Slide escutcheon onto shank and thread down until tight.

Attach spout to shank and thread down retaining collar until tight.

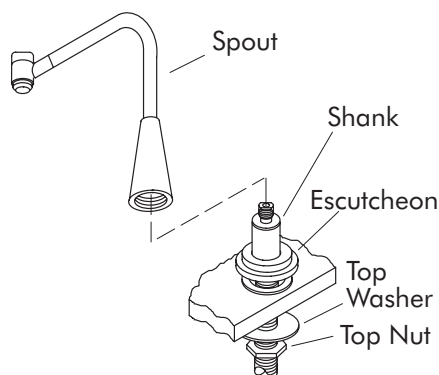

Slide top washer on shank up to the underside of the deck or fixture and thread the top nut up against washer until tight.

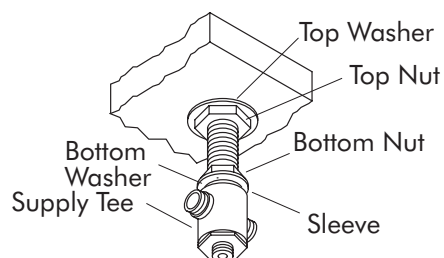

HANDSPRAY INSTALLATION

Apply plumbers putty or other sealant to the underside of the spray holder according to the putty manufacturer's instructions. Insert the spray holder through the sink hole.

From under the sink, securely hand-tighten the nut.

Remove any excess putty or sealant.

Insert the handspray hose through the spray holder and attach the hose to shank tee.

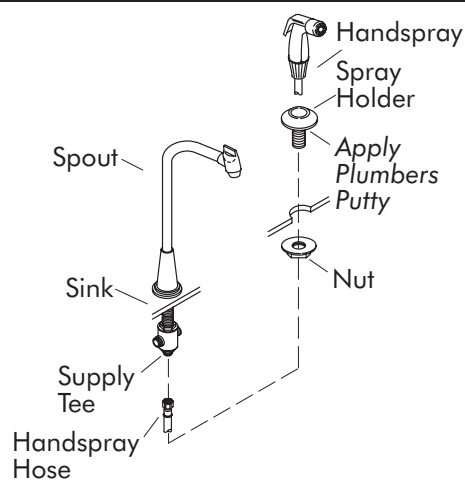

VALVE BODY INSTALLATION

Remove nut and washer from valve body.

Apply a bead of plumbers putty or other sealant to the underside of the escutcheon according to the putty manufacturer's instructions.

Insert valve body assembly through hole in fixture or deck. Make sure that the valve labeled "cold" is inserted in the right-hand hole (as viewed when facing the sink).

Repeat for other side.

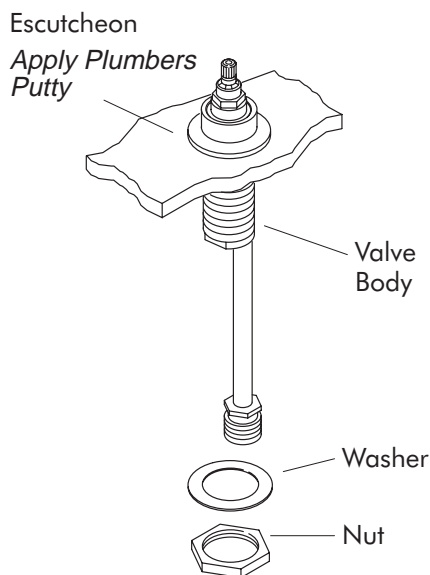

Align end body so the copper tubing faces the outside. Slide washer up to underside of deck or fixture and secure with nut.

Remove any excess putty or sealant.

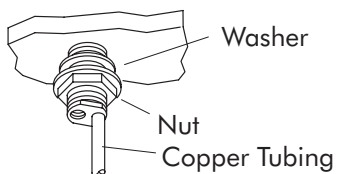

Install handles at this time according to the directions packed with the handles.

Thread hose to end body outlets.
Wrench tighten, but do not
overtighten.

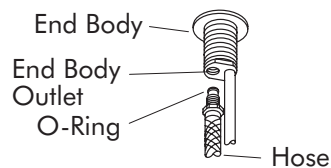

Connect the flexible hoses to the
tee inlets. Do not use thread
sealant. To avoid kinking the
hoses, loop them as shown. Do
not overtighten.

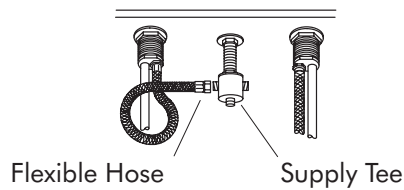

**IF THE SINK IS NOT INSTALLED, INSTALL IT AT THIS
TIME. BE SURE TO FOLLOW ALL INSTRUCTIONS
PACKED WITH THE SINK.**

SUPPLY INSTALLATION

Identify your supply connection
type.

Connect the supply tubes to the
faucet inlets and supply stops.
(Left is hot – right is cold.)

Tighten all connections.

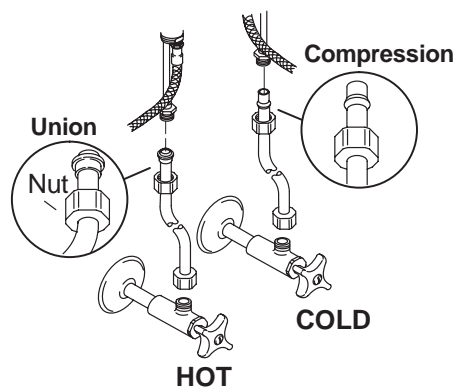

2. INSTALLATION CHECKOUT

Install strainer bodies, tailpieces, and P-traps as needed.

Ensure that all connections are tight.

Turn on the main water supply and check for leaks.

Remove the aerator.

Open both hot and cold valves and run water through the spout to remove any debris. Turn the valves off.

Reinstall the aerator.

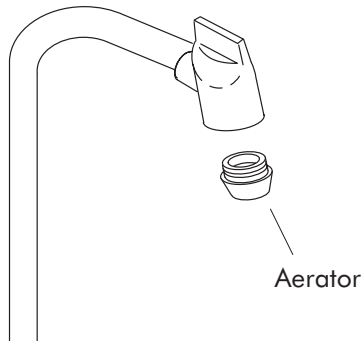

CALL US FOR HELP

Questions? Problems? First review the installation instructions to ensure correct installation. For additional assistance in the USA, call our Customer Service Department for direct help. You may also contact us at our web site listed below.

1-800-4-KOHLER

THE BOLD LOOK
OF **KOHLER**®
www.kohlerco.com