

60" X 32" BRADENTON ACRYLIC DROP-IN WHIRLPOOL TUB

SKU: 948046-WP

Code: SHBDW6032

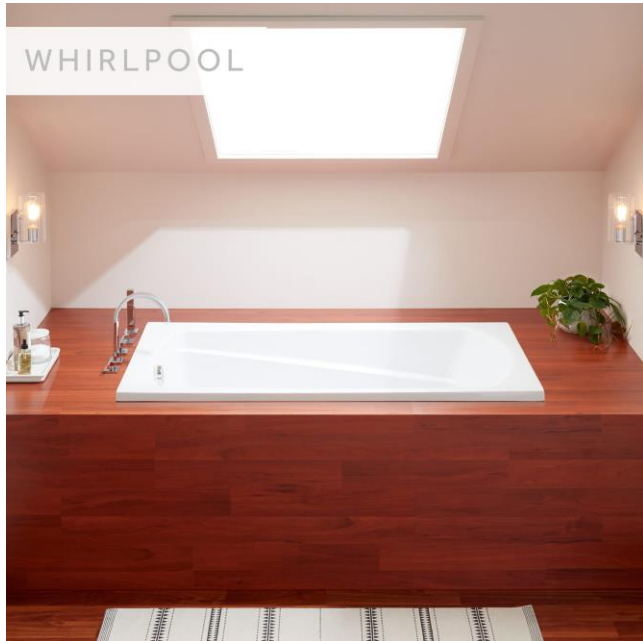

FEATURES

Design: Modern
Product Finish: White
Length: 59-1/2"
Width: 32"
Height: 21-1/2"
Water Depth To Overflow: 15"
Interior Treatment: Smooth
Faucet Included: No
Shape: Rectangle
Tub Overflow: Yes
Tub Material: Acrylic
Tub Interior Length: 41"
Tub Interior Width: 20"
Tap Deck: No
Faucet Drillings: No Drillings
Tub Weight Uncrated (lbs): 99
Tub Weight Crated (lbs): 209
Blower: Yes
Jet Color: White
On/Off Switch: Yes

REVISED 6/5/2023

60" X 32" BRADENTON ACRYLIC DROP-IN WHIRLPOOL TUB

SKU: 948046-WP

Code: SHBDW6032

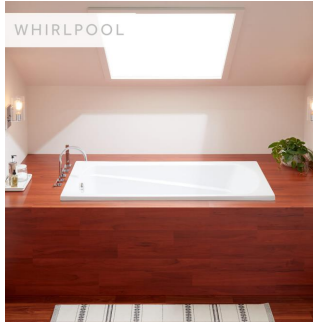

ADDITIONAL FEATURES

|| |[u_list| All dimensions ($\pm 1/2"$). |43-gallon (162.8-Liters) operating capacity. |Integral arm rests. |Textured slip-resistant bottom. |Pre-leveled base. |Whirlpool - 8 Strategically placed air jets move water with increased pressure for an invigorating bathing experience. |Whirlpool system uses a powerful 1.75hp, 10.9 amp whirlpool pump. |Air tub systems are pre-wired for simple plug-in installation. |Optional Quick Connect Drop-In Drain Kit Includes: || |[u_list| Floor Plate, 1-1/2" PVC Pipe, 2" x 1-1/2" Trap Adapters, 1 Brass Threaded, 1 Brass Unthreaded Tailpiece and Plug. |Installs above your subfloor, but underneath your cement floor or tile, so you do not need access below the fixture.u_list]||]

- [ABS drain version available if needed for your installation.](#)

REVISED 6/5/2023

60" x 32" BRADENTON

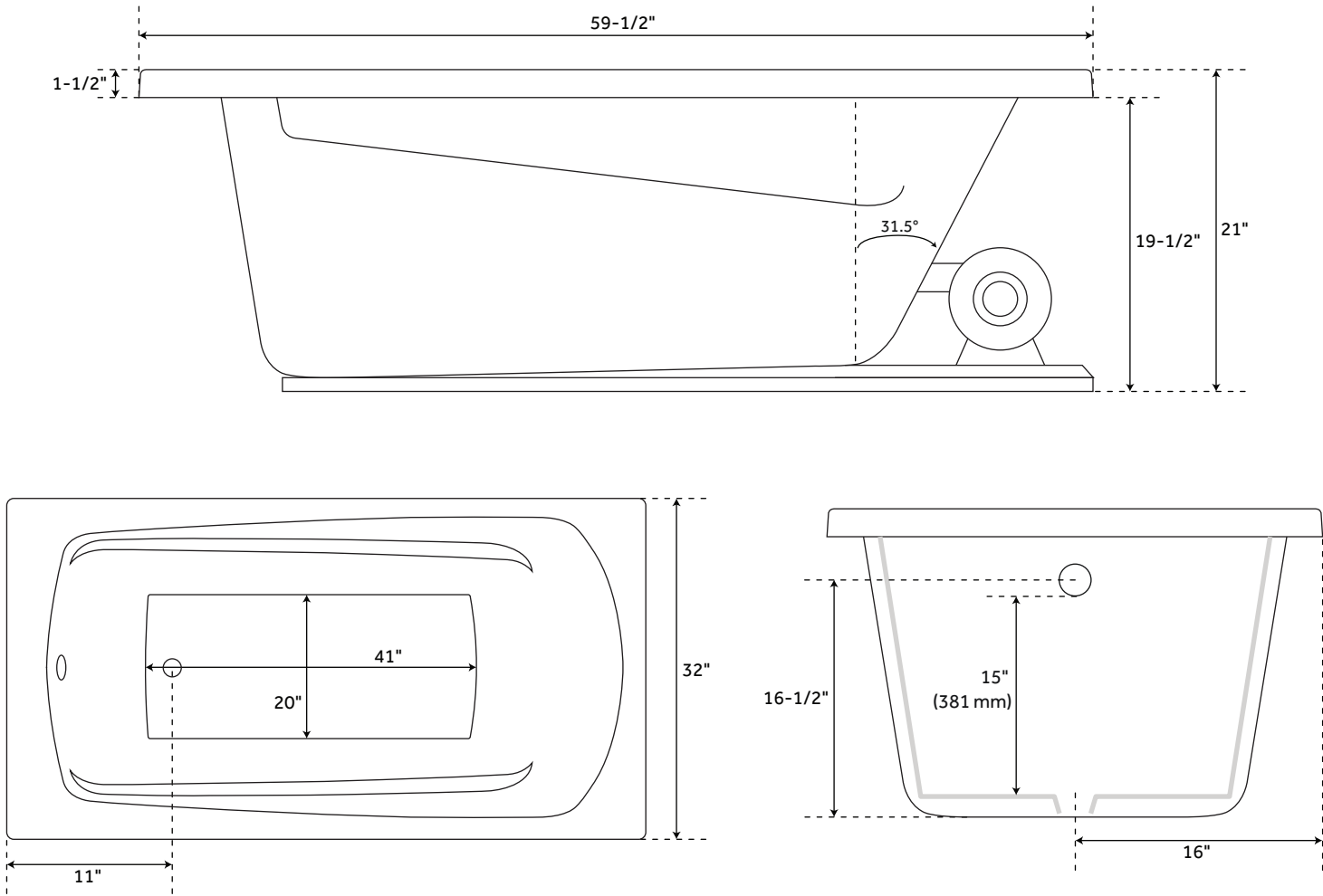

All dimensions and specifications are nominal and may vary. Use actual products for accuracy in critical situations.

AIR TUB AND WHIRLPOOL TUB

COMPONENTS LIST

- Powerful whirlpool pump with variable flow device
- Heated blower for air bath system

INSTALLATION

- Whirlpool and Total Massage units require dedicated 20 Amp, 120V service
- You must provide a receptacle with a 20 Amp configuration
- Electrical outlet must be mounted 4" (101mm) above the floor line and 12" max (305mm) inside from the edge of the bathtub, or in accordance with local building and electrical codes

INTEGRATED CONTROL PANEL

- Whirlpool Baths: Equipped with on/off switch actuator. Each depression of the switch will activate the pump
- Air Baths: Equipped with a 3-speed air switch actuator. Each depression of the switch will change the flow of air
- Total Massage Baths: Equipped with both an on/off air switch actuator for whirlpool function and 3-speed air switch actuator for air function

INSIDE OF BATH

- (8) HIGH-FLOW DIRECTIONAL AND VOLUME-ADJUSTABLE WHIRLPOOL JETS
- (65) CHANNEL-FED AIRJETS (air bath and total massage)



WHIRLPOOL JET

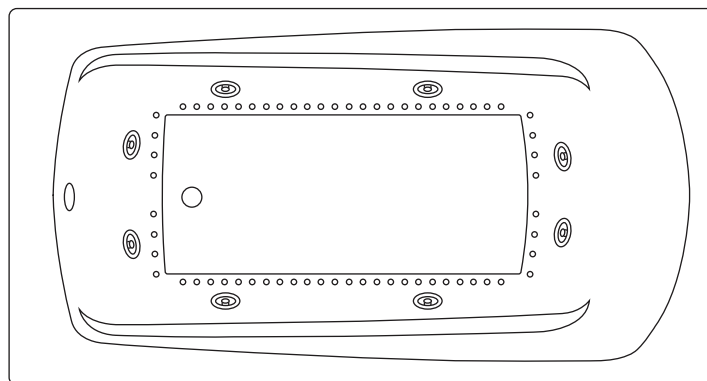

ELECTRICAL CONFIGURATIONS

WHIRLPOOL WITH INSTALLED AIR SWITCH

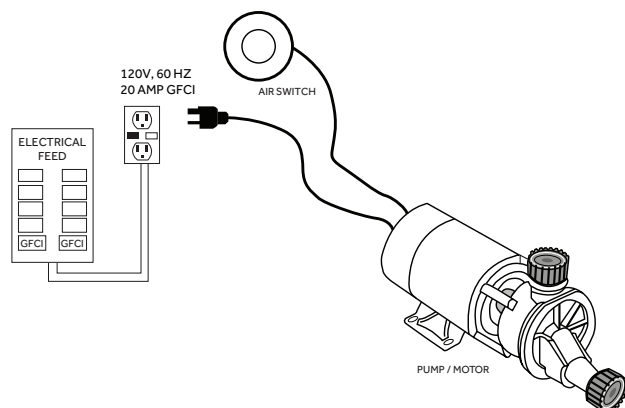

TOTAL MASSAGE CIRCUIT WITH OPTIONAL HEATER

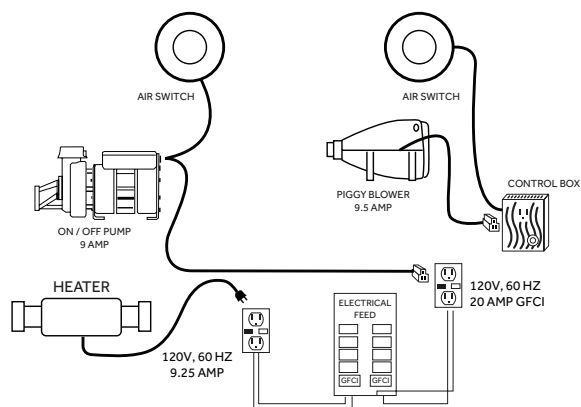

AIR BATH CIRCUIT

