



MAUICAST

5' BATHTUB / 15" DEEP SOAKER
PORCELAIN ON STEEL
Standard Outlet



Description:

The 5' Mauicast is porcelain enameled steel encased with **Synlron 2** an engineered composite material designed to improve heat retention, reduce sound, prevent handling and transportation damage. 35° lumbar support for comfortable bathing. New 15" sump depth for added comfort. Weighs less than 100 lbs. - for

easy installation. Full-length sound deadening support pad for added strength. Available in left or right hand with a slip resistant bottom. ASME A112.19.1-2008/ CSA B45.2-2008, ASTM E 162-08 Surface Flammability, ASTM E662-06 Smoke Density
Made in the USA

Ordering Information:

Standard Outlet

60" x 30" x 16 5/8"

011-2344-00 Mauicast RH

011-2345-00 Mauicast LH

Bootz Industries

1400 Park Street
PO Box 18010
Evansville, IN 47719-1010

Phone: (812) 423-5401 • Fax: (812) 429 2254
e-mail: webmaster@bootz.com
website: www.bootz.com



SPECIFICATIONS:

Dimensions:

Length: 60"
Width: 30"
Height: 16 5/8"
Sump Depth: 15"
Tile Flange: 1"

Complies with:

All fixtures are compatible or comply with ANSI, ASME, CSA, WW-P-541, HUD-FHA-VA, LEED, and the "Buy America Act" where applicable when installed accordingly.

Standard Features:

"The affordable alternative to cast iron"
Made in the USA

5' Mauicast Bathtub: 011-2344-00, 2345-00

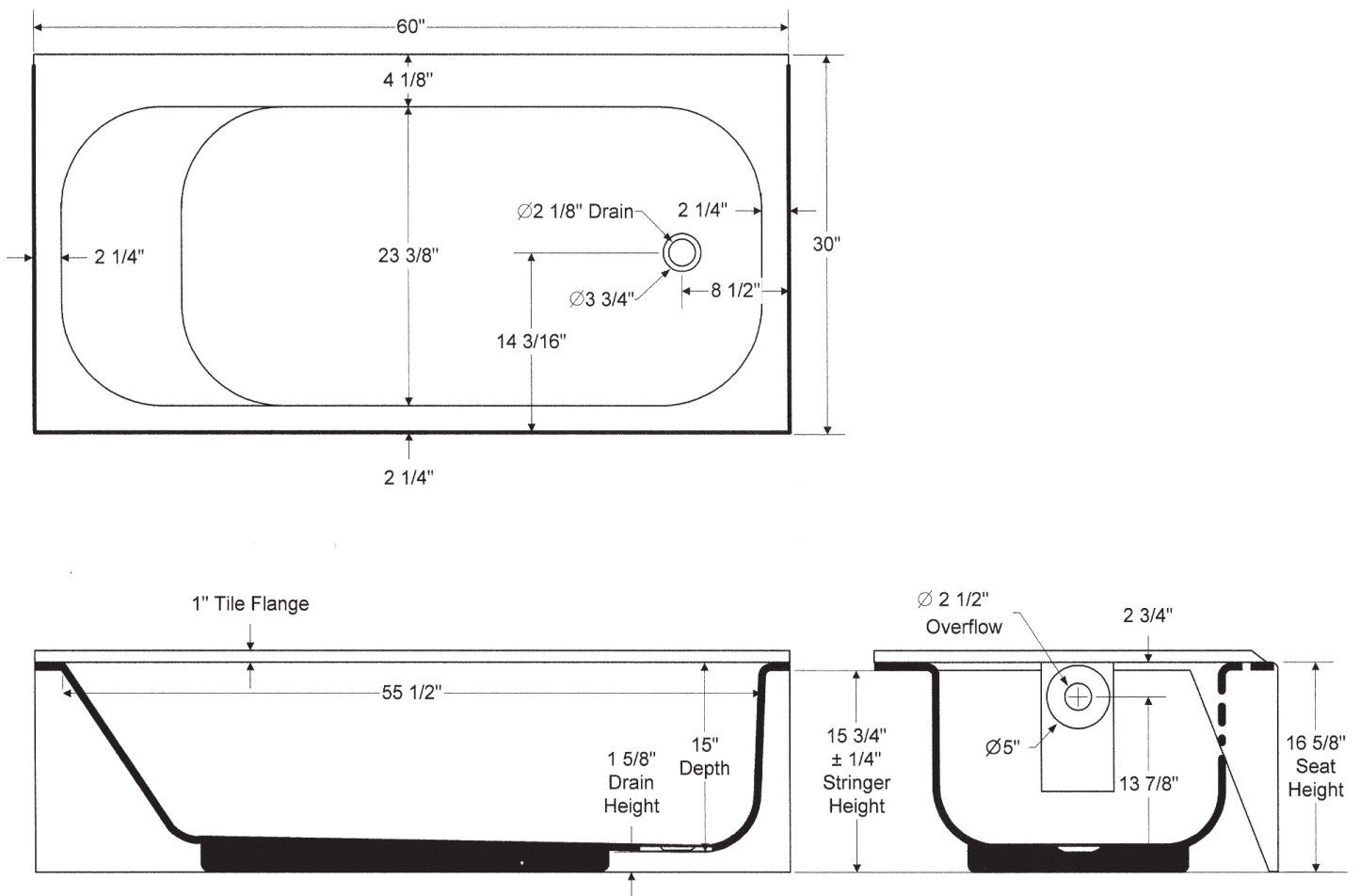

All dimensions +/- 1/8" unless otherwise noted.

Dimensions shown are for reference. Actual dimensions may vary slightly and should be checked prior to installation.



Bootz Industries

1400 Park Street
PO Box 18010
Evansville, IN 47719-1010

Phone: (812) 423-5401 • Fax: (812) 429 2254

e-mail: webmaster@bootz.com

website: www.bootz.com