

LF 1/2" CPVC Water Hammer Arrestor



Product Features

- For single fixture use
- Helps to eliminate shock waves generated in piping systems by sudden on/off changes in flow
- Polypropylene Pistone
- AA arrestors are suitable for 1-3 fixture units
- May be installed at any angle.
- To function more effectively, please install within 6 feet of the fixture the arrestor is servicing.
- Approved for installation with no access panels required.



PFXWHACFD

Product Specifications

Temperature Range: 33°F to 180°F
Max. Working Pressure: 350psi
ASSE 1010-2004
IAMPO Listed (cUPC)
Certified to NSF 372 requirements

| Model Numbers | A | B |
|---------------|-------------------------|-------------------|
| PFXWHACFD | 1/2" CPVC Female Socket | 4-1/16" (103.1mm) |
| PFXWHACSD | 1/2" CPVC Male Spigot | 3-3/8" (80.5mm) |

PFXWHACFD

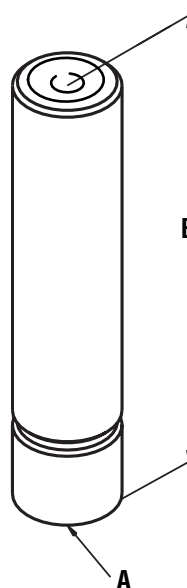

PFXWHACSD

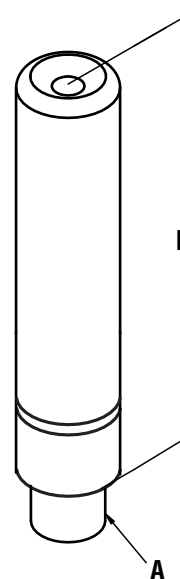

Warranty and Codes

This PROFLO product carries a 1-year limited warranty.

