

NOTES:

1. FIT / FORM / FUNCTION SHALL FOLLOW PS-E.008.
2. APPLY LOCTITE 680 TO THREADS
3. APPLY THIN COAT OF SILICONE GREASE TO O-RINGS
4. UPON ASSEMBLY 7-736 ARM TO SUSTAIN ITS OWN WEIGHT WHEN ROTATED

BILL OF MATERIAL (CURRENT LEVEL)

ITEM	PT/ASSY	DESCRIPTION	TYPE	QTY.
1	02XXG	MOUNTING BRACKET	PART	2
2	1-206	HARDWARE PACK	ASSEMBLY	2
3	40376	ROSETTE	PART	2
4	40688	PIVOTING TISSUE POST RIGHT	PART	1
5	91464	WSHR, .254 ID X .625 OD X .063 THK, FLT, ACETAL	PART	1
6	7-736	PIVOTING TISSUE ARM	PART	1
7	92893	PIVOT SCREW	PART	1
8	91098	O-RING, #2-007, EPDM, 65-75 DURO	PART	2
9	91254	POLY BUMPER PAD, DIA .250" X .062"	PART	1
10	40689	PIVOTING TISSUE POST LEFT	PART	1
11	92031	SCRW, M6 X 1 X 6 SKT HD CUP PT W/ SELF LOC SS	PART	2
12	10615	HEX KEY, 3MM ALLOY STEEL	PART	1

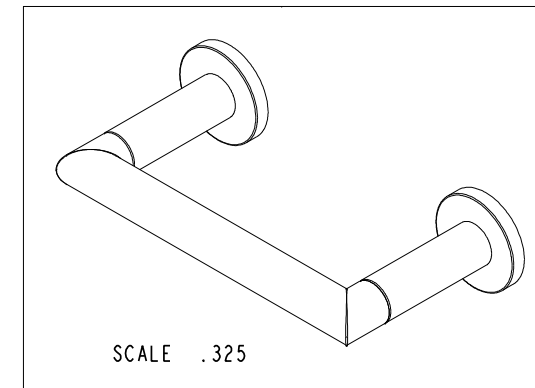
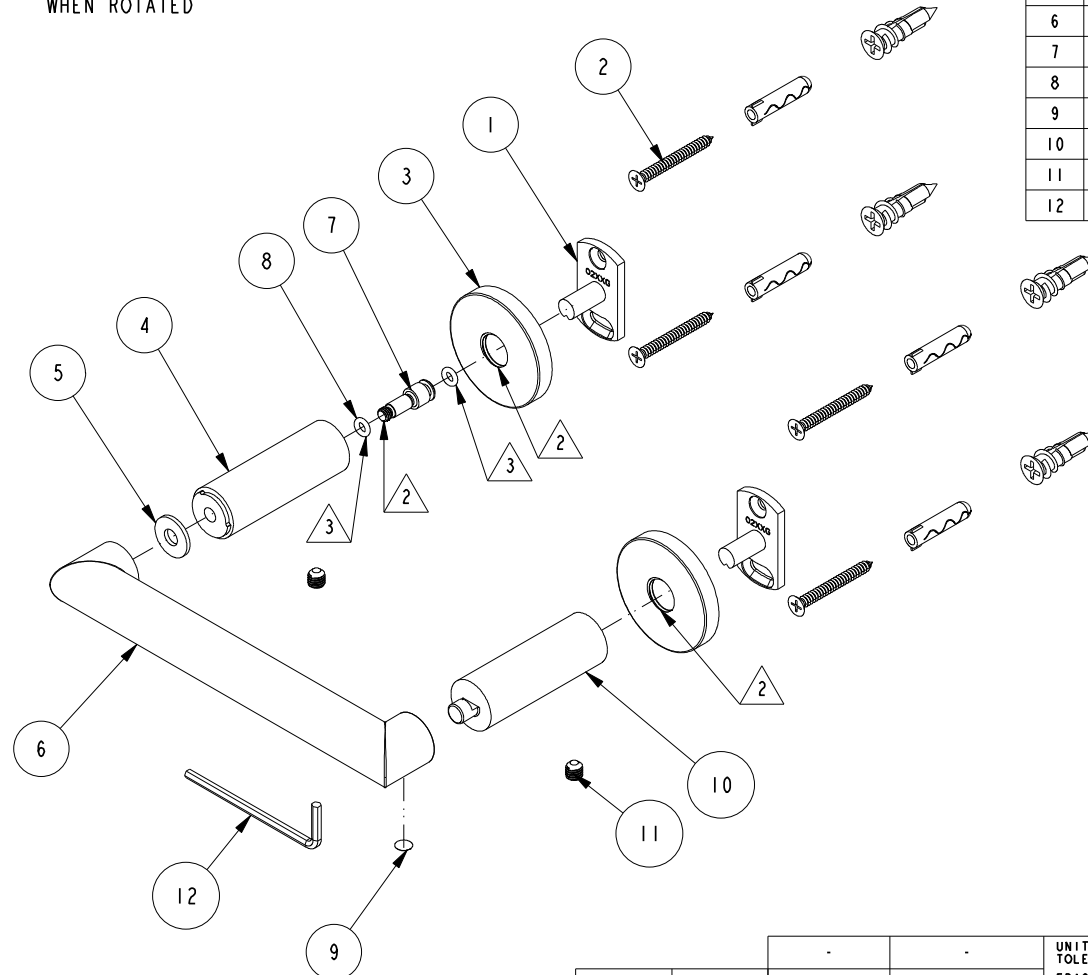

		-	-
TESTING	-	-	-
ASSEMBLY	-	-	-
PLATING	-	-	-
POLISHING	-	NEXT ASSY	USED ON
MACHINING	-	APPLICATION	
TOOLING FIXTURE #		REMOVE ALL BURRS AND SHARP EDGES	

UNITS ARE: INCHES [MM]		
TOLERANCES ARE:		
FRACTIONS	DECIMALS	ANGLES
±1/16"	.X ±.1 [2.5]	±1°
	.XX ±.06 [1.5]	
(X.XXX) DENOTES CRITICAL DIMS.		
ALL THREADS ARE CRITICAL		
DRAWN	JINSON	06/19/19
CHECKED	J.M.	06/19/19
APPROVED	J.M.	06/19/19

BRASSTECH		2001 CARNEGIE AVE. SANTA ANA, CA 92705 (949) 417-5207	
INCORPORATED			
PIVOTING TISSUE HOLDER			
DWG NO.			REV
4608			C
SCALE	.375	REF. -	SHEET 1 OF 2

-	C	EN-4143	03/20/20	J.M.
-	B	EN-4032	12/02/19	R.S.
-	A	EN-3735	06/19/19	J.M.
-	-	EN-0995-1	11/10/10	-
ZONE	REV	DESCRIPTION	DATE	APPROVED

COPYRIGHT 2005 BRASSTECH, INC.
THESE DRAWINGS AND THE DESIGNS
DEPICTED HEREIN ARE THE PROPRIETARY
PROPERTY OF BRASSTECH. ANY USE
OR REPRODUCTION IS SUBJECT TO
THE EXPRESS APPROVAL OF BRASSTECH.
UNAUTHORIZED USE IS STRICTLY
PROHIBITED. ALL RIGHTS RESERVED.

