



VITREOUS CHINA

TOILET
DF-21-117

LAVATORIES

TOILETS

BIDETS / URINALS

CAST IRON

MAXWELL® DUAL FLUSH
ErgoHeight™
16 1/2" High Elongated Toilet

10" Rough-in

Features:

- Dual Flush 1.1/1.6 gpf (4.0/6.0 Lpf)
- High Efficiency Toilet (HET)
- Elongated Front Bowl
- Glazed Trapway
- Reverse Trap
- Front Jet Flushing Action
- Top Mounted, Two-button Actuator
- Siphonic Flush Action Keeps Bowl Clean
- Available in White and Biscuit
- 2 Bolt Caps

Dimensions:

Height 30 5/8"
Width 15 1/2"
Depth 26 5/8"
Rough-in 10"
Water Surface from Rim 6"
Trapway 1 3/4"
Water Surface 10 3/8" x 7 3/4"
Water Seal 2 1/4"
Shipping Weight 67.5 lbs



Specifications: Bowl—#21-128 Elongated Bowl
Seat not included

Tank—#DF-28-195

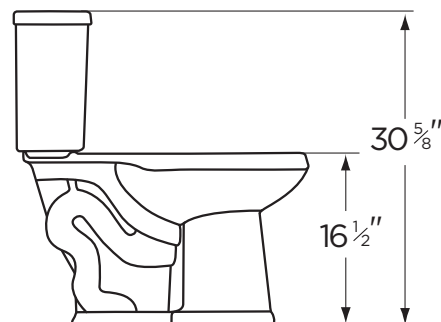
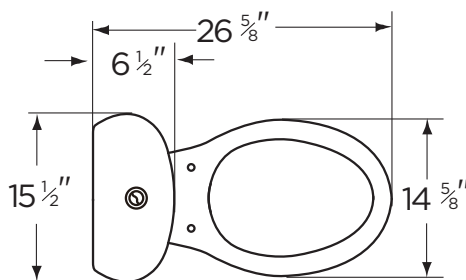

THIS FIXTURE QUALIFIES
ACCORDING TO ASME TEST
PROCEDURES AS A WATER CLOSET
WITH AN AVERAGE CONSUMPTION
OF 1.6 gpf (6 Lpf) OR LESS.



www.gerberonline.com

Job Name	
Date	
Model Specified	
Quantity	
Customer	
Contractor	
Architect/engineer	



16 1/2" High Elongated, 10" Rough-in
(Bowl 21-128 with Tank DF-28-195)

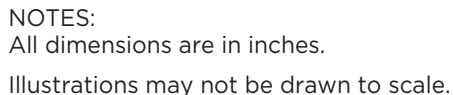

THIS FIXTURE QUALIFIES ACCORDING TO ASME
TEST PROCEDURES AS A WATER CLOSET WITH
AN AVERAGE CONSUMPTION OF 1.6 gpf (6 Lpf)
OR LESS.