

Kahlo 4

MODEL #: 143

66" x 36" x 22"

GENERAL SPECIFICATIONS

Material - Acrylic

Installation - Freestanding

Soaker Weight - 165 lbs / 75 kg

Maximum Fill - 85 gal to overflow

NOTE: Filling this tub to the maximum may require an above average size or dedicated water heater.



Features integrated overflow and will allow for centered faucet on the tub deck.

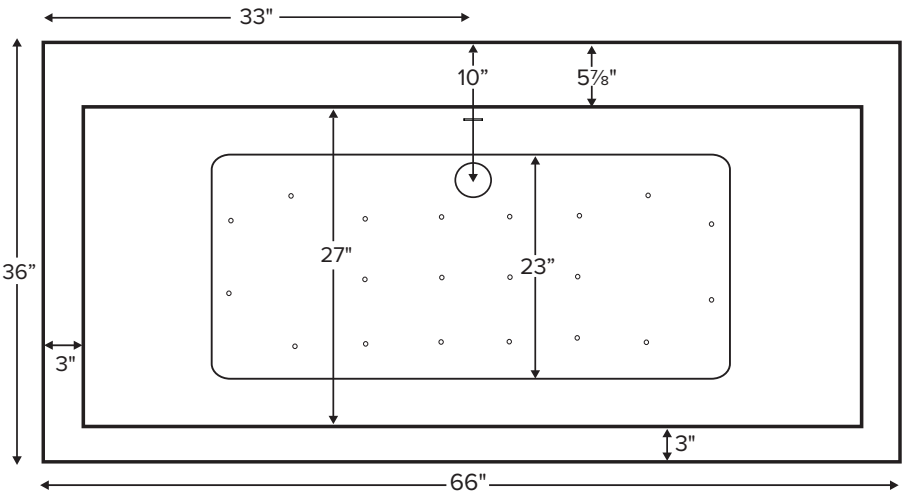

Drain Rough-In Measurement

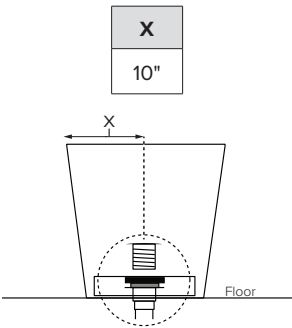

Kahlo 4 features a flat deck on the drain side for mounting faucetry.
Shown with Air Massage Package.

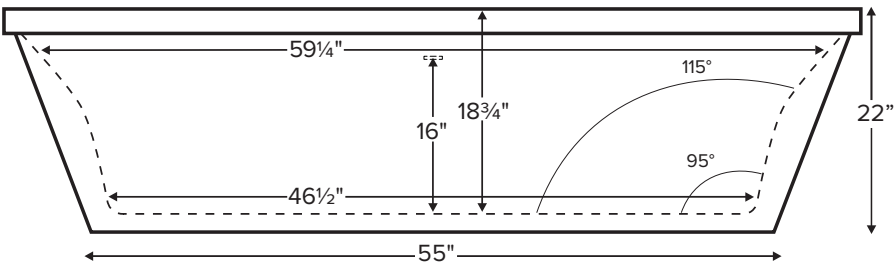

Access panel

20 1/4" x 15 1/8"



ELECTRICAL COMPONENTS & SPECIFICATIONS

Required Electrical Service - 110 Volt

Hydrotherapy Package	Components Included	GFCI
Air Massage	heated blower	1-15 amp
Air Massage Elite	heated blower, chromatherapy	1-15 amp

Electrical requirements may change with the addition of optional therapy components.
See specific option details or installation information.
CSA Certified C/US; ANSI Z124.1 and ANSI 112.19.7

See the Installation & Operation Manual for more details.
MTI's Customer Service: Monday-Friday 8am-6pm EST
800-783-8827 or service@mtibaths.com

- Before discarding tub crate, check for accessories that may be packaged inside.
- All product measurements are $\pm 1/2"$.
- Specifications and configurations are subject to change without notice.
- Measurements herein supersede all others published prior to publication date below.

IMPORTANT ORDERING & INSTALLATION INFORMATION:

- Before ordering or installing, please consider future access to equipment.
- Comes equipped with an access panel on the drain side for installation of waste and overflow.
- Air baths require job site preparations for remote mounting the blower.
- Hydrotherapy equipment may ship loose for remote installation depending on tub model. See package content on the following page for details.
- MTI will eliminate the access panel upon request. Installation will be more difficult.
- Radiance placed on floor locations will affect placement of air jets.



Kahlo 4
MODEL #: 143
66" x 36" x 22"

Hydrotherapy Packages	Package Contents	Part #	MSRP
Soaker	Soaking bath - no jets; includes a pre-leveled foam base and integrated slotted overflow with toe-tap drain kit in chrome.	S143	\$4,650
Air Massage	20 air jets, heated air blower, pre-leveled foam base and integrated slotted overflow with toe-tap drain kit in chrome. Blower and control boxes must be remote located.	AST143	\$7,550
Air Massage Elite	30 air jets, heated air blower, Chromatherapy LED lighting, Spa Mode, pre-leveled foam base and integrated slotted overflow with toe-tap drain kit in chrome. Blower and control boxes must be remote located.	AE143	\$9,325

RECOMMENDED SENSORY THERAPIES

Chromatherapy

(LE) **\$640** underwater lighting
2 LED lights included

Audiotherapy

(STEREOBT) **\$1,175** 2 transducers
with bluetooth and amplifier
(BTREMOTE) **\$490** bluetooth remote

(STEREOH202) **\$1,135** 4 transducers
amplifier not included

Thermaltherapy

(RAD100) **\$1,190** Radiance®
2 heated zones included

Options

Must be ordered at time of purchase.

Standard Colors White (CWH)
Biscuit (CBS)

Please call for availability of special colors.

Quick Ship reduces lead time (QSPRI) **\$380**

Please call for availability

Textured, Slip-Resistant Bottom (TXTBTM) **\$100**
Compliant with ASTM C 1028-07 friction coefficient.

Virtual Spout high-flow integrated tub filler (FPMJ) **\$350**

Grab Bars from **\$300** (1 set of 2)

Grab bars are factory installed to the left and right of the overflow. Go to Acrylic Tub Options on mtibaths.com for details before ordering.

Color and finish selections vary.

Decorative Towel Bar

Chrome (CHTOWEL) **\$520**, Brushed Nickel (BNTOWEL) **\$520**

Accessories

Pillows from **\$145**

Teak Bath Mat (TKMAT3018) **\$390**

Custom sizes also available. Contact MTI for details and pricing.

Teak Tub Tray **\$315**

Slatted (TK-TRAY1), Solid (TK-TRAY2)

Concealed Blower Box

Oak (BBOAK) **\$920**, Cherry (BBCH) **\$920**, Maple (BMAP) **\$920**

Floor-Mounted High-Flow Tub Filler two designs available

Contemporary
Chrome (FILLC) **\$1,680**
Brushed Nickel (FILLBN) **\$1,850**

Traditional
Chrome (FILLTC) **\$1,680**
Brushed Nickel (FILLTBN) **\$1,845**

Faucet Stand SculptureStone® Standard

Small 3-hole capacity

14¼" w x 21¾" h

Matte (STAND) **\$515**

Large 5-hole capacity

22" w x 21¾" h

Matte (STANDL) **\$610**

+\$310 gloss finish upcharge (SSGLOSSENK)

Drains & Overflow Kits *Must be ordered at time of purchase*

Integrated Overflow with Toe Tap

Slotted Overflow

PVC drain - Chrome (SLOTIOC) included

Finish Upcharge

White (SLOTIOWHU) **\$60**

Brushed Nickel (SLOTIOBNU) **\$60**

Polished Nickel (SLOTIOPNU) **\$100**

Round Overflow

Chrome (RIOBC) may substitute slotted overflow

Finish Upcharge

White (RIOWH) **\$60**

Brushed Nickel (RIOBN) **\$60**

Polished Nickel (RIOPN) **\$100**

Brass Tailpiece (WIOBS) **\$35**

May be ordered separately

