



Commercial Roof Hydrants

Model RHY1-MS & RHY2-MS



The Woodford Freezeless Roof Hydrant system is designed to facilitate installing a secure water source, on commercial roof surfaces. The Y2 hydrant drains with a hose attached. Both hydrants require a drain line from the valve body.

Either hydrant can be used for cleaning condenser coils, windows or any other job where a roof water source is required.

Y2 Hydrant (Shown)
With Double Check
Backflow Preventer
OR
Y1 Hydrant Without
Backflow Preventer



Model 50HF
ASSE 1052
Dual Check - Auto Drain
Backflow Preventer

Boot covers Well
Seal that tightens
between
Hydrant Support
and Casing

Hydrant Support

2° Shim

Under-Deck
Flange

Mounting
Bolts

1/8" NPT
Must Plumb to
Drain Source

ROOF HYDRANT	PRICE
RHY1-MS Complete	564.00
RHY2-MS Complete	638.45
RH-MS	240.75
RHY1	323.25
RHY2	397.70

Part# RHY1-MS

Consists of the complete
Roof Hydrant system:

Qty. 1 RHY1

Y1 Hydrant shipped in 1
carton.

Qty. 1 RH-MS
Mounting System
shipped in 1 carton.

Total Shipping Wt.
2 cartons: 50 lbs

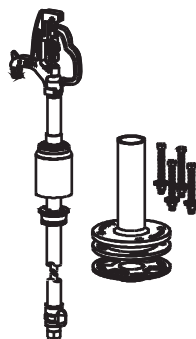

Part# RHY1

Carton contents
consists of:

- Y1 Hydrant Assembly
- Well Seal
- Boot

Shipped in 1 Carton.
Shipping Wt. - 20 lbs



Part# RHY2-MS

Consists of the complete
Roof Hydrant system:

Qty. 1 RHY2

Y2 Hydrant shipped in 1
carton.

Qty. 1 RH-MS
Mounting System
shipped in 1 carton.

Total Shipping Wt.
2 cartons: 50 lbs

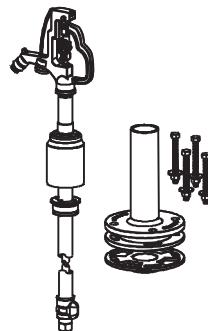

Part# RHY2

Carton contents
consists of:

- Y2 Hydrant Assembly
- Well Seal
- Boot

Shipped in 1 Carton.
Shipping Wt. - 20 lbs



Part# RH-MS

Carton contents consists of:

Mounting System/Rough-In Components

- Hydrant Support - cast iron
- 2° Shim - cast iron
- Under Deck Flange - cast iron
- Mounting Bolts, Nuts & Washers

Shipped in 1 Carton.
Shipping Wt. - 30 lbs

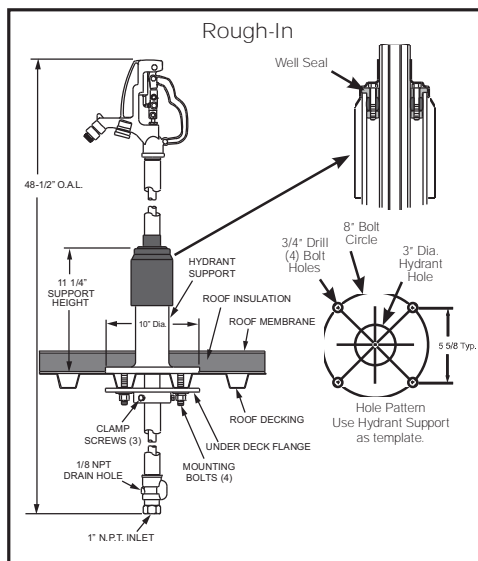
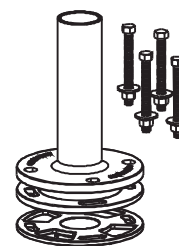



ASCE 1052
Dual Check - Auto Drain
Backflow Preventer

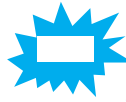
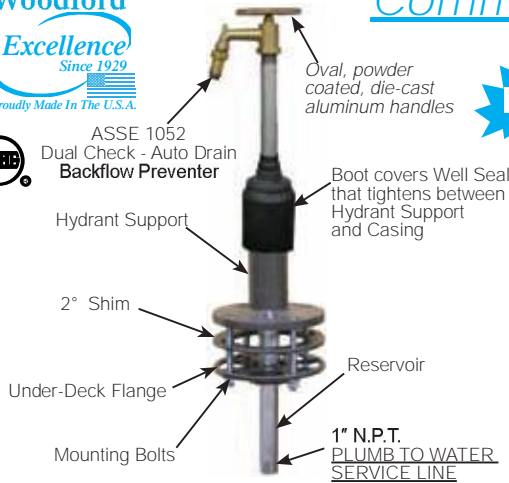

Mild Climate Model RHMC-MS

The Woodford, RHMC-MS Roof Hydrant is intended to provide water on commercial building roofs, in non-freezing mild climate areas, for window washing, cleaning of condenser coils, cooling towers, green roofs and other types of roof top equipment. The RHMC is backflow protected with a field testable ASCE 1052 dual check backflow preventer.

The RHMC-MS with Mounting System allows for installation flexibility. It is not necessary to install hydrant when hydrant support is mounted to the roof. The hydrant support utilizes a 3" diameter opening that allows the hydrant to be installed or easily removed at a later time. All necessary mounting hardware for proper installation on a commercial roof is supplied, including a 2 degree shim for pitch adjustment.

ROOF HYDRANT	PRICE
RHMC-MS Complete	404.75
RH-MS	240.75
RHMC	164.00

[See Page 10 for RH-MS Mounting System Details](#)

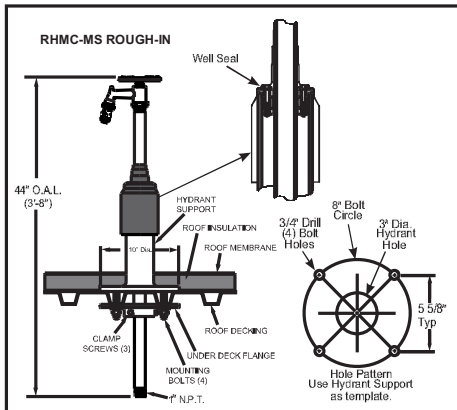

Part# RHMC-MS

Consists of the complete Roof Hydrant system: Qty. 1 RHMC Hydrant shipped in 1 carton. Qty. 1 RH-MS Mounting System shipped in 1 carton.

Total Shipping Wt.
2 cartons: 50 lbs

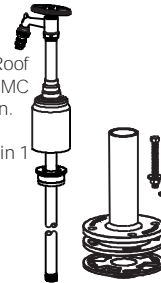

Part# RHMC

Carton contents consists of:
• Hydrant Assembly
• Well Seal
• Boot

Shipped in 1 Carton.
Shipping Wt. - 20 lbs



ASCE 1052
Dual Check - Auto Drain
Backflow Preventer

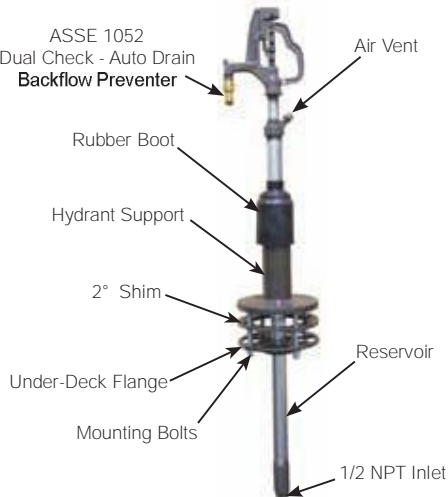

Sanitary Model SRH-MS

No Drain Line Required!

ASCE 1057

This hydrant does not require removal of vacuum breaker or use of a diverter to protect from freezing.

The Woodford SRH Freezeless Roof Hydrant is designed to facilitate installing a secure sanitary hydrant on commercial roof surfaces. With hose removed, a venturi action forces water to drain up and out through the backflow preventer. This product can be used for cleaning condenser coils, windows or any other job where a roof water source is required.

ROOF HYDRANT	PRICE
SRH-MS Complete	715.90
RH-MS	240.75
SRH	475.15

[See Page 10 for RH-MS Mounting System Details](#)

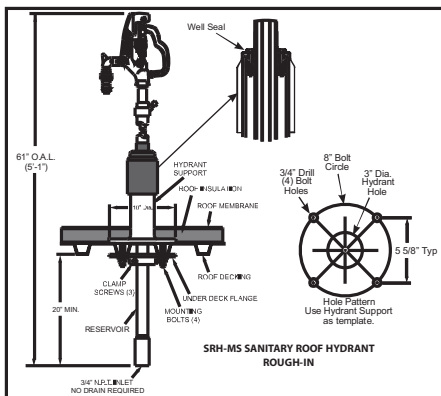

Part# SRH-MS

Consists of the complete Roof Hydrant system: Qty. 1 SRH Hydrant shipped in 1 carton. Qty. 1 RH-MS Mounting System shipped in 1 carton.

Total Shipping Wt.
2 cartons: 50 lbs

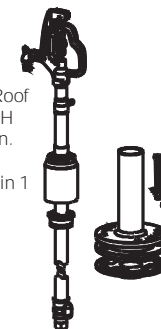

Part# SRH

Carton contents consists of:
• Hydrant Assembly
• Well Seal
• Boot

Shipped in 1 Carton.
Shipping Wt. - 20 lbs

