



see what Delta can do™

72632



X00072632

INSTALLATION INSTRUCTIONS FOR ADJUSTABLE WALL BAR

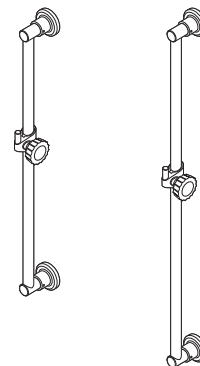

Models

55024▲ & 55030▲

Series

Write purchased model number here.

Escriba aquí el número del modelo comprado.

▲Designate proper finish suffix

The installation of your new Delta® adjustable bar unit is simple and easy requiring no special tools or skills. Caution: Use care to avoid marring or scratching chromed and plastic surfaces. A personal shower offers numerous possibilities of connections to water supply. The hose will connect easily to the shower arm, elbow at the shower outlet, Delta® shower diverter (permitting existing shower to

remain in use), or Delta® diverter tub spout (permitting this shower to be added to baths without a shower). It is important to establish your water supply connections first, as this avoids mounting the bar too far from the water supply outlet, creating excessive strain on flexible hose. As subsequent instructions specify, the bar should be mounted in a vertical position at the most convenient height.

Conversion of Water Supply

Conventional Water Supply For wall shower/hand shower use.

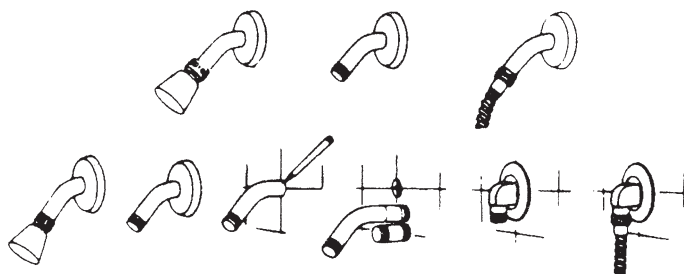

Installation:

1. Remove existing shower head from shower arm.
2. Attach flexible hose to exposed threads on shower arm using gasket.

Installation:

1. Remove existing shower head and escutcheon from shower arm.
2. Mark shower arm at wall and remove shower arm replacing it with a nipple 1/2 inch longer than unexposed length of shower arm to the mark.
3. Attach Delta® supply elbow with flange onto nipple and tighten securely. **Caution: Do not twist supply pipe in wall.**
4. Attach hose to supply elbow using gasket provided.

Shower Diverter Water Supply For use with existing shower.

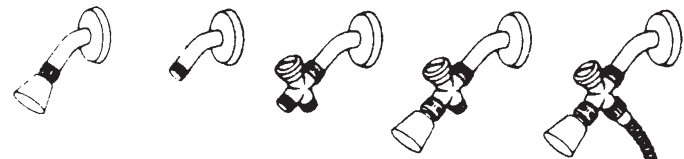

Installation:

1. Remove shower head by turning counter clockwise.
2. Attach female threaded end of shower diverter to shower arm, using gasket supplied. Do not overtighten.
3. Replace shower head onto end of diverter shower. A sealant such as pipe compound or plumber tape may be required to prevent water seepage.
4. Attach flexible hose to shower diverter using gasket supplied. Do not overtighten.

Tub Spout Water Supply For baths without shower.



Installation:

1. Remove present tub spout by turning counter clockwise.
2. Replace with Delta® diverter tub spout following directions enclosed inside package.

Hose Care

Your hose is of high quality chrome plated spiral wound around a rubber inner liner. It will provide many years of quality performance with proper care. Avoid the following conditions which may weaken or damage your hose and void your warranty.

Do not pull, strain, stretch, or jerk hose.

Do not wind, swirl or twist hose.

Do not bend, knot, coil or crimp hose.

Select Location

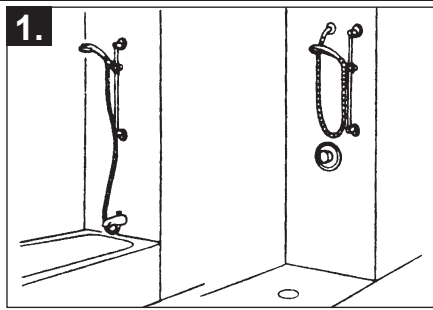

Your bar unit is a beautiful bath accessory and should be located so it looks good and performs as intended. Pictured are some typical installations as suggestions only, pick a location that suits your family's needs.

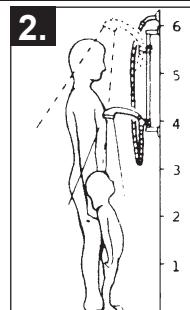

Select a convenient height based on your family's needs. **Note:** Locate so there will be slack in the hose when shower is in extreme up or down position.

Mounting Bar

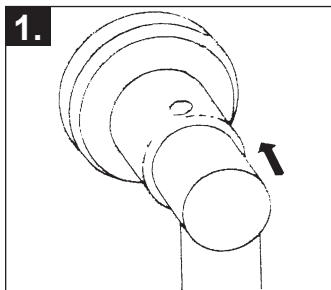

Place end mount of wall bar into the mount - do not tighten the set screw.

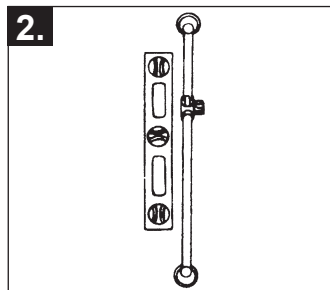

Position bar on wall at desired position.

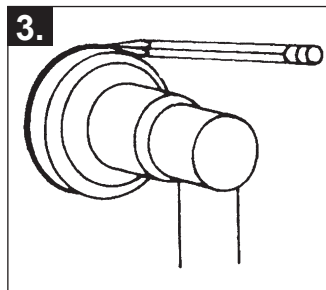

Draw circle around top mount with soft pencil.

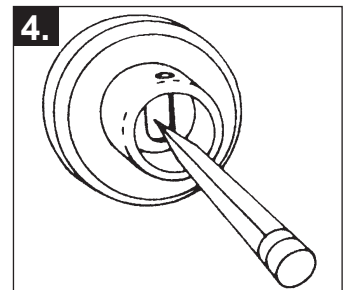

Remove bar mount from bar. Place in marked position on wall and mark center screw hole on wall. Do not mark lower mount at this time.

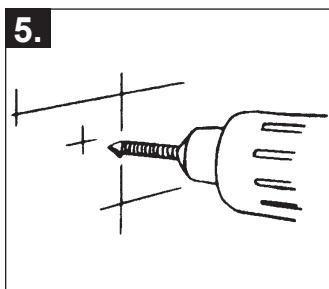

Drill hole for top mount. Use 1/4 inch carbide drill for ceramic tile.

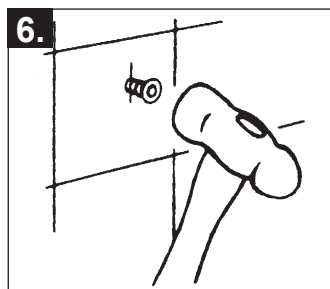

Insert screw anchor.

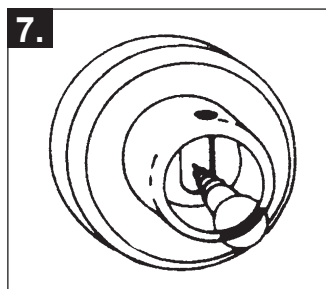

Secure mount to wall with screw. **Note:** Allen set screw must be at top of mount.

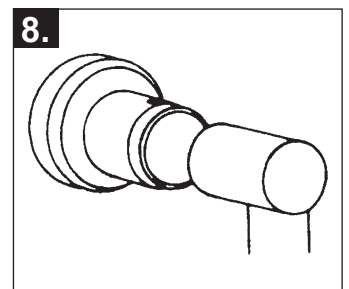

Place bar into mount. Do not tighten Allen set screw.

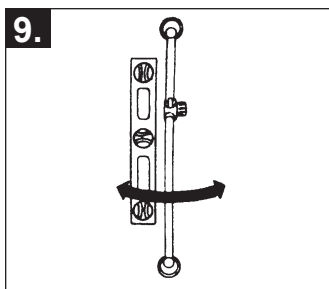

Align bar and mark bottom as in step 5.

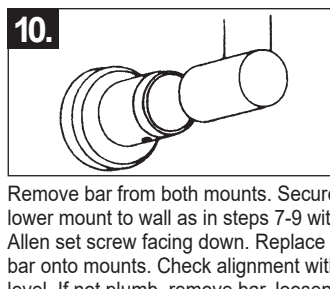

Remove bar from both mounts. Secure lower mount to wall as in steps 7-9 with Allen set screw facing down. Replace bar onto mounts. Check alignment with level. If not plumb, remove bar, loosen mount screws and adjust accordingly, retighten screws and replace bar.

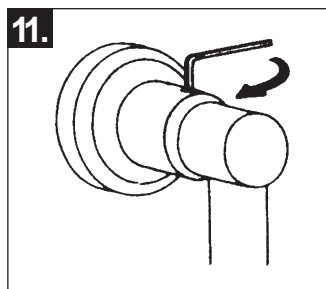

Tighten Allen set screw on both top and bottom mounts.

CAUTION:
Delta® Wall Bars are not to be used as grab bars!

Limited Warranty on Delta® Faucets

Parts and Finish: All parts (other than electronic parts and batteries) and finishes of Delta® faucets purchased from authorized Delta sellers are warranted to the original consumer purchaser to be free from defects in material and workmanship for as long as the original consumer purchaser owns the home in which the faucet was first installed. For commercial purchasers, (a) the warranty period is ten (10) years for multi-family residential applications and (b) five (5) years for all other commercial applications, in each case from the date that the product is received by the original purchaser or their authorized representative (installation contractor, etc.). For purposes of this warranty, the term "multi-family residential application" refers to the purchase of the faucet from an authorized Delta seller by a purchaser who owns but does not live in the residential dwelling in which the faucet is initially installed, such as in a rented or leased single unit or multi-unit detached home (duplex or townhome), or a condominium, apartment building or community living center. The following installations are not considered multi-family residential applications, are excluded from the 10-year warranty and are subject to the 5-year warranty: industrial, institutional or other business premises, such as a dormitory, hospitality premises (hotel, motel or extended stay location), airport, educational facility, long- or short-term healthcare facility (hospital, rehabilitation center, nursing, assisted or staged-care living unit), public space or common area.

Parts and Finish for Delta® Recertified Faucets: Delta Faucet Company offers for sale online Delta® Recertified faucets. Delta® Recertified faucets only include faucets that have been certified as such by Delta Faucet Company. All parts (other than electronic parts and batteries) and finishes of these Delta® Recertified faucets are warranted to the original consumer purchaser to be free from defects in material and workmanship for ten (10) years from the date that the product is received by the original purchaser or their authorized representative (installation contractor, etc.). For commercial purchasers, the warranty period is one (1) year from the date that the product is received by the original purchaser or their authorized representative (installation contractor, etc.).

Electronic Parts: Electronic parts (other than batteries), if any, of Delta® faucets purchased from deltafaucet.com or authorized Delta sellers are warranted to the original consumer purchaser to be free from defects in material and workmanship for five (5) years from the date that the product is received by the original purchaser or their authorized representative (installation contractor, etc.) or, for commercial purchasers, for one (1) year from the date that the product is received by the original purchaser or their authorized representative (installation contractor, etc.). No warranty is provided on batteries.

What We Will Do: Delta Faucet Company will repair or replace, free of charge, during the applicable warranty period (as described above), any part or finish that proves defective in material and/or workmanship under normal installation, use and service. Delta Faucet Company may, in its sole discretion, use new, refurbished or recertified parts or products for such repair or replacement. If repair or replacement is not practical, Delta Faucet Company may elect to refund the purchase price in exchange for the return of the product. **These are your exclusive remedies.**

What Is Not Covered: Because Delta Faucet Company is unable to control the quality of Delta products sold by unauthorized sellers, unless otherwise prohibited by law, this warranty does not cover Delta products purchased from unauthorized sellers.

Any labor charges incurred by the purchaser to repair, replace, install or remove this product are not covered by this warranty. Delta Faucet Company shall not be liable for any damage to the faucet resulting from reasonable wear and tear, outdoor use, misuse (including use of the product for an unintended application), freezing water, abuse, neglect or improper or incorrectly performed installation, maintenance or repair, including failure to follow the applicable care and cleaning instructions. Delta Faucet Company recommends using a professional plumber for all installation and repair of faucets. We also recommend that you use only genuine Delta® replacement parts.

What You Must Do To Obtain Warranty Service or Replacement Parts: A warranty claim may be made and replacement parts may be obtained by calling 1 800 345 DELTA (3358) or by contacting us by mail or online as follows (please include your model number, date of original purchase and documentation of the date of receipt of the product by the original purchaser or their authorized representative (installation contractor, etc.)):

In the United States and Mexico:

Delta Faucet Company
55 E. 111th Street
Indianapolis, IN 46280
Attention: Warranty Service
www.deltafaucet.com/service-parts/contact-us

In Canada:

Masco Canada Limited, Plumbing Group
Technical Service Centre
350 South Edgeware Road
St. Thomas, Ontario, Canada N5P 4L1
Attention: Customer Service
<http://www.deltafaucet.ca/customersupport/assistance.html>

Proof of purchase (original sales receipt showing purchase date) and documentation of the date of receipt of the product by the original purchaser or their authorized representative (installation contractor, etc.) from the original purchaser must be made available to Delta Faucet Company for all warranty claims unless the purchaser has registered the product with Delta Faucet Company or the product is a Delta® Recertified product purchased from deltafaucet.com. This warranty applies only to Delta® faucets manufactured after January 1, 2019 and installed in the United States of America, Canada and Mexico.

Limitation on Duration of Implied Warranties: Please note that some states/provinces (including Quebec) do not allow limitations on how long an implied warranty lasts, so the below limitations may not apply to you. TO THE MAXIMUM EXTENT PERMITTED BY APPLICABLE LAW, ANY IMPLIED WARRANTY, INCLUDING THE IMPLIED WARRANTIES OF MERCHANTABILITY AND OF FITNESS FOR A PARTICULAR PURPOSE, IS LIMITED TO THE STATUTORY PERIOD OR THE DURATION OF THIS WARRANTY, WHICHEVER IS SHORTER.

Limitation of Special, Incidental or Consequential Damages: Please note that some states/provinces (including Quebec) do not allow the exclusion or limitation of special, incidental or consequential damages, so the below limitations and exclusions may not apply to you. TO THE MAXIMUM EXTENT PERMITTED BY APPLICABLE LAW, THIS WARRANTY DOES NOT COVER, AND DELTA FAUCET COMPANY SHALL NOT BE LIABLE FOR, ANY SPECIAL, INCIDENTAL OR CONSEQUENTIAL DAMAGES (INCLUDING LABOR CHARGES TO REPAIR, REPLACE, INSTALL OR REMOVE THIS PRODUCT), WHETHER ARISING OUT OF BREACH OF ANY EXPRESS OR IMPLIED WARRANTY, BREACH OF CONTRACT, TORT, OR OTHERWISE. DELTA FAUCET COMPANY SHALL NOT BE LIABLE FOR ANY DAMAGE TO THE FAUCET RESULTING FROM REASONABLE WEAR AND TEAR, OUTDOOR USE, MISUSE (INCLUDING USE OF THE PRODUCT FOR AN UNINTENDED APPLICATION), FREEZING WATER, ABUSE, NEGLIGENCE OR IMPROPER OR INCORRECTLY PERFORMED INSTALLATION, MAINTENANCE OR REPAIR, INCLUDING FAILURE TO FOLLOW THE APPLICABLE INSTALLATION, CARE AND CLEANING INSTRUCTIONS. Notice to residents of the State of New Jersey: The provisions of this warranty, including its limitations, are intended to apply to the fullest extent permitted by the laws of the State of New Jersey.

Additional Rights: This warranty gives you specific legal rights, and you may also have other rights which vary from state/province to state/province. This is Delta Faucet Company's exclusive written warranty and the warranty is not transferable.

If you have any questions or concerns regarding our warranty, please contact us as provided above or view our Warranty FAQs at www.deltafaucet.com.

© 2023 Masco Corporation of Indiana