

# WINGITS®

## MODERN Elegance™

### Stainless Steel Double Robe Hook

Model:

## WMEDRH

Part Numbers:

WMEDRHPS  
Polished Finish

WMEDRHSN  
Satin Finish

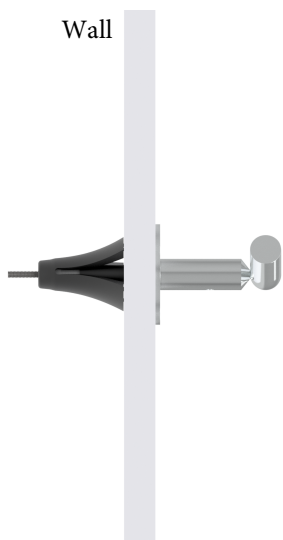

#### Features:

- Modern design combined with **PATENTED BridgeBind™** Manufacturing creates the ultimate in bath accessories
- No Lines for Dirt to Collect - Maintenance Free
- Hand Polished Stainless Steel

#### MECHANICAL DATA

**Length:** 3.125" (80mm)  
**Depth:** 2.5" (64mm)  
**Height:** 2" (51mm)  
**Tube Diameter:** 0.625" (16mm)

#### COMPOSITION

18-8 (304) Stainless Steel

#### INSTALLATION

Includes Stainless Steel Screw to Install into **Adequate Structural Blocking**.  
Includes 3M® VHB Waterproof Tape.  
Can Be Installed with WINGITS® Fasteners when blocking is not available.

#### RECOMMENDED INTEGRATION

**PROPER INSTALLATION REQUIRES** use of 3M® VHB Waterproof Tape to stop rotation and **MUST** be installed into **Adequate Structural Blocking** or with optional WINGITS® Fasteners.

WINGITS® MODERN™ design is available in all Bath Accessories.

PATENTED

### BridgeBind™ Technology



A steel dowel is expertly embedded in a stainless steel tube then arc welded to the tube's far side for the perfect structural synthesis

Front

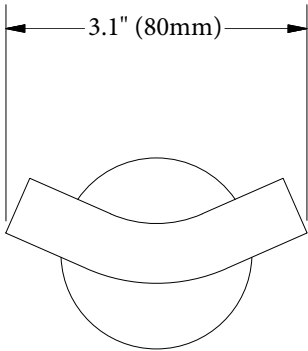

Back

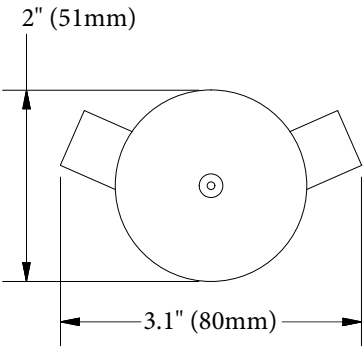

Top

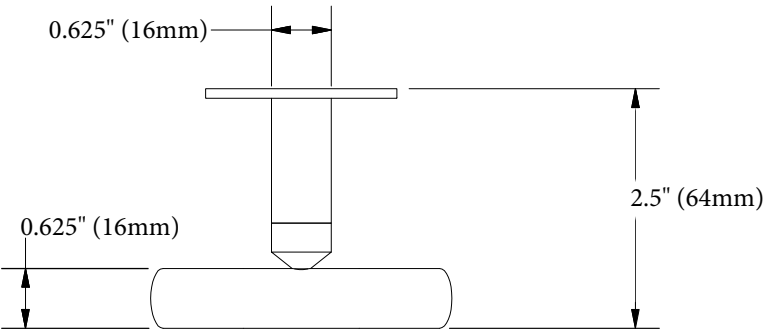

Side

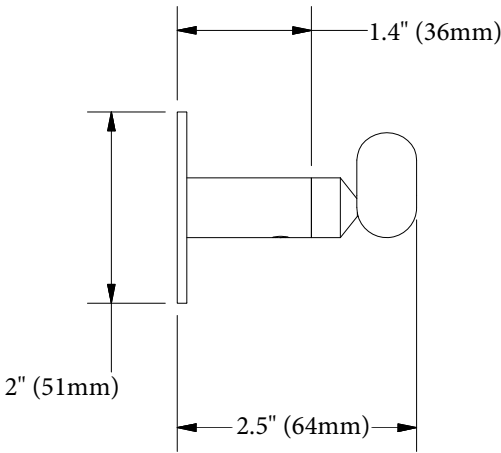

Included Hardware

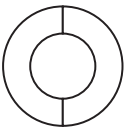

3M<sup>®</sup> Waterproof Tape (1)



2.5" S/S Screw (1)

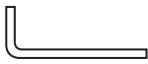

Allen Wrench (1)



Set Screw (1)

Optional Hardware  
(Sold Separately)

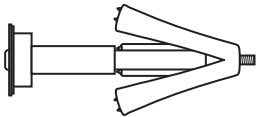

WINGITS<sup>®</sup> MASTER Anchor<sup>™</sup> (MAW35)  
(1)