

Fig. 171: Pipe Roll

Single Pipe Roll

Size Range: 1" through 30"

Material: Cast iron roll and sockets, steel roll rod

Finish: Plain or Galvanized

Service: For suspension of pipe from two rods where longitudinal expansion and contraction may occur.

Approvals: Complies with Federal Specification A-A-1192A (Type 41), WW-H-171-E (Type 42), ANSI/MSS SP-69 and MSS SP-58 (Type 41).

Adjustment: Adjustable socket permits vertical adjustment at the roll.

Maximum Temperature: 450° F at roller

How to size:

- (1) If the roll is to support non-insulated pipe, select the size directly from nominal pipe size (column 1) in table below.
- (2) If used with pipe covering protection saddle, see page 104 for size of pipe roll.

Features:

- Provides for vertical adjustment; nut at bottom of hanger rod fits into the socket preventing loosening or turning due to vibration.
- Pipe roll is designed for two point surface contact with pipe or saddle.

Ordering:

- Specify pipe roll size.
- Order should include figure number, name and finish in all cases. Hanger rods and nuts to be ordered separately.
- Be certain to order oversized rolls when insulation and protection saddles makes this necessary.

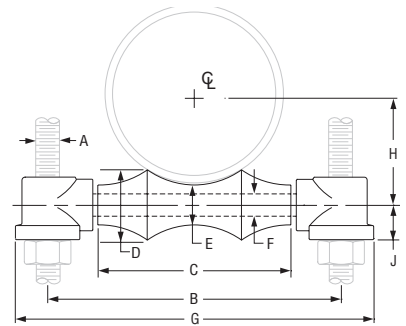

FIG. 171: LOADS (LBS) • WEIGHT (LBS) • DIMENSIONS (IN)

Pipe Size	Max O.D. Covering	Rod Size A	Max Load	Weight	G	B	C	D	E	F	H	J		
1	2	3/8	600	0.45	4 1/8	3	1 1/2	1	3/4	3/8	1 1/16	9/16		
1 1/4	2 1/2			0.48	4 1/2	3 3/8	1 7/8	1 1/16			1 1/4			
1 1/2	2 3/4			0.51	4 3/4	3 5/8	2 1/8	1 1/8			1 3/8			
2	3 1/4			0.57	5 1/4	4 1/8	2 5/8	1 3/16			1 5/8			
2 1/2	3 3/4	1/2	660	1.00	6 1/4	4 7/8	3 1/8	1 3/8	7/8	1/2	1 15/16	1 1/16		
3	4 1/2		700	1.10	6 7/8	5 1/2	3 3/4	1 7/16			2 1/4			
3 1/2	5		1.40	7 1/2	6 7/8	4 1/4	1 5/8	2 9/16						
4	5 1/2	5/8	750	1.70	8 1/4	6 7/8	4 3/4	1 3/4	1	5/8	2 13/16	3/4		
5	7			2.60	9 11/16	8 1/16	5 13/16	2			1 1/8		3 7/16	7/8
6	8 1/4	3/4	1,070	4.50	11 7/16	9 9/16	6 7/8	2 5/16	1 1/4	3/4	4	1		
8	10 1/2		1,350	7.20	14 1/16	11 15/16	8 7/8	2 13/16			1 1/2		5 1/8	
10	12 3/4	7/8	1,730	9.50	16 3/16	14 1/16	11	3 3/8	1 3/4	7/8	6 3/8	1 1/4		
12	14 3/4			2,400	15.90	17 15/16	15 13/16	12 1/2			3 7/8		2	1
14	16 1/4	1	3,130	24.30	20 1/8	17 3/4	14 1/4	4 5/8	2 1/2	1 1/8	8 3/8	1 3/8		
16	18			3,970	31.90	22 1/8	19 3/4	16 1/4			5		2 5/8	9 7/16
18	20 1/4			4,200	35.50	24 1/2	21 7/8	18 1/4			5 7/16		2 3/4	10 1/2
20	22 1/2	1 1/4	4,550	47.00	27 1/4	24 1/4	20 1/4	6	3	1 1/4	11 1/8	1 5/8		
24	26 1/2			6,160	76.30	32 1/8	28 7/8	24 1/4			7 3/16		3 5/8	14
30	32 1/2	1 1/2	7,290	129.90	39	35 1/2	30 1/4	8 15/16	4 1/2	1 3/4	17 7/16	2 7/16		

DI/CI ROLL SIZING	
DI/CI Pipe Size	Fig. 171 Roller Size
3	4
4	5
6	6
8	8
10	10
12	14
14	16
16	18
18	20
20	24
24	30
30	No Recom.

PROJECT INFORMATION

APPROVAL STAMP

Project:	<input type="checkbox"/> Approved
Address:	<input type="checkbox"/> Approved as noted
Contractor:	<input type="checkbox"/> Not approved
Engineer:	Remarks:
Submittal Date:	
Notes 1:	
Notes 2:	