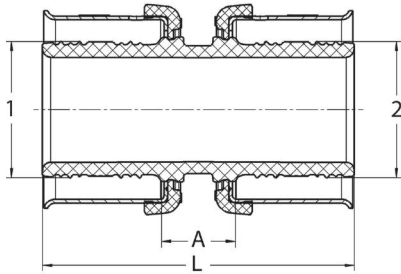
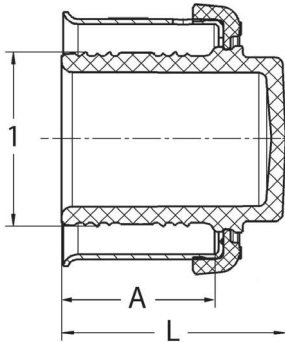
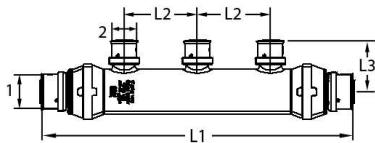

PureFlow Press Coupling Polymer - Model V5615

Part No.	Size (in)	A (in)	L (in)
	1 2		
49402	3/8 x 3/8	0.47	1.66
49342	1/2 x 3/8	0.42	1.61
49403	1/2 x 1/2	0.47	1.66
49404	3/4 x 3/4	0.47	1.66
49343	3/4 x 1/2	0.43	1.62
49354	1 x 3/4	0.47	1.82
49405	1 x 1	0.47	1.98
49347	1 1/4 x 3/4	0.65	2.34
49357	1 1/4 x 1	0.48	2.33
49407	1 1/4 x 1 1/4	0.51	2.69
49348	1 1/2 x 3/4	0.69	2.37
49358	1 1/2 x 1	0.62	2.47
49378	1 1/2 x 1 1/4	0.50	2.69
49408	1 1/2 x 1 1/2	0.51	2.69
49398	2 x 1 1/2	1.05	3.16
49409	2 x 2	1.02	3.16

PureFlow Press Test Plug Polymer - Model V5656

Part No.	Size (in)	A (in)	L (in)
	1		
49722	3/8	0.60	0.95
49723	1/2	0.60	0.95
49744	3/4	0.60	0.95
49765	1	0.75	1.10
49770	1 1/4	1.10	1.46
49780	1 1/2	1.10	1.46
49790	2	1.07	1.93

PureFlow Press Manifold Polymer Flow Through - Model V5636

Part No	Size (in)	Outlets	L1 (in)	L2 (in)	L3 (in)
	1 2				
49152	3/4 x 1/2	2	6.58	2.00	1.42
49153	3/4 x 1/2	3	8.58	2.00	1.42
49054	3/4 x 1/2	4	10.58	2.00	1.42
49254	1 x 3/4 x 1/2	4	10.72	2.00	1.42
49256	1 x 1/2	6	14.85	2.00	1.42
49258	1 x 1/2	8	18.85	2.00	1.42