



SYMMONS®

Tub and Shower Assembly

4-5000VT-LIG

Parts Breakdown



Need Help?

Contact Symmons customer service at
(800) 796-6667, (781) 848-2250
Email: customerservice@symmons.com
Monday - Friday 7:30 am - 7:00 pm EST



Please check Symmons website for technical help,
the latest product information and warranty policy.
Website: www.symmons.com

Product Highlights

- Pressure balancing mixing valve
- Adjustable stop screw to limit handle turn
- Integral service stops to allow water shut-off at valve for servicing
- Polished chrome finish

Parts Assembly

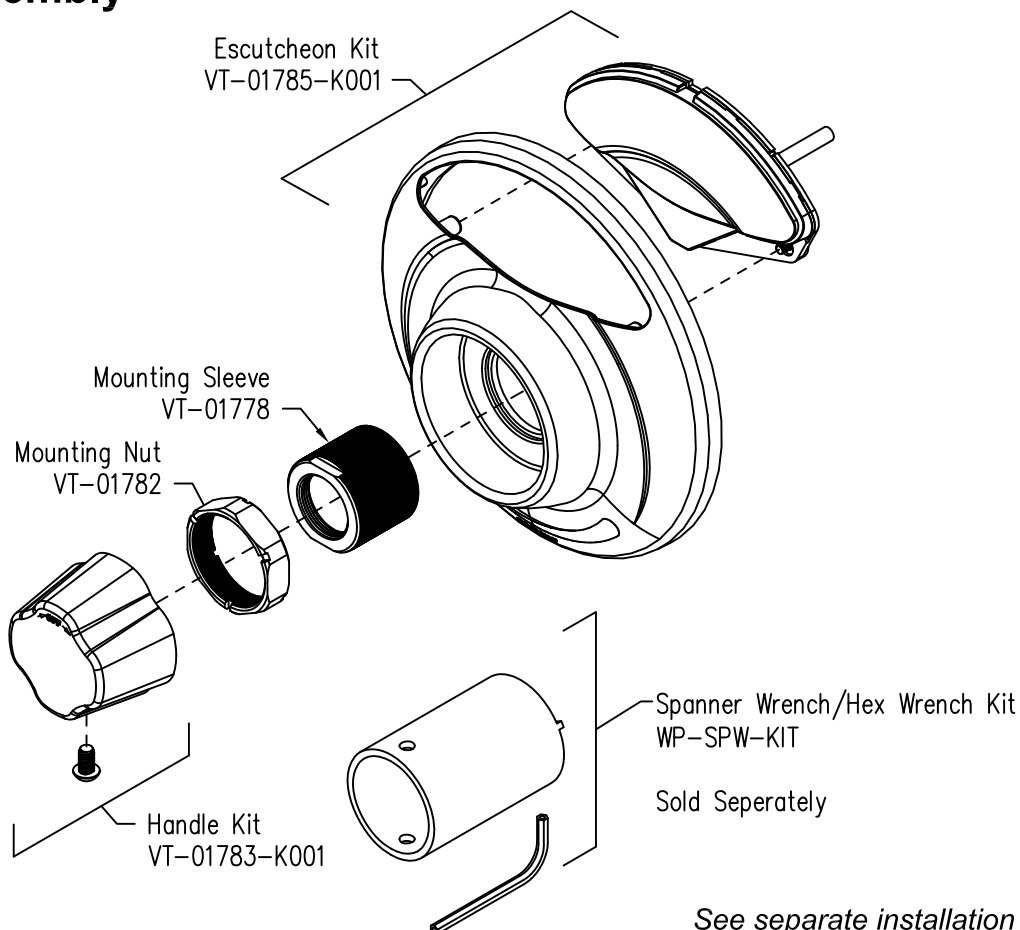

*See separate installation instructions
for control valve replacement parts.*

ATTENTION: Important Cleaning Instructions

To ensure that your Symmons faucet or tub/shower trim will continue to look as beautiful as the day it was installed, please follow these simple cleaning instructions.

1. To clean the finish on your Symmons faucet or tub/shower trim, rinse with clean water, wipe with a soft damp cloth and blot dry with a soft cotton cloth or towel.
2. If heavy cleaning is required start by cleaning as described in Step 1. Use a mild liquid soap or liquid glass cleaner to remove any remaining surface buildup. Rinse faucet or tub/shower trim with clean water to remove any remaining cleaning solution and blot dry with a soft cotton cloth or towel.

DO NOT use cleaning products containing abrasives, acids, alcohol, bleach or foaming compounds. If any unintentional splashing or overspray of these types of products comes in contact with your faucet or tub/shower trim immediately rinse it with clean water and blot dry with a clean soft cotton cloth or towel.

INSTALLER: Please leave this notice with owner.

1-800-SYMMONS www.symmons.com 111210



ZV-100