



Fluidmaster®

PerforMAX™

**High Performance
Toilet Fill Valve**

**Quietest and
most powerful
fill valve on
the market**

Works with all toilets,
including Kohler®, Toto® and
American Standard®

Universal fit, perfect for:

- High efficiency toilets
(HET 1.28 gal.)
- Dual Flush including
DUO FLUSH™
- 1.6 gallon toilets with
2" and 3" flush valves
(1994 & newer)
- Older high gallon toilets
with 2" Flush valve
(1994 & older)

**Maximize toilet
performance
and save water**

**7 YEAR
WARRANTY**

Preferred by Toilet Manufacturers



Large Turbo Port:
For exceptional fill power.

Water Saving Roller Clamp:
Lets you regulate fill level in the bowl, saving water and money.

EZ-Twist Height:
Adjusts from 10" to 15" to fit most tanks.

Double Flange Design:
For ultra quiet fill.

Torque Guard Lock Nut:
Prevents thread damage from over-tightening.



400ARHR

PerforMAX™ High Performance Toilet fill Valve

Universal Fit

2X greater refill rate
than standard fill valves

Avoids excessive or
inadequate bowl
fill levels

Quick, Easy Installation

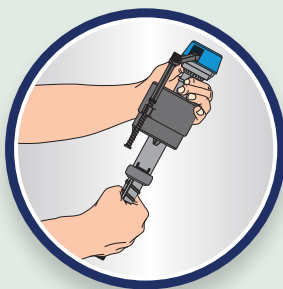

Set Height.

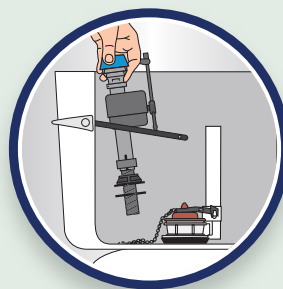

Install.

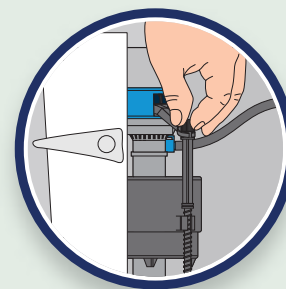

Adjust.

MODEL NUMBER	CASE QTY	PRODUCT DIMENSIONS H/W/D (INCHES)	CASE DIMENSIONS H/W/D (INCHES)	CASE WEIGHT (LBS)	UPC 0 39961	SCCI 2 OF 5 100 39961
400ARHR	10	12.5 x 4.5 x 3.125	12.625 x 8.625 x 16.5	8.0	70245 6	70245 3

Fluidmaster, Inc. at 30800 Rancho Viejo Road, San Juan Capistrano, CA 92675
(949) 728-2000, Fax (949) 728-2205.

Red/Green color arrangement is a registered trademark of Fluidmaster, Inc.
© 2011 Fluidmaster, Inc. ® Registered trademark of Fluidmaster, Inc.

U.S. and Other Patents Pending.

10/11 FM91399 Rev.2

**The latest
technology & best
performance**