

1 APPLY LOCTITE 680.

2 SLIT O-RING, ITEM 8, BEFORE INSTALLING.

3 INSTALLATION TORQUE: 11 - 14 LB-FT

4 ASSEMBLY SHALL BE WATER TESTED.

5 BAG 5-007 IN A SEPARATE BAG.

6 CUT O-RING, ITEM 9, TO .20"  
(SHORTEN BY .13") BEFORE  
INSTALLING.

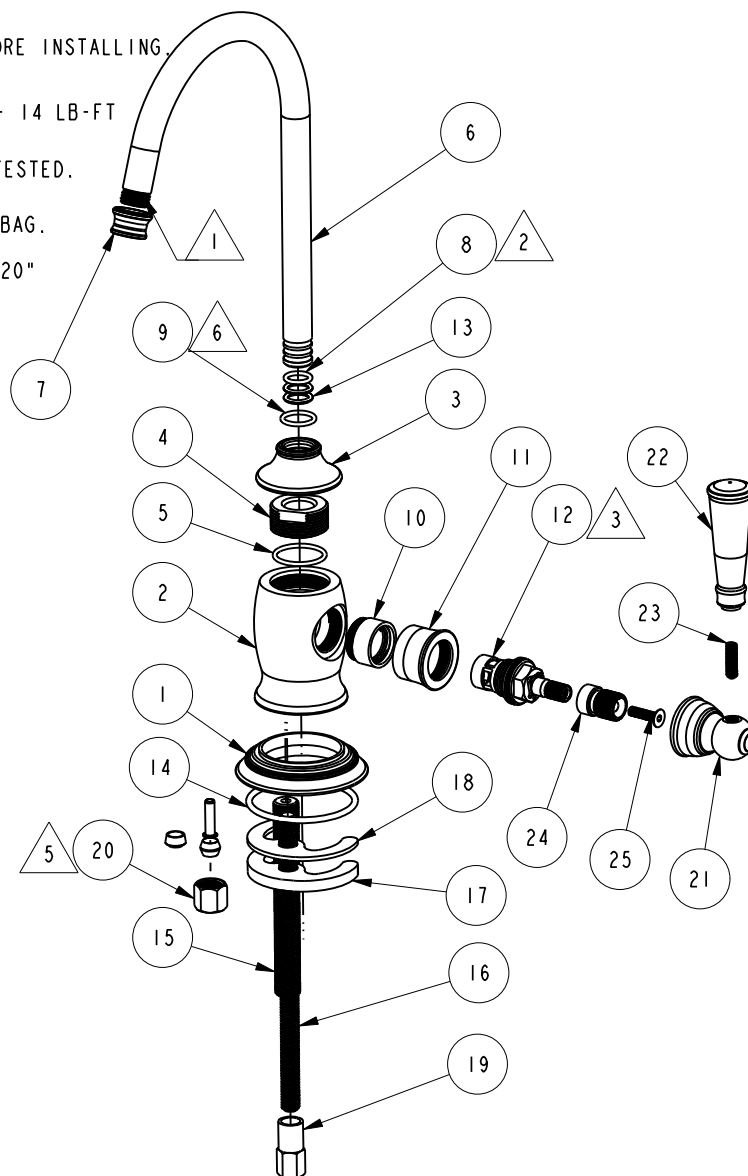
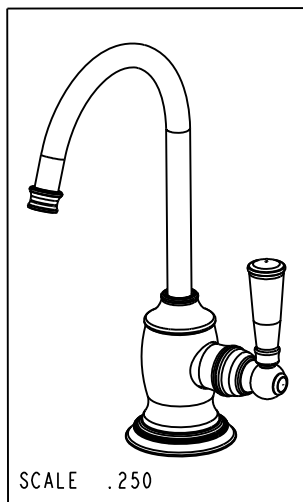

### BILL OF MATERIAL (CURRENT LEVEL)

ITEM	PT/ASSY	DESCRIPTION	TYPE	QTY.
1	11731	ESCUTCHEON	PART	1
2	50703	WATER DISP. BODY (TRAD.)	PART	1
3	11732	CAP, BODY, WATER DISP	PART	1
4	11836	RETAINING RING	PART	1
5	91023	O-RING #2-019	PART	1
6	50713	SPOUT, WATER DISP. (TRAD.)	PART	1
7	11733	SHELL, SPOUT, WATER DISP	PART	1
8	91382	O-RING, TEFLON, #2-012	PART	1
9	91383	O-RING, TEFLON, #2-014	PART	1
10	50714	WATER DISP. CAR.T HOLDER	PART	1
11	11734	BONNET	PART	1
12	1-134	CARTR 3/8 HOT 1/4 TR	PART	1
13	91017	O-RING #2-012	PART	2
14	91394	O-RING #2-132	PART	1
15	50760	NIPPLE WATER DISP	PART	1
16	10661	MOUNTING STUD	PART	1
17	10514	MOUNTING CRESCENT	PART	1
18	91063	MOUNTING CRESCENT GASKET	PART	1
19	10516	MOUNTING NUT	PART	1
20	5-007	1/4 COMP KIT	ASSEMBLY	1
21	11729	BODY HANDLE	PART	1
22	11728	LEVER, HANDLE	PART	1
23	92192	SET SCREW 10-32 X 5/8"	PART	1
24	11834	ADAPTER	PART	1
25	92477	M4 X 16 mm FLAT HD CAP SCREW	PART	1

COPYRIGHT 2005 BRASSTECH, INC. THESE DRAWINGS AND THE DESIGNS DEPICTED HEREIN ARE THE PROPRIETARY PROPERTY OF BRASSTECH. ANY USE OR REPRODUCTION IS SUBJECT TO THE EXPRESS APPROVAL OF BRASSTECH. UNAUTHORIZED USE IS STRICTLY PROHIBITED. ALL RIGHTS RESERVED.

**BRASSTECH**  
INCORPORATED  
2001 E. CARNEGIE AVE.  
SANTA ANA, CA 92705  
(949) 417-5207

JACOBEOAN TRADITIONAL COLD WATER DISPENSER "R" W/VICTORIAN SPOUT

ASSY. NO. 2470-5623

SCALE .030

REF. -

SHEET 1 OF 2

B	EN-2204	06/15/12
A	EN-2085	03/05/12
-	EN-1552-3	02/01/11
REV	REV DESC	DATE

# SPECIFICATION DWG

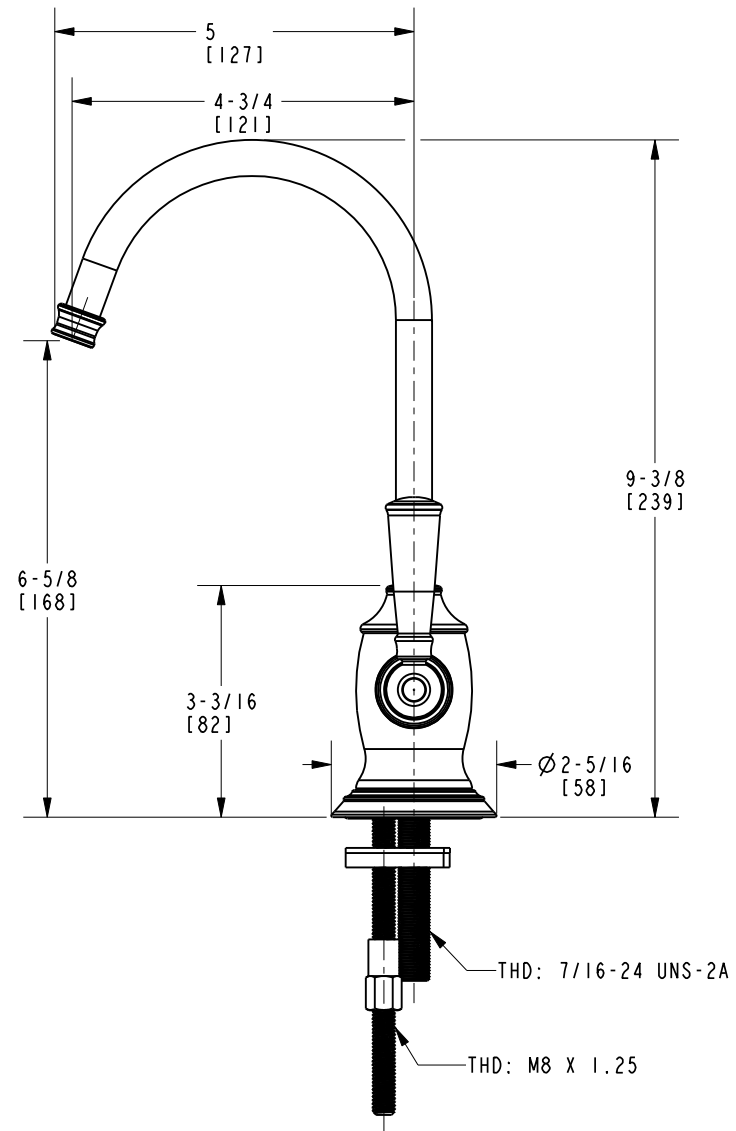
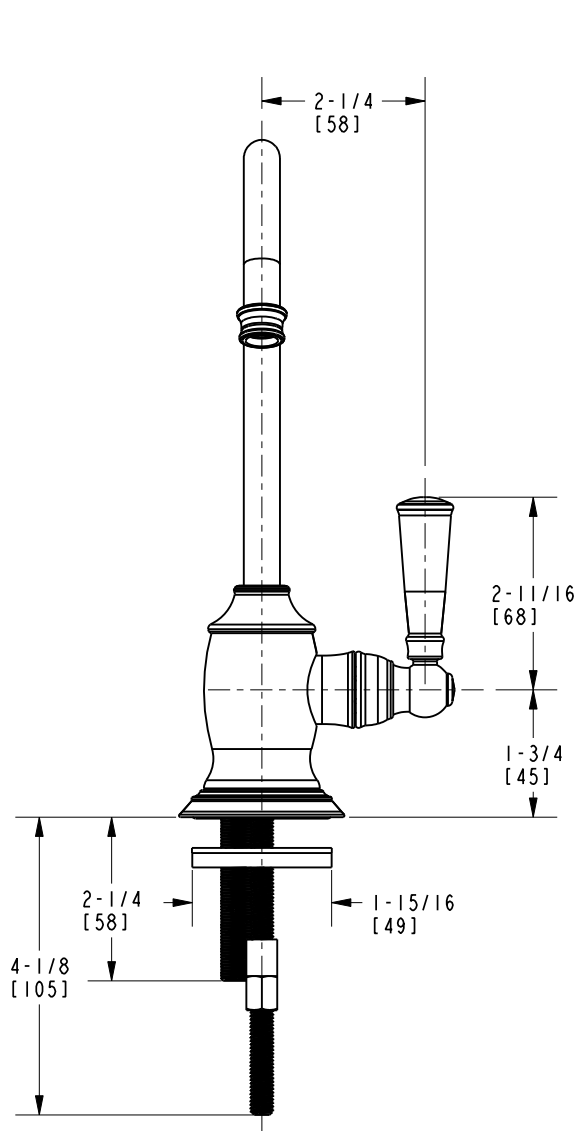

DIMENSIONS ARE IN INCHES AND AN APPROXIMATION OF A TYPICAL INSTALLATION

COPYRIGHT 2005 BRASSTECH, INC. THESE DRAWINGS AND THE DESIGNS DEPICTED HEREIN ARE THE PROPRIETARY PROPERTY OF BRASSTECH. ANY USE OR REPRODUCTION IS SUBJECT TO THE EXPRESS APPROVAL OF BRASSTECH. UNAUTHORIZED USE IS STRICTLY PROHIBITED. ALL RIGHTS RESERVED.

<b>BRASSTECH</b> INCORPORATED		2001 CARNEGIE AVE. SANTA ANA, CA 92705 (949) 417-5207
DWG NO.	2470-5623	REV B
SCALE .375	REF. -	SHEET 2 OF 2