

BRASS/COPPER BALL VALVE FOR CPVC

648 SERIES

SPECIFICATION

Sioux Chief 648 series ball valves for CPVC connection shall be used where necessary in water supply systems. Valves shall have No-Lead compliant brass bodies and plated brass ball. Valves shall be Full-Port design with 1/4-Turn operation and blowout proof stem.

MATERIALS

Body: HSI 76-3 Brass - Dezincification/SCC resistant

Seats: PTFE

Ball: Chrome-plated

Socket Extension: Copper

O-ring: EPDM

Socket: CPVC

WORKING PRESSURE

600 WOG/PSI

Note: CPVC connection specifications are limited to those called out in their respective ASTM standards for pipe and fittings.

CERTIFICATIONS/APPROVALS

cUPC Listed

Meets ASME A112.4.14 and ASME A112.18.1

DIMENSIONS

A: CPVC socket Connection	1/2"	3/4"	1"	1 1/4"	1 1/2"	2"
B: Overall length	5"	6 5/8"	7 3/4"	9 5/8"	11"	12 3/8"

ITEM # SUBMITTED	_____
JOB NAME	_____
LOCATION	_____
ENGINEER	_____
CONTRACTOR	_____
PO#	_____ TAG _____



648-CG2FPD

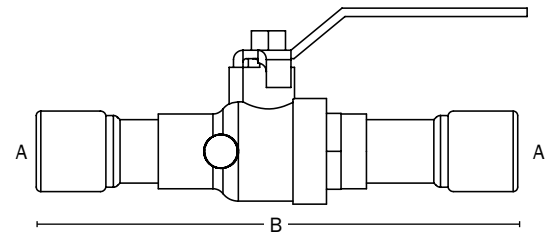

Create Item Number

648-CGA

e.g. 648-CG2FPD: 1/2" CPVC Full-Port ball valve with drain

CONNECTION A

2FPD = 1/2" CPVC Full-Port ball valve with drain

3FPD = 3/4" CPVC Full-Port ball valve with drain

4FPD = 1" CPVC Full-Port ball valve with drain

5FP = 1 1/4" CPVC Full-Port ball valve

6FP = 1 1/2" CPVC Full-Port ball valve

7FP = 2" CPVC Full-Port ball valve