



P110 Flush C.O. Plug

(Continued)

MPT



Part Number	Size	L
P110-040	4	7/8
P110-060	6	31/32

P118 Adapter Bushing
 (Adapts DWV Hub to S&D Spigot)

DWV SPIGOT x HUB

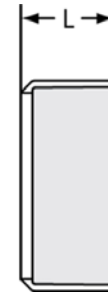

Part Number	Size	L
P118-030	3	1- 5/16
P118-040	4	2
P118-060F*	6	3-1/8

* Fabricated

P116 Cap

SOC



Part Number	Size	L
P116-015	1-1/2	15/16
P116-020	2	1
P116-030	3	1-3/4
P116-040	4	2
P116-060	6	3-5/16
P116-080	8	6-3/16

Note: 8" Cap is Domed Style

* Fabricated

P119 No-Hub Adapter

S x H

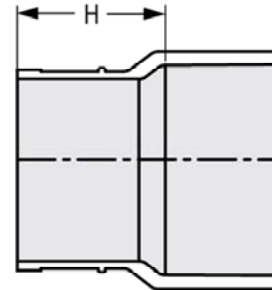

Part Number	Size	H
P119-015	1-1/2	1- 5/8
P119-020	2	1- 5/8
P119-030	3	1-3/4
P119-040	4	1- 7/8
P119-251	2X1-1/2	1- 5/8
P119-422	4X3	2- 1/16

P117 Transition Coupling
 (DWV Hub by S&D Hub)

H x H

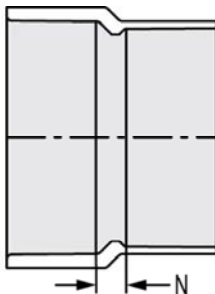

Part Number	Size	N
P117-040	4	1/2
P117-422	4X3	3/4