

SPEAKMAN NEO™

Accessories

SPECIFICATION

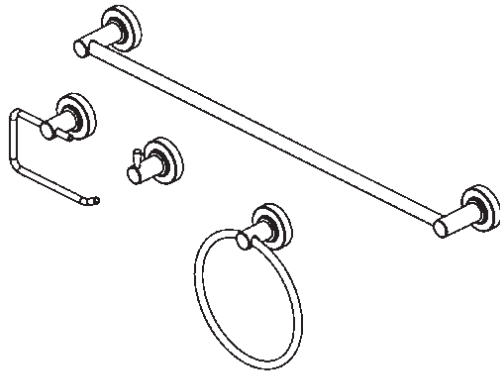

FEATURES:

- SA-1007: 24" towel bar
- SA-1004: Towel ring
- SA-1005: Paper holder
- SA-1006: Robe hook
- Metal construction

AVAILABLE FINISHES:

ADD SUFFIX TO MODEL #

- Polished Chrome (standard)
- Brushed Nickel ☐ -BN
- Polished Nickel ☐ -PN

WARRANTY:

- 1 year limited

Robe Hook
SA-1006

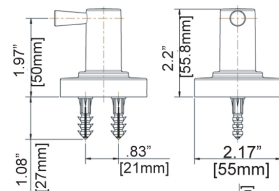

Towel Ring
SA-1004

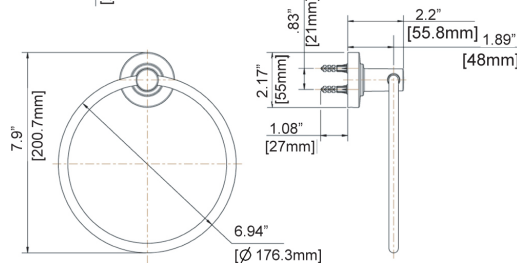

Tissue Holder
SA-1005

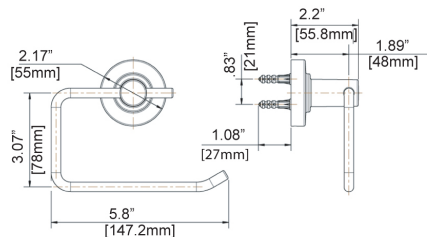

Towel Bar

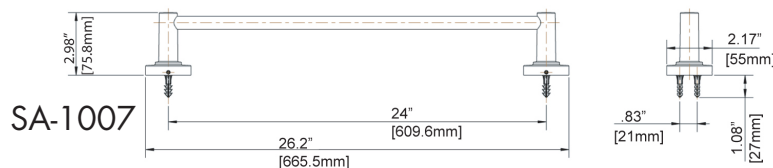

NOTE: 1. All dimensions are in inches (millimeters) unless otherwise specified and are subject to change without notice.

THIS SPACE FOR ARCHITECT/ENGINEER APPROVAL.

SPEAKMAN®

400 ANCHOR MILL ROAD | NEW CASTLE, DE 19720
P: 800-537-2107 | F: 800-977-2747
WWW.SPEAKMANCOMPANY.COM

REVISION DATE: APRIL 2013

Management Systems
Registered to ISO 9001