



**Figure # 5200**  
Brass Gas Ball Valve (3/8"-1")

**Product Features**

- 175 PSI Brass Body
- 2-Piece Body
- Threaded Ends
- CSA 1/2 & 5 PSI Approved
- UL 175 PSI Approved
- ANSI Z.21.15
- Lever, Tee or Square head handles available



**Materials & Specifications**

Item	Description	Material	Specification
1	Body	Brass	B283 C37700
2	End Piece	Brass	B283 C37700
3	Ball	Brass/Chrome Plated	B283 C37700
4	Seat	PTFE	PTFE
5	Stem	Brass	B124 C37700
6	O-Ring Packing	NBR	NBR
7	Packing Nut	Brass	B124 C37700
8	Handle	Aluminum	B85
9	Handle bolt	Brass	B16 C36000

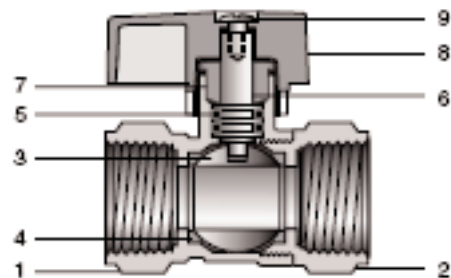

**Dimensions, Weights (inches-lbs.) & Valve Data**

Size	3/8	1/2	3/4	1
d	.39	.39	.55	.95
E	2	2	2	2
H	1.5	1.5	1.6	1.9
L	.41	.55	.59	.70
Wt.- lbs.	.26	.38	.61	.81

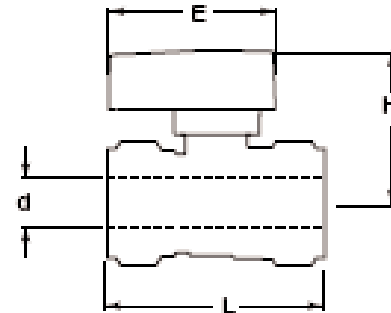

5200T Tee-Handle Version

