

# GLOBE 1502 BRONZE

125 lb. SWP-200 lb. WOG† • Plumbing and Heating  
Bronze Disc • Threaded Bonnet • Sweat Ends

3/8" and 1/2" sizes have the disc integral with the stem and have no disc ring.

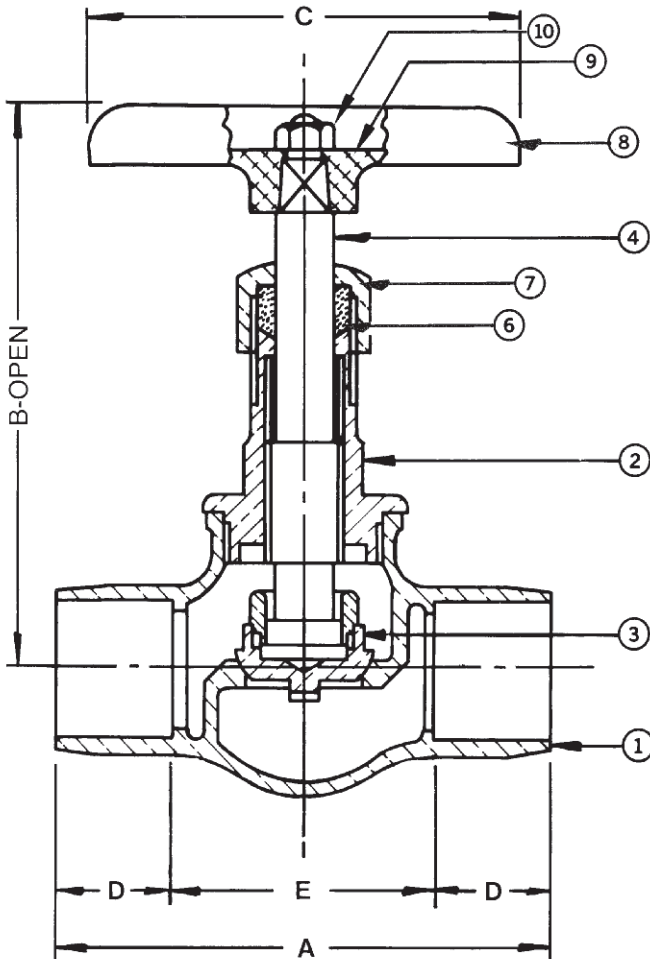

## SPECIFICATIONS

1502	Conforms to: MSS SP-80. Type 1, Class 125, Soldered Ends.		
------	---	--	--

## MATERIAL LIST

NO.	PART	MATERIAL	SPECIFICATION
1	Body	Bronze	ASTM B 62
2	Bonnet	Bronze	ASTM B 62
3	Disc	Bronze	ASTM B 62
4	Stem	Bronze	ASTM B 16
5	Disc Ring	Brass	ASTM B 16 3/4" to 2" Incl.
6	Packing	Graphite	Commercial
7	Packing Nut	Brass	ASTM B 16
8	Handwheel	Malleable Iron	Commercial
9	Identification Plate	Aluminum	Commercial
10	Handwheel Nut	Brass	Commercial

## DIMENSIONS - INCHES / MILLIMETERS

Units	Size	A	B	C	D	E	C <sub>v</sub>
Inches	3/8	2.00	3.19	2.00	0.38	1.25	2.21
mm	9.5	50.8	81.0	50.8	9.5	31.8	
Inches	1/2	2.44	3.75	2.25	0.50	1.44	3.64
mm	12.7	61.9	95.3	57.2	12.7	36.5	
Inches	3/4	3.19	4.00	2.50	0.75	1.69	6.65
mm	19.1	81.0	101.6	63.5	19.1	42.9	
Inches	1	3.69	4.38	2.75	0.91	1.88	11.10
mm	25.4	93.7	111.1	69.9	23.0	47.6	
Inches	1 1/4	4.19	5.13	3.13	0.97	2.25	20.00
mm	31.8	106.4	130.2	79.4	24.6	57.2	
Inches	1 1/2	4.75	5.63	3.50	1.09	2.56	28.00
mm	38.1	120.7	142.9	88.9	27.8	65.1	
Inches	2	5.94	6.69	4.00	1.34	3.25	48.00
mm	50.8	150.8	169.9	101.6	34.1	82.6	

† Non-Shock

Rev. 7

**INNOVATION** IN EVERY VALVE



**MILWAUKEE VALVE**

www.milwaukeevalve.com

The information presented on this sheet is correct at the time of publication. Milwaukee Valve reserves the right to change design, and/or material specifications without notice. For the Installation, Operation and Maintenance Manual (IOM) see the engineering section on our website. For the most current information access www.milwaukeevalve.com