

# Consumer Information

Faucets made of leaded brass alloys may contribute small amounts of lead to water that is allowed to stand in contact with the brass. The amount of lead contributed by any faucet is highest when the faucet is new. The following steps may reduce potential exposure to lead from faucets and other parts of the plumbing system:

- Always run the water for a few seconds prior to use for drinking or cooking.
- Use only cold water for drinking or cooking.
- If you wish to flush the entire plumbing system of water that has been standing in the pipes or other fittings, run the cold water until the temperature of the water drops, indicating water coming from the outside main.
- If you are concerned about lead in your water, have your water tested by a certified laboratory in your area.

## REPLACEMENT PARTS FOR MODELS 8120, 8121 and 8122.

Part #	Description
16839	4" Wrist Blade Handle Service Kit (model 8121), (2)
16841	6" Wrist Blade Handle Service Kit (model 8122), (2)
16842	Cross Handle Service Kit (model 8120), (2)
14690	Ceramic Disk Cartridge Service Kit
16846	Aerator Service Kit (2.0)gpm Female
16847	Aerator Service Kit (2.5)gpm Female
16848	Cartridge Removal Tool



# Disassembly

**CAUTION:** Turn “OFF” both hot and cold water supplies.  
Turn faucet handle to the on position to relieve pressure.

1. With a flat instrument carefully pry off the handle cap, remove handle screw using a **TORX** screwdriver (not supplied), pull off handle and remove cartridge nut.
2. With pliers, grasp cartridge stem and remove from cartridge.
3. With pliers, grasp cartridge as shown in illustration 2 remove from valve.

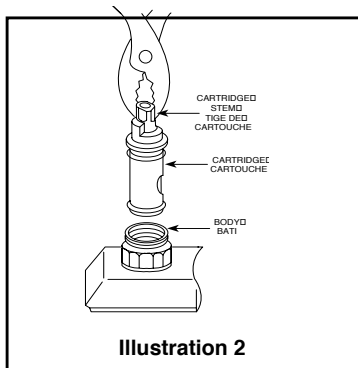

Illustration 2

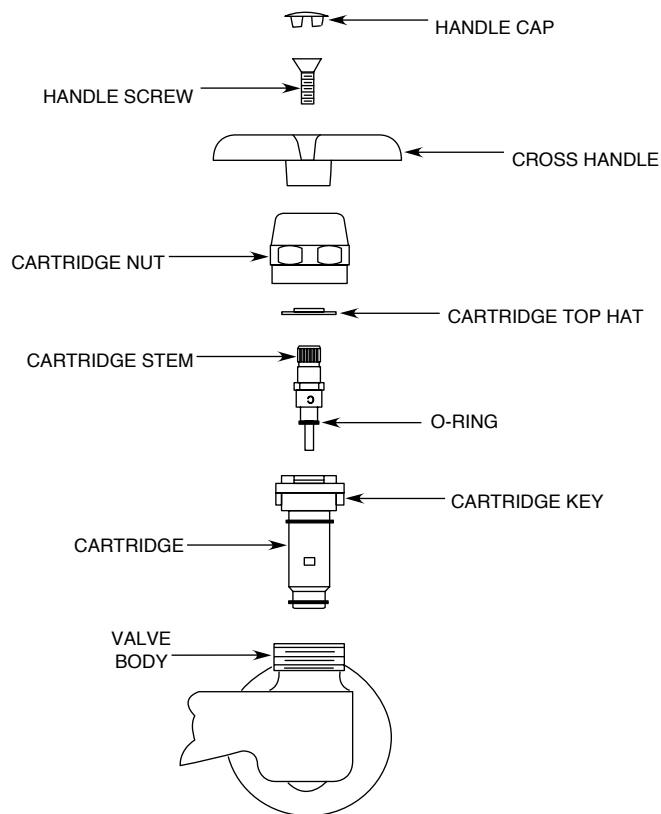

Illustration 3

# Reassembly

**For model #8120**

1. Thoroughly grease cartridge o-rings and stem o-rings with grease pack provided. Make sure cartridge stem o-ring is installed as shown in illustration 3 before installing stem into the cartridge. (**Hot** side stem and **Cold** side stem are marked “H” and “C” respectively.)
2. Place cartridge into faucet body, making sure that the cartridge keys are aligned with notches in valve body.
3. Make sure that the cartridge top hat is in place in the cartridge nut and secure to the faucet body.
4. Place handle onto cartridge stem and rotate stems in the off direction until they stop. Remove handles and replace at desired off position. Secure with handle screw using a **TORX** screwdriver (not supplied) and place handle cap onto handle. Reference illustration 3

**For model #8121, 8122**

1. Thoroughly grease cartridge o-rings and stem o-rings with grease pack provided. Make sure cartridge stem o-ring is installed as shown in illustration 4 before installing stem into the cartridge. (**Hot** side stem and **Cold** side stem are marked “H” and “C” respectively).
2. Place cartridge into faucet body, making sure that the cartridge keys are aligned with the notches in the faucet body.
3. Make sure that the cartridge top hat is in place in the cartridge nut and secure to the faucet body.
4. Place handle washers, red “HOT” side, blue “COLD” side onto handles and secure with handle screws using a **TORX** screwdriver (not supplied). Reference illustration 4.

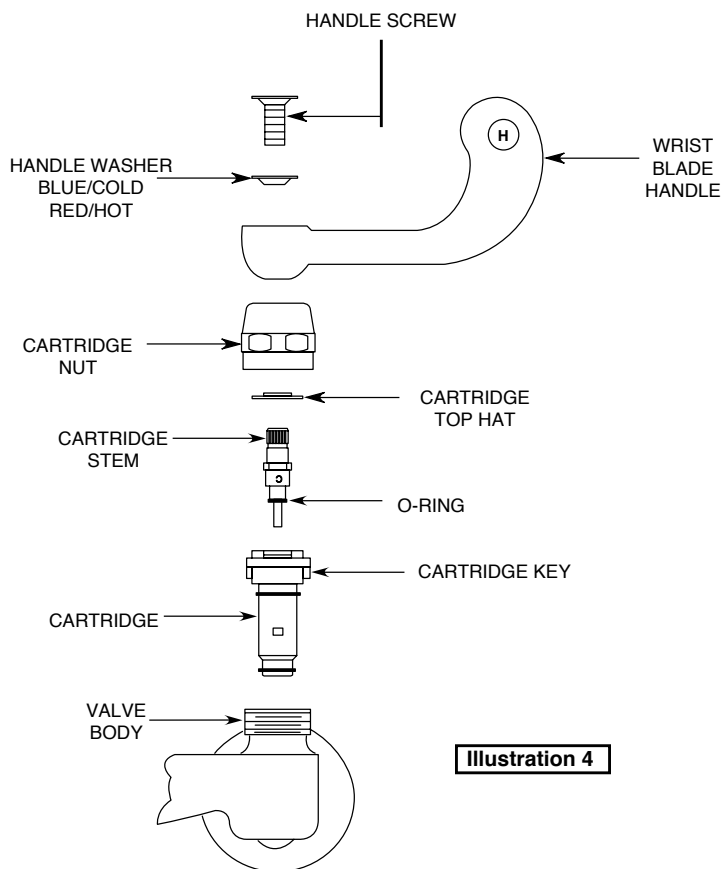
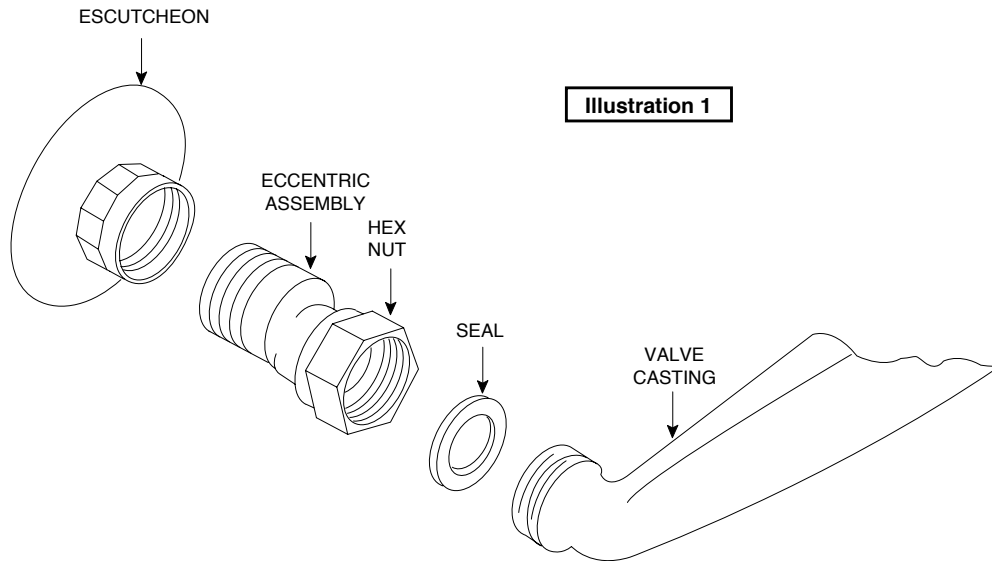

Illustration 4

# Installation

1. Apply pipe joint compound on the supply threads.
2. Thread the escutcheon onto eccentric assembly.
3. Screw the eccentric assembly onto supply threads.
4. Place a 3/8" bead of plumbers putty (not supplied) on the back of the escutcheon. Secure escutcheon against wall.
5. Making sure seal is in place, secure hex nut on eccentric assembly to valve with wrench.



# Flushing

**IMPORTANT:** Pipe chips, sand, stones and other solids found in new construction plumbing can damage the sealing surface of the faucet cartridge and cause a leak. To avoid damage, **DO NOT OPERATE VALVE** until you have followed these instructions:

- a. Make sure all water supplies are **OFF**.
- b. Remove handle parts and cartridge (see "Disassembly" on page 3 for detailed instructions).
- c. At the supplies, slowly turn both hot and cold water on and thoroughly flush out the body and lines.
- d. After flushing, reassemble valves, turn faucet on and check installation for leaks.

# Maintenance

Your new faucet will give good service for an extended period of time. Should foreign materials in the system affect its operation, routine repairs can be easily made.

If your faucet drips from the spout end or leaks up through the handle, follow "Disassembly" instructions and replace the cartridge. For proper water flow, aerator must be free of foreign particles. If flow is weak or irregular, unscrew aerator, clean and replace.

# SANI-STREAM<sup>®</sup> INSTALLATION INSTRUCTIONS

by MOEN

THESE INSTRUCTIONS MUST BE  
LEFT AT INSTALLATION SITE

## 2 HANDLE WALL MOUNT FAUCET

Model No. 8120 (Cross Handles)  
Model No. 8121 (4" Wrist Blade Handles)  
Model No. 8122 (6" Wrist Blade Handles)

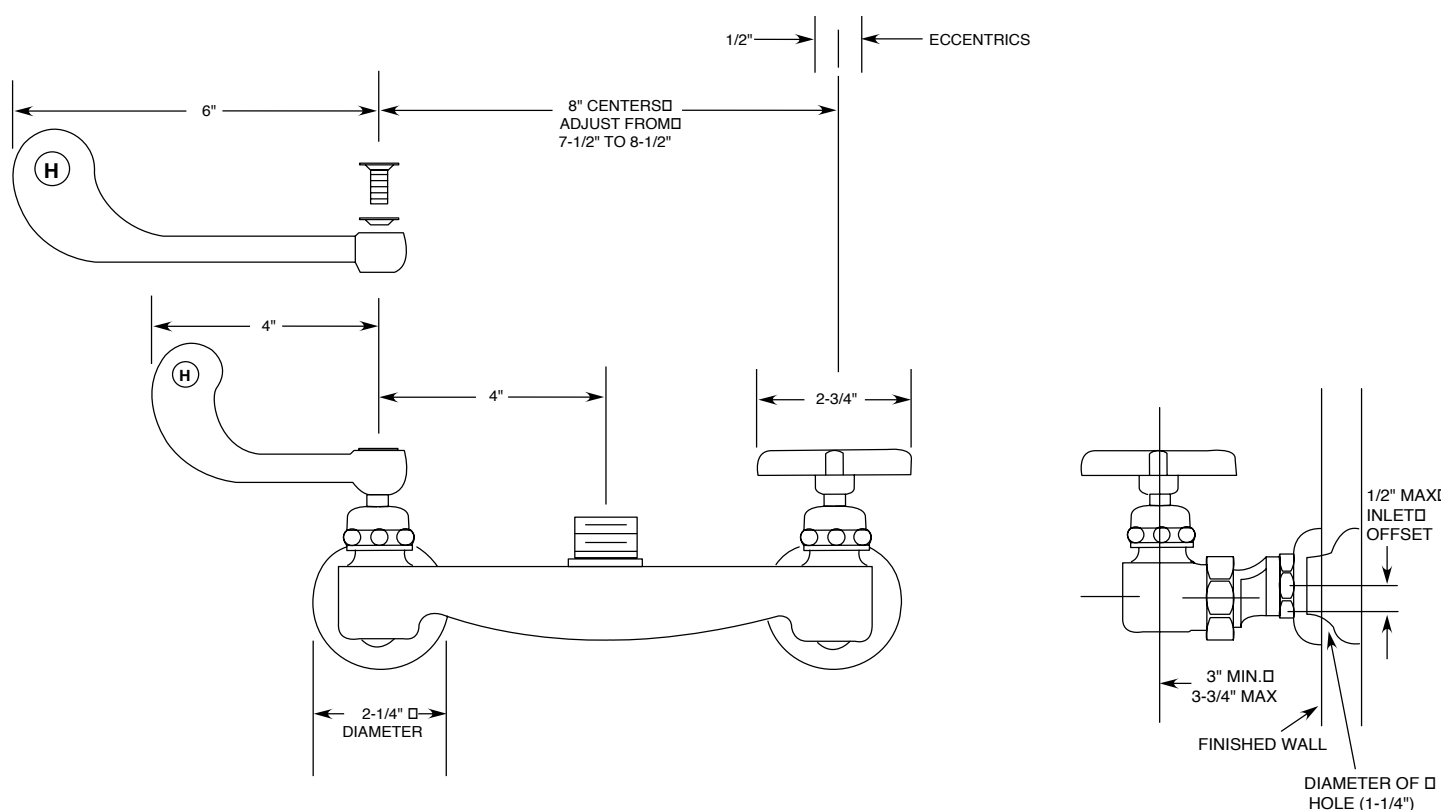

**NOTE:** Spout choice will affect installed height.  
Check local code requirements when selecting spout.

**CAUTION:** Always turn water off before disassembling the valve. Open both faucet handles to alleviate water pressure to insure that complete water shut-off has been accomplished.

Before turning water on during either rough-in or trim-out, make sure that the cartridge retainer nut is in place. The cartridge and retainer nut were properly installed and tested before leaving the factory. Although it is unlikely, it is nevertheless possible that through the handling of the valve by any number of persons the retainer nut may not be properly installed. This should be carefully checked at time of rough-in and trim-out. If the retainer nut is not properly installed, water pressure could force the cartridge out of the casting. Personal injury or water damage to the premises could result.