

Installation Instructions

822 Series Floor Drain with Deck Flange

Typical Installation on Wood Deck
Solvent Weld Connection

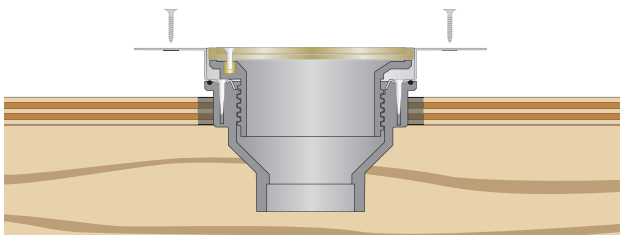

Cut a 6" round hole in wood deck and secure stainless steel flange to top surface with six screws or nails

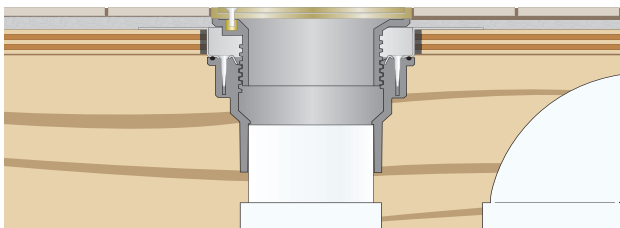

Solvent weld ABS or PVC DWV pipe into hub of drain body. Enclosure of 3" P-traps (shown) in floor/ceiling joist requires a 12" joist cavity. Drain head may be adjusted up to 3/4" above subfloor.

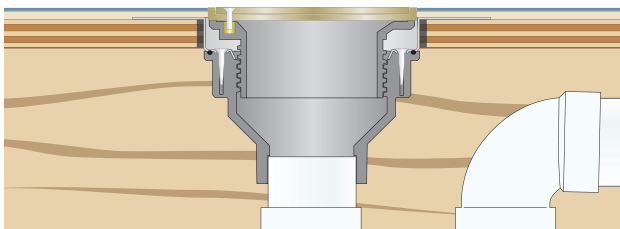

Enclosure of 2" P-traps (shown) in floor/ceiling joist requires a 10" joist cavity. Use minimal adjustment for thinner finished floor coverings.

Typical Installation in Cored Concrete
No-Hub Connection

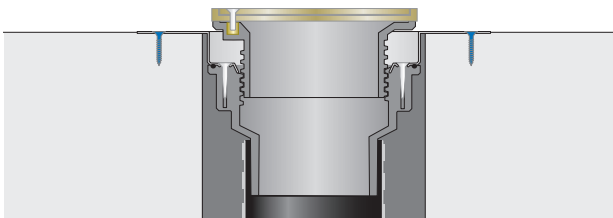

Holes in precast concrete floors should be 6" straight diameter (not stepped). Secure stainless steel flange with six screws for concrete surfaces. If necessary, connect no-hub coupling to drain outlet before installation

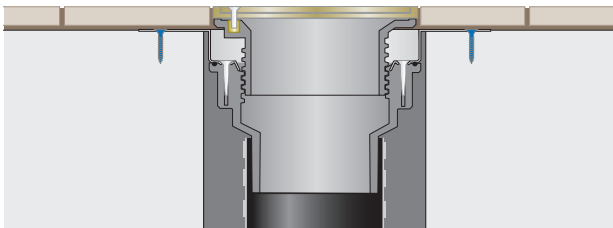

After installation, drain head may be adjusted up to 3/4" above concrete surface to accommodate finished floor veneer.

Installation of Finish Line Option
(cored concrete application)

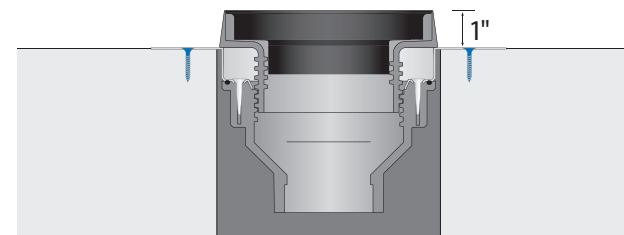

Install drain and secure stainless steel flange as described. Finish Line sleeve/plug assembly will set 1" above concrete surface.

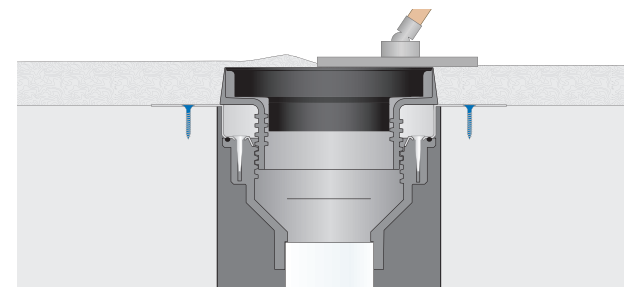

Finish secondary (or lightweight) concrete pour flush with top surface of sleeve/plug assembly.

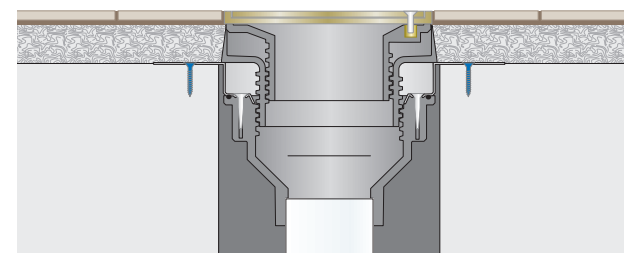

Remove Finish Line plug and replace with drain fixture when flooring is installed.

Installation Notes:

- Solvent weld joints should be made per solvent cement/DWV pipe manufacturer's instructions. Follow manufacturer's instructions for installation of no-hub couplings.
- Installation of drain flange on underside of wood or metal decks is NOT recommended.
- Always be sure to check and follow all local plumbing codes.



Sioux Chief Manufacturing
1-800-821-3944 • www.siouxchief.com

