

SPLIT RING HANGERS

516 SERIES

SPECIFICATION

Sioux Chief 516-B series domestic split ring hangers shall be used where necessary to suspend or support CTS or IPS piping from 3/8" threaded rod in accordance with national code requirements for light commercial applications. Hanger shall comply with MSS-SP58 Type 12 and WWH-171D Type 25.

MATERIALS

- 516-CB:** Copper-plated, 16 gauge steel
- 516-GB:** Galvanized, 16 gauge steel

SAFE WORKING LOAD

180 lbs.

DIMENSIONS

Dimensions = inches

		CTS					
Tube size		1/2"	3/4"	1"	1 1/4"	1 1/2"	2"
A:	O.D.	0.625	0.875	1.125	1.375	1.625	2.125
B:	Center line	0.600	0.730	0.850	0.980	1.100	1.350
C:	Length	2.23	2.44	2.69	2.94	3.19	3.69
D:	Height	1.033	1.23	1.52	1.78	2.02	2.52
E:	Depth	0.63	0.63	0.63	0.63	0.63	0.63
		IPS					
Pipe size		1/2"	3/4"	1"	1 1/4"	1 1/2"	2"
A:	O.D.	0.84	1.05	1.32	1.66	1.90	2.38
B:	Center line	0.71	0.82	0.95	1.12	1.24	1.48
C:	Length	2.40	2.61	2.88	3.22	3.46	3.94
D:	Height	1.19	1.41	1.72	2.06	2.30	2.78
E:	Depth	0.63	0.63	0.63	0.63	0.63	0.63

ITEM # SUBMITTED	_____
JOB NAME	_____
LOCATION	_____
ENGINEER	_____
CONTRACTOR	_____
PO#	_____ TAG _____



516-4CB

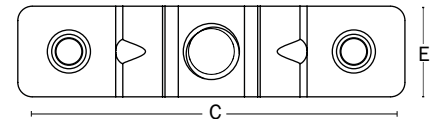
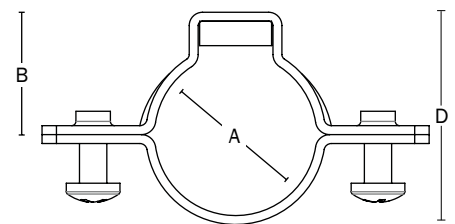

Made in USA

Create Item Number

516-AB

e.g. **516-4CB:** Copper-plated split ring hanger for 1" CTS tube.

TUBE/PIPE SIZE <u>A</u>	FINISH <u>B</u>
2 = 1/2"	CB = Copper-plated
3 = 3/4"	GB = Galvanized
4 = 1"	
5 = 1 1/4"	
6 = 1 1/2"	
7 = 2"	