

ONE-LOK™ MODEL SLCE WEDGE RESTRAINT FOR PVC PIPE

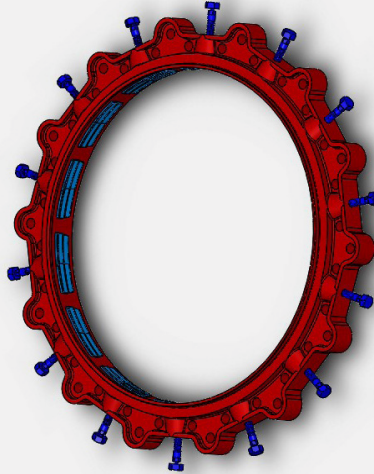
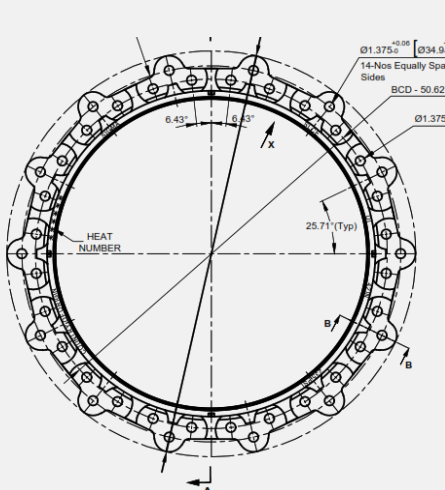

PRODUCT SPECIFICATIONS

- MATERIAL:**
- Gland body, wedge inserts and break-off top actuating bolts are manufactured of high strength ductile iron in accordance with ASTM A536, Grade 65-45-12.
- SIZE RANGE:**
- 3" - 60"
- DIMENSION:**
- Conform to ANSI/AWWA C111/A21.11 & ANSI/AWWA C153/A21.53 standards
- PRESSURE RATING:**
- Equal to the water working pressure rating of the pipe upon which it is installed with a minimum 2:1 factor of safety.
- COATING:**
- Red Alkyd paint
 - Electro-deposition "CORRSAFE™" available upon request. For further information, please refer to our CORRSAFE Product Information sheet at <http://www.sigmaco.com/pipe-restraint-product-coatings-linings/>
- APPROVALS:**
- Underwriters Laboratories' listed in sizes 4"-12" to ASTM F1674 (latest revision) and Factory Mutual approved in sizes 4"-12".
- DEFLECTION:**
- 5° on 3"-12", 2° on 14"-16", 1.5° on 18"-30" and 1° on 36", 42", 48", 54" and 60"
- TRACEABILITY:**
- Gland body, wedge inserts and break-off top actuating bolts are individually cast with exact heat code information.
- INSTALLATION:**
- In accordance with manufacturer's recommendation and applicable AWWA standards.